

0 10 20 30 40 50 METRES
M.G.A. ZONE 56 M.G.A. DATUM: GDA2020

- DESIGNER AND WATER SERVICING COORDINATOR:
QALCHEK PTY LTD (CERTIFIED No.289)
UNIT 2, LEVEL 1, 15-17 DAVID ROAD, EMU PLAINS 2750
PH. No. (02) 4722 8181

FOR:
WOORONG PARK PTY LTD
c/o J WYNDHAM PRINCE
580 HIGH STREET, PENRITH, NSW 2750
PH. (02) 4720 3300
- THE WORKS AND MATERIALS ARE IN ACCORDANCE WITH THE SEWERAGE CODE OF AUSTRALIA WSA 02-2002-2.2 SYDNEY WATER EDITION VERSION 4 (2017) INCLUDING THE SYDNEY WATER SUPPLEMENT & APPENDICES AS WELL AS THE SYDNEY WATER TECHNICAL SPECIFICATION - CIVIL VERSION 9.0.
- ALL STRUCTURES WERE CONSTRUCTED TO FINISHED SURFACE LEVELS.
ALL LEVELS REFER TO FINISHED SURFACE LEVEL.
- ALL BUILDING LAYOUTS, FINISHED SURFACE LEVELS, STORMWATER INFORMATION, AND GENERAL CIVIL ENGINEERING DETAILS TAKEN FROM:
CIVIL BASEPLAN: 998512-P7F-BASE FOR SERVICE DESIGN.dwg (SUPPLIED 21.01.22 BY JWP)
SURFACE INFORMATION: Design Precinct 7 triangles 211012.dwg (SUPPLIED 21.01.22 BY JWP)
SWD INFORMATION SUBDIVISION: Drainage LS SYSTEM A & B.dwg (SUPPLIED 21.01.22 BY JWP)
- THE MINIMUM NUMBER OF FIELD COMPACTION TESTS CONDUCTED TO SATISFY THE SEWERAGE CODE OF AUSTRALIA ARE:
PIPE EMBEDMENT ZONE: 0 TESTS CONDUCTED (LETTER PROVIDED)
TRENCH FILL ZONE (NON TRAFFICABLE): 7 TESTS CONDUCTED (LETTER PROVIDED)
TRENCH FILL ZONE (TRAFFICABLE): 0 TESTS CONDUCTED (LETTER PROVIDED)
TRENCH FILL ZONE (MAINTENANCE STRUCTURES): 19 TESTS CONDUCTED (LETTER PROVIDED)
TRENCH FILL ZONE - TOTAL: 26 TESTS CONDUCTED
- ALL EXCAVATION, SHORING EXCAVATION AND STABILITY OF ADJACENT STRUCTURES/SERVICES/DWELLINGS WAS THE RESPONSIBILITY OF THE CONSTRUCTOR.
- ALL PCS CONNECTIONS TO I.S. ARE AT 0.7m & 45° TO MAIN UNLESS OTHERWISE INDICATED.
DENOTES STANDARD PCS CONNECTION (REFER DTC-2120 ISSUE A DATE 18.03.15)
- THE WORKS WERE CONSTRUCTED IN ACCORDANCE WITH SYDNEY WATER'S DEEMED TO COMPLY DRAWINGS:

FOR ALL MH'S
DTC-2000 (ISSUE C 18.03.15),
DTC-2203 (ISSUE B 18.03.15),
DTC-2220 (ISSUE D 18.03.15),
DTC-2221 (ISSUE B 01.03.13),
DTC-2222 (ISSUE C 18.03.15)
- PIPES CONCRETE ENCASED SHOWN ACCORDINGLY: REFER TO SEW-1205-V
- AREAS HATCHED THUS NOT DRAINED:
- W.A.C. PREPARED FROM INFORMATION SUPPLIED (IN PART BY QALCHEK PTY LTD) & BY J.P.H. SURVEYS.

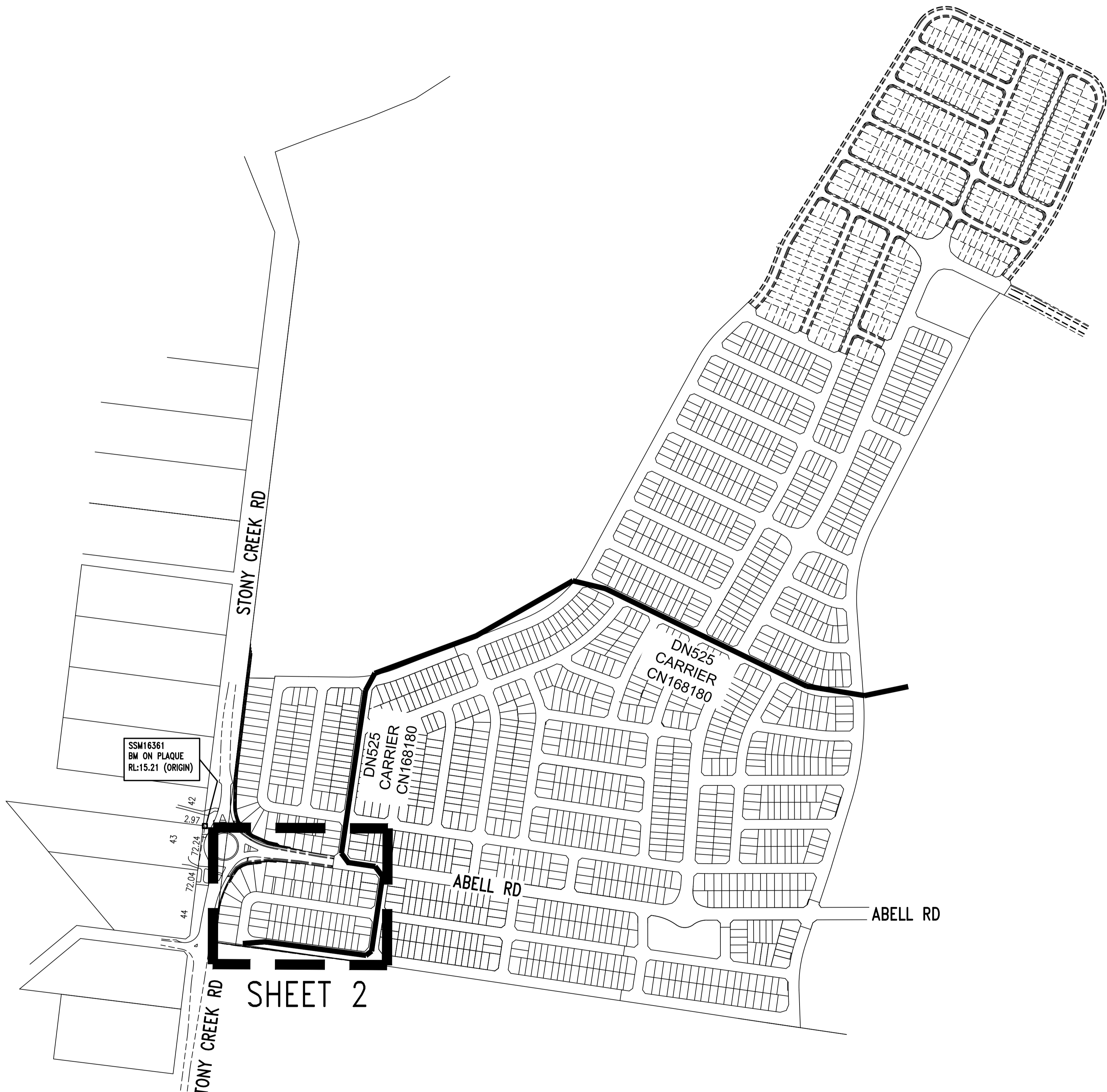

SHEET 2

LOCALITY PLAN & BENCHMARK DIAGRAM

(NOT TO SCALE)

1	WORK AS CONSTRUCTED	JV	01.06.23
C	L1/L2 AMENDED TO SUIT EX. CARRIER INLET	TT	04.05.23
B	ISSUE FOR APPROVAL	FJ	28.05.22
A	LAYOUT FOR CLIENT	FJ	28.01.22
No.	AMENDMENT DESCRIPTION	BY	DATE

PLAN TO BE READ IN CONJUNCTION WITH CURRENT SYDNEY WATER STANDARDS SYDNEY WATER CORPORATION PRIOR TO COMMENCEMENT OF EXCAVATION FOR PROPOSED AND EXISTING SERVICES CONTACT:- DIAL BEFORE YOU DIG Ph. 1100 ELECTRICITY Ph. GAS Ph. TELECOMMUNICATIONS Ph. SYDNEY WATER Ph. 132 092 GIVING AT LEAST 48 HOURS NOTICE.	UTILITIES <table border="1"> <tr> <th>TYPE</th> <th>DATE</th> <th>REF.</th> </tr> <tr> <td>WATER: DN100 Water</td> <td>29.05.22</td> <td>DESIGN</td> </tr> <tr> <td>NEW WATER: DN100 Water</td> <td>29.05.22</td> <td>DESIGN</td> </tr> <tr> <td>STORMWATER: SWD</td> <td>21.01.22</td> <td>ENG.PLAN</td> </tr> <tr> <td>NEW STORMWATER: SWD</td> <td>21.01.22</td> <td>ENG.PLAN</td> </tr> <tr> <td>SSM 16361 (ORIGIN)</td> <td>05.05.21</td> <td>SCIMS</td> </tr> </table>			TYPE	DATE	REF.	WATER: DN100 Water	29.05.22	DESIGN	NEW WATER: DN100 Water	29.05.22	DESIGN	STORMWATER: SWD	21.01.22	ENG.PLAN	NEW STORMWATER: SWD	21.01.22	ENG.PLAN	SSM 16361 (ORIGIN)	05.05.21	SCIMS	WORK AS CONSTRUCTED CERTIFICATION DEVELOPER WOORONG PARK PTY LTD WATER SERVICE CO-ORDINATOR QALCHEK PTY LTD CONSTRUCTOR C.J. DOYLE CONTRACTING SERVICES PTY LTD COMPLETED 15.05.2023 W.A.C. PREPARED 01.06.2023 DESIGNER QALCHEK PTY LTD I CERTIFY THAT THE WORKS HAVE BEEN CONSTRUCTED IN ACCORDANCE WITH THE WORK AS CONSTRUCTED DRAWINGS.			PIPE SCHEDULE <table border="1"> <tr> <th>SIZE DN</th> <th>TYPE</th> <th>CLASS</th> <th>LENGTH</th> <th>PIPE JOINING METHOD / NOTES</th> </tr> <tr> <td>150</td> <td>U.P.V.C.</td> <td>SN8</td> <td>572.72</td> <td>RRJ</td> </tr> <tr> <td>100</td> <td>U.P.V.C.</td> <td>SN10</td> <td>108.00</td> <td>SWJ</td> </tr> </table>			SIZE DN	TYPE	CLASS	LENGTH	PIPE JOINING METHOD / NOTES	150	U.P.V.C.	SN8	572.72	RRJ	100	U.P.V.C.	SN10	108.00	SWJ	AUSTRALIAN HEIGHT DATUM SCALES PLAN . 1:500 . SECTION { HOR. . 1:500 VERT. . 1:125 . CROSS SECTIONS NATURAL LENGTHS, DEPTHS & LEVELS ARE IN METRES.			NO AMENDMENTS ARE TO BE MADE TO THIS PLAN WITHOUT REFERENCE TO SYDNEY WATER. THIS PLAN IS NOT NECESSARILY UP TO DATE OR CORRECT AND SYDNEY WATER ACCEPTS NO RESPONSIBILITY. Sydney WATER SYDNEY WATER CORPORATION Case No. 192219WW BLACKTOWN SEWERAGE DRAINS TO RICHMOND ROAD CARRIER VIA SP1160 RIVERSTONE S.T. 0042 SHEET . 1 . OF . 3 . File No. N/A		
	TYPE	DATE	REF.																																													
WATER: DN100 Water	29.05.22	DESIGN																																														
NEW WATER: DN100 Water	29.05.22	DESIGN																																														
STORMWATER: SWD	21.01.22	ENG.PLAN																																														
NEW STORMWATER: SWD	21.01.22	ENG.PLAN																																														
SSM 16361 (ORIGIN)	05.05.21	SCIMS																																														
SIZE DN	TYPE	CLASS	LENGTH	PIPE JOINING METHOD / NOTES																																												
150	U.P.V.C.	SN8	572.72	RRJ																																												
100	U.P.V.C.	SN10	108.00	SWJ																																												
FILE LOCATION: PM28373WW-1			DESIGNED: T.T.			DRAFTED: J.V.			VERIFIED: D.L.			REVIEWED: D.L.			APPROVED: D.L.			ISSUED: 01.06.2023																														

PLAN DRAWN DATE: 01.06.2023 VERSION: 1 SHEET 1 OF 3 SHEETS

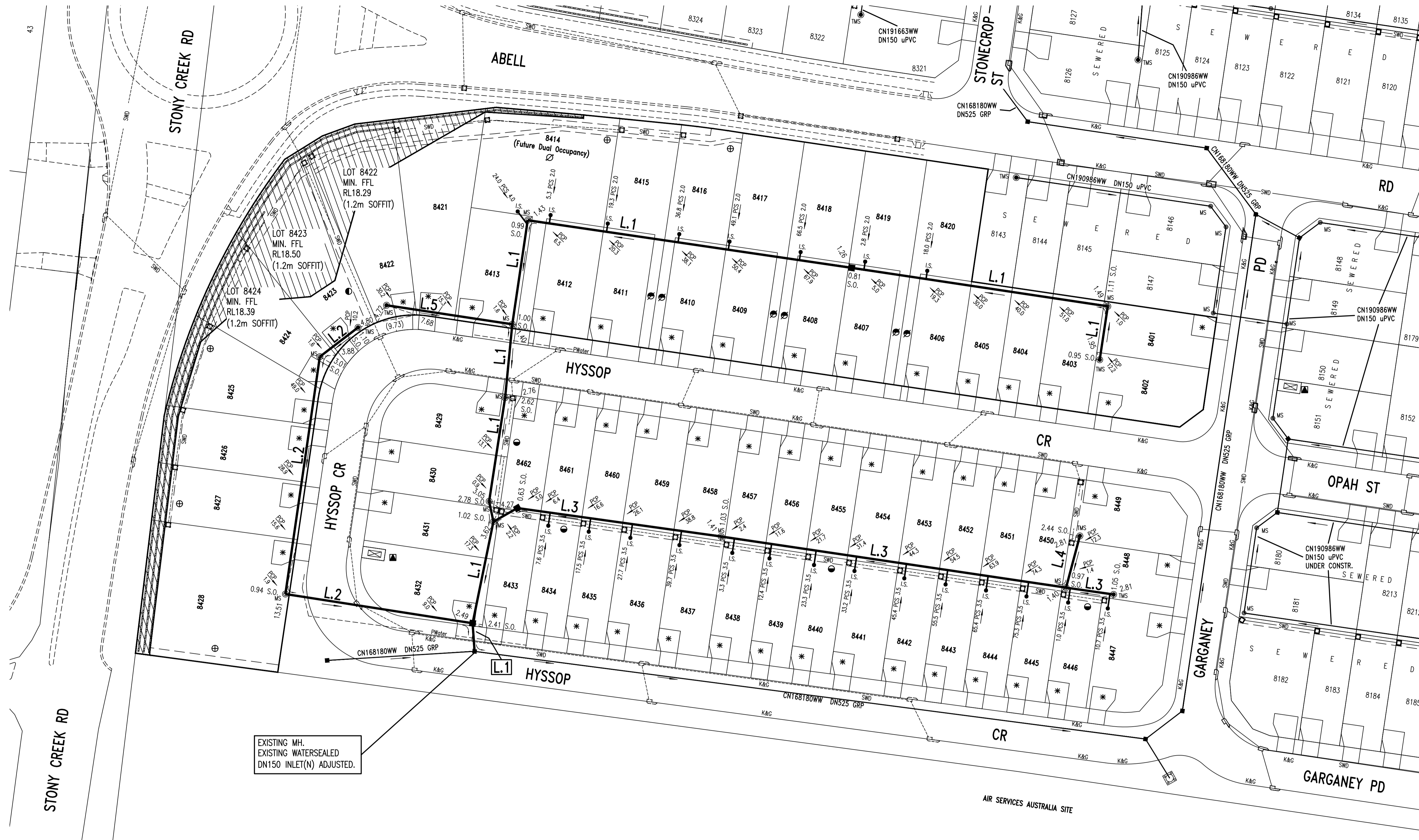
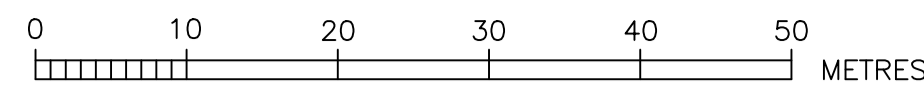

EXISTING MH.
EXISTING WATERSEALED
DN150 INLET(N) ADJUSTED.

- EASEMENT FOR DRAINAGE 1.5 WIDE
- EASEMENT FOR DRAINAGE 2.5 WIDE
- * DRIVEWAY
- SUBSTATION
- ⊕ EASEMENT FOR RETAINING WALLS
- ⊗ RIGHT OF CARRIAGEWAY & EASEMENT FOR SERVICES
- ⊗ LOT 8414 PROVIDED WITH 2 SEWER CONNECTIONS FOR FUTURE DUAL OCCUPANCY. DN100 PCS LINE CONCRETE ENCASED.

1	WORK AS CONSTRUCTED	TT	01.06.23
C	L1/L2 AMENDED TO SUIT EX. CARRIER INLET	TT	04.05.23
B	ISSUE FOR APPROVAL	FJ	28.05.22
A	LAYOUT FOR CLIENT	FJ	28.01.22
No.	AMENDMENT DESCRIPTION	BY	DATE

WORK AS CONSTRUCTED CERTIFICATION

DEVELOPER: WOORONG PARK PTY LTD.
W.S.C.: DALCHEK PTY LTD.
CONSTRUCTOR: C.J. DOYLE PTY LTD.
COMPLETED: 15.05.2023
W.A.C. PREPARED: 01.06.2023

Sydney WATER
SYDNEY WATER CORPORATION
Case No. 192219WW SHT 2 OF 3 SHTS.

DESIGNER: DALCHEK PTY LTD.
I CERTIFY THAT THE WORKS HAVE BEEN CONSTRUCTED IN ACCORDANCE WITH THE WORK AS CONSTRUCTED DRAWINGS

SYDNEY WATER CORPORATION
FOR DETAILS OF SERVICES SEE SHEET 1

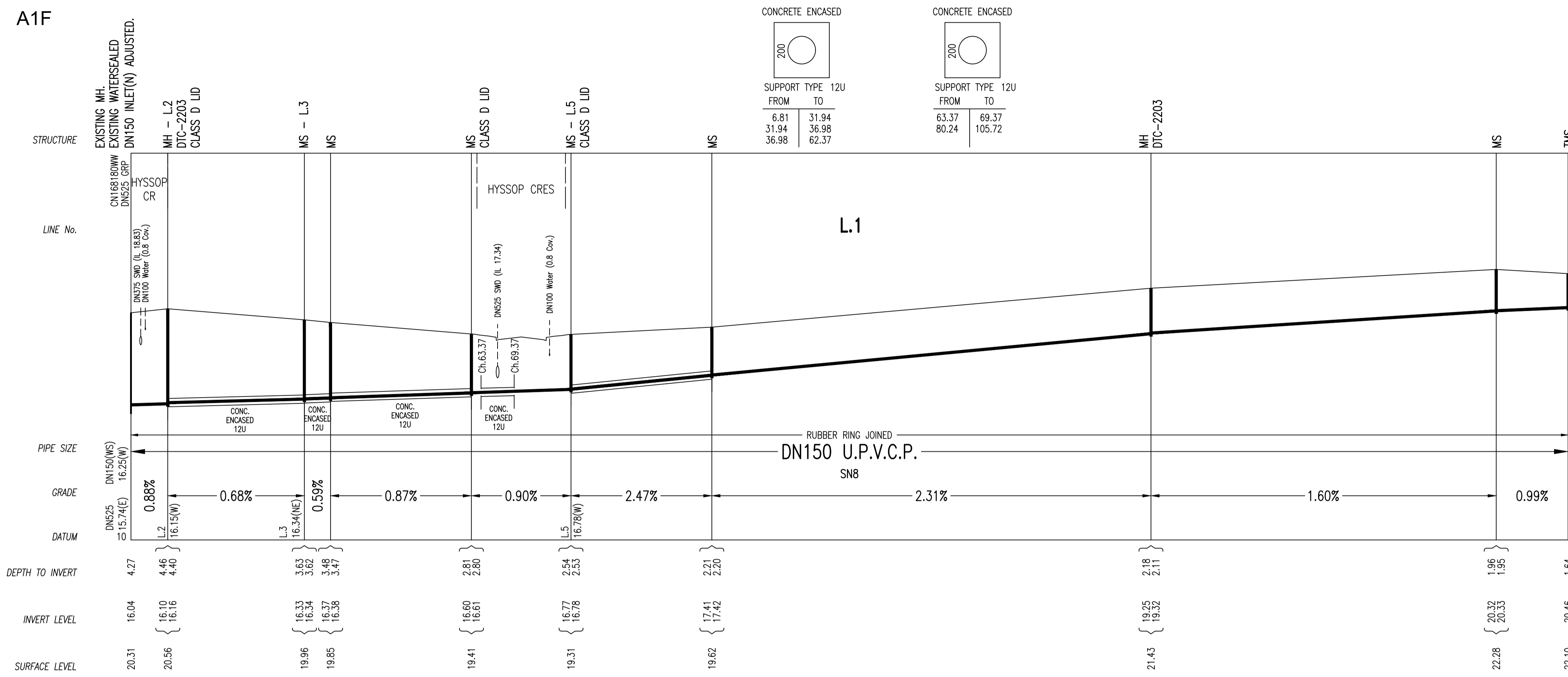

LINE No.	CHAINAGE	TYPE (MH/MS/MC)	DN RISER	CLASS OF COVER	MATERIAL (PVC-U, PE, PP, GRP, CAST IN SITU CONC, PRE-CAST CONC, OTHER - SPECIFY)	COMMENTS (BRAND/DTC No/ISSUE, DATE/NA, OTHER AS REQUIRED)
1	6.81	MH	1050	D	IN-SITU CONCRETE	DTC-2203
	31.94	MS	225	B	AS PER WSA-137	AS PER WSA-137
	36.98	MS	225	B	AS PER WSA-137	AS PER WSA-137
	62.37	MS	225	D	AS PER WSA-137	AS PER WSA-137
	80.24	MS	225	D	AS PER WSA-137	AS PER WSA-137
	105.72	MS	225	B	AS PER WSA-137	AS PER WSA-137
	185.02	MH	1050	B	IN-SITU CONCRETE	DTC-2203
	247.71	MS	225	B	AS PER WSA-137	AS PER WSA-137
	260.80	TMS	225	B	AS PER WSA-137	AS PER WSA-137
2	45.88	MS	225	D	AS PER WSA-137	AS PER WSA-137
	103.97	MS	225	D	AS PER WSA-137	AS PER WSA-137
	115.61	TMS	225	D	AS PER WSA-137	AS PER WSA-137
3	6.66	MH	1050	B	IN-SITU CONCRETE	DTC-2203
	56.47	MS	225	B	AS PER WSA-137	AS PER WSA-137
	140.91	MS	225	B	AS PER WSA-137	AS PER WSA-137
	152.54	TMS	225	B	AS PER WSA-137	AS PER WSA-137
4	12.97	TMS	225	B	AS PER WSA-137	AS PER WSA-137
5	30.80	TMS	225	D	AS PER WSA-137	AS PER WSA-137

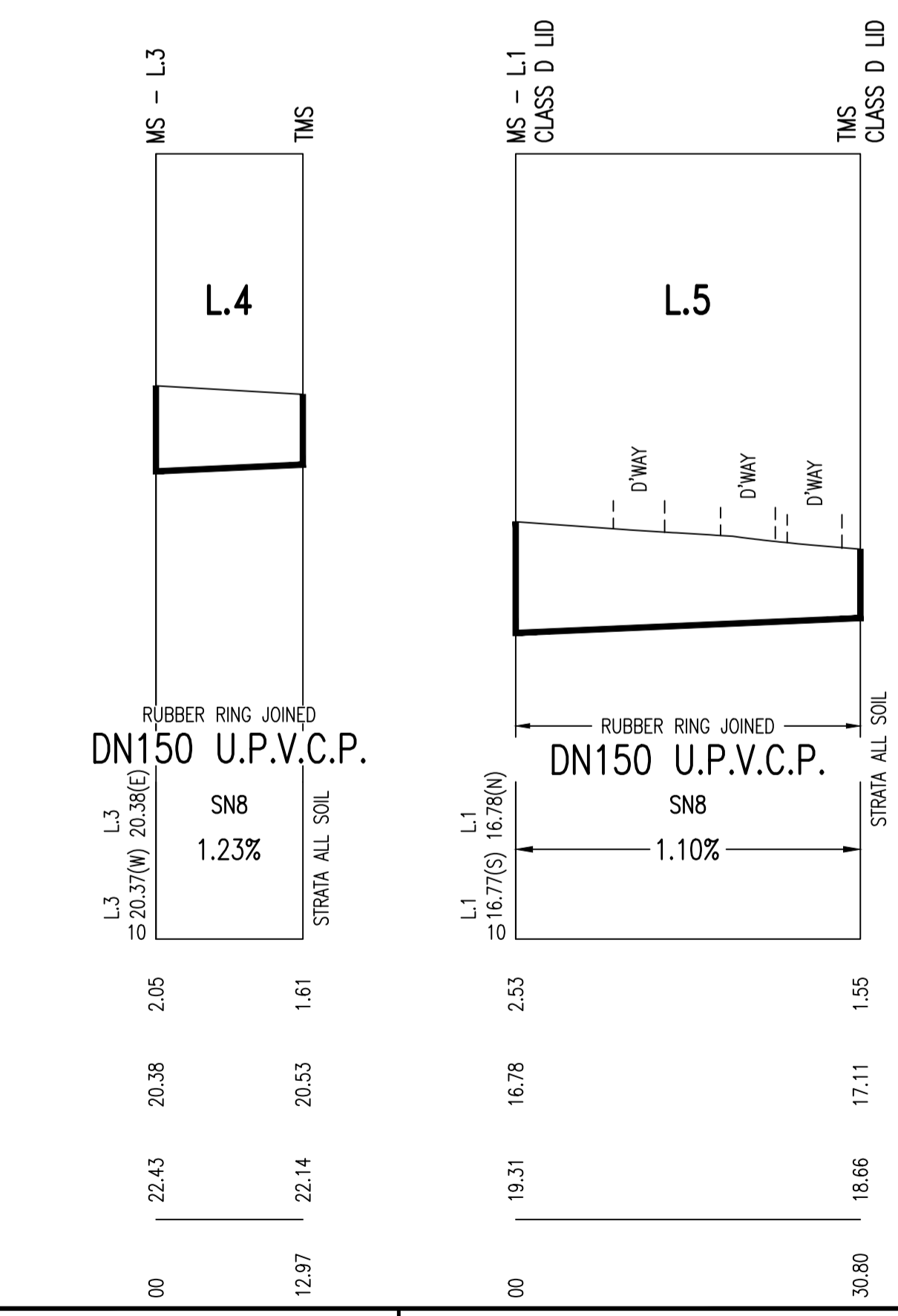
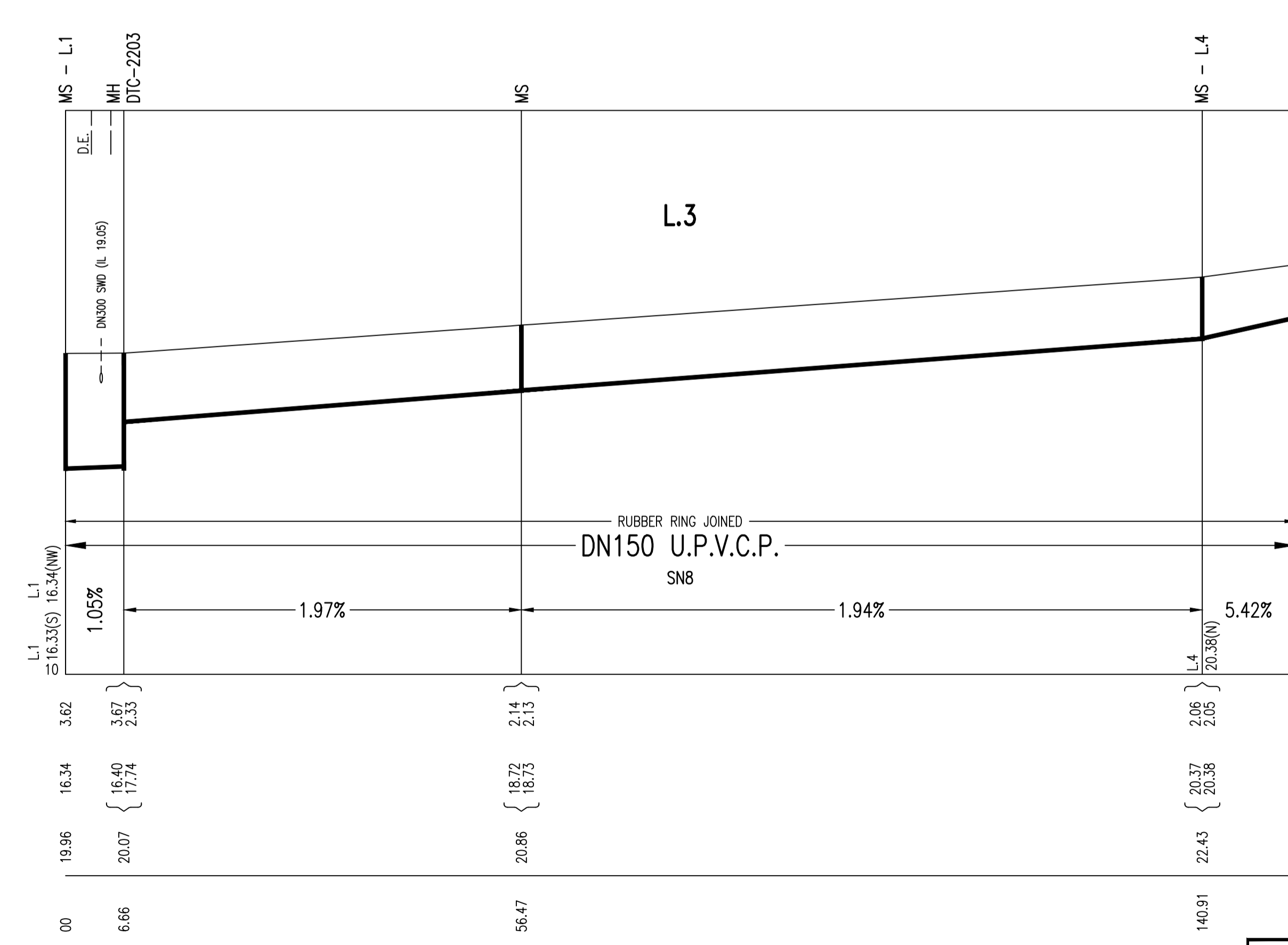
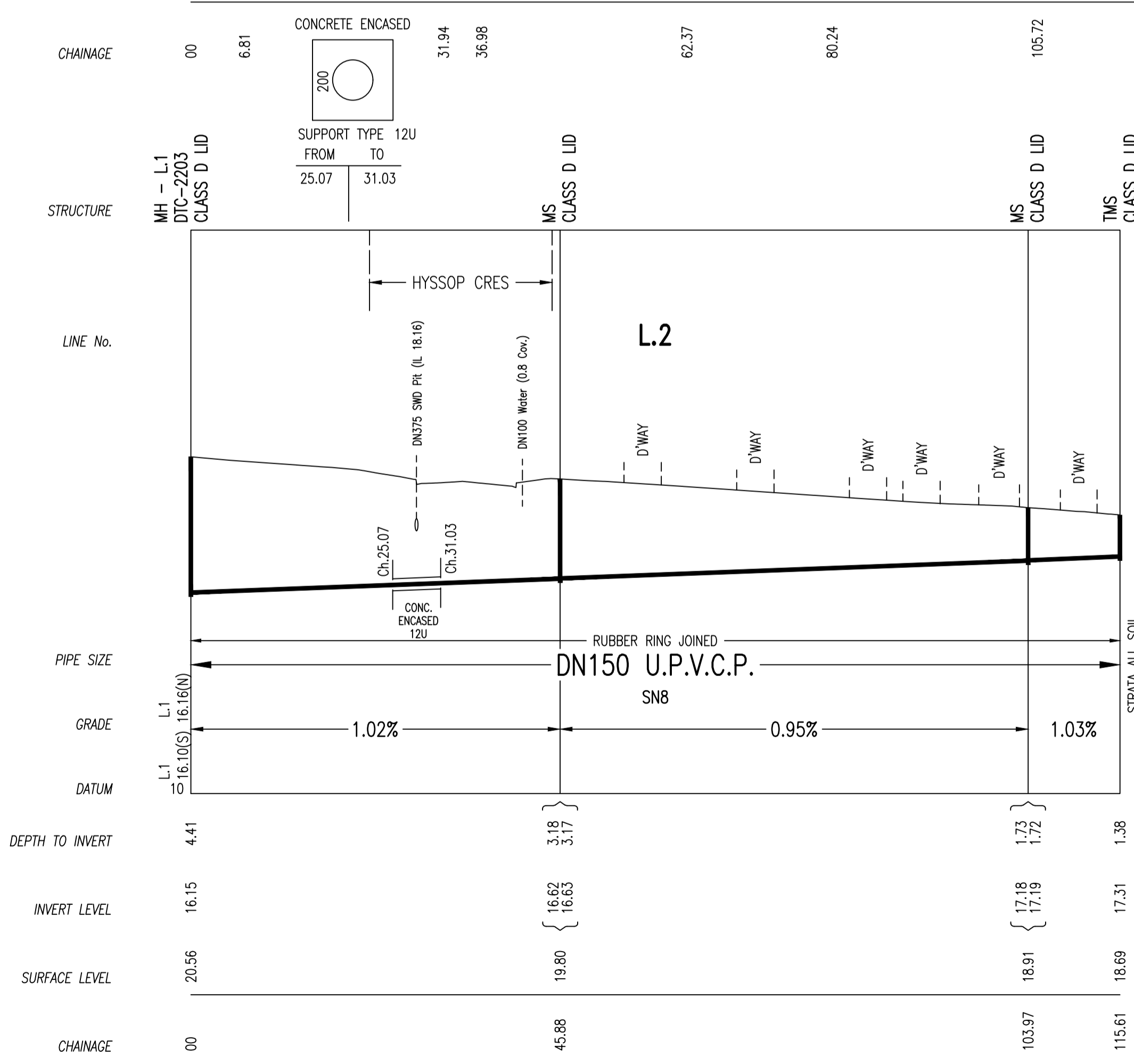

No.	AMENDMENT DESCRIPTION	BY	DATE
1	WORK AS CREATED	TT	01.06.23
C	L1/L2 AMENDED TO SUIT EX. CARRIER INLET	TT	04.05.23
B	ISSUE FOR APPROVAL	FJ	28.05.22
A	LAYOUT FOR CLIENT	FJ	28.01.22

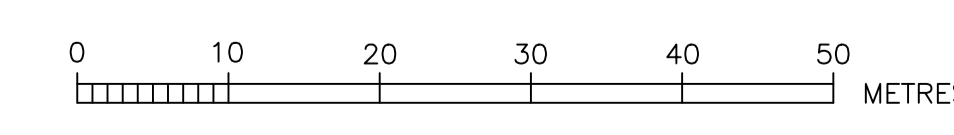

WORK AS CREATED CERTIFICATION		SYDNEY WATER CORPORATION	
DEVELOPER	WOORONG PARK PTY LTD	Sydney WATER	
W.S.C.	QUALCHEK PTY LTD		
CONSTRUCTOR	CJ DOYLE PTY LTD	Case No. 192219WW	SHT 3 OF 3 SHTS.
COMPLETED	15.05.2023		
W.A.C. PREPARED	01.06.2023		
DESIGNER	QUALCHEK PTY LTD	SYDNEY WATER CORPORATION	
I CERTIFY THAT THE WORKS HAVE BEEN CONSTRUCTED IN ACCORDANCE WITH THE WORK AS CREATED DRAWINGS		FOR DETAILS OF SERVICES SEE SHEET 1	