

- DESIGNER AND WATER SERVICING COORDINATOR:
QALCHEK PTY LTD (CERTIFIED No.289)
UNIT 2, LEVEL 1, 15-17 DAVID ROAD EMU PLAINS NSW 2750
PH. No. (02) 4722 8181

FOR:
WOORONG PARK PTY LTD
C/- J WYNHAM PRINCE
580 HIGH STREET PENRITH NSW 2750
PH. (02) 4720 3300
- THE WORKS AND MATERIALS ARE IN ACCORDANCE WITH:
- THE WATER SUPPLY CODE OF AUSTRALIA (WSA 03-2011-3.1) INCLUDING THE SYDNEY WATER SUPPLEMENT (2014) AND APPENDICES
- THE SYDNEY WATER TECHNICAL SPECIFICATION - CIVIL VERSION 9.0
- THE SYDNEY WATER TECHNICAL SPECIFICATION - MECHANICAL VERSION 11.0.
- MAINS LAID GENERALLY 2.9 P.L. AND AS SHOWN AT STANDARD DEPTH BELOW KERB INVERT EXCEPT WHERE OTHERWISE SHOWN.
- ALL EXCAVATION, SHORING EXCAVATION AND STABILITY OF ADJACENT STRUCTURES/SERVICES/DWELLINGS WAS THE RESPONSIBILITY OF THE CONSTRUCTOR.
- ALL BUILDING LAYOUTS, FINISHED SURFACE LEVELS, STORMWATER INFORMATION, AND GENERAL CIVIL ENGINEERING DETAILS TAKEN FROM:
CIVIL BASEPLAN: 998512-P7F-BASE FOR SERVICE DESIGN.dwg (SUPPLIED 21.01.22 BY JWP)
SURFACE INFORMATION: Design Precinct 7 triangles 211012.dwg (SUPPLIED 21.01.22 BY JWP)
SWD INFORMATION SUBDIVISION: Drainage LS SYSTEM A & B.dwg (SUPPLIED 21.01.22 BY JWP)
- CONDITIONS FOR EMBEDMENT, BACKFILL AND TESTING REQUIREMENTS ARE AS FOLLOWS:
- ALL POTABLE WATER ROAD CARRIAGEWAY CROSSINGS FOR EXISTING AND NEW ROADS BEDDED AND BACKFILLED WITH SAND/CEMENT. SAND/CEMENT RATIO 20:1 AND WAS PLACED DRY.
- FOR ANY WATERMAIN LOCATED WITHIN 1.0m OF A ROAD SHOULDER OR KERB AND GUTTER IN THE VERGE OR FOOTPATH THE EMBEDMENT AND BACKFILL WAS COMPACTED TO A DENSITY INDEX OF 95%. ALL TESTS (EMBEDMENT AND BACKFILL) WERE DONE AS FOR TRAFFICABLE AREA.

THE MINIMUM NUMBER OF FIELD COMPACTION TESTS CONDUCTED TO SATISFY THE CONDITIONS ABOVE AS WELL AS THE WATER SUPPLY CODE OF AUSTRALIA ARE:

PIPE EMBEDMENT ZONE: 0 TESTS CONDUCTED
TRENCH FILL ZONE (TRAFFICABLE): 20 TESTS CONDUCTED
TRENCH FILL ZONE PROPERTY SERVICES: 13 TESTS CONDUCTED
COMPACTION TESTS - TOTAL: 33 TESTS CONDUCTED
- ALL PROPERTY (MAIN TO METER) SERVICES WERE CONSTRUCTED TO SYDNEY WATER'S INSTALLATION REQUIREMENTS BY A LICENSED PLUMBER AND ACCREDITED DRILLER. THE WORKS WERE INSTALLED IN ACCORDANCE WITH THE CURRENT SYDNEY WATER PROPERTY SERVICE (MAIN TO METER) INSTALLATIONS TECHNICAL REQUIREMENTS, NSW CODE OF PRACTICE FOR PLUMBING AND DRAINAGE, AND AS/NZ 3500.
- ALL REDUNDANT SURFACE FITTINGS AND INDICATOR PLATES WERE RECOVERED.
- THE WORKS WERE CONSTRUCTED IN ACCORDANCE WITH THE FOLLOWING SYDNEY WATER'S DEEMED TO COMPLY DRAWINGS:
- FOR HORIZONTAL BENDS TYPE 2 DTC-1111 (ISSUE B 29.02.12)
- FOR STOP VALVES NOTE THAT VALVES DN200 AND UNDER DO NOT REQUIRE ANCHORING AS NOTED IN SYDNEY WATER'S EMAIL 08.08.14
- BULKHEADS WERE CONSTRUCTED AT EACH KERB CROSSING TO WAT-1209.

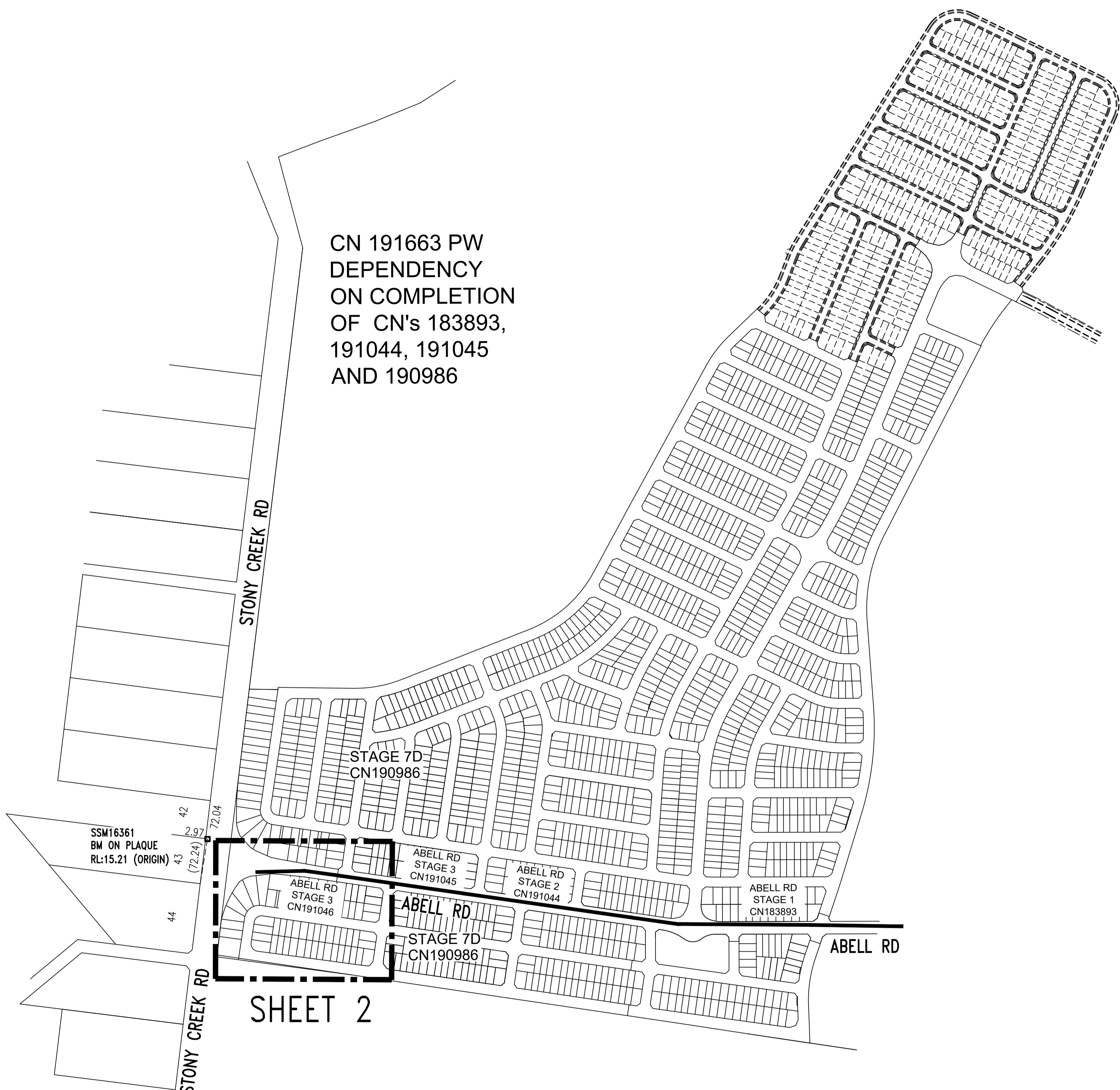

CN 191663 PW
DEPENDENCY
ON COMPLETION
OF CN's 183893,
191044, 191045
AND 190986

SHEET 2

LOCALITY PLAN & BENCHMARK DIAGRAM

(NOT TO SCALE)

PLAN DRAWN DATE: 27.10.2023 VERSION: 1 SHEET 1 OF 2 SHEETS

1	WORK AS CONSTRUCTED	J.V.	27.10.23
B	ISSUE FOR APPROVAL	FJ	30.05.22
A	LAYOUT FOR CLIENT	FJ	28.01.22
No.	AMENDMENT DESCRIPTION	BY	DATE

PLAN TO BE READ IN CONJUNCTION WITH CURRENT SYDNEY WATER STANDARDS SYDNEY WATER CORPORATION PRIOR TO COMMENCEMENT OF EXCAVATION FOR PROPOSED AND EXISTING SERVICES CONTACT:- DIAL BEFORE YOU DIG Ph. 1100 ELECTRICITY Ph. GAS Ph. TELECOMMUNICATIONS Ph. SYDNEY WATER Ph. 132 092 GIVING AT LEAST 48 HOURS NOTICE.	UTILITIES TYPE DATE REF. TYPE DATE REF. EXIST. SEWER: S - - - - - S 26.03.22 DESIGN NEW SEWER: S - - - - - S 26.03.22 DESIGN STORMWATER: SWD - - - - - SWD 21.01.22 ENG.PLAN NEW STORMWATER: SWD - - - - - SWD 21.01.22 ENG.PLAN SSM 16361 (ORIGIN) 05.05.21 SCIMS	WORK AS CONSTRUCTED CERTIFICATION DEVELOPER WOORONG PARK PTY LTD WATER SERVICE CO-ORDINATOR QALCHEK PTY LTD CONSTRUCTOR C.J. DOYLE CONTRACTING SERVICE PTY LTD COMPLETED 24.10.2023 W.A.C. PREPARED 27.10.2023 DESIGNER QALCHEK PTY LTD I CERTIFY THAT THE WORKS HAVE BEEN CONSTRUCTED IN ACCORDANCE WITH THE WORK AS CONSTRUCTED DRAWINGS.	PIPE SCHEDULE SIZE DN TYPE CLASS LENGTH PIPE JOINING METHOD / NOTES 100 OPVC PN16 464.9 RRJ DESIGN HEAD, 120 m BOUNDARY TRAPS REQUIRED.	AUSTRALIAN HEIGHT DATUM SCALES PLAN 1:500 SECTION { HOR. VERT. CROSS SECTIONS NATURAL LENGTHS, DEPTHS & LEVELS ARE IN METRES.	NO AMENDMENTS ARE TO BE MADE TO THIS PLAN WITHOUT REFERENCE TO SYDNEY WATER. THIS PLAN IS NOT NECESSARILY UP TO DATE OR CORRECT AND SYDNEY WATER ACCEPTS NO RESPONSIBILITY. U.B. DIRECTORY MAP 126/A16 45th EDITION SHEET . 1 . OF . 2 . File No. N/A Sydney WATER SYDNEY WATER CORPORATION Case No. 192219PW WATERMAIN EXTENSION ABELL RD AND OTHERS MARSDEN PARK BLACKTOWN
	FILE LOCATION: PM28373PW-1 DESIGNED: F.J. DRAFTED: J.V. VERIFIED: D.L. REVIEWED: D.L. APPROVED: D.L. ISSUED: 27.10.2023				

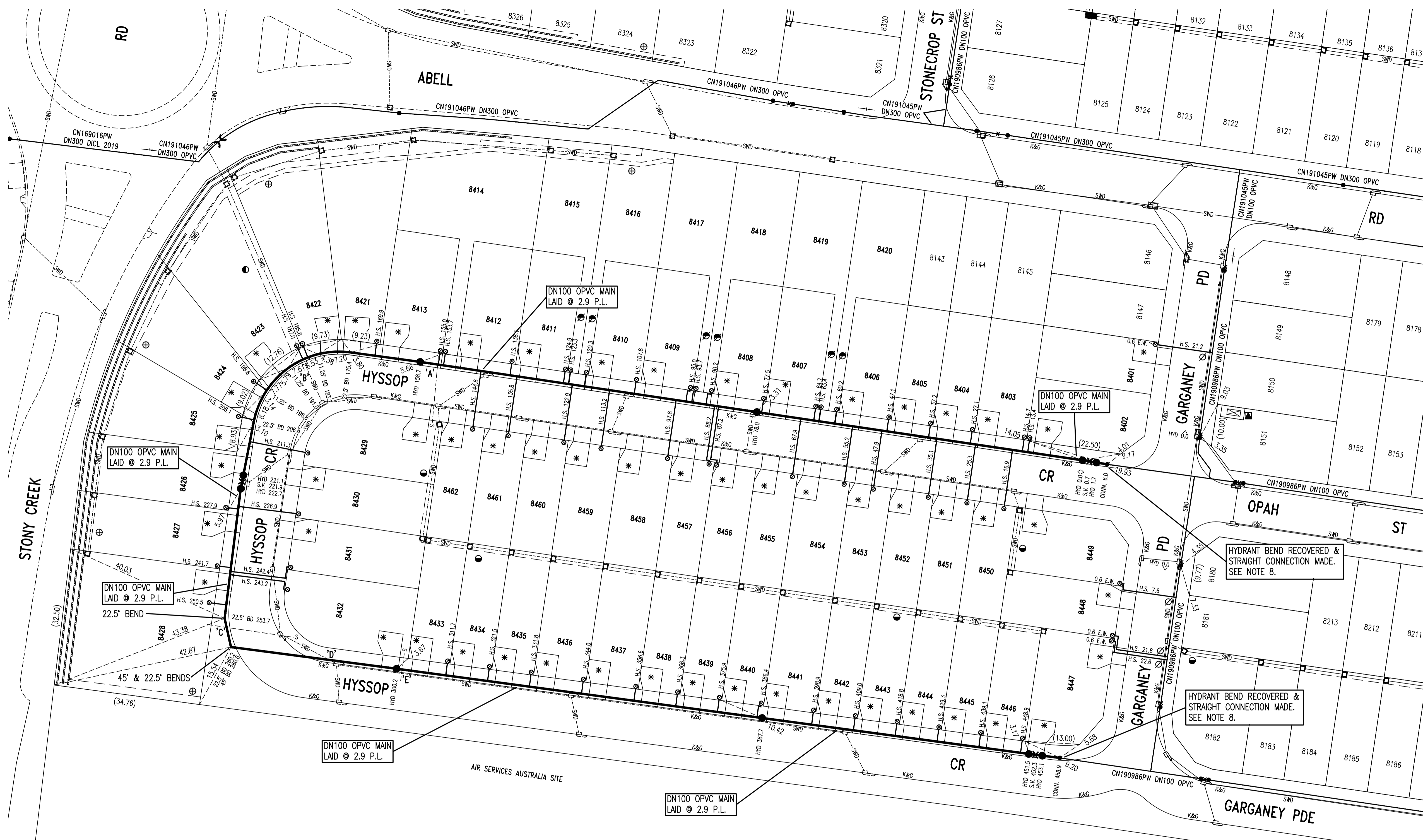

SERVICES CROSSING TABLE – MAIN LAID OVER UNLESS NOTED OTHERWISE

CROSSING	SERVICE	SERVICE SIZE	PW SIZE	SERVICE COVER (m)	PW COVER (m)	CLEARANCE (m)	COMMENT/DTC
'A'	Sewer	DN150	DN100	2.40	0.75	1.55	N/A
'B'	SWD	DN600	DN100	1.20	0.75	0.35	N/A
'C'	Sewer	DN150	DN100	3.10	0.75	2.25	N/A
'D'	SWD	DN375	DN100	1.15	0.75	0.30	N/A
'E'	Sewer	DN150	DN100	4.08	0.75	3.23	N/A

- EASEMENT FOR DRAINAGE 1.5 WIDE
- EASEMENT FOR DRAINAGE 2.5 WIDE
- * DRIVEWAY
- SUBSTATION
- ⊕ EASEMENT FOR RETAINING WALLS
- ⊗ ROC & EASEMENT FOR SERVICES
- ⊗ TAPPING INSERTED INTO EXISTING MAIN

1	WORK AS CONSTRUCTED	J.V.	27.10.23
B	ISSUE FOR APPROVAL	FJ	30.05.22
A	LAYOUT FOR CLIENT	FJ	28.01.22
No.	AMENDMENT DESCRIPTION	BY	DATE

WORK AS CONSTRUCTED CERTIFICATION		SYDNEY WATER CORPORATION	
DEVELOPER	WOORONG PARK PTY LTD	Sydney WATER	Case No. 192219PW SHT 2 OF 2 SHTS.
W.S.C.	QALCHEK PTY LTD		
CONSTRUCTOR	C.J. DOYLE CONTRACTING SERVICE PTY LTD	DESIGNER . . . QALCHEK PTY LTD	
COMPLETED	24.10.2023	I CERTIFY THAT THE WORKS HAVE BEEN CONSTRUCTED IN ACCORDANCE WITH THE WORK AS CONSTRUCTED DRAWINGS	
W.A.C. PREPARED	27.10.2023	FOR DETAILS OF SERVICES SEE SHEET 1	