

0 10 20 30 40 50 METRES
M.G.A. ZONE 56 M.G.A. DATUM: GDA2020

- DESIGNER AND WATER SERVICING COORDINATOR:
QALCHEK PTY LTD (CERTIFIED No.289)
UNIT 2, LEVEL 1, 15-17 DAVID ROAD, EMU PLAINS NSW 2750
PH. No. (02) 4722 8181

FOR:
WOORONG PARK PTY LTD
c/o J WYNDHAM PRINCE
560 HIGH STREET PENRITH NSW 2750
PH. (02) 4720 3300
- THE WORKS AND MATERIALS ARE IN ACCORDANCE WITH THE WATER SUPPLY CODE OF AUSTRALIA (WSA 03-2011-3.1) INCLUDING THE SYDNEY WATER SUPPLEMENT (2014) AND APPENDICES AS WELL AS THE SYDNEY WATER TECHNICAL SPECIFICATION - CIVIL VERSION 9.0 AND THE SYDNEY WATER TECHNICAL SPECIFICATION - MECHANICAL VERSION 11.0.
- MAINS LAID GENERALLY AS SHOWN AT STANDARD DEPTH BELOW KERB INLET EXCEPT WHERE OTHERWISE SHOWN.
- ALL EXCAVATION, SHORING EXCAVATION AND STABILITY OF ADJACENT STRUCTURES/SERVICES/DWELLINGS WAS THE RESPONSIBILITY OF THE CONSTRUCTOR.
- ALL BUILDING LAYOUTS, FINISHED SURFACE LEVELS, STORMWATER INFORMATION, AND GENERAL CIVIL ENGINEERING DETAILS TAKEN FROM:
CIVIL BASEPLAN: 998512-P7B-BASE FOR SERVICE DESIGN.dwg (SUPPLIED 26.03.2021 BY JWP)
SURFACE INFORMATION: 9985 DESIGN PRECINCT 7 TRIANGLES 210513.dwg (SUPPLIED 20.07.2021 BY JWP)
SND INFORMATION SUBDIVISION: Drainage LS SYSTEM A & B.dwg (SUPPLIED 26.03.21 BY JWP)
- CONDITIONS FOR EMBEDMENT, BACKFILL AND TESTING REQUIREMENTS ARE AS FOLLOWS:
- ALL POTABLE WATER ROAD CARRIAGEWAY CROSSINGS FOR EXISTING AND NEW ROADS BEDDED AND BACKFILLED WITH SAND/CEMENT. SAND/CEMENT RATIO 14:1 AND WAS PLACED DRY.
- FOR ANY WATERMAIN LOCATED WITHIN 1.0m OF A ROAD SHOULDER OR KERB AND GUTTER IN THE VERGE OR FOOTPATH THE EMBEDMENT AND BACKFILL WAS COMPACTED TO A DENSITY INDEX OF 98%. ALL TESTS (EMBEDMENT AND BACKFILL) WERE DONE AS FOR TRAFFICABLE AREA.

THE MINIMUM NUMBER OF FIELD COMPACTION TESTS CONDUCTED TO SATISFY THE CONDITIONS ABOVE AS WELL AS THE WATER SUPPLY CODE OF AUSTRALIA ARE:
PIPE EMBEDMENT ZONE: 0 TESTS CONDUCTED (LETTER PROVIDED)
TRENCH FILL ZONE (TRAFFICABLE): 106 TESTS CONDUCTED
TRENCH FILL ZONE PROPERTY SERVICES: 54 TESTS CONDUCTED
COMPACTION TESTS - TOTAL: 160 TESTS CONDUCTED
- ALL PROPERTY (MAIN TO METER) SERVICES WERE CONSTRUCTED TO SYDNEY WATER'S INSTALLATION REQUIREMENTS BY A LICENSED PLUMBER AND ACCREDITED DRILLER. THE WORKS WERE INSTALLED IN ACCORDANCE WITH THE CURRENT SYDNEY WATER PROPERTY SERVICE (MAIN TO METER) INSTALLATIONS TECHNICAL REQUIREMENTS, NSW CODE OF PRACTICE FOR PLUMBING AND DRAINAGE, AND AS/NZ 3500.
- ALL REDUNDANT SURFACE FITTINGS AND INDICATOR PLATES WERE RECOVERED.
- THE WORKS WERE CONSTRUCTED IN ACCORDANCE WITH THE FOLLOWING SYDNEY WATER'S DEEMED TO COMPLY DRAWINGS:
- FOR HORIZONTAL BENDS TYPE 2 DTC-1111 (ISSUE B 29.02.12)
- FOR TEES DTC-1113 (ISSUE B 29.02.12)
- FOR VERTICAL BENDS & HYDRANT BENDS DTC-1114 (ISSUE A 31.01.12)
- FOR STOP VALVES NOTE THAT VALVES DN200 AND UNDER DO NOT REQUIRE ANCHORING AS NOTED IN SYDNEY WATER'S EMAIL 08.08.14

LOCALITY PLAN & BENCHMARK DIAGRAM

(NOT TO SCALE)

1	WORK AS CONSTRUCTED	J.V.	22.11.22
C	5 TAPPING LOCATIONS AMENDED	FJ	07.10.21
B	ISSUE FOR APPROVAL	FJ	09.09.21
A	ISSUE FOR CLIENT REVIEW	FJ	03.05.21
No.	AMENDMENT DESCRIPTION	BY	DATE

PLAN TO BE READ IN CONJUNCTION WITH CURRENT SYDNEY WATER STANDARDS SYDNEY WATER CORPORATION

PRIOR TO COMMENCEMENT OF EXCAVATION FOR PROPOSED AND EXISTING SERVICES CONTACT:-
DIAL BEFORE YOU DIG Ph. 1100
ELECTRICITY Ph.
GAS Ph.
TELECOMMUNICATIONS Ph.
SYDNEY WATER Ph. 132 092
GIVING AT LEAST 48 HOURS NOTICE.

UTILITIES			
TYPE	DATE	REF.	
EXIST. SEWER: S	09.09.21	DESIGN	
NEW SEWER: S	09.09.21	DESIGN	
STORMWATER: SWD	20.07.21	ENG.PLAN	
NEW STORMWATER: SWD	20.07.21	ENG.PLAN	
SSM 16361 (ORIGIN)	05.05.21	SCIMS	

WORK AS CONSTRUCTED CERTIFICATION	
DEVELOPER	WOORONG PARK PTY LTD
WATER SERVICE CO-ORDINATOR	QALCHEK PTY LTD
CONSTRUCTOR	C.J. DOYLE PTY LTD
COMPLETED	08.11.2022
DESIGNER	QALCHEK PTY LTD
I CERTIFY THAT THE WORKS HAVE BEEN CONSTRUCTED IN ACCORDANCE WITH THE WORK AS CONSTRUCTED DRAWINGS.	

PIPE SCHEDULE				
SIZE DN	TYPE	CLASS	LENGTH	PIPE JOINING METHOD / NOTES
100	OPVC	PN16	2609.2	RRJ
DESIGN HEAD, 120 m				
BOUNDARY TRAPS REQUIRED.				

AUSTRALIAN HEIGHT DATUM	
SCALES	
PLAN 1:500	SECTION { HOR. VERT.
CROSS SECTIONS NATURAL	
LENGTHS, DEPTHS & LEVELS ARE IN METRES.	

NO AMENDMENTS ARE TO BE MADE TO THIS PLAN WITHOUT REFERENCE TO SYDNEY WATER. THIS PLAN IS NOT NECESSARILY UP TO DATE OR CORRECT AND SYDNEY WATER ACCEPTS NO RESPONSIBILITY.

U.B. DIRECTORY MAP 126/A/16 45th EDITION

SHEET . 1 . OF . 5 . File No. N/A

Sydney WATER SYDNEY WATER CORPORATION

Case No. 190189PW

WATERMAIN EXTENSION
ABELL RD AND OTHERS
MARSDEN PARK BLACKTOWN



DRAINAGE BASIN
876

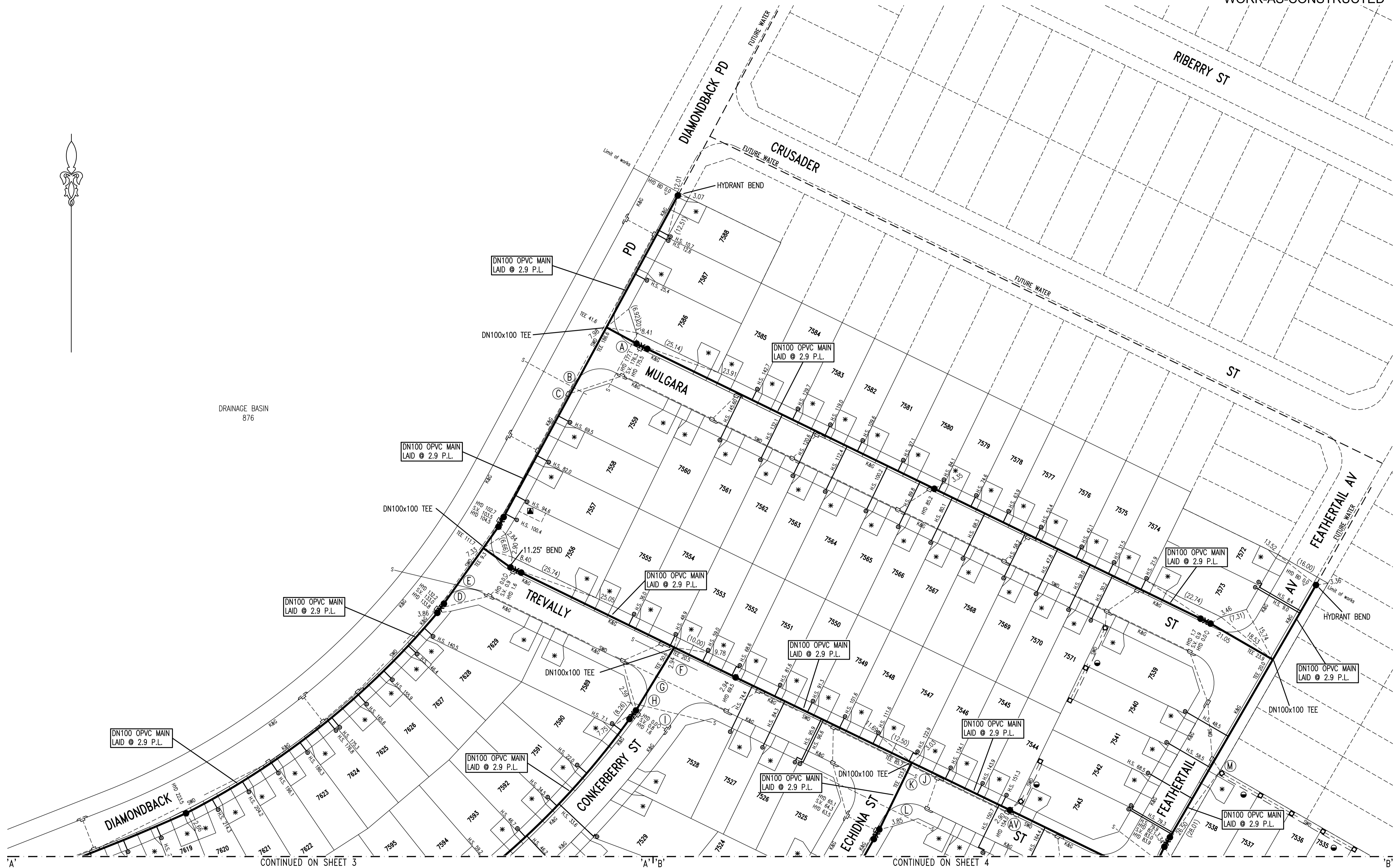

CONTINUED ON SHEET 3

CONTINUED ON SHEET 4

- EASEMENT FOR DRAINAGE 1.5 WIDE
- * DRIVEWAY
- SUBSTATION
- ⊗ TAPPING INSERTED INTO EXISTING MAIN

No.	AMENDMENT DESCRIPTION	BY	DATE
1	WORK AS CONSTRUCTED	J.V.	22.11.22
C	5 TAPPING LOCATIONS AMENDED	FJ	07.10.21
B	ISSUE FOR APPROVAL	FJ	09.09.21
A	ISSUE FOR CLIENT REVIEW	FJ	03.05.21

WORK AS CONSTRUCTED CERTIFICATION		SYDNEY WATER CORPORATION	
DEVELOPER	WOORONG PARK PTY LTD	Sydney WATER	Case No. 190189PW SHT 2 OF 5 SHTS.
W.S.C.	QALCHEK PTY LTD		
CONSTRUCTOR	C.J. DOYLE PTY LTD	FOR DETAILS OF SERVICES SEE SHEET 1	
COMPLETED	08.11.2022		
W.A.C. PREPARED	22.11.2022	SYDNEY WATER CORPORATION	
DESIGNER	QALCHEK PTY LTD	I CERTIFY THAT THE WORKS HAVE BEEN CONSTRUCTED IN ACCORDANCE WITH THE WORK AS CONSTRUCTED DRAWINGS	

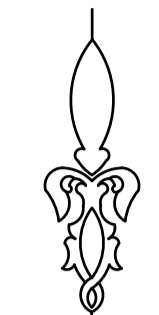

CONTINUED ON SHEET 2

CONTINUED ON SHEET 4

- ◉ EASEMENT FOR DRAINAGE 1.5 WIDE
- * DRIVEWAY
- SUBSTATION
- ◊ TAPPING INSERTED INTO EXISTING MAIN

1	WORK AS CONSTRUCTED	J.V.	22.11.22
C	5 TAPPING LOCATIONS AMENDED	FJ	07.10.21
B	ISSUE FOR APPROVAL	FJ	09.09.21
A	ISSUE FOR CLIENT REVIEW	FJ	03.05.21
No.	AMENDMENT DESCRIPTION	BY	DATE

WORK AS CONSTRUCTED CERTIFICATION		SYDNEY WATER CORPORATION	
DEVELOPER	WOORONG PARK PTY LTD	Sydney WATER	Case No. 190189PW SHT 3 OF 5 SHTS.
W.S.C.	QALCHEK PTY LTD		
CONSTRUCTOR	C.J. DOYLE PTY LTD	DESIGNED: F.J.	
COMPLETED	08.11.2022	DRAFTED: J.V.	
W.A.C. PREPARED	22.11.2022	VERIFIED: D.L.	
DESIGNER	QALCHEK PTY LTD	REVIEWED: D.L.	
I CERTIFY THAT THE WORKS HAVE BEEN CONSTRUCTED IN ACCORDANCE WITH THE WORK AS CONSTRUCTED DRAWINGS		APPROVED: D.L.	
FOR DETAILS OF SERVICES SEE SHEET 1		ISSUED: 22.11.2022	

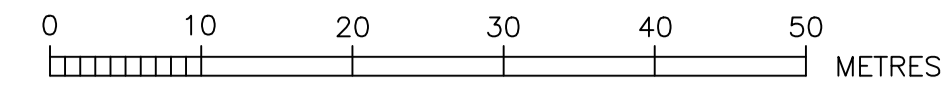

SERVICES CROSSING TABLE SHEET - MAIN LAID OVER UNLESS NOTED OTHERWISE

CROSSING	SERVICE	SERVICE SIZE	PW SIZE	SERVICE COVER (m)	PW COVER (m)	CLEARANCE (m)	COMMENT/DTC
'A'	Sewer	DN150	DN100	2.17	0.75	1.27	N/A
'B'	Sewer	DN150	DN100	3.18	0.75	2.28	N/A
'C'	SWD	DN675	DN100	1.59	0.75	0.69	N/A
'D'	SWD	DN675	DN100	2.17	0.75	1.27	N/A
'E'	Sewer	DN525	DN100	5.08	0.75	4.18	N/A
'F'	Sewer	DN525	DN100	6.46	0.75	5.56	N/A
'G'	SWD	DN600	DN100	2.78	0.75	1.88	N/A
'H'	Sewer	DN150	DN100	3.08	0.75	2.18	N/A
'I'	SWD	DN375	DN100	1.47	0.75	0.57	N/A
'J'	SWD	DN600	DN100	2.34	0.75	1.44	N/A
'K'	Sewer	DN525	DN100	7.10	0.75	6.20	N/A
'L'	Sewer	DN150	DN100	2.89	0.75	1.99	N/A
'M'	SWD	DN375	DN100	1.12	0.75	0.22	N/A
'N'	SWD	DN1200x2	DN100	1.67	0.75	0.77	N/A
'O'	Sewer	DN225	DN100	4.02	0.75	3.12	N/A
'P'	SWD	DN1200x2	DN100	1.39	0.75	0.49	N/A
'Q'	SWD	DN1200x2	DN100	1.34	0.75	0.44	N/A
'R'	SWD	DN375	DN100	1.44	0.75	0.54	N/A
'S'	Sewer	DN225	DN100	3.94	0.75	3.04	N/A
'T'	SWD	DN1200x2	DN100	1.70	0.75	0.80	N/A
'U'	Sewer	DN150	DN100	3.00	0.75	2.10	N/A
'V'	SWD	DN675	DN100	1.44	0.75	0.54	N/A
'W'	SWD	DN1200x2	DN100	1.36	0.75	0.46	N/A
'X'	Sewer	DN225	DN100	3.76	0.75	2.86	N/A
'Y'	SWD	DN450	DN100	1.85	0.75	0.95	N/A
'Z'	Sewer	DN150	DN100	2.92	0.75	2.02	N/A
'AA'	SWD	DN1350	DN100	1.32	0.75	0.42	N/A
'AB'	SWD	DN1350	DN100	1.37	0.75	0.47	N/A
'AC'	SWD	DN1350	DN100	1.37	0.75	0.47	N/A
'AD'	Sewer	DN225	DN100	3.04	0.75	2.14	N/A
'AE'	SWD	DN1050	DN100	1.55	0.75	0.65	N/A
'AF'	Sewer	DN225	DN100	3.07	0.75	2.17	N/A
'AG'	SWD	DN375	DN100	1.83	0.75	0.93	N/A
'AH'	SWD	DN375	DN100	1.51	0.75	0.61	N/A
'AI'	SWD	DN600	DN100	1.69	0.75	0.79	N/A
'AJ'	SWD	DN375	DN100	1.09	0.75	0.19	N/A
'AK'	Sewer	DN150	DN100	2.14	0.75	1.24	N/A
'AL'	SWD	DN375	DN100	1.35	0.75	0.45	N/A
'AM'	Sewer	DN575	DN100	8.27	0.75	7.37	N/A
'AN'	SWD	DN375	DN100	1.18	0.75	0.28	N/A
'AO'	Sewer	DN150	DN100	2.75	0.75	1.85	N/A
'AP'	SWD	DN525	DN100	1.73	0.75	0.83	N/A
'AQ'	SWD	DN375	DN100	1.60	0.75	0.70	N/A
'AR'	SWD	DN450	DN100	1.35	0.75	0.45	N/A
'AS'	Sewer	DN150	DN100	2.31	0.75	1.41	N/A
'AT'	Sewer	DN150	DN100	1.39	0.75	0.49	N/A
'AU'	SWD	DN375	DN100	1.53	0.75	0.63	N/A
'AV'	SWD	DN375	DN100	1.10	0.75	0.20	N/A
'AW'	SWD	DN750	DN100	1.97	0.75	1.07	N/A
'AX'	SWD	DN375	DN100	1.10	0.75	0.20	N/A

- EASEMENT FOR DRAINAGE 1.5 WIDE
- * DRIVEWAY
- SUBSTATION
- ⊗ TAPPING INSERTED INTO EXISTING MAIN

WORK AS CONSTRUCTED CERTIFICATION		SYDNEY WATER CORPORATION	
DEVELOPER	WOORONG PARK PTY LTD	Sydney WATER	
W.S.C.	QALCHEK PTY LTD		
CONSTRUCTOR	C.J. DOYLE PTY LTD	Case No. 190189PW	SHT 4 OF 5 SHTS.
COMPLETED	08.11.2022		
W.A.C. PREPARED	22.11.2022		
DESIGNER	QALCHEK PTY LTD	SYDNEY WATER CORPORATION	
I CERTIFY THAT THE WORKS HAVE BEEN CONSTRUCTED IN ACCORDANCE WITH THE WORK AS CONSTRUCTED DRAWINGS		FOR DETAILS OF SERVICES SEE SHEET 1	

No.	AMENDMENT DESCRIPTION	BY	DATE
1	WORK AS CONSTRUCTED	J.V.	22.11.22
5	TAPPING LOCATIONS AMENDED	FJ	07.10.21
B	ISSUE FOR APPROVAL	FJ	09.09.21
A	ISSUE FOR CLIENT REVIEW	FJ	03.05.21



CONTINUED ON SHEET 2

CONTINUED ON SHEET 3



PRECINCT	CASE NUMBER	DEPENDENCY	COMMENTS/STATUS
Abell Rd Stockland Precinct 6	171635	N/A	Completed, connected
Abell Rd Culvert Crossing	180445	N/A	Completed, connected
Precinct 5	180446	180445	Connected 21.06.2021
Abell Rd Stage 1	183893	180445, 180446	Design Endorsed by SWC
Winten Stage 7A	183455	18393, 180445, 180446	Under Construction
Winten Stage 7C	190658	180445, 183455, 18393, 180446	Design Endorsed by SWC
Winten Stage 7D	190986	180445, 183455, 18393, 180447, 190658, 191044, 191045	Design Endorsed by SWC
Winten Stage 7B	190189	180445, 183455, 18393, 180447, 190658, 191044, 191046, 190986	Current CN as of PW design (09.09.2021)
Abell Rd Stage 2	191044	18393, 180445, 180446	Design Submitted to SWC for Endorsement
Abell Rd Stage 3	191045	18393, 180445, 180446, 191044	Design Submitted to SWC for Endorsement
Abell Rd Stage 4	191046	18393, 180445, 180446, 191044, 191045	Design not started, Civil Construction Commencing December 2021, concluding September 2024
Stony Creek Rd Upgrade	169016	N/A	Completed, connected

No.	AMENDMENT DESCRIPTION	BY	DATE
1	WORK AS CONSTRUCTED	J.V.	22.11.22
C	5 TAPPING LOCATIONS AMENDED	FJ	07.10.21
B	ISSUE FOR APPROVAL	FJ	09.09.21
A	ISSUE FOR CLIENT REVIEW	FJ	03.05.21

WORK AS CONSTRUCTED CERTIFICATION		SYDNEY WATER CORPORATION	
DEVELOPER	WOORONG PARK PTY LTD	Sydney WATER	Case No. 190189PW SHT 5 OF 5 SHTS.
W.S.C.	QALCHEK PTY LTD		
CONSTRUCTOR	C.J. DOYLE PTY LTD	FOR DETAILS OF SERVICES SEE SHEET 1	
COMPLETED	08.11.2022		
W.A.C. PREPARED	22.11.2022	SYDNEY WATER CORPORATION	
DESIGNER	QALCHEK PTY LTD	I CERTIFY THAT THE WORKS HAVE BEEN CONSTRUCTED IN ACCORDANCE WITH THE WORK AS CONSTRUCTED DRAWINGS	