

- DESIGNER AND WATER SERVICING COORDINATOR:
QALCHEK PTY LTD (CERTIFIED No.289)
77 UNION RD. PENRITH NSW 2750
PH. No. (02) 4722 8181

FOR:
WOORONG PARK PTY LTD
c/o J WYNDHAM PRINCE
580 HIGH STREET, PENRITH, NSW, 2750
PHONE 02 4720 3341 (CHRIS MUDIE, PROJECT MANAGER JWP)
- THE WORKS AND MATERIALS ARE IN ACCORDANCE WITH THE WATER SUPPLY CODE OF AUSTRALIA (WSA 03-2011-3.1) INCLUDING THE SYDNEY WATER SUPPLEMENT (2014) AND APPENDICES.
- MAINS LAID GENERALLY 2.9m P.L. AT STANDARD DEPTH BELOW KERB INLET EXCEPT WHERE OTHERWISE SHOWN.
- ALL EXCAVATION, SHORING EXCAVATION AND STABILITY OF ADJACENT STRUCTURES/SERVICES/DWELLINGS WAS THE RESPONSIBILITY OF THE CONSTRUCTOR.
- PRECAUTIONS MAY BE NECESSARY IN THE VICINITY OF SUB-STATION EARTHING.
- ALL BUILDING LAYOUTS, FINISHED SURFACE LEVELS, STORMWATER INFORMATION, AND GENERAL CIVIL ENGINEERING DETAILS TAKEN FROM:
STORMWATER: P4 DETAILED ENGINEERING PLANS.PDF (PROVIDED BY JWP 22.11.2017)
CIVIL ENGINEERING: CENTRAL PRECINCTS CAD BASE 171103.DWG (PROVIDED BY JWP 03.11.2017)
LOT LAYOUT: CENTRAL PRECINCTS ROAD AND LOT BASE.DWG (PROVIDED BY JWP 30.10.2017)
SURFACE INFORMATION: CENTRAL PRECINCT 3D TRIANGLES 171205.DWG (PROVIDED BY JWP 06.12.2017)
- THE NUMBER OF FIELD COMPACTION TESTS CONDUCTED TO SATISFY THE WATER SUPPLY CODE OF AUSTRALIA ARE:

SAND/CEMENT BACKFILL USED AT ROAD CROSSINGS. (LETTER PROVIDED)

PIPE EMBEDMENT ZONE: 52 TESTS CONDUCTED

TRENCH FILL ZONE (TRAFFICABLE): 104 TESTS CONDUCTED

TRENCH FILL ZONE (NON TRAFFICABLE): 0 TESTS CONDUCTED (LETTER PROVIDED)

TRENCH FILL ZONE ERTY SERVICES: 0 TESTS CONDUCTED (LETTER PROVIDED)

TRENCH FILL ZONE - TOTAL: 156 TESTS CONDUCTED
- ALL PROPERTY (MAIN TO METER) SERVICES ARE CONSTRUCTED TO SYDNEY WATER'S INSTALLATION REQUIREMENTS BY A LICENSED PLUMBER AND ACCREDITED DRILLER. THE WORKS ARE INSTALLED IN ACCORDANCE WITH THE CURRENT SYDNEY WATER PROPERTY SERVICE (MAIN TO METER) INSTALLATIONS TECHNICAL REQUIREMENTS, NSW CODE OF PRACTICE FOR PLUMBING AND DRAINAGE, AND AS/NZ 3500.
- ALL SURFACE FITTINGS AND INDICATOR PLATES AT POINTS OF CONNECTION TO EXISTING SYSTEM WHERE FLUSHING BENDS ARE REMOVED WERE RECOVERED.
- THE WORKS ARE CONSTRUCTED IN ACCORDANCE WITH SYDNEY WATER'S DEEMED TO COMPLY DRAWINGS:
- FOR HORIZONTAL BENDS TYPE 2 DTC-1111 (ISSUE B 29.02.12)
- FOR TAPERS DTC-1112 (ISSUE B 29.02.12)
- FOR TEES DTC-1113 (ISSUE B 29.02.12)
- FOR VERTICAL BENDS & HYDRANT BENDS DTC-1114 (ISSUE A 31.01.12)

LOCALITY PLAN

(NOT TO SCALE)

0	WORK AS CONSTRUCTED	J.V.	11.02.19
B	ISSUE FOR APPROVAL	F.J.	17.03.18
A	DRAFT ISSUE FOR TENDER	F.J.	12.03.18
No.	AMENDMENT DESCRIPTION	BY	DATE

PLAN TO BE READ IN CONJUNCTION WITH CURRENT SYDNEY WATER STANDARDS SYDNEY WATER CORPORATION

PRIOR TO COMMENCEMENT OF EXCAVATION FOR PROPOSED AND EXISTING SERVICES CONTACT :-
DIAL BEFORE YOU DIG Ph. 1100
ELECTRICITY Ph.
GAS Ph.
TELECOMMUNICATIONS Ph.
SYDNEY WATER Ph. 132 092
GIVING AT LEAST 48 HOURS NOTICE.

UTILITIES			
TYPE	DATE	REF.	ENG. PLANS
STORMWATER: SMD	22.11.17		DESIGN
SEWER: S	13.03.18		DESIGN

WORK AS CONSTRUCTED CERTIFICATION			
DEVELOPER	WOORONG PARK PTY LTD		
WATER SERVICE CO-ORDINATOR	QALCHEK PTY LTD		
CONSTRUCTOR	C.J. DOYLE		
COMPLETED	30.11.2018	W.A.C. PREPARED	11.02.2019
DESIGNER	QALCHEK PTY LTD		
I CERTIFY THAT THE WORKS HAVE BEEN CONSTRUCTED IN ACCORDANCE WITH THE WORK AS CONSTRUCTED DRAWINGS.			

PIPE SCHEDULE				
SIZE DN	TYPE	CLASS	LENGTH	PIPE JOINING METHOD / NOTES
200	O.P.V.C.	PN16	329.0	RRJ
100	O.P.V.C.	PN16	2555.3	RRJ

SCALES	
PLAN	1:500
SECTION	HOR. : VERT. :
CROSS SECTIONS NATURAL
LENGTHS, DEPTHS & LEVELS ARE IN METRES.	

NO AMENDMENTS ARE TO BE MADE TO THIS PLAN WITHOUT REFERENCE TO SYDNEY WATER. THIS PLAN IS NOT NECESSARILY UP TO DATE OR CORRECT AND SYDNEY WATER ACCEPTS NO RESPONSIBILITY.

U.B. DIRECTORY MAP 126 A/16 45th EDITION

SHEET . 1 . OF . 4 File No. N/A

Sydney WATER SYDNEY WATER CORPORATION

Case No. 167855PW

WATERMAIN EXTENSION
ELARA BV & OTHERS
MARSDEN PARK BLACKTOWN



SEE SHEET '4' FOR CONTINUATION

SEE SHEET '3' FOR CONTINUATION

No.	AMENDMENT DESCRIPTION	BY	DATE
0	WORK AS CREATED	J.V.	11.02.19
B	ISSUE FOR APPROVAL	F.J.	17.03.18
A	DRAFT ISSUE FOR TENDER	F.J.	12.03.18

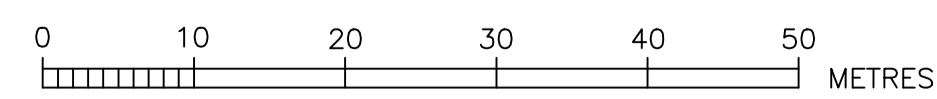

- ⊘ EASEMENT FOR ACCESS AND MAINTENANCE 0.9 WIDE
- EASEMENT TO DRAIN WATER 0.9 WIDE
- * DRIVEWAY

WORK AS CREATED CERTIFICATION		Sydney WATER	
DEVELOPER	WOORONG PARK PTY LTD	SYDNEY WATER CORPORATION	
W.S.C.	QALCHEK PTY LTD	Case No. 167855PW SHT 2 OF 4 SHTS.	
CONSTRUCTOR	C.J. DOYLE		
COMPLETED	30.11.2018		
W.A.C. PREPARED	11.02.2019		
DESIGNER	QALCHEK PTY LTD	SYDNEY WATER CORPORATION	
I CERTIFY THAT THE WORKS HAVE BEEN CONSTRUCTED IN ACCORDANCE WITH THE WORK AS CREATED DRAWINGS		FOR DETAILS OF SERVICES SEE SHEET 1	

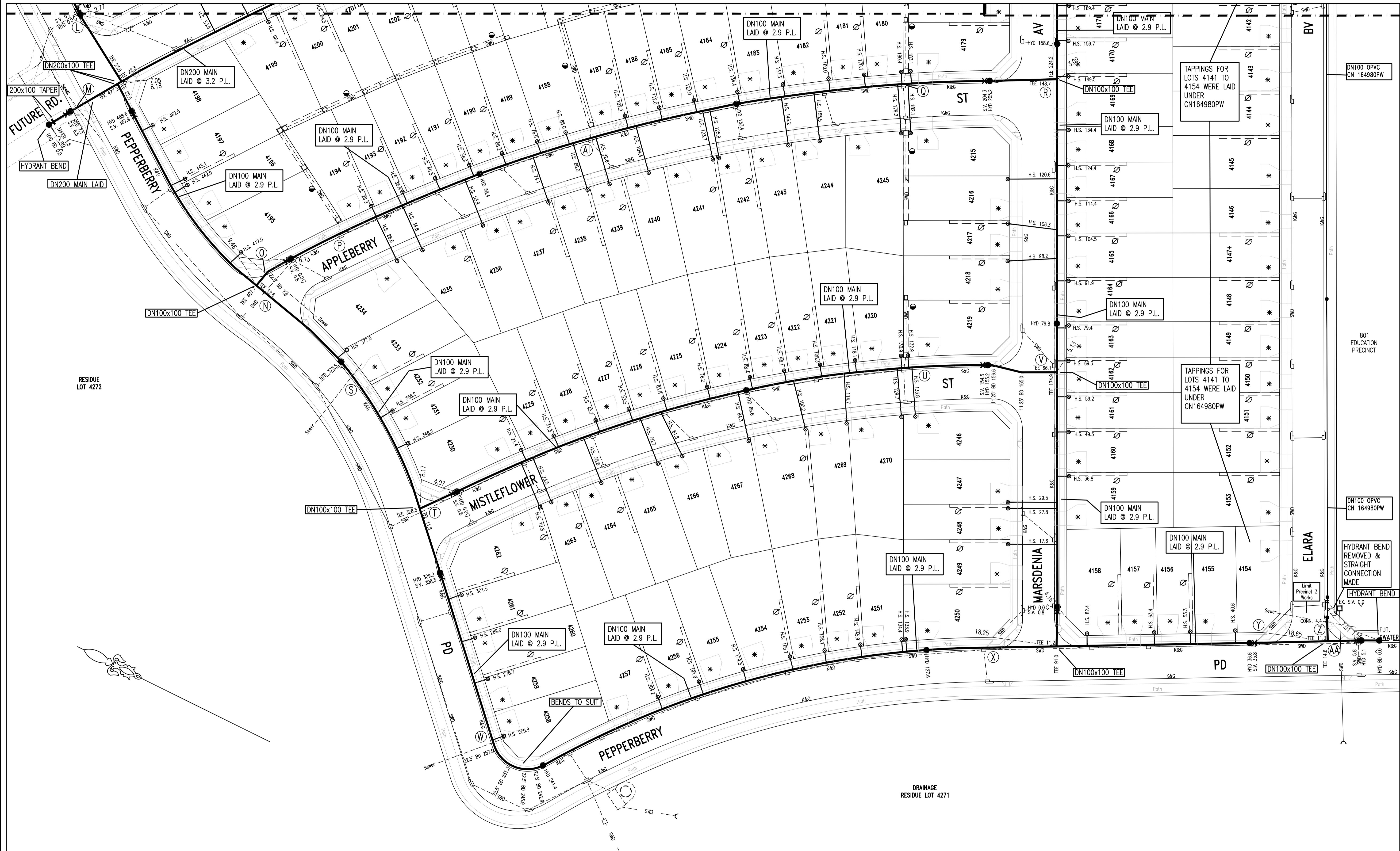

0	WORK AS CONSTRUCTED	J.V.	11.02.19
B	ISSUE FOR APPROVAL	F.J.	17.03.18
A	DRAFT ISSUE FOR TENDER	F.J.	12.03.18
No.	AMENDMENT DESCRIPTION	BY	DATE

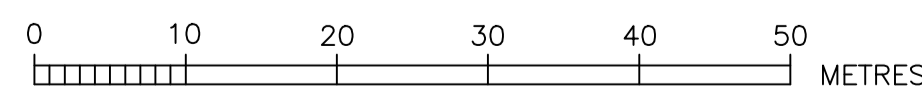

- ⊙ EASEMENT FOR ACCESS AND MAINTENANCE 0.9 WIDE
- EASEMENT TO DRAIN WATER 0.9 WIDE
- * DRIVEWAY

WORK AS CONSTRUCTED CERTIFICATION		SYDNEY WATER CORPORATION	
DEVELOPER	WOORONG PARK PTY LTD	Sydney WATER	Case No. 167855PW SHT 3 OF 4 SHTS.
W.S.C.	QALCHEK PTY LTD		
CONSTRUCTOR	C.J. DOYLE		
COMPLETED	30.11.2018	SYDNEY WATER CORPORATION	
W.A.C. PREPARED	11.02.2019	FOR DETAILS OF SERVICES SEE SHEET 1	
DESIGNER	QALCHEK PTY LTD	I CERTIFY THAT THE WORKS HAVE BEEN CONSTRUCTED IN ACCORDANCE WITH THE WORK AS CONSTRUCTED DRAWINGS	

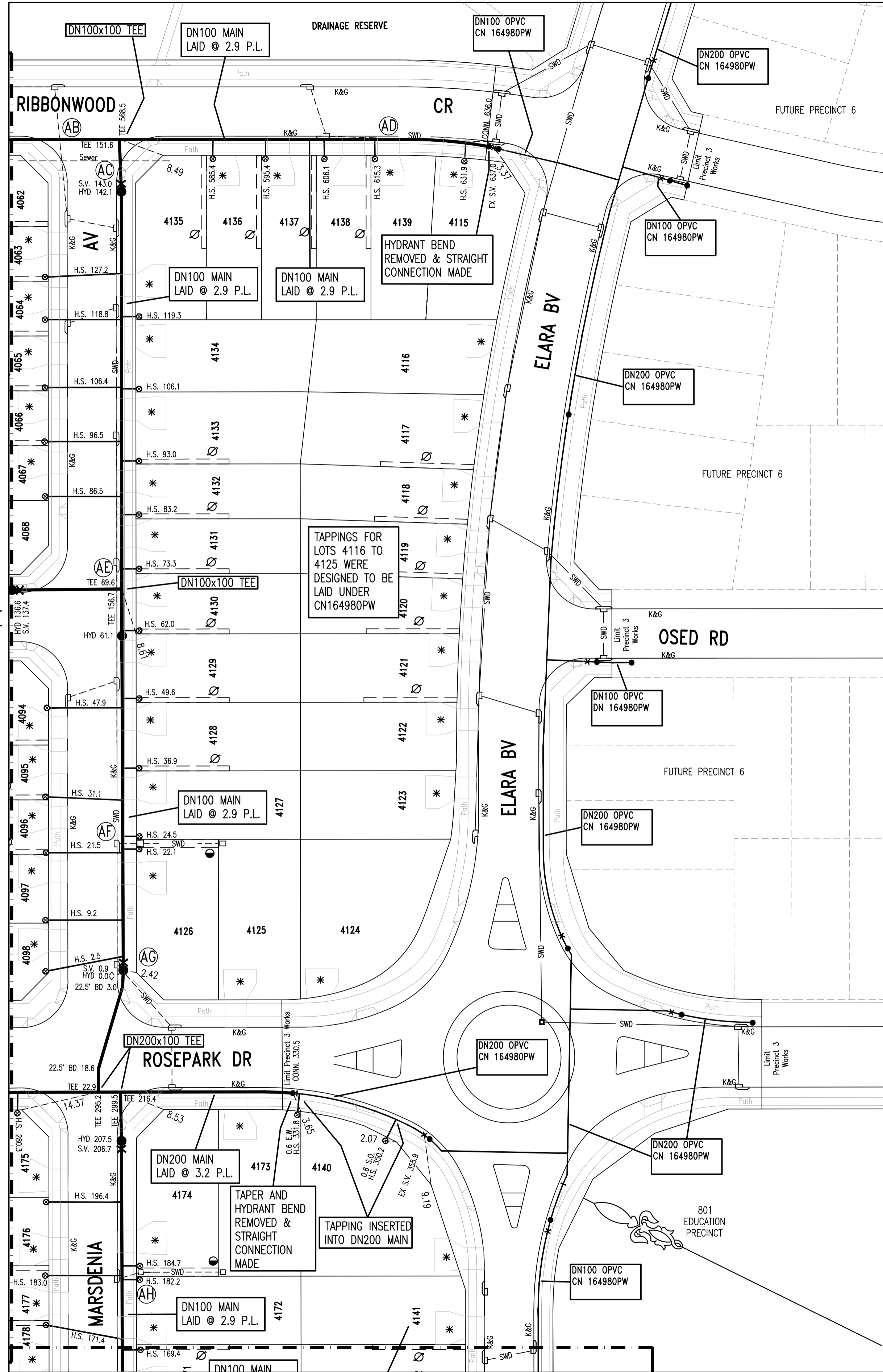

SEE SHEET '2' FOR CONTINUATION

SEE SHEET '3' FOR CONTINUATION

0	WORK AS CONSTRUCTED	J.V.	11.02.19
B	ISSUE FOR APPROVAL	F.J.	17.03.18
A	DRAFT ISSUE FOR TENDER	F.J.	12.03.18
No.	AMENDMENT DESCRIPTION	BY	DATE

- ⊙ EASEMENT FOR ACCESS AND MAINTENANCE 0.9 WIDE
- ⊙ EASEMENT TO DRAIN WATER 0.9 WIDE
- * DRIVEWAY

SERVICES CROSSING TABLE SHEET 2 - MAIN LAID OVER UNLESS NOTED OTHERWISE

CROSSING	SERVICE	SERVICE SIZE	PW SIZE	SERVICE COVER (m)	PW COVER (m)	CLEARANCE (m)	REFER TO DTC DRAWING No.
'A'	Sewer	DN225	DN100	4.50	0.75	3.65	N/A
'B'	Sewer	DN225	DN100	4.28	0.75	3.43	N/A
'C'	SWD	DN1050	DN100	1.91	0.75	1.06	N/A
'D'	SWD	DN900	DN100	2.81	0.75	1.96	N/A
'E'	Sewer	DN225	DN100	3.60	0.75	2.75	N/A
'F'	SWD	DN225	DN100	1.06	0.75	0.21	N/A
'G'	SWD	DN450	DN100	1.43	0.75	0.58	N/A
'H'	SWD	DN900	DN100	1.19	0.75	0.39	N/A
'I'	SWD	DN225	DN100	1.09	0.75	0.24	N/A
'J'	SWD	DN225	DN100	1.09	0.75	0.24	N/A

SERVICES CROSSING TABLE SHEET 3 - MAIN LAID OVER UNLESS NOTED OTHERWISE

CROSSING	SERVICE	SERVICE SIZE	PW SIZE	SERVICE COVER (m)	PW COVER (m)	CLEARANCE (m)	REFER TO DTC DRAWING No.
'K'	SWD	DN225	DN100	1.09	0.75	0.24	N/A
'L'	SWD	DN375	DN100	1.09	0.75	0.24	N/A
'M'	Sewer	DN450	DN200	8.84	0.75	7.89	N/A
'N'	SWD	DN825	DN100	1.10	0.75	0.30	N/A
'O'	Sewer	DN150	DN100	2.85	0.75	2.00	N/A
'P'	SWD	DN375	DN100	1.07	0.75	0.22	N/A
'Q'	SWD	DN225	DN100	0.94	0.69	0.15	EASE OVER SWD
'R'	SWD	DN375	DN100	1.16	0.75	0.31	N/A
'S'	Sewer	DN150	DN100	3.21	0.75	2.36	N/A
'T'	SWD	DN600	DN100	1.45	0.75	0.60	N/A
'U'	SWD	DN225	DN100	1.08	0.75	0.23	N/A
'V'	SWD	DN375	DN100	1.24	0.75	0.39	N/A
'W'	Sewer	DN150	DN100	4.30	0.75	3.45	N/A
'X'	SWD	DN450	DN100	1.52	0.75	0.67	N/A
'Y'	SWD	DN600	DN100	1.46	0.75	0.61	N/A
'Z'	Sewer	DN150	DN100	3.30	0.75	2.45	N/A
'AA'	SWD	DN825	DN100	1.88	0.75	1.03	N/A
'AI'	SWD	DN375	DN100	0.78	0.50	0.15	EASE OVER SWD

SERVICES CROSSING TABLE SHEET 4 - MAIN LAID OVER UNLESS NOTED OTHERWISE

CROSSING	SERVICE	SERVICE SIZE	PW SIZE	SERVICE COVER (m)	PW COVER (m)	CLEARANCE (m)	REFER TO DTC DRAWING No.
'AB'	SWD	DN450	DN100	2.08	0.75	1.23	N/A
'AC'	Sewer	DN225	DN100	4.00	0.75	3.15	N/A
'AD'	SWD	DN375	DN100	1.28	0.75	0.43	N/A
'AE'	SWD	DN375	DN100	1.39	0.75	0.54	N/A
'AF'	SWD	DN375	DN100	1.09	0.75	0.24	N/A
'AG'	SWD	DN375	DN100	1.15	0.75	0.30	N/A
'AH'	SWD	DN375	DN100	1.08	0.75	0.23	N/A

PLAN DRAWN DATE: 11.02.2019 VERSION: 0 SHEET 4 OF 4 SHEETS

WORK AS CONSTRUCTED CERTIFICATION		SYDNEY WATER CORPORATION	
DEVELOPER	WOORONG PARK PTY LTD	Sydney WATER	Case No. 167855PW SHT 4 OF 4 SHTS.
W.S.C.	QALCHEK PTY LTD		
CONSTRUCTOR	C.J. DOYLE	DESIGNER: QALCHEK PTY LTD	
COMPLETED	30.11.2018	I CERTIFY THAT THE WORKS HAVE BEEN CONSTRUCTED IN ACCORDANCE WITH THE WORK AS CONSTRUCTED DRAWINGS	
W.A.C. PREPARED	11.02.2019	FOR DETAILS OF SERVICES SEE SHEET 1	
DESIGNER: QALCHEK PTY LTD		SYDNEY WATER CORPORATION	