

LEGEND

- Existing Underground Cables,
- Existing Conduits (Ducts),
- Proposed New Conduits (Ducts),
- Street Light Trenching
- Low Voltage Trenching
- High Voltage Trenching
- Lay 40mm P.V.C. Service Conduits
- Existing Service Mains
- Pillar Excavation Location,
- Existing Pillar,
- Proposed Column Excavation location
- 4.5m Enlarged Base Column & 3.0m Eden Outreach
- Type 2 Ragbolt (Type 2 Footing)
- Colour Powdercoated Black
- Existing Column,
- Proposed New Streetlight Lantern,
- ⊗ Existing Streetlight Lantern,
- ⊗ Proposed New Padmount Substation,
- ⊗ Existing Padmount Substation,
- ⊙ Point Indicator,
- Lot Less Than 350m2 (ADMD 5.0kVA/Lot).

Trench Length

High Voltage Trenching	240m
Low Voltage Trenching	408m
Street Light Trenching	0m
Road Crossing	72m
Total	720m

Funding Arrangements for Scope of Works

ASP Level 1 Electrical Works			Customer		
Endeavour Energy Supplied Materials			Customer Funded		
NIL			Customer Funded		
Endeavour Energy Funded & Constructed			Customer Funded Contestable Works		
Works Required Prior to Completion of Customer Contestable Project			Works Required in Association of Customer Contestable Project		
NIL			NIL		
Endeavour Energy Funded & Level 1 ASP Constructed - Reimbursement (excl GST)			Customer Funded Contestable Works		
Item			Amount		
1x 500kVA (11000-433V) PMS Trfs			\$12 576.00		
Total EE Capital Contribution (excl. PM & Design)			\$12 576.00		
Total EE Capital Contribution (HV reimbursement)			\$13 796.00		

DIAL BEFORE YOU DIG

Ref: 31901682 Date: 05 May, 2022
 DBYD searches indicates the presence of services within the proposed work-site. The Level 1 ASP /Constructor is to confirm the location of "all" services prior to the commencement of works.

Painting of Columns
 Local council requires a certificate from the manufacturer supplied confirming the power coated columns are in accordance with the requirements of AS/NZ 4506-2005.

Caution
 Existing live electrical assets located in this vicinity, appropriate safety precautions must be utilized.

Caution
 High Pressure Gas Assets in this area, constructor to contact Jeremia on ph 1300 665 380 prior to the commencement of works.

Caution
 Telstra assets in this area, Constructor to contact Telstra on ph 1800 653 935 prior to the commencement of works.

Pollution
 Requirements of the environmental protection authority pollution control legislation is to be strictly adhered to.

Final Ground Level
 The constructor is to confirm finished ground level with the developer prior to the commencement of construction.

Construction of this Project
 This Project will require the completion of:
 • Stage 7D (URS25542) Dwgs 522560A & 522559A,
 • Stage 7E (URS25734) Dwgs 526343A & 526342A.

Testing and Commissioning
 All required testing in accordance with SDI 120 must be performed in strict accordance with the standard.

Establish Proposed PMS No. 95589

- Transformer: 500kVA (11000-433V),
- HV Switchgear: ABB Safelink, Type: "RTR",
- HV Fuses: 12kV, 50Amp (Full Range),
- LV Switchgear: Weber CAT 1, Config: "FFIFF",
- LV Fuses: LV 250A (DIN, size 2)
- Cubicle: Size 14,
- Earthing: Common (refer Earth Design).

SAP Data Sub 95585

HV BusBar	19188
Trf	10003908
LV BusBar	36931

KEY DOCUMENTS TABLE

The Certification of this project is supported by the following key documents

Document Name	Notation Date
Summary Environmental Report - FAT0038 (EMS0001)	13 May, 2022
Safe Design Report	13 May, 2022

This Drawing Supplies 62 Lots (Subdivision of Proposed Lot 8384)

C.A.P. No.	Lot Numbers	No. of Lots	Developer	Developers Representative	Contact No.
URS25735	Lot 8401 to 8462	62	Woorong Park Pty Limited	Briony Traish / Tana Sainsbury (J. Wyndham Prince)	(02) 4720 3319

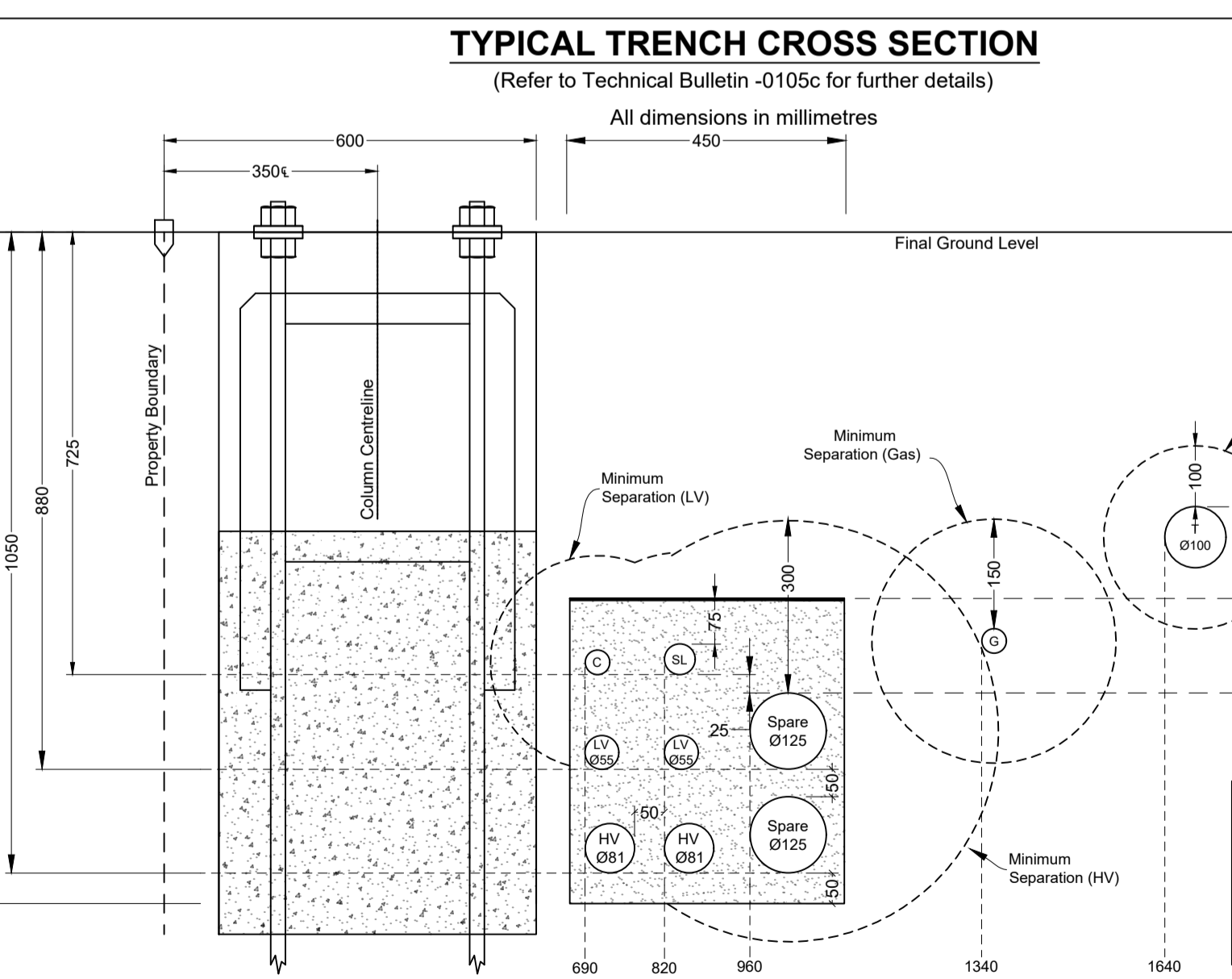

Certified by Endeavour Energy

Amendment: _____
 Date Approved: _____
 Examiner's Signature: _____
 Print Name: _____

This Certification is issued subject to Endeavour Energy's Standard Certification Terms.

APPROVAL TO CONNECT TO PUBLIC LIGHTING

Reviewers Name: _____
 Date Approved: _____
 Reviewers Signature: _____

This Approval is issued subject to Endeavour Energy's General Terms & Conditions for Connection of Public Lighting and is specifically for drawing No. _____ Amendment _____.

Authorisation of Estimate Value of Endeavour Energy Funded Assets

Signed: _____
 Print Name: _____
 Service Number: _____
 Funding Amount: \$ _____
 Date: _____

WORK COMPLETED / FIELD BOOK

CONSTRUCTED BY: **C.J. DOYLE CONTRACTING**
 WORKS COMPLETED: **CHRIS JOWETT**
 SIGNATURE: **C.J. JOWETT** DATE: **26/09/23**

INSPECTED BY: **GAVIN NIXON**
 SIGNATURE: _____ DATE: _____

ASSET RECORDING

I, **STEVE FRIDAY**
 OF **C.J. DOYLE CONTRACTING**
 CONTACT No. **8784-1922**
 HEREBY CERTIFY THAT ASSETS MARKED AS-BUILT ON THIS DRAWING HAVE BEEN RECORDED AS PER ENDEAVOUR ENERGY STANDARD SAD 0004.
 SIGNATURE: **STEVE FRIDAY** DATE: **26/09/23**

NOTE:
 THE SURVEY IN THIS DRAWING HAS BEEN CONDUCTED IN GDA2020.

Design Compliance and Indemnity

This design complies with Endeavour Energy's relevant standards as current at this time & as listed on the Endeavour Energy Accredited Service Provider's internet site. These standards include, but are not limited to:

- CP: Connection Policy,
- EMS: Environmental Management Standard,
- MCI: Mains Construction Instruction,
- MDI: Mains Design Instruction,
- FDI: Protection Design Instruction,
- SDI: Substation Design Instruction,
- SAD: Design Drawing Standard,
- MMI: Mains Maintenance Instruction,
- SMI: Substation Maintenance Instruction,
- LDI: Public Lighting Electrical Design Element.

Additionally, where relevant, the design complies with AS/NZS7000 "Overhead Line Design - Detailed Procedures" published by The Australian Standards.

Power Line Design Pty Ltd indemnifies Endeavour Energy for any loss or damage resulting from non-compliance of the design with the above standards.

Signed: **Mike Baranowski**
 Name: **Michael | Baranowski**
 Service Provider Number: **2486** Date: **11-07-2022**

WAE LEGEND

- PVC DUCTS (TRENCH)
- PVC DUCTS (UNDERBORE)
- ⊙ QUALITY LEVEL DATA POINT
- PL PROPERTY LINE
- DE DUCT END
- UB UNDERBORE END

WAE NOTES

- ONLY CHANGES MARKED UP IN RED FORM ARE PART OF THIS ASSET RECORDING.
- ALL SURFACE ASSETS WERE RECORDED AT LEVEL QUALITY 'C'.
- DUCT TABLE HAS BEEN AMENDED AS PER INSPECTION. REFER TO DUCT SCHEDULE FOR DETAILS.

Notes

- This drawing is to be read in conjunction with the relevant Endeavour Energy Network Standards and Connection Policy.
- Endeavour Energy Contact Phone: 131081.
- Design certification shall lapse where:
 (i) notice of intent has not been received within six (6) months of this certification, or
 (ii) construction has been interrupted for more than six (6) months.
 where design certification has lapsed the design must be resubmitted for certification by the accredited designer.
- Accredited Service Provider to notify Endeavour Energy asset data customer department daily when cable works is in progress. (ph. 131 081).
- ATTENTION:**
 Permanent survey marks may exist in this area, these are to be located by a surveyor prior to commencement of work.
- ATTENTION:**
 All services searches must be checked before construction.
- ATTENTION:**
 The preparation of this design has been undertaken giving due consideration to the location of existing services. The Constructor is however responsible for the verification of services and permanent survey marks prior to the commencement of construction. No responsibility nor liability will be accepted by the designer for damage to existing services as a result of this design.
- WARNING:**
 Live Endeavour Energy cables & other services in this area.
 Please contact "Dial Before You Dig" for information: 1100 for searches two days prior to excavation.
- Material Quantities Specified on this Design:**
 The quantities or dimensions specified on this design are based on design information supplied and site conditions at the time of the design. As quantities and dimensions are subject to change, the Constructor must check all quantities and dimensions on site prior to tendering and prior to construction.
- Reimbursements:**
 Reimbursements will be paid to the nominated party on the letter of intent after the works have been completed and the letter of acceptance has been issued. The reimbursed amount is shown in the "Funding Arrangements for Scope of Work Table". Any disagreement with the amount should be resolved with Endeavour energy prior to the commencement of works.
- Operational Limitations:**
 Unless approved otherwise, interruption to any customer's supply must be avoided. The following alternatives should be considered:
 • mobile generators and substations,
 • live line work,
 • design alternatives,
 • low voltage parallels,
 • work practices/standards.
 The cost is to be funded by the customer/developer.
- Environmental Management plan:**
 EMP EMS0001 is part of this design (refer to EIA for details).
- Pollution Controls:**
 All the requirements of the Environmental Protection Authority pollution control legislation is to be strictly adhered to.
- Aboriginal Heritage:**
 If during construction of this project the constructor or developer becomes aware of any previously unidentified Aboriginal Object(s), all work likely to affect the object(s) shall cease immediately, and the Office of Environment & Heritage shall be notified immediately in accordance with section 89a of the National Parks & Wildlife ACT 1974. Works shall not recommence until written authorization from the NSW Office of Environment and Heritage has been issued, in addition to written consent from the local aboriginal land council.
- Heritage:**
 If during construction of this project the constructor or developer becomes aware of any previously unidentified heritage object(s), all work likely to affect the object(s) shall cease immediately, and the Heritage Council of NSW shall be notified immediately in accordance with Section 146 of the Heritage ACT1977. Works shall not recommence until written authorization from the heritage council has been issued.
- Telecommunications:**
 Telecommunications assets are **NOT** effected by the proposed works.
- Existing Assets:**
 Have all the existing assets been field checked and are accurate at the time of design? **YES**

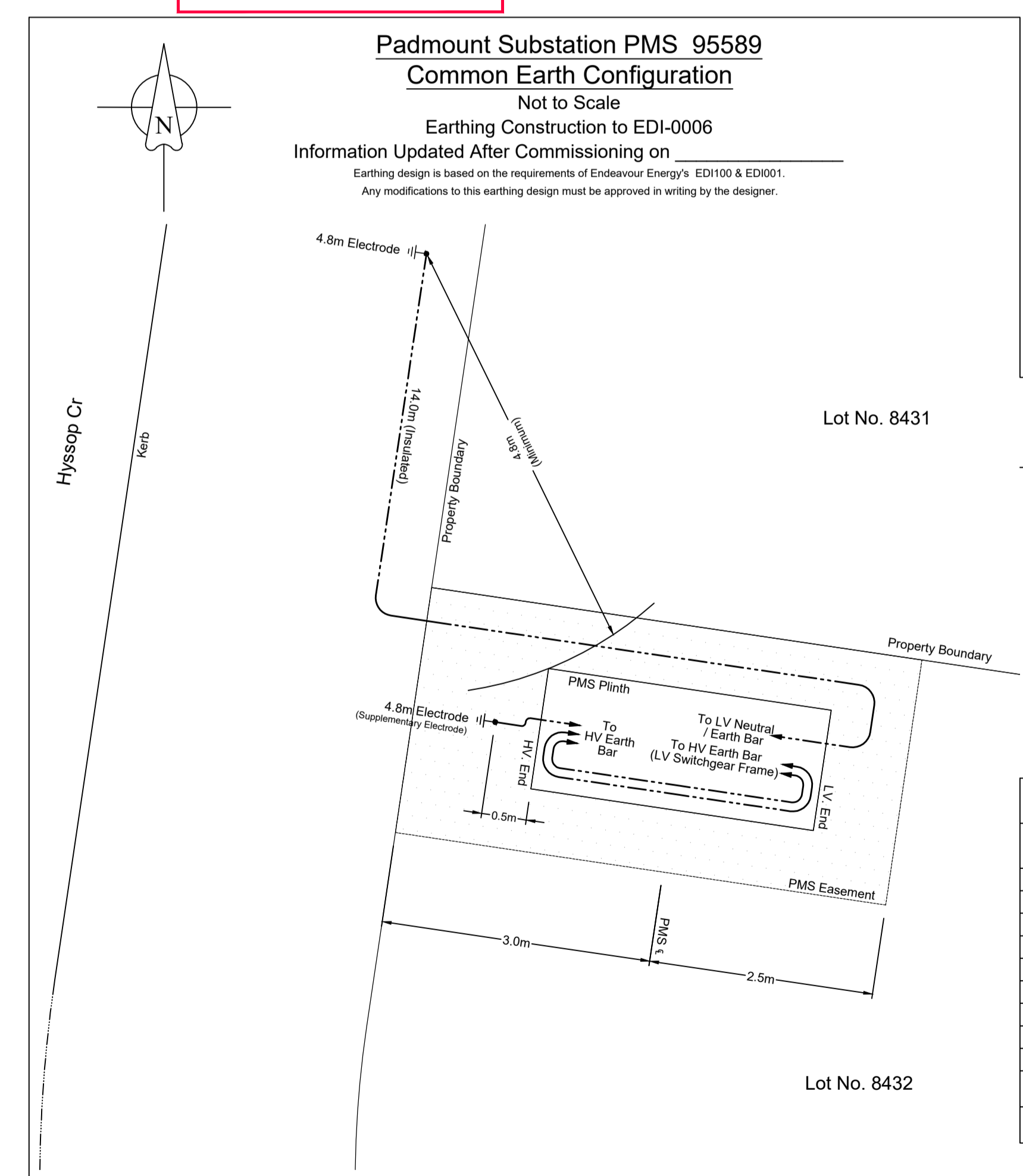

LEGEND

- 19/2.14 (70mm²) Insulated PVC/PVC Annealed Cu Cable
- ⊙ Earth Electrode Location & Length (Length of bare electrode shown in meters)

HV Earth Minimum Separation

	Design	Actual	Telco	Design	Actual
TDMEN	0.0m	>5.0m	0.0m	>5.0m	>5.0m
TDB	0.0m	>5.0m	Pipes	0.0m	>5.0m
TDU	0.0m	>5.0m	HV - LV	4.8m	4.8m

EARTHING DETAILS

Soil Resistivity (Ohms.m)	Layer 1		Depth (m)	5.97m
	28.17 Ω	16.0Ω		
Design Earth Resistance (Ohms)				6.4Ω
Measured Earth Resistance (Ohms)				5.55
Number of Electrodes (Excluding Supplementary Electrodes)				1
Length of Bare Electrode (m)				4.8
Insulated Depth (m)				0.6
Connector Type (CAD or CRIMP)				Crimp
Location Category (F-frequented, R-remote, S-special)				F
What Design Tools Used?				3E
HV Fault Level (kA)				1.82kA
Is this the first Asset from Zone Substation? (If Yes, check Z/S Earthing Configuration)				N
Are Cable Screens of Incoming Cable Bonded to Distribution Substation Earth Bar?				Yes

AMENDMENTS	ORIGINAL ISSUE	DRAFT No. 01	powerlinedesign	POWER LINE DESIGN PTY LTD PO BOX 338 Mittagong NSW 2575 Ph (02) 4872 1920 Fax (02) 4872 1240 Accredited Designer Number 0268 / ABN: 33107 591 846	The preparation of this design has been undertaken giving due consideration to the existing services. The project constructor is wholly responsible for verifying the exact location of existing services and permanent survey marks prior to commencing construction. No responsibility or liability will be accepted by the designer of this project for damage to existing services as a result of this design.	PLD Ref: 3866	Reference Drawings	Work Orders	CAMS File No.	URS25735	ORIGINAL SCALE 1:1000	DO NOT SCALE	Off Richmond Road MARSDEN PARK URS25735 Stage 7F	Endeavour Energy	A1	526363	A	SHEET No 1 OF 4 SHEETS

Final HV Circuit

Not to Scale
11kV Area

South Marsden Park ZS
Reference: (Q-9)
Feeder: MS1162 "Northborne Dr"
1φ Fault level @ SUB 54759: 5.25kA

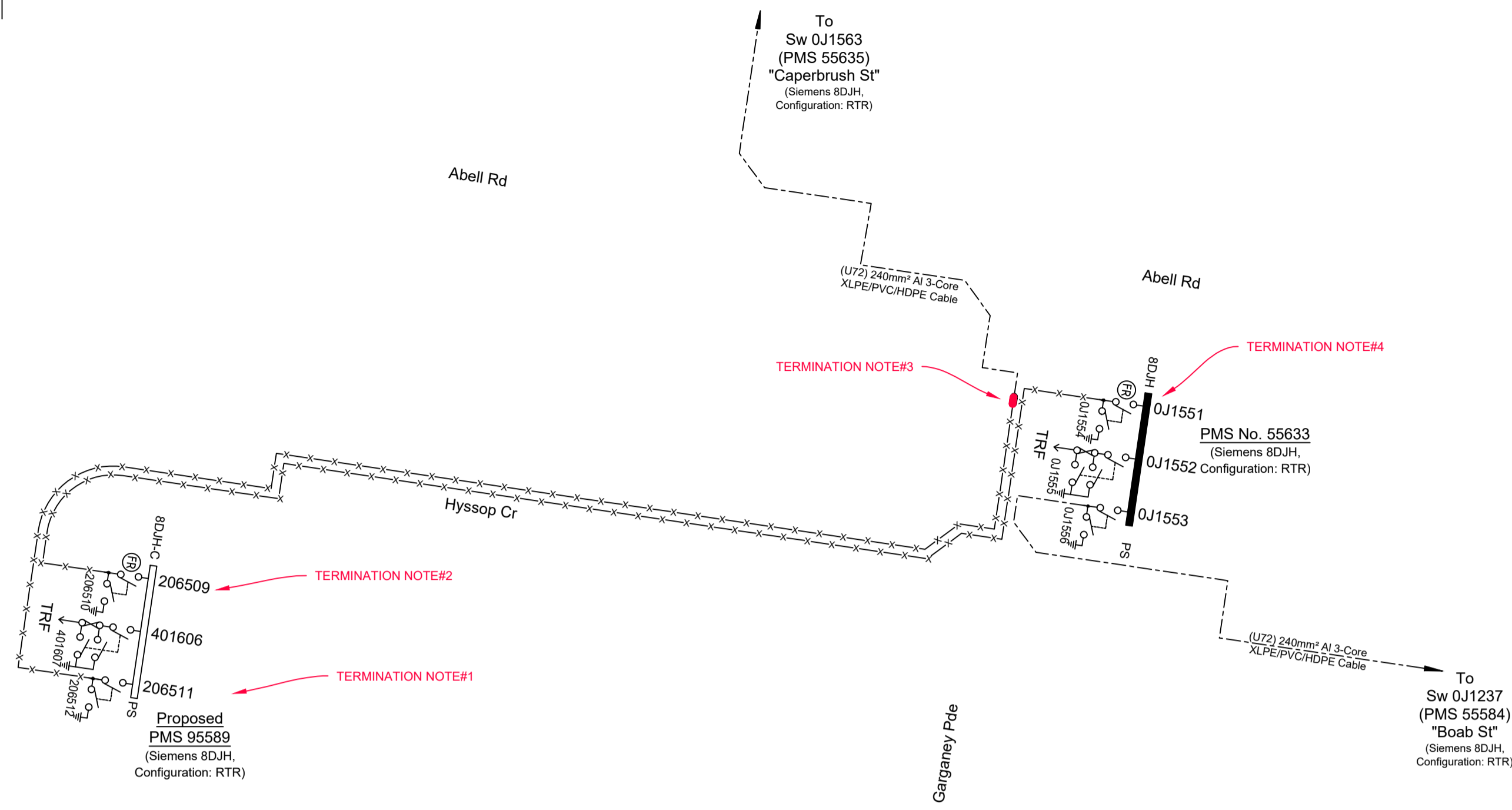

LEGEND

- Existing Underground Cables/
- Install 11kV 240mm² Al 3-Core XLPE/PVC/HDPE Cable (U72)
R.L. 558m, C.L. 586m.
- Straight Through Joint (STJ)

TERMINATION NOTE #1

JOINT/TERMINATION TYPE: INDOOR TERMINATION
NETWORK ACCESS AUTHORITY: 1358
JOINT/TERMINATION KIT #: RSTI-5855
JOINT/TERMINATION BATCH #: CM0013-001
DATE OF MANUFACTURE: 04/02/22

TERMINATION NOTE #3

JOINT/TERMINATION TYPE: HV STJ
NETWORK ACCESS AUTHORITY: 1358
JOINT/TERMINATION KIT #: MXSU-P101
JOINT/TERMINATION BATCH #: C22315-000
DATE OF MANUFACTURE: 20/07/21

TERMINATION NOTE #2

JOINT/TERMINATION TYPE: INDOOR TERMINATION
NETWORK ACCESS AUTHORITY: 1358
JOINT/TERMINATION KIT #: RSTI-5855
JOINT/TERMINATION BATCH #: CM0013-001
DATE OF MANUFACTURE: 04/02/22

TERMINATION NOTE #4

JOINT/TERMINATION TYPE: INDOOR TERMINATION
NETWORK ACCESS AUTHORITY: 1358
JOINT/TERMINATION KIT #: RSTI-5855
JOINT/TERMINATION BATCH #: CM0013-001
DATE OF MANUFACTURE: 04/02/22

Certified by Endeavour Energy

Amendment: _____
Date Approved: _____
Examiner's Signature: _____
Print Name: _____

This Certification is issued subject to Endeavour Energy's Standard Certification Terms.



The preparation of this design has been undertaken giving due consideration to the existing services. The project contractor is wholly responsible for verifying the exact location of existing services and permanent survey marks prior to commencing construction. No responsibility or liability will be accepted by the designer of this project for damage to existing services as a result of this design.

PLD Ref: 3866

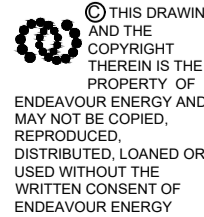

THIS DRAWING AND THE COPYRIGHT THEREIN IS THE PROPERTY OF ENDEAVOUR ENERGY AND MAY NOT BE COPIED, REPRODUCED, DISTRIBUTED, LOANED OR USED WITHOUT THE WRITTEN CONSENT OF ENDEAVOUR ENERGY.

Reference Drawings	Work Orders	CAMS File No.
526360A	General	URS25735
URS25735 Duct Trench and Easement	Overhead	
	Underground	
	Substations	

AM Project No.	EE Depot	EE Region	HV OP Diagram	Local Government Area
	Glendenning	Northern	Marsden Park	Blacktown City

ORIGINAL SCALE	DO NOT SCALE
1:1000	Dimensions in Meters
Drawn: Michael J.B	Design: Michael J.B
Date: 11-07-2022	
Ch'd: Michael J.B	

Off Richmond Road	Off Garganey Pde
MARSDEN PARK	MARSDEN PARK
URS25735	URS25735
Stage 7F	Stage 7F

Electrical Reticulation

Sheet No	Of	Total Sheets
A1	2	4

Project No
526363

Scale
A

Endeavour Energy

Project No
526363

Sheet No	Of	Total Sheets
A1	2	4

Final LV Circuit

Not to Scale

New Labels PM Sub. 95585

'R' - Pillar 402614	206413
'S' - Pillar 402613	206414
'T' - Transformer	401608
'U' - Pillar 402612	206415
'V' - Spare (N/O)	206416
'G' - Generator Fuse Strip	206417

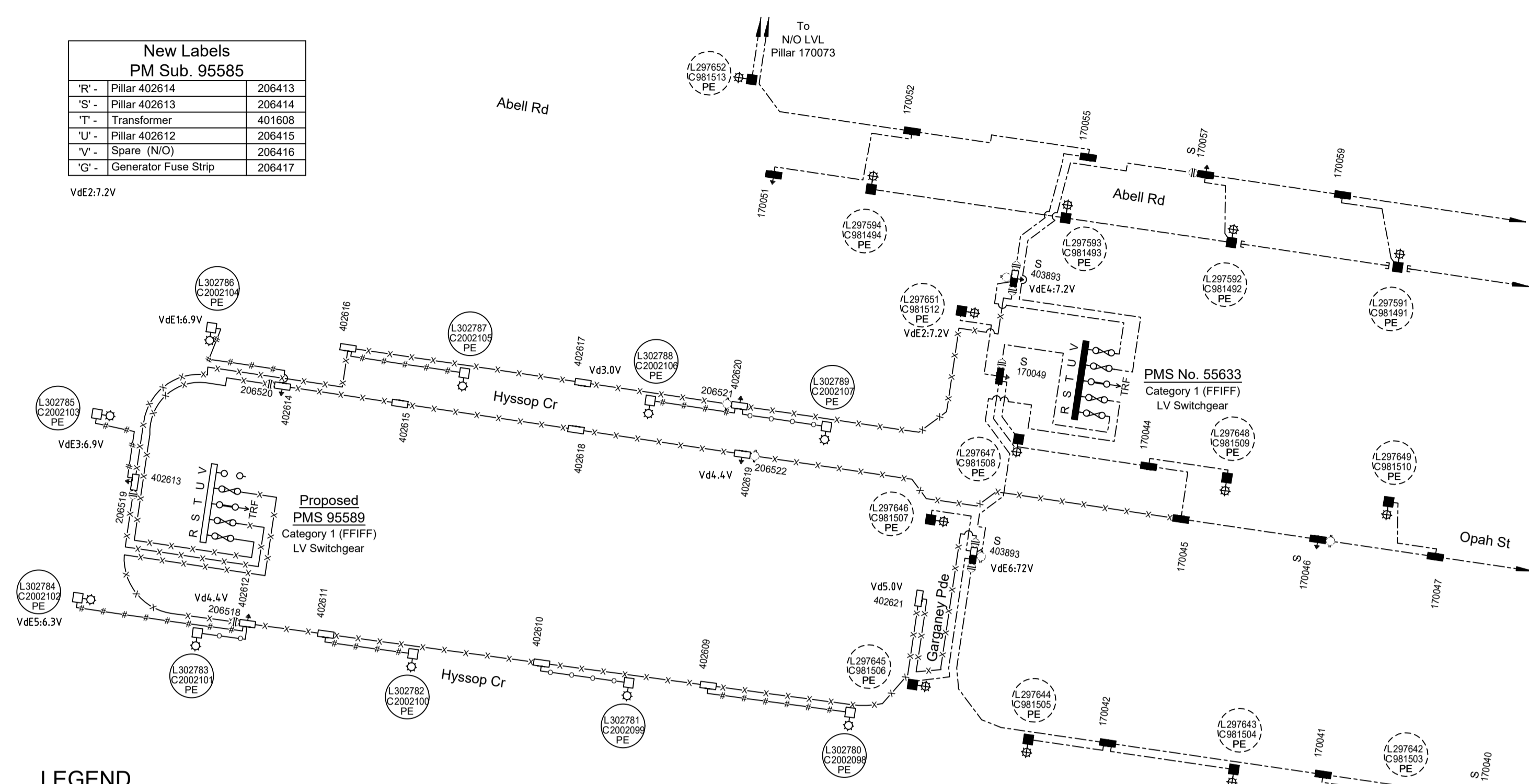

LEGEND

- Existing Underground Cables/
- Install 240mm² Al 4-Core XLPE/PVC Cable (T84)
R.L. 935m, C.L. 1005m.
- Install 50mm² Cu 4-Core XLPE/PVC Cable (T94)
R.L. 233m, C.L. 251m.
- Install 1x 16mm² Cu 2-Core XLPE/PVC Cable
In 50mm Conduit and a Spare 50mm Conduit.
R.L. 65m, C.L. 72m.
- LV Isolation Switch/Links (N/O)
- LV Isolation Switch/Links (N/C)
- Pillar Earth
- Proposed New Street Light Lantern - 17W StreetLED
- End Cap (E.C.)
- Lantern Number - Proposed Asset
Column Number - Proposed Asset
(PE Controlled)
- Lantern Number - Existing Asset
Column Number - Existing Asset
(PE Controlled)

Pillar 403893 (170043) Linking Diagram

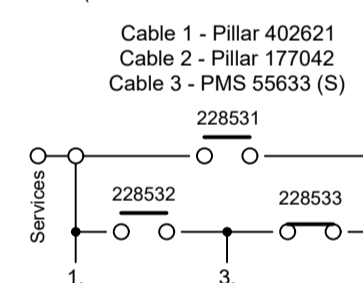

Pillar 403894 (170050) Linking Diagram

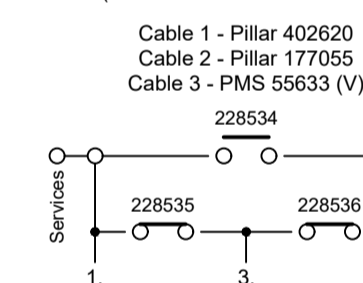

Pillars 170043 & 170050
Existing Pillars 170043 & 170050 to be replaced with new Pillars 403893 & 403894 fitted with 3 Links Switchgear.

Legend for LV Voltage Drop

Voltage Drop Calculations Based on an ADMD of 5kVA/lot for lots less than 350m², and 6.5kVA/lot for lots 350m² and greater.
Vd = Voltage drop for normal supply @ 100% ADMD
Emergency / backup voltage drop @ 60% of ADMD

	Supply Sub (Fuse Strip)	Backed Up Sub (Fuse Strip)
VdE1	PMS 95589(R)	PMS 55633 (R)
VdE2	PMS 55633 (R)	PMS 95589(R)
VdE3	PMS 95589(S)	PMS 55633 (V)
VdE4	PMS 55633 (V)	PMS 95589(S)
VdE5	PMS 95589(U)	PMS 55633 (S)
VdE6	PMS 55633 (S)	PMS 95589(U)

Lighting Equipment & Billing Schedule

State	Luminaire Number	Support Number	Luminaire				Column / Pole				Outreach / Bracket				Upcast Angle	Category	Mounting Height	Column Colour	Charge To	
			Description	Part No.	Rate Code	QTY	Description	Part No.	Footing Bolt / Foundation	Rate Code	QTY	Description	Part No.	Rate Code						QTY
New	302780 - 302789	2002089 - 2002107	17W StreetLED (Gerard)	JLB99G05L17	889	10	4.5m Enlarged Base Column	IE/4.5.EB	Type 2 / Type 2 (<9.0m)	995	10	3.0m Curved Pipe Outreach	IE3.0CPS/25	991	10	5°	PRS	6.5m	Black	Blacktown City Council

WORK COMPLETED / FIELD BOOK

CONSTRUCTED BY C.J. DOYLE CONTRACTING
WORKS COMPLETED BY CHRIS JOWETT
SIGNATURE C.J. DOYLE DATE 28/09/23
INSPECTED BY GAVIN NIXON
SIGNATURE _____ DATE _____

ASSET RECORDING

I STEVE FRIDAY
OF C.J. DOYLE CONTRACTING
CONTACT No 8784-1922
HEREBY CERTIFY THAT ASSETS MARKED AS-BUILT ON THIS DRAWING HAVE BEEN RECORDED AS PER ENDEAVOUR ENERGY STANDARD SAD 0004.
SIGNATURE STEVE FRIDAY DATE 28/09/23

Duct Breakdown Table										
Route	Configuration	Route Length	Duct Re-Imbursement				Duct Usage Charge			
			No. of 50mm Ducts	Amount (@ \$7/m)	No. of 125mm Ducts	Amount (@ \$27/m)	No. of 50mm Ducts	Amount (@ \$7/m)	No. of 125mm Ducts	Amount (@ \$27/m)
A → B	Existing Footpath Allocation - Install LV Cable in Spare 125mm Duct	13m	0	\$ 0.00	0	\$ 0.00	0	\$ 0.00	0	\$ 0.00
B → C	Nil	0m	0	\$ 0.00	0	\$ 0.00	0	\$ 0.00	0	\$ 0.00
C → D	Existing Footpath Allocation - Install HV Cables in Spare 125mm Ducts	10m	0	\$ 0.00	0	\$ 0.00	0	\$ 0.00	0	\$ 0.00
E → F	Existing Footpath Allocation - Install LV Cable in Spare 125mm Duct	8m	0	\$ 0.00	0	\$ 0.00	0	\$ 0.00	0	\$ 0.00
E → H	Existing Footpath Allocation - Install LV Cable in Spare 125mm Duct	44m	0	\$ 0.00	0	\$ 0.00	0	\$ 0.00	0	\$ 0.00
a → b	New LV Footpath Allocation Trenching	19m	0	\$ 0.00	0	\$ 0.00	0	\$ 0.00	0	\$ 0.00
b → c	New LV Footpath Allocation Trenching	16m	0	\$ 0.00	0	\$ 0.00	0	\$ 0.00	0	\$ 0.00
c → d	New LV Footpath Allocation Trenching	37m	0	\$ 0.00	0	\$ 0.00	0	\$ 0.00	0	\$ 0.00
d → e	New LV Footpath Allocation Trenching	20m	0	\$ 0.00	0	\$ 0.00	0	\$ 0.00	0	\$ 0.00
e → f	New LV Footpath Allocation Trenching	23m	0	\$ 0.00	0	\$ 0.00	0	\$ 0.00	0	\$ 0.00
f → g	New LV Footpath Allocation Trenching	33m	0	\$ 0.00	0	\$ 0.00	0	\$ 0.00	0	\$ 0.00
g → h	New LV Footpath Allocation Trenching	23m	0	\$ 0.00	0	\$ 0.00	0	\$ 0.00	0	\$ 0.00
h → i	New LV Footpath Allocation Trenching	20m	0	\$ 0.00	0	\$ 0.00	0	\$ 0.00	0	\$ 0.00
i → j	New LV Footpath Allocation Trenching	13m	0	\$ 0.00	0	\$ 0.00	0	\$ 0.00	0	\$ 0.00
j → k	New LV Footpath Allocation Trenching	7m	0	\$ 0.00	0	\$ 0.00	0	\$ 0.00	0	\$ 0.00
Sub Totals			0	\$ 0	0	\$ 0	0	\$ 0	0	\$ 0
Total			\$ 0				\$ 0			

Duct Breakdown Table										
Route	Configuration	Route Length	Duct Re-Imbursement				Duct Usage Charge			
			No. of 50mm Ducts	Amount (@ \$7/m)	No. of 125mm Ducts	Amount (@ \$27/m)	No. of 50mm Ducts	Amount (@ \$7/m)	No. of 125mm Ducts	Amount (@ \$27/m)
k → l	New LV Footpath Allocation Trenching	23m	0	\$ 0.00	0	\$ 0.00	0	\$ 0.00	0	\$ 0.00
l → m	New HV Footpath Allocation Trenching	14m	0	\$ 0.00	0	\$ 0.00	0	\$ 0.00	0	\$ 0.00
m → n	New HV Footpath Allocation Trenching	13m	0	\$ 0.00	0	\$ 0.00	0	\$ 0.00	0	\$ 0.00
n → o	New HV Footpath Allocation Trenching	22m	0	\$ 0.00	0	\$ 0.00	0	\$ 0.00	0	\$ 0.00
o → p	New HV Footpath Allocation Trenching	10m	0	\$ 0.00	0	\$ 0.00	0	\$ 0.00	0	\$ 0.00
p → q	New HV Footpath Allocation Trenching	15m	0	\$ 0.00	0	\$ 0.00	0	\$ 0.00	0	\$ 0.00
q → r	New LV Footpath Allocation Trenching	15m	0	\$ 0.00	0	\$ 0.00	0	\$ 0.00	0	\$ 0.00
r → t	New LV Footpath Allocation Trenching	45m	0	\$ 0.00	0	\$ 0.00	0	\$ 0.00	0	\$ 0.00
s → t	New LV Footpath Allocation Trenching	43m	0	\$ 0.00	0	\$ 0.00	0	\$ 0.00	0	\$ 0.00
t → F1	New LV Footpath Allocation Trenching	50m	0	\$ 0.00	0	\$ 0.00	0	\$ 0.00	0	\$ 0.00
B1 → D1	New LV Footpath Allocation Trenching	23m	0	\$ 0.00	0	\$ 0.00	0	\$ 0.00	0	\$ 0.00
D1 → u	New HV Footpath Allocation Trenching	31m	0	\$ 0.00	0	\$ 0.00	0	\$ 0.00	0	\$ 0.00
u → v	New HV Footpath Allocation Trenching	23m	0	\$ 0.00	0	\$ 0.00	0	\$ 0.00	0	\$ 0.00
v → w	New HV Footpath Allocation Trenching	23m	0	\$ 0.00	0	\$ 0.00	0	\$ 0.00	0	\$ 0.00
w → x	New HV Footpath Allocation Trenching	18m	0	\$ 0.00	0	\$ 0.00	0	\$ 0.00	0	\$ 0.00
Sub Totals			0	\$ 0	0	\$ 0	0	\$ 0	0	\$ 0
Total			\$ 0				\$ 0			

Duct Breakdown Table										
Route	Configuration	Route Length	Duct Re-Imbursement				Duct Usage Charge			
			No. of 50mm Ducts	Amount (@ \$7/m)	No. of 125mm Ducts	Amount (@ \$27/m)	No. of 50mm Ducts	Amount (@ \$7/m)	No. of 125mm Ducts	Amount (@ \$27/m)
x → y	New HV Footpath Allocation Trenching	30m	0	\$ 0.00	0	\$ 0.00	0	\$ 0.00	0	\$ 0.00
y → q1	New HV Footpath Allocation Trenching	30m	0	\$ 0.00	0	\$ 0.00	0	\$ 0.00	0	\$ 0.00
H → bi	Existing Footpath Allocation - Install LV Cable in Spare 125mm Duct	29m	0	\$ 0.00	0	\$ 0.00	0	\$ 0.00	0	\$ 0.00
B → B1	Existing Road Crossing Duct - Install LV Cable	16m	0	\$ 0.00	0	\$ 0.00	0	\$ 0.00	0	\$ 0.00
D → D1	Existing Road Crossing Ducts - Install HV Cables	16m	0	\$ 0.00	0	\$ 0.00	0	\$ 0.00	0	\$ 0.00
F → F1	Existing Road Crossing Duct - Install LV Cable	16m	0	\$ 0.00	0	\$ 0.00	0	\$ 0.00	0	\$ 0.00
b → b1	Existing Road Crossing Duct - Install LV Cable	16m	0	\$ 0.00	0	\$ 0.00	0	\$ 0.00	0	\$ 0.00
k → k1	New Road Crossing	16m	0	\$ 0.00	0	\$ 0.00	0	\$ 0.00	0	\$ 0.00
n → n1	New Road Crossing	16m	0	\$ 0.00	0	\$ 0.00	0	\$ 0.00	0	\$ 0.00
o → o1	New Road Crossing	16m	0	\$ 0.00	0	\$ 0.00	0	\$ 0.00	0	\$ 0.00
q → q1	New Road Crossing	16m	0	\$ 0.00	0	\$ 0.00	0	\$ 0.00	0	\$ 0.00
Sub Totals			0	\$ 0	0	\$ 0	0	\$ 0	0	\$ 0
Total			\$ 0				\$ 0			

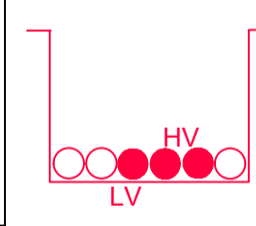

WORK COMPLETED / FIELD BOOK
 CONSTRUCTED BY: C.J. DOYLE CONTRACTING
 WORKS COMPLETED: CHRIS JOWETT
 SIGNATURE: C. JOWETT DATE: 26/09/23
 INSPECTED BY: GAVIN NIXON
 SIGNATURE: DATE: _____
ASSET RECORDING
 I: STEVE FRIDAY
 OF: C.J. DOYLE CONTRACTING
 CONTACT No: 8784-1922
 HEREBY CERTIFY THAT ASSETS MARKED AS-BUILT ON THIS DRAWING HAVE BEEN RECORDED AS PER ENDEAVOUR ENERGY STANDARD SAD 0004.
 SIGNATURE: STEVE FRIDAY DATE: 26/09/23

Certified by Endeavour Energy
 Amendment: _____
 Date Approved: _____
 Examiner's Signature: _____
 Print Name: _____
 This Certification is issued subject to Endeavour Energy's Standard Certification Terms.

- Conduit / Cable Legend**
- LV Cable - Direct Buried.
 - HV Cable - Direct Buried.
 - 50mm Duct - Spare.
 - 50mm Duct - with Existing Cable.
 - 50mm Duct - with New SL Cable.
 - 125mm Duct - with Existing LV Cable.
 - 125mm Duct - with Existing HV Cable.
 - 125mm Duct - with New LV Cable.
 - 125mm Duct - with New HV Cable.
 - 125mm Duct - Spare.

WAE SURVEY COORDINATE TABLE - GDA2020. Table with columns: NODE ID #, QUALITY LEVEL, ASSET TYPE, PROPERTY LINE, COVER, NOTES, EASTING, NORTHING, REDUCED/SURFACE LEVEL. Contains 121 rows of survey data.

Table with columns: Node ID, Quality Level, Asset Type, Cover, Notes, Easting, Northing, Reduced/Surface Level. Contains 10 rows of survey data.

WAE SURVEY COORDINATE TABLE - GDA2020 - SURFACE ASSETS. Table with columns: NODE ID #, ASSET TYPE, NOTES, EASTING, NORTHING, REDUCED/SURFACE LEVEL. Contains 41 rows of surface asset data.

WORK COMPLETED / FIELD BOOK. Includes fields for Constructed by (C.J. DOYLE CONTRACTING), Works Completed (CHRIS JOWETT), Inspected by (GAVIN NIXON), and Asset Recording (STEVE FRIDAY).