

- 1. DESIGNER AND WATER SERVICING COORDINATOR:
QALCHEK PTY LTD (CERTIFIED No.289)
77 UNION RD. PENRITH NSW 2750
PH. No. (02) 4722 8181
FOR:
WOORONG PARK PTY LTD
c/o J WYNDHAM PRINCE
580 HIGH STREET, PENRITH, NSW 2750
PH. 02 4720 3300
- 2. THE WORKS AND MATERIALS ARE IN ACCORDANCE WITH THE SEWERAGE CODE OF AUSTRALIA WSA 02-2002-2.2 SYDNEY WATER EDITION VERSION 4 (2017) INCLUDING THE SYDNEY WATER SUPPLEMENT & APPENDICES.
- 3. ALL STRUCTURES ARE CONSTRUCTED TO FINISHED SURFACE LEVELS. ALL LEVELS REFER TO FINISHED SURFACE LEVEL.
- 4. ALL BUILDING LAYOUTS, FINISHED SURFACE LEVELS, STORMWATER INFORMATION, AND GENERAL CIVIL ENGINEERING DETAILS TAKEN FROM:
CIVIL ENGINEERING AND STORMWATER: NEWPARK PRECINCT 6 CAD BASE 180731.DWG & PRECINCT 6 CC PLANS.PDF (PROVIDED BY JWP 31.07.2018)
SURFACE INFORMATION: NEWPARK PRECINCT 6 3D TRIANGLES 180808.DWG (PROVIDED BY JWP 08.08.2018)
- 5. THE NUMBER OF FIELD COMPACTION TESTS CONDUCTED TO SATISFY THE SEWERAGE CODE OF AUSTRALIA ARE:
SAND/CEMENT BACKFILL IS USED AT ROAD CROSSINGS. (LETTER PROVIDED)
PIPE EMBEDMENT ZONE: 0 TESTS CONDUCTED (LETTER PROVIDED)
TRENCH FILL ZONE (TRAFFICABLE): 0 TESTS CONDUCTED (LETTER PROVIDED)
TRENCH FILL ZONE (NON TRAFFICABLE): 89 TESTS CONDUCTED (LETTER PROVIDED)
TRENCH FILL ZONE (MAINTENANCE STRUCTURES): 222 TESTS CONDUCTED (LETTER PROVIDED)
TRENCH FILL ZONE - TOTAL: 311 TESTS CONDUCTED
ALL BACKFILL MATERIAL CERTIFIED AS SUITABLE BY A GEOTECHNICAL ENGINEER.
- 6. BUILDING OVER/ADJACENT TO SEWER - CONDITIONS MAY APPLY. REFER TO QALCHEK FOR DETAILS.
- 7. ALL EXCAVATION, SHORING EXCAVATION AND STABILITY OF ADJACENT STRUCTURES/SERVICES/DWELLINGS WAS THE RESPONSIBILITY OF THE CONSTRUCTOR.
- 8. ALL PCS CONNECTIONS TO I.S. ARE AT 0.7m & 45° TO MAIN UNLESS OTHERWISE INDICATED.
DENOTES STANDARD PCS CONNECTION (REFER DTC-2120 ISSUE A DATE 18.03.15)
- 9. CONSTRUCTOR TO ENSURE THAT WORKS ARE CONSTRUCTED IN ACCORDANCE WITH SYDNEY WATER'S DEEMED TO COMPLY DRAWINGS: FOR ALL MH'S DTC-2000 (ISSUE C 18.03.15), DTC-2203 (ISSUE B 18.03.15), DTC-2220 (ISSUE D 18.03.15), DTC-2221 (ISSUE B 01.03.13), DTC-2222 (ISSUE C 18.03.15)
- 10. PIPES CONCRETE ENCASED SHOWN ACCORDINGLY:- REFER TO SEW-1205-V
- 11. BULKHEADS CONSTRUCTED AT ROAD CROSSINGS TO SEW-1206
- 12. L5 BETWEEN CHAINAGE 8.09 AND CHAINAGE 30.63 BORED AS PER SCHEMATIC 'A' ON SHEET 6 USING 5mm THICK 406mm STEEL ENCASING PIPE AS A SLEEVE AND DN225 UPVC PIPE AS A CARRIER. THE VOID WAS GROUTED WITH SUITABLE SMPa GROUT.
- 13. NOTE L2 HAS BEEN DELETED.
- 14. W.A.C. PREPARED FROM INFORMATION SUPPLIED BY QALCHEK PTY LTD.

LOCALITY PLAN & BENCHMARK DIAGRAM

(NOT TO SCALE)

0	WORK AS CONSTRUCTED	J.V.	09.08.19
E	BORE ON L5 ADDED, STRUCTURE L18 AMENDED	F.J.	12.02.19
D	L2 DELETED, L6 AMENDED, L20 ADDED	F.J.	14.01.19
C	SHEET 11 ADDED AS PER SWC REQUEST	F.J.	26.11.18
B	ISSUE FOR APPROVAL	F.J.	29.08.18
A	DRAFT ISSUE FOR TENDER	F.J.	22.08.18
No.	AMENDMENT DESCRIPTION	BY	DATE

PLAN TO BE READ IN CONJUNCTION WITH CURRENT SYDNEY WATER STANDARDS SYDNEY WATER CORPORATION	UTILITIES						WORK AS CONSTRUCTED CERTIFICATION						PIPE SCHEDULE				AUSTRALIAN HEIGHT DATUM	NO AMENDMENTS ARE TO BE MADE TO THIS PLAN WITHOUT REFERENCE TO SYDNEY WATER. THIS PLAN IS NOT NECESSARILY UP TO DATE OR CORRECT AND SYDNEY WATER ACCEPTS NO RESPONSIBILITY.	 SYDNEY WATER CORPORATION
	TYPE	DATE	REF.	TYPE	DATE	REF.	DEVELOPER	WOORONG PARK PTY LTD	SIZE	TYPE	CLASS	LENGTH	PIPE JOINING METHOD / NOTES						
PRIOR TO COMMENCEMENT OF EXCAVATION FOR PROPOSED AND EXISTING SERVICES CONTACT :- DIAL BEFORE YOU DIG Ph. 1100 ELECTRICITY Ph. GAS Ph. TELECOMMUNICATIONS Ph. SYDNEY WATER Ph. 132 092 GIVING AT LEAST 48 HOURS NOTICE.	STORMWATER:	SWD	31.07.18	ENG. DES.			WATER SERVICE CO-ORDINATOR	QALCHEK PTY LTD	225	U.P.V.C.	SN8	293.87	RRJ	SCALES PLAN : 1:500 SECTION { HOR. : 1:500 					

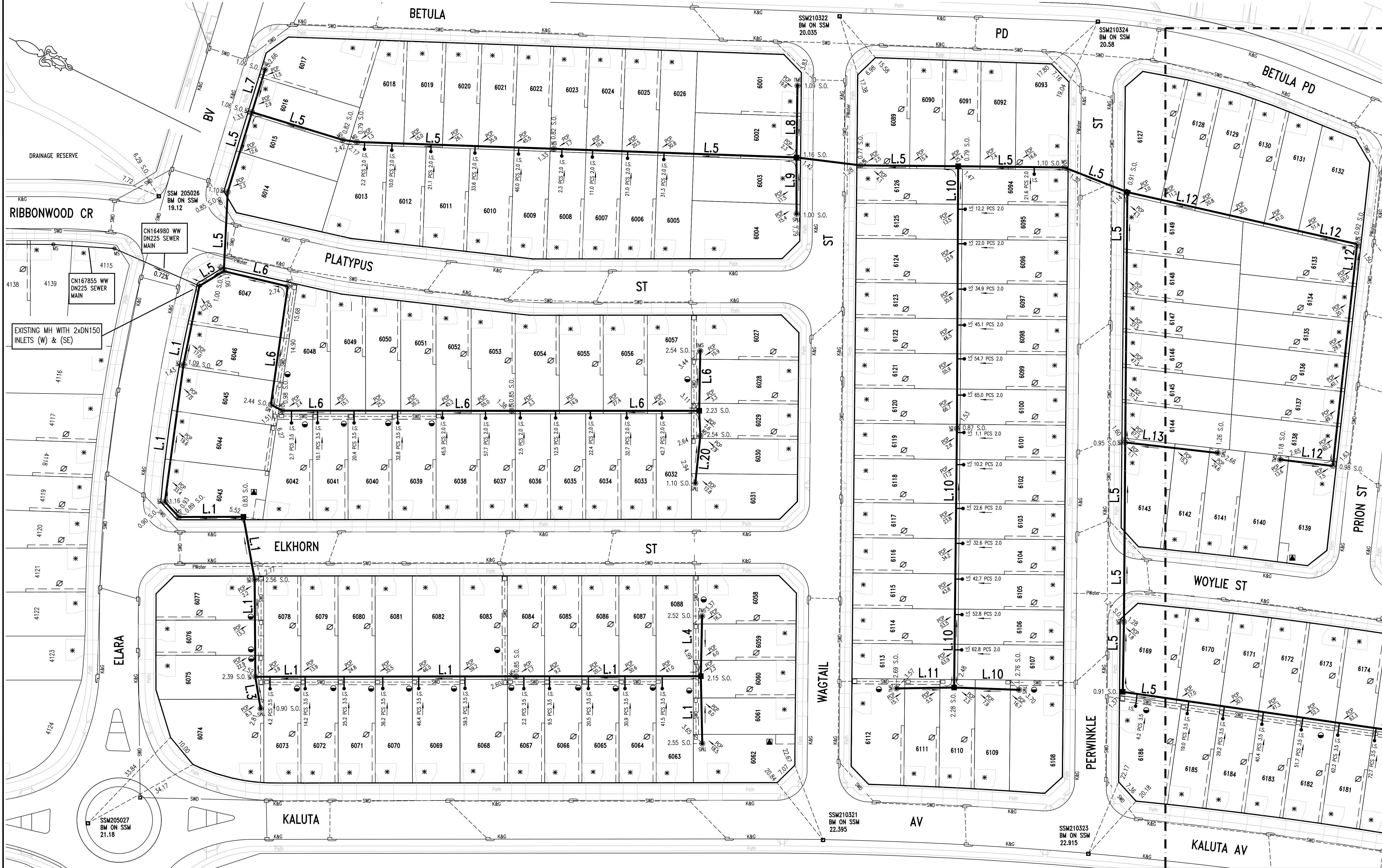

No.	AMENDMENT DESCRIPTION	BY	DATE
0	WORK AS CONSTRUCTED	J.V.	09.08.19
E	BORE ON L5 ADDED, STRUCTURE L18 AMENDED	F.J.	12.02.19
D	L2 DELETED, L6 AMENDED, L20 ADDED	F.J.	14.01.19
C	SHEET 11 ADDED AS PER SWC REQUEST	F.J.	26.11.18
B	ISSUE FOR APPROVAL	F.J.	29.08.18
A	DRAFT ISSUE FOR TENDER	F.J.	22.08.18

- EASEMENT FOR ACCESS AND MAINTENANCE 0.9 WIDE
- EASEMENT TO DRAIN WATER 1.5 WIDE
- * DRIVEWAY
- SUBSTATION

SEE SHEET '4' BELOW

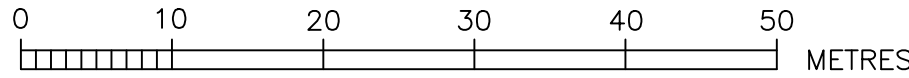

WORK AS CONSTRUCTED CERTIFICATION		Sydney WATER		SYDNEY WATER CORPORATION	
DEVELOPER	WOORONG PARK PTY LTD	W.S.C.	QALCHECK PTY LTD	CONSTRUCTOR	C.J. DOYLE CONTRACTING PTY LTD
COMPLETED	27.07.2019	W.A.C. PREPARED	09.08.2019	DESIGNER	QALCHECK PTY LTD
I CERTIFY THAT THE WORKS HAVE BEEN CONSTRUCTED IN ACCORDANCE WITH THE WORK AS CONSTRUCTED DRAWINGS				FOR DETAILS OF SERVICES SEE SHEET 1	

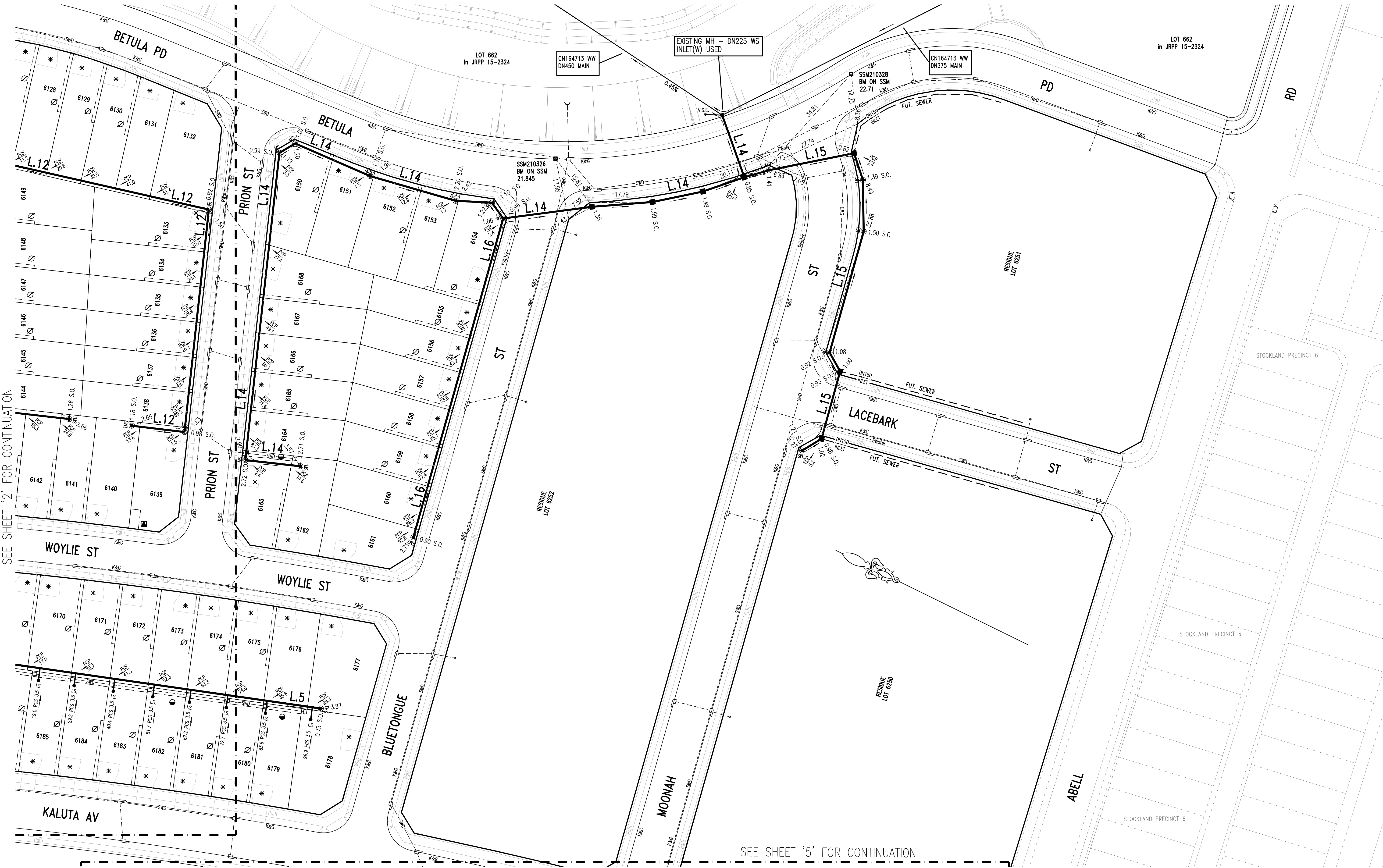

SEE SHEET '2' FOR CONTINUATION

SEE SHEET '5' FOR CONTINUATION

0	WORK AS CONSTRUCTED	J.V.	09.08.19
E	BORE ON L.5 ADDED, STRUCTURE L18 AMENDED	F.J.	12.02.19
D	L.2 DELETED, L.6 AMENDED, L.20 ADDED	F.J.	14.01.19
C	SHEET 11 ADDED AS PER SWC REQUEST	F.J.	26.11.18
B	ISSUE FOR APPROVAL	F.J.	29.08.18
A	DRAFT ISSUE FOR TENDER	F.J.	22.08.18
No.	AMENDMENT DESCRIPTION	BY	DATE

- EASEMENT FOR ACCESS AND MAINTENANCE 0.9 WIDE
- EASEMENT TO DRAIN WATER 1.5 WIDE
- DRIVEWAY
- SUBSTATION

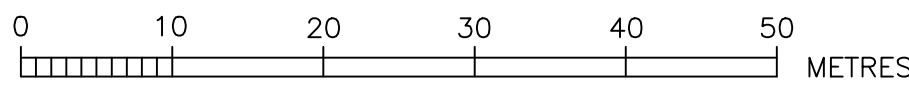

WORK AS CONSTRUCTED CERTIFICATION		Sydney WATER		SYDNEY WATER CORPORATION	
DEVELOPER	WOORONG PARK PTY LTD	Case No. 167856WW SHT 3 OF 11 SHTS.			
W.S.C.	QALCHEK PTY LTD				
CONSTRUCTOR	C.J. DOYLE CONTRACTING PTY LTD				
COMPLETED	27.07.2019				
W.A.C. PREPARED	09.08.2019	FOR DETAILS OF SERVICES SEE SHEET 1			
DESIGNER	QALCHEK PTY LTD				
I CERTIFY THAT THE WORKS HAVE BEEN CONSTRUCTED IN ACCORDANCE WITH THE WORK AS CONSTRUCTED DRAWINGS					

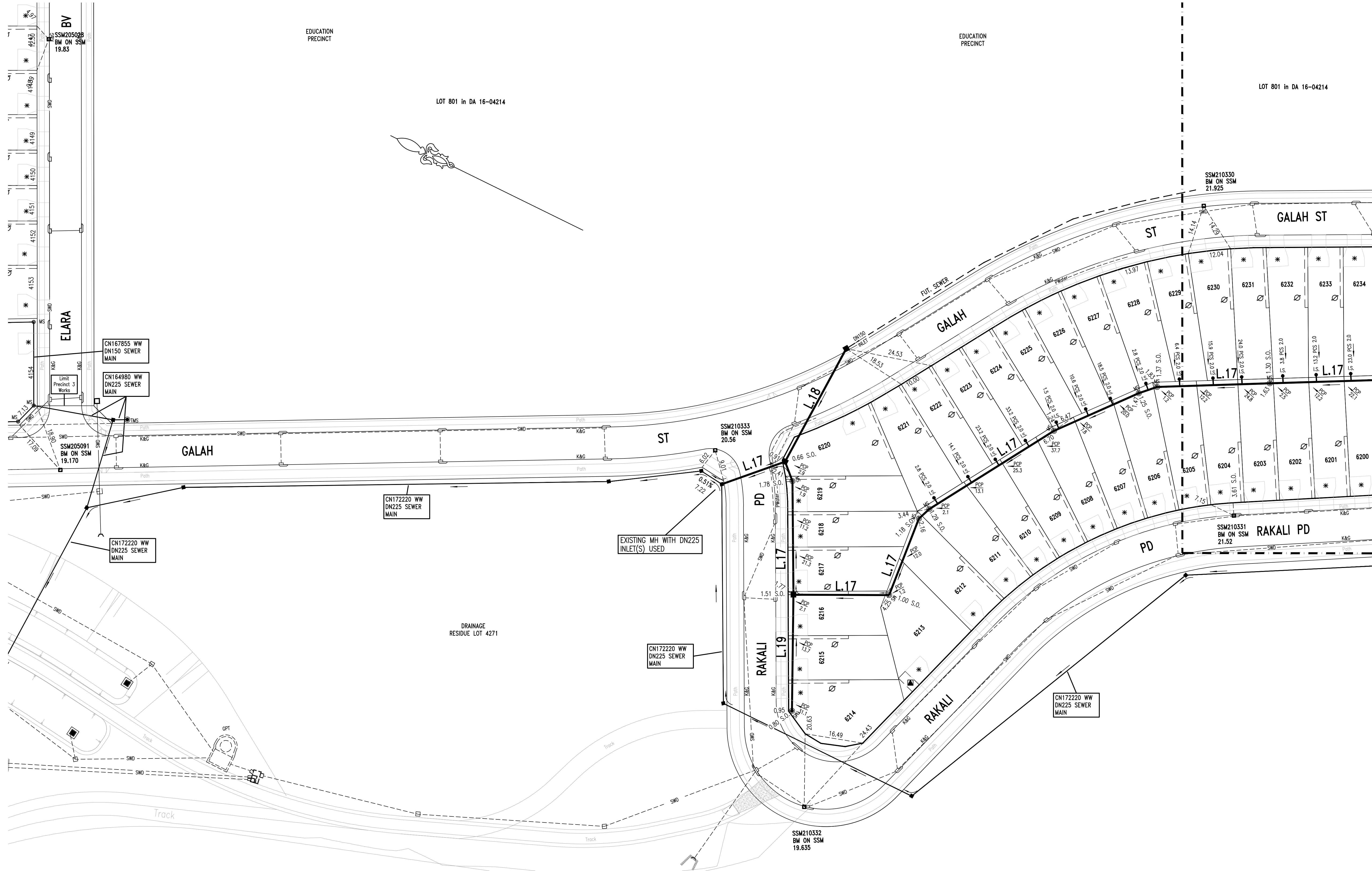

0	WORK AS CONSTRUCTED	J.V.	09.08.19
E	BORE ON L5 ADDED, STRUCTURE L18 AMENDED	F.J.	12.02.19
D	L2 DELETED, L6 AMENDED, L20 ADDED	F.J.	14.01.19
C	SHEET 11 ADDED AS PER SWC REQUEST	F.J.	26.11.18
B	ISSUE FOR APPROVAL	F.J.	29.08.18
A	DRAFT ISSUE FOR TENDER	F.J.	22.08.18
No.	AMENDMENT DESCRIPTION	BY	DATE

- EASEMENT FOR ACCESS AND MAINTENANCE 0.9 WIDE
- EASEMENT TO DRAIN WATER 1.5 WIDE
- DRIVEWAY
- SUBSTATION

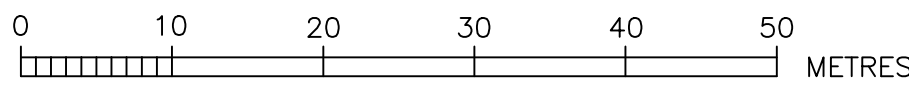

WORK AS CONSTRUCTED CERTIFICATION				SYDNEY WATER CORPORATION	
DEVELOPER	WOORONG PARK PTY LTD			<div><div>Sydney</div><div>WATER</div></div>	
W.S.C.	QALCHEK PTY LTD				
CONSTRUCTOR	C.J. DOYLE CONTRACTING PTY LTD				
COMPLETED	27.07.2019				
W.A.C. PREPARED	09.08.2019			Case No. 167856WWW	SHT 4 OF 11 SHTs.
DESIGNER	QALCHEK PTY LTD			SYDNEY WATER CORPORATION	
I CERTIFY THAT THE WORKS HAVE BEEN CONSTRUCTED IN ACCORDANCE WITH THE WORK AS CONSTRUCTED DRAWINGS				FOR DETAILS OF SERVICES SEE SHEET 1	

LINE No.	CHAINAGE	TYPE (MH/MS/MC)	DN RISER	CLASS OF COVER	MATERIAL (PVC-U,PE,PP,GRP, CAST IN SITU CONC,PRE-CAST CONC, OTHER - SPECIFY)	COMMENTS (BRAND/DTC No/ISSUE, DATE/NA, OTHER AS REQUIRED)
1	22.74	MS	225	B	AS PER WSA-137	AS PER WSA-137
1	62.14	MS	225	B	AS PER WSA-137	AS PER WSA-137
1	68.00	MS	225	B	AS PER WSA-137	AS PER WSA-137
1	86.33	MH	1050	B	CONCRETE	DTC-2203
1	104.51	MS	225	B	AS PER WSA-137	AS PER WSA-137
1	132.05	MS	225	B	AS PER WSA-137	WSA-137 (DN300 RISER USED ON HIGH LEVEL CONN. M/S)
1	206.10	MS	300	B	AS PER WSA-137	AS PER WSA-137
1	258.55	MH	1050	B	CONCRETE	DTC-2203
1	277.69	TMS	225	B	AS PER WSA-137	AS PER WSA-137
3	9.18	TMS	225	B	AS PER WSA-137	AS PER WSA-137
4	17.08	TMS	225	B	AS PER WSA-137	AS PER WSA-137
5	8.09	MS	225	B	AS PER WSA-137	AS PER WSA-137
5	30.63	MS	225	B	AS PER WSA-137	AS PER WSA-137
5	54.31	MS	225	B	AS PER WSA-137	AS PER WSA-137
5	81.25	MS	225	B	AS PER WSA-137	AS PER WSA-137
5	85.30	MS	225	B	AS PER WSA-137	AS PER WSA-137
5	141.28	MS	225	B	AS PER WSA-137	AS PER WSA-137
5	210.22	MH	1050	B	CONCRETE	DTC-2203
5	228.52	MS	225	B	AS PER WSA-137	AS PER WSA-137
5	256.25	MH	1050	B	CONCRETE	DTC-2203
5	286.39	MS	225	B	AS PER WSA-137	AS PER WSA-137
5	305.61	MH	1050	B	CONCRETE	DTC-2203
5	376.71	MS	225	B	AS PER WSA-137	AS PER WSA-137
5	427.68	MS	225	B	AS PER WSA-137	AS PER WSA-137
5	447.56	MH	1050	B	CONCRETE	DTC-2203
5	546.82	TMS	225	B	AS PER WSA-137	AS PER WSA-137
6	18.65	MS	225	B	AS PER WSA-137	AS PER WSA-137
6	52.56	MS	225	B	AS PER WSA-137	AS PER WSA-137
6	56.20	MS	225	B	AS PER WSA-137	AS PER WSA-137
6	121.30	MS	225	B	AS PER WSA-137	AS PER WSA-137
6	174.61	MH	1050	B	CONCRETE	DTC-2203
6	191.61	TMS	225	B	AS PER WSA-137	AS PER WSA-137
7	12.63	TMS	225	B	AS PER WSA-137	AS PER WSA-137
8	20.41	TMS	225	B	AS PER WSA-137	AS PER WSA-137
9	16.01	TMS	225	B	AS PER WSA-137	AS PER WSA-137
10	74.55	MS	225	B	AS PER WSA-137	AS PER WSA-137
10	148.07	MH	1050	B	CONCRETE	DTC-2203
10	166.51	TMS	225	B	AS PER WSA-137	AS PER WSA-137
11	16.39	TMS	225	B	AS PER WSA-137	AS PER WSA-137
12	66.91	MS	225	B	AS PER WSA-137	AS PER WSA-137
12	130.28	MS	225	B	AS PER WSA-137	AS PER WSA-137
12	145.36	TMS	225	B	AS PER WSA-137	AS PER WSA-137
13	26.46	TMS	225	B	AS PER WSA-137	AS PER WSA-137
14	18.66	MH	1050	B	CONCRETE	DTC-2203
14	31.07	MH	1050	B	CONCRETE	DTC-2203
14	45.63	MH	1050	B	CONCRETE	DTC-2203
14	62.81	MH	1050	B	CONCRETE	DTC-2203
14	88.18	MS	225	B	AS PER WSA-137	AS PER WSA-137
14	93.67	MS	225	B	AS PER WSA-137	AS PER WSA-137
14	104.00	MS	225	B	AS PER WSA-137	AS PER WSA-137
14	129.16	MS	225	B	AS PER WSA-137	AS PER WSA-137
14	152.28	MS	225	B	AS PER WSA-137	AS PER WSA-137
14	157.50	MS	225	B	AS PER WSA-137	AS PER WSA-137
14	245.02	MS	225	B	AS PER WSA-137	AS PER WSA-137
14	260.68	TMS	225	B	AS PER WSA-137	AS PER WSA-137
15	7.21	MS	225	B	AS PER WSA-137	AS PER WSA-137
15	31.82	MH	1050	B	CONCRETE	DTC-2203
15	39.82	MS	225	B	AS PER WSA-137	AS PER WSA-137
15	54.36	MS	225	B	AS PER WSA-137	AS PER WSA-137
15	89.99	MS	225	B	AS PER WSA-137	AS PER WSA-137
15	96.11	MH	1050	B	CONCRETE	DTC-2203
15	115.93	MH	1050	B	CONCRETE	DTC-2203
15	122.33	TMS	225	B	AS PER WSA-137	AS PER WSA-137
16	93.82	MS	225	B	AS PER WSA-137	AS PER WSA-137
17	18.96	MH	1050	B	CONCRETE	DTC-2203
17	24.83	MS	225	B	AS PER WSA-137	AS PER WSA-137
17	56.85	MH	1050	B	CONCRETE	DTC-2203
17	83.85	MS	225	B	AS PER WSA-137	AS PER WSA-137
17	107.00	MS	225	B	AS PER WSA-137	AS PER WSA-137
17	111.00	MS	225	B	AS PER WSA-137	AS PER WSA-137
17	152.53	MS	225	B	AS PER WSA-137	AS PER WSA-137
17	178.71	MS	225	B	AS PER WSA-137	AS PER WSA-137
17	184.16	MS	225	B	AS PER WSA-137	AS PER WSA-137
17	216.00	MS	225	B	AS PER WSA-137	AS PER WSA-137
17	331.00	MH	1050	B	CONCRETE	DTC-2203
17	379.95	MS	225	B	AS PER WSA-137	AS PER WSA-137
17	384.32	TMS	225	B	AS PER WSA-137	AS PER WSA-137
18	36.26	MH	1050	B	CONCRETE	DTC-2203
19	32.79	TMS	225	B	AS PER WSA-137	AS PER WSA-137
20	7.12	MS	225	B	AS PER WSA-137	AS PER WSA-137
20	20.64	TMS	225	B	AS PER WSA-137	AS PER WSA-137

O	WORK AS CONSTRUCTED	J.V.	09.08.19
E	BORE ON L5 ADDED, STRUCTURE L18 AMENDED	F.J.	12.02.19
D	L2 DELETED, L6 AMENDED, L20 ADDED	F.J.	14.01.19
C	SHEET 11 ADDED AS PER SWC REQUEST	F.J.	26.11.18
B	ISSUE FOR APPROVAL	F.J.	29.08.18
A	DRAFT ISSUE FOR TENDER	F.J.	22.08.18
No.	AMENDMENT DESCRIPTION	BY	DATE

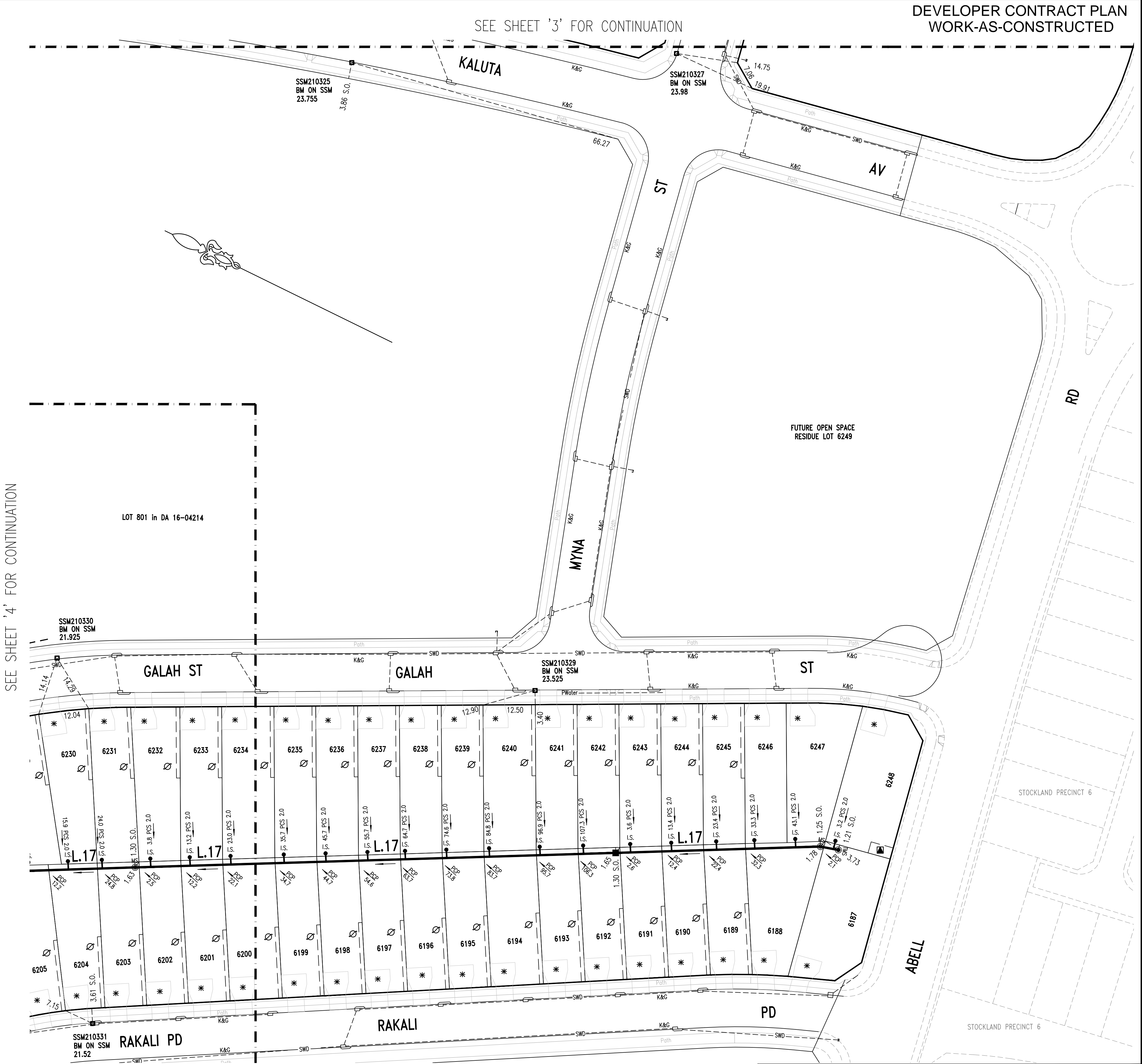

- EASEMENT FOR ACCESS AND MAINTENANCE 0.9 WIDE
- EASEMENT TO DRAIN WATER 1.5 WIDE
- * DRIVEWAY
- SUBSTATION

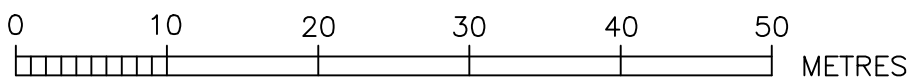

WORK AS CONSTRUCTED CERTIFICATION		Sydney WATER	
DEVELOPER	WOORONG PARK PTY LTD	Case No. 167856WW SHT 5 OF 11 SHTS.	
W.S.C.	QALCHEK PTY LTD		
CONSTRUCTOR	C.J. DOYLE CONTRACTING PTY LTD		
COMPLETED	27.07.2019		
W.A.C. PREPARED	09.08.2019	FOR DETAILS OF SERVICES SEE SHEET 1	
DESIGNER	QALCHEK PTY LTD		
I CERTIFY THAT THE WORKS HAVE BEEN CONSTRUCTED IN ACCORDANCE WITH THE WORK AS CONSTRUCTED DRAWINGS		SYDNEY WATER CORPORATION	

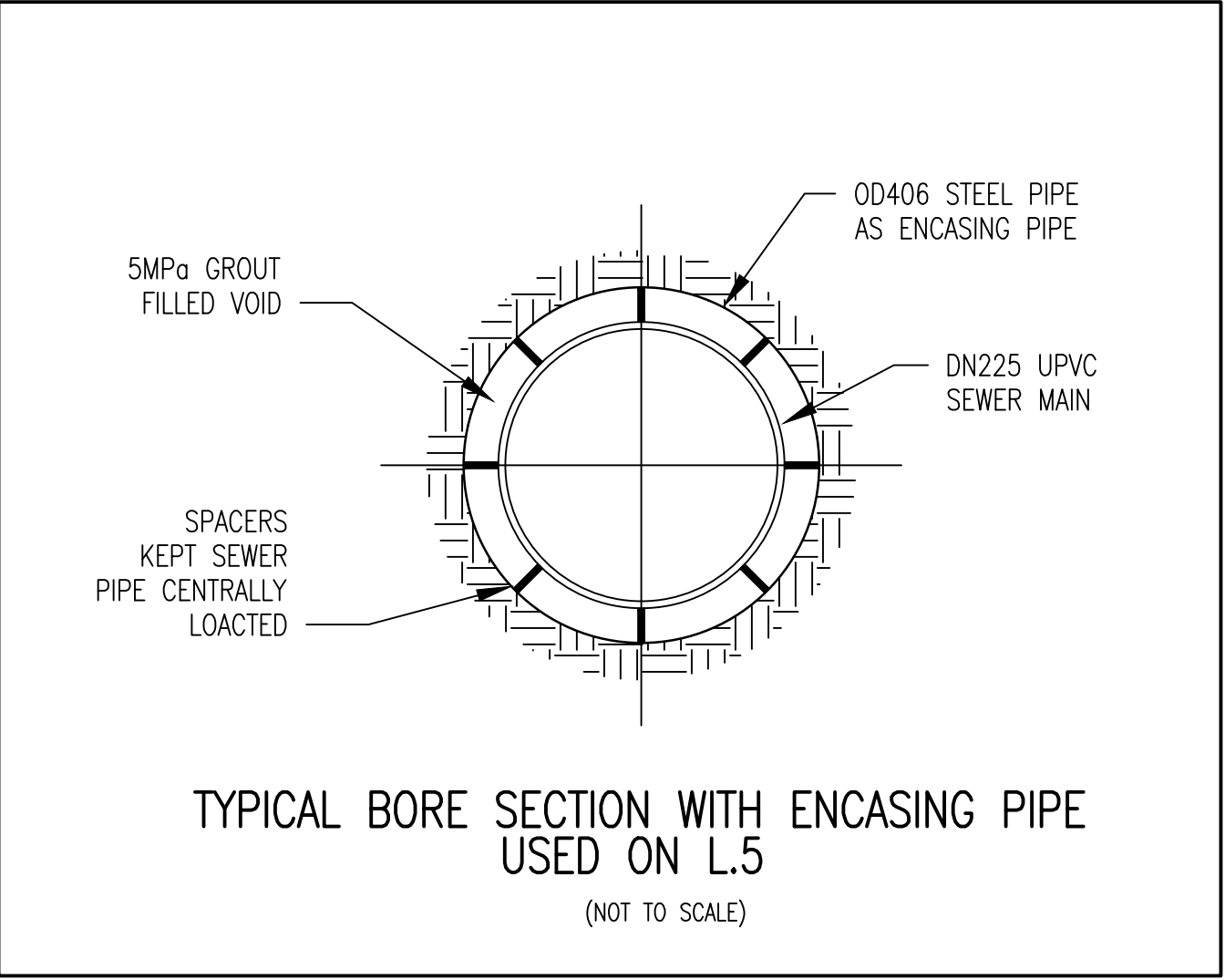
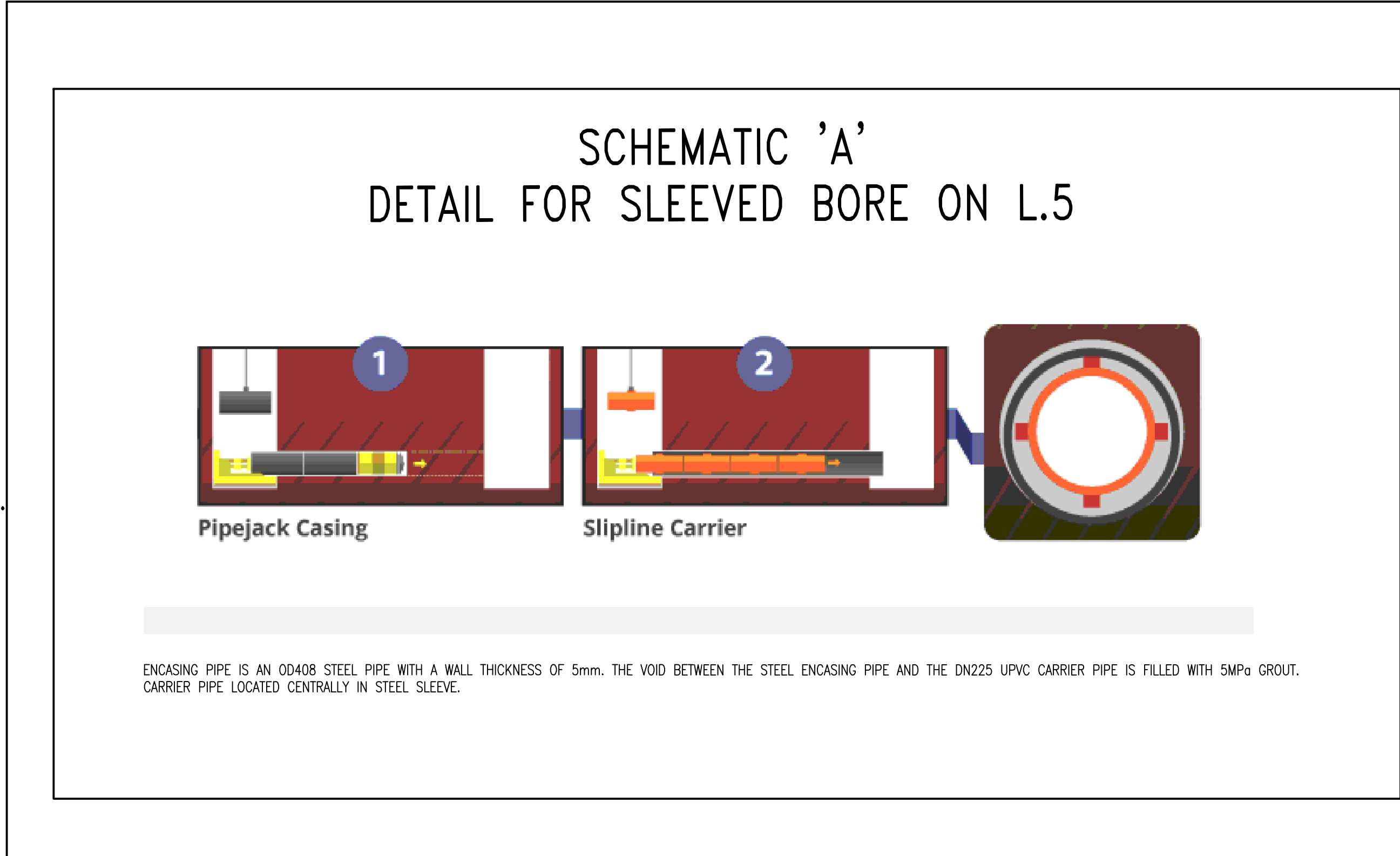
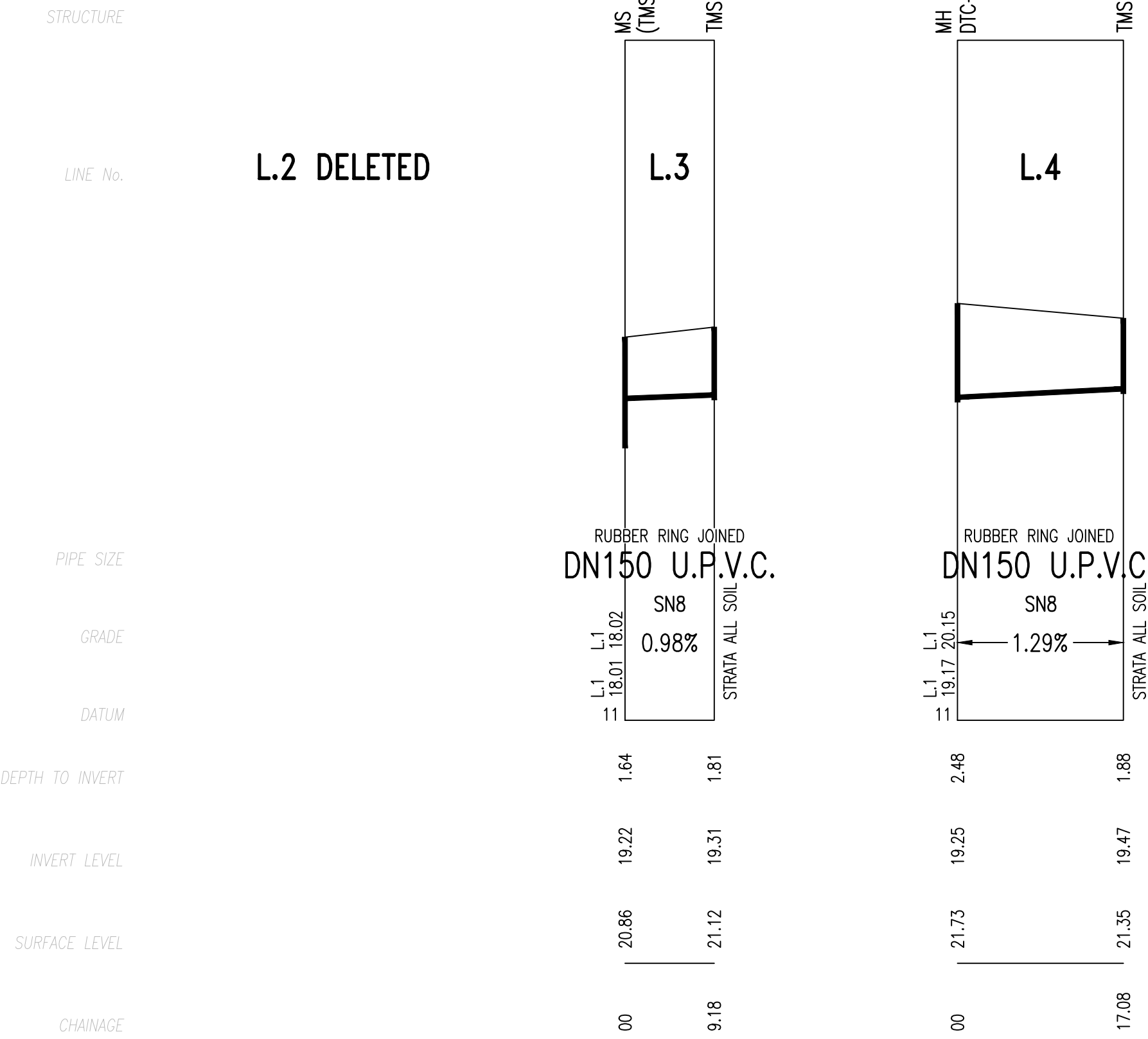
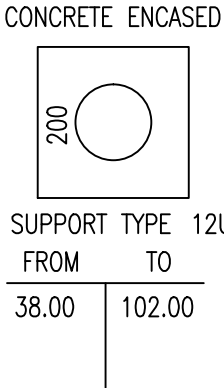
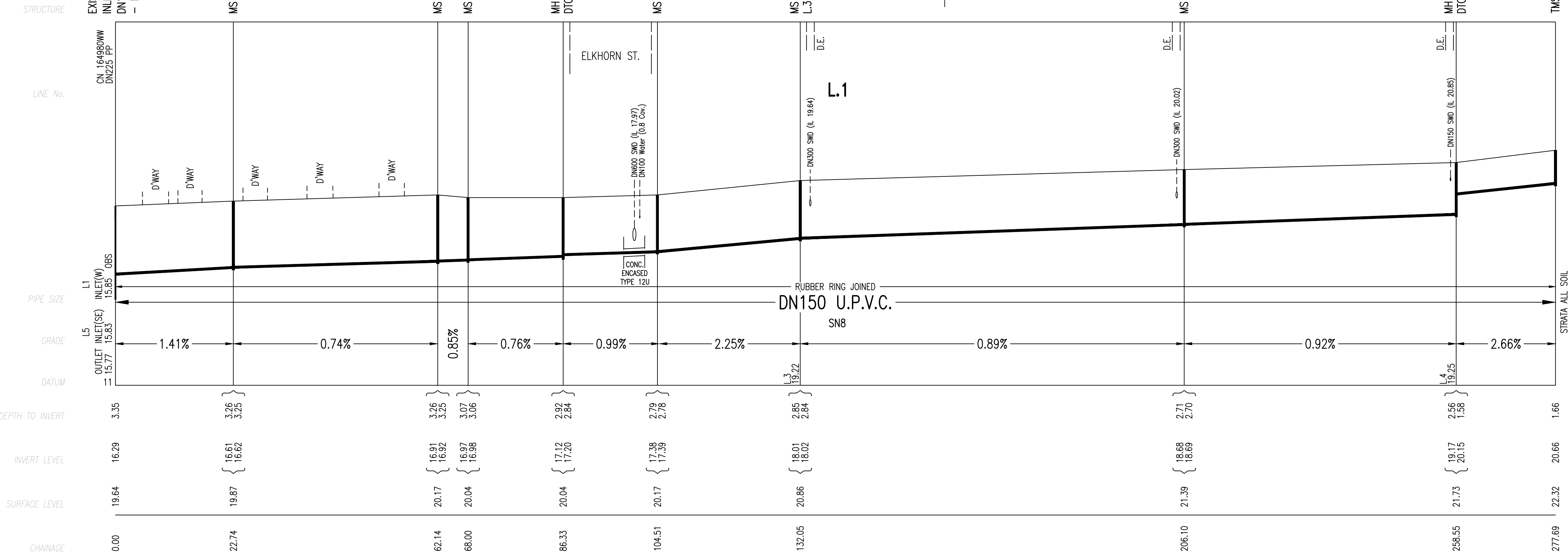

0	WORK AS CONSTRUCTED	J.V.	09.08.19
E	BORE ON L5 ADDED, STRUCTURE L18 AMENDED	F.J.	12.02.19
D	L2 DELETED, L6 AMENDED, L20 ADDED	F.J.	14.01.19
C	SHEET 11 ADDED AS PER SWC REQUEST	F.J.	26.11.18
B	ISSUE FOR APPROVAL	F.J.	29.08.18
A	DRAFT ISSUE FOR TENDER	F.J.	22.08.18
No.	AMENDMENT DESCRIPTION	BY	DATE

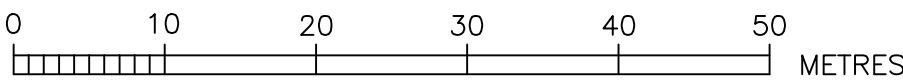

WORK AS CONSTRUCTED CERTIFICATION		Sydney WATER		SYDNEY WATER CORPORATION	
DEVELOPER	WOORONG PARK PTY LTD	Case No. 167856WW SHT 6 OF 11 SHTS.			
W.S.C.	QALCHEK PTY LTD				
CONSTRUCTOR	C.J. DOYLE CONTRACTING PTY LTD				
COMPLETED	27.07.2019				
W.A.C. PREPARED	09.08.2019				
DESIGNER	QALCHEK PTY LTD				
I CERTIFY THAT THE WORKS HAVE BEEN CONSTRUCTED IN ACCORDANCE WITH THE WORK AS CONSTRUCTED DRAWINGS		SYDNEY WATER CORPORATION FOR DETAILS OF SERVICES SEE SHEET 1			

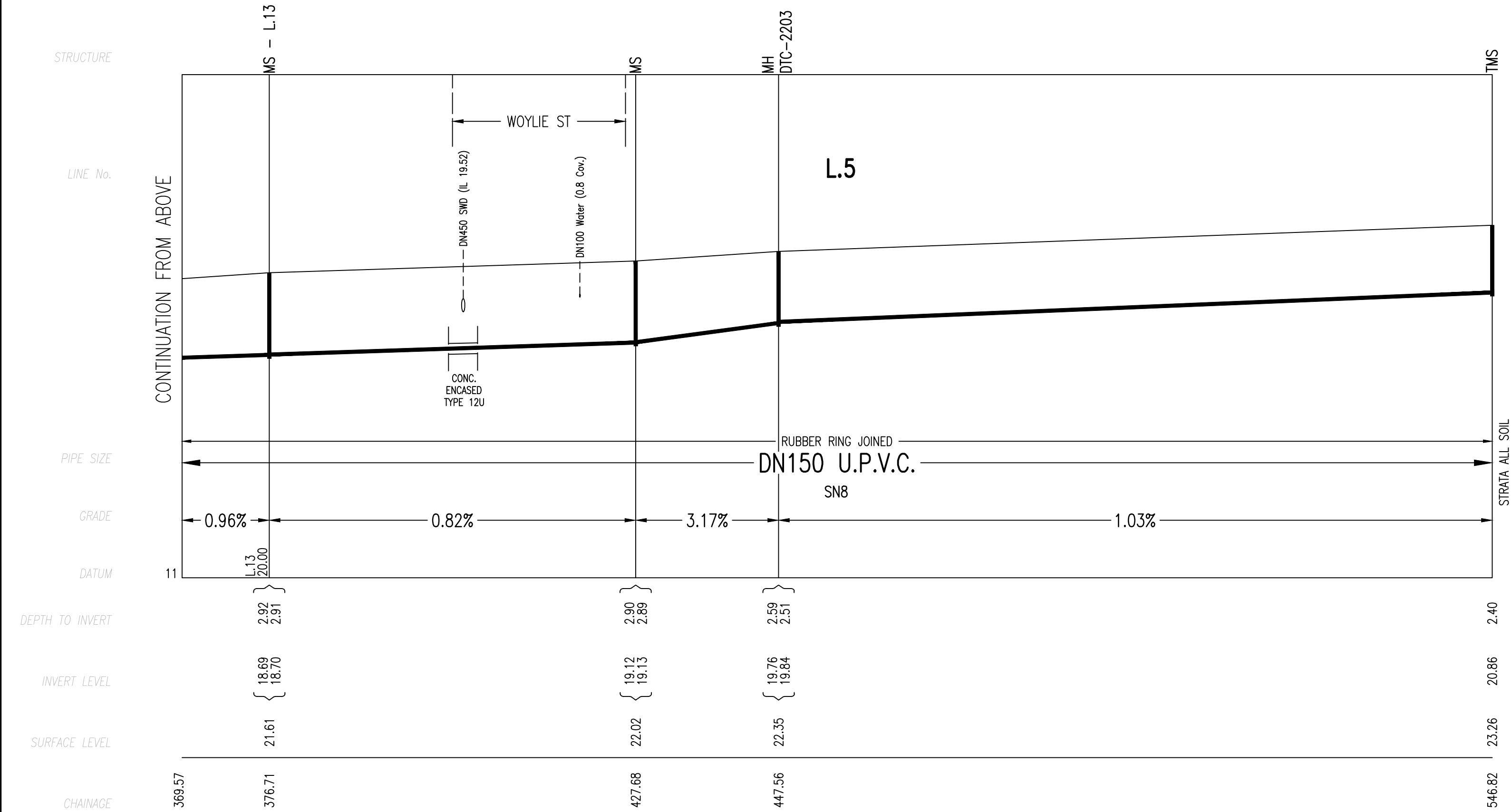
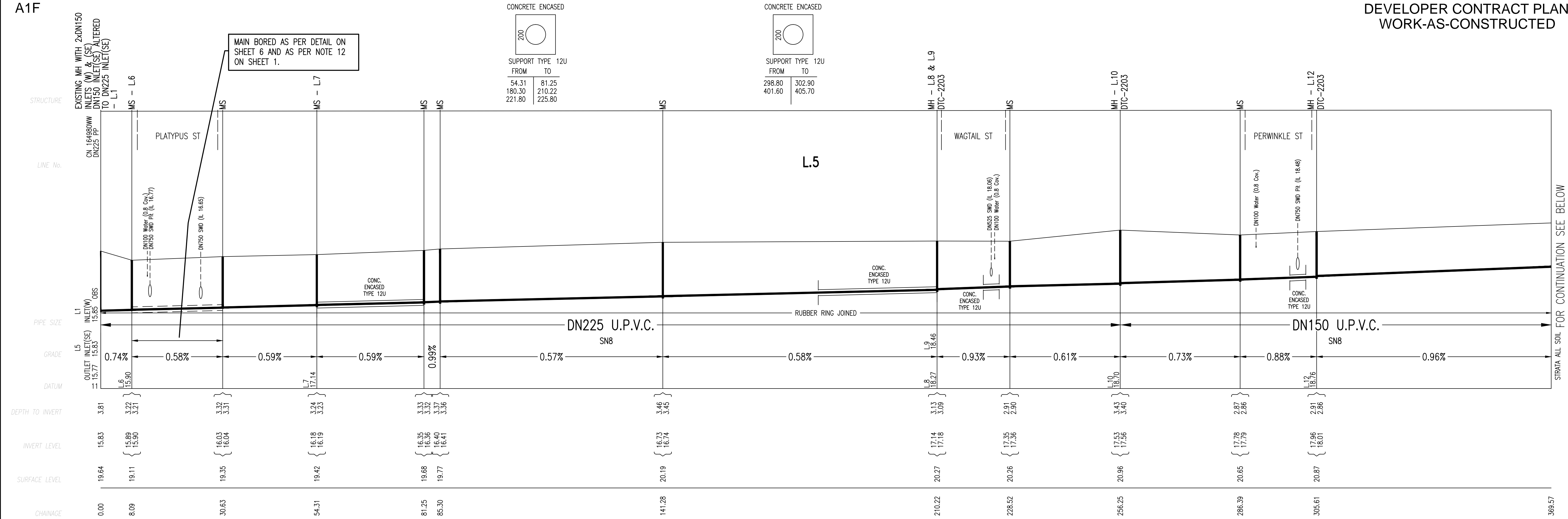

0	WORK AS CONSTRUCTED	J.V.	09.08.19
E	BORE ON L5 ADDED, STRUCTURE L18 AMENDED	F.J.	12.02.19
D	L2 DELETED, L6 AMENDED, L20 ADDED	F.J.	14.01.19
C	SHEET 11 ADDED AS PER SWC REQUEST	F.J.	26.11.18
B	ISSUE FOR APPROVAL	F.J.	29.08.18
A	DRAFT ISSUE FOR TENDER	F.J.	22.08.18
No.	AMENDMENT DESCRIPTION	BY	DATE

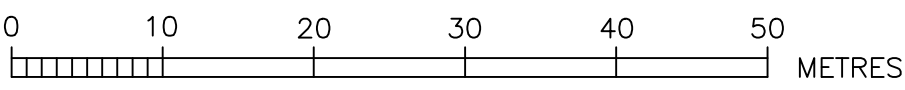

WORK AS CONSTRUCTED CERTIFICATION		<div>Sydney WATER</div>		SYDNEY WATER CORPORATION	
DEVELOPER	WOORONG PARK PTY LTD				
W.S.C.	QALCHEK PTY LTD				
CONSTRUCTOR	C.J. DOYLE CONTRACTING PTY LTD	Case No. 167856WW		SHT 7 OF 11 SHTS.	
COMPLETED	27.07.2019				
W.A.C. PREPARED	09.08.2019				
DESIGNER	QALCHEK PTY LTD				
I CERTIFY THAT THE WORKS HAVE BEEN CONSTRUCTED IN ACCORDANCE WITH THE WORK AS CONSTRUCTED DRAWINGS		SYDNEY WATER CORPORATION			
		FOR DETAILS OF SERVICES SEE SHEET 1			

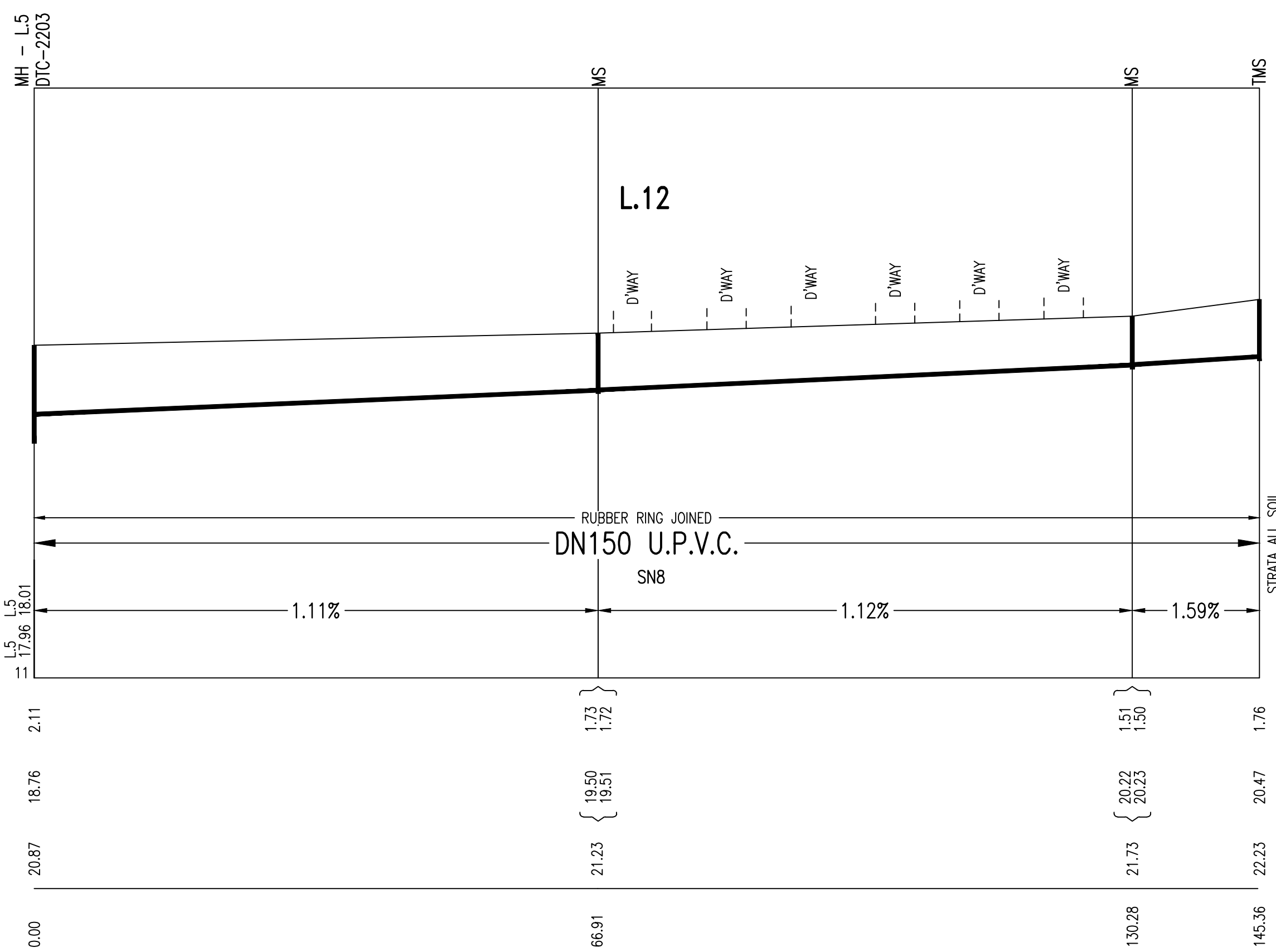
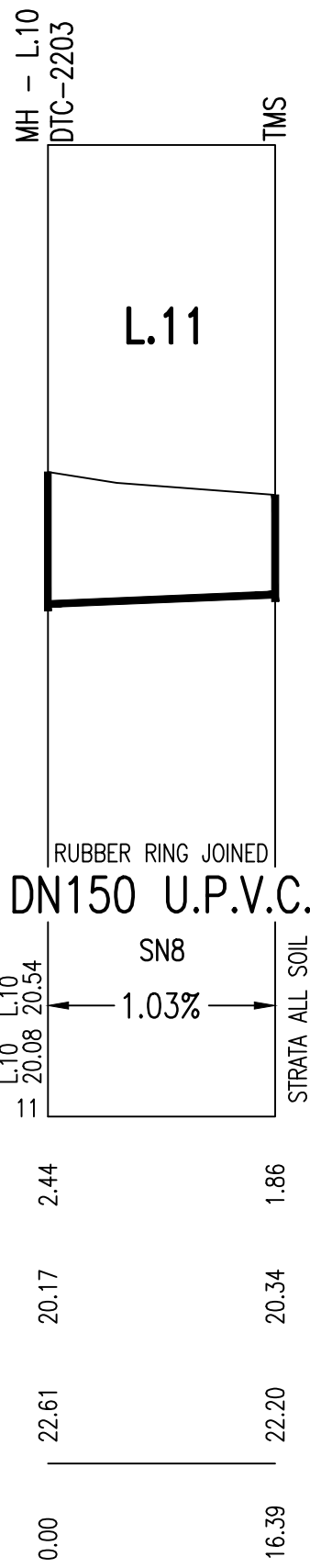
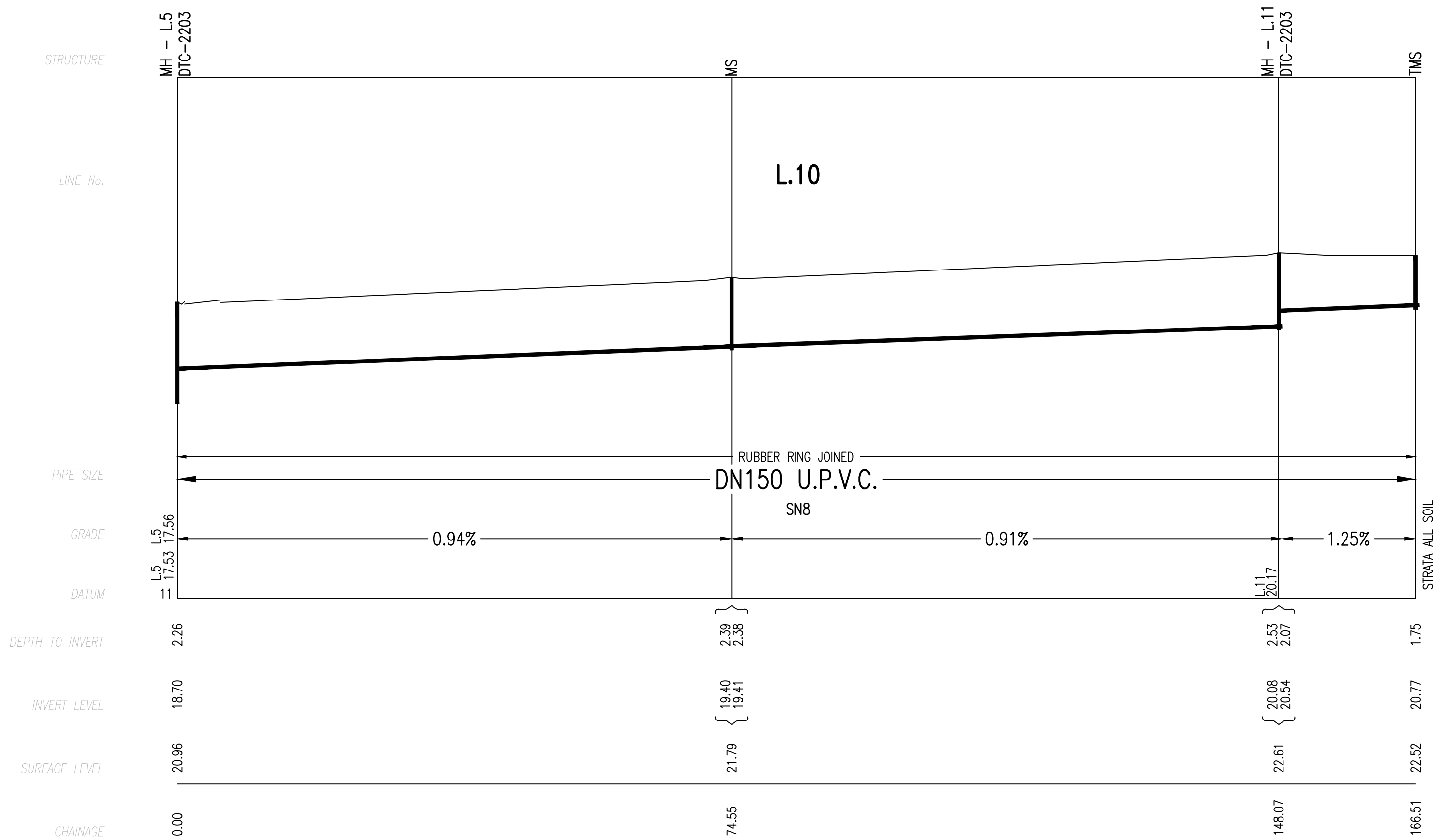
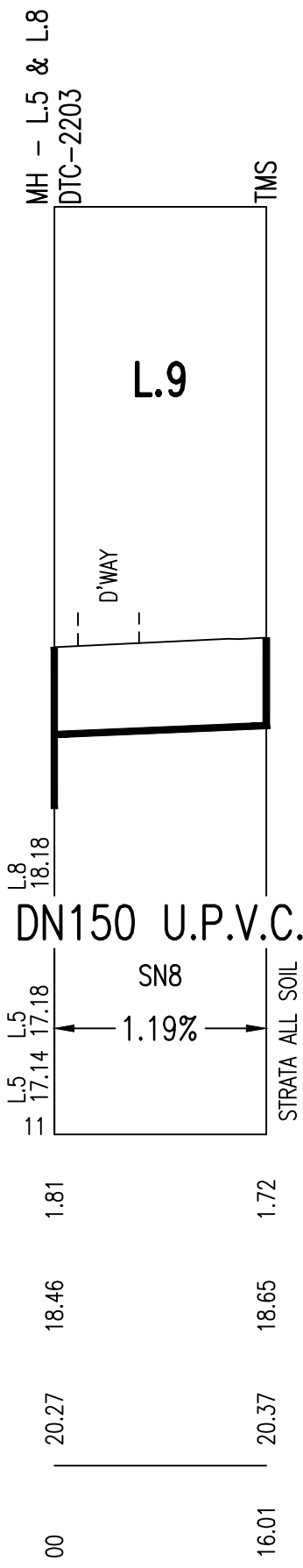
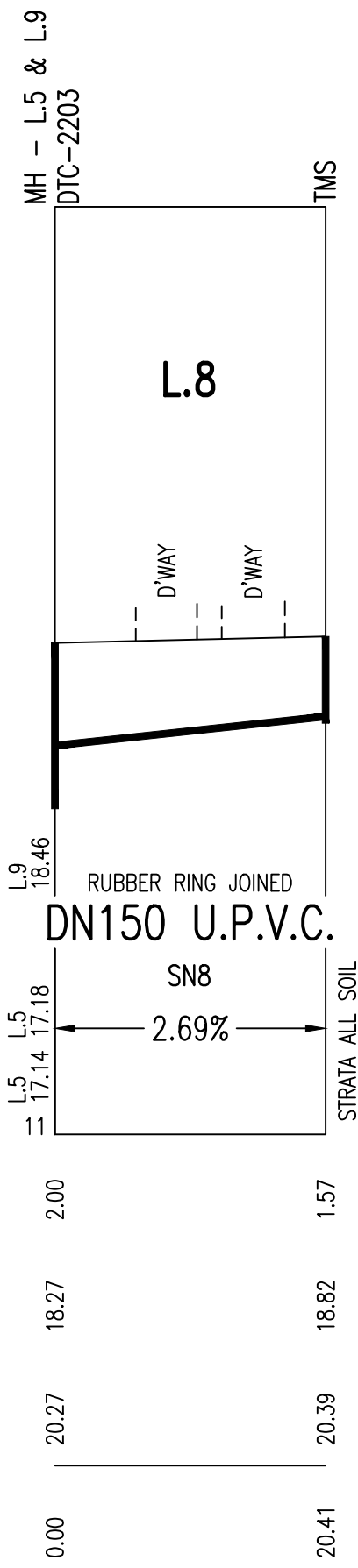
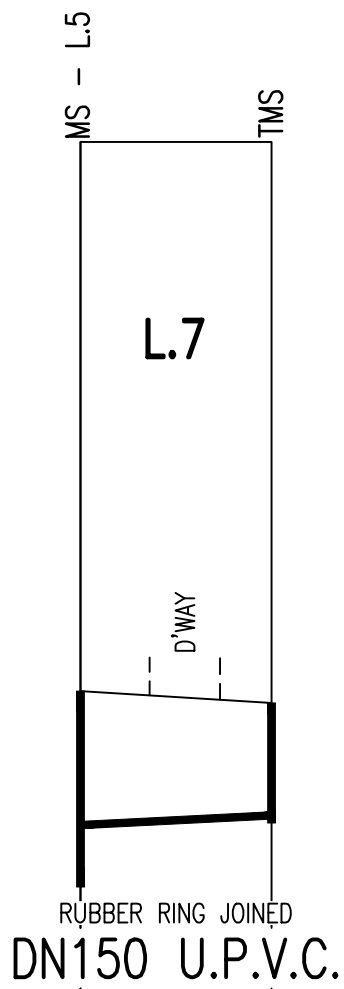

O	WORK AS CONSTRUCTED	J.V.	09.08.19
E	BORE ON L5 ADDED, STRUCTURE L18 AMENDED	F.J.	12.02.19
D	L2 DELETED, L6 AMENDED, L20 ADDED	F.J.	14.01.19
C	SHEET 11 ADDED AS PER SWC REQUEST	F.J.	26.11.18
B	ISSUE FOR APPROVAL	F.J.	29.08.18
A	DRAFT ISSUE FOR TENDER	F.J.	22.08.18
No.	AMENDMENT DESCRIPTION	BY	DATE

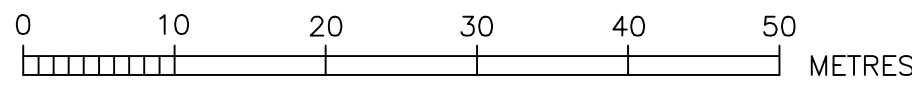

WORK AS CONSTRUCTED CERTIFICATION		Sydney <i><u>WATER</u></i>		SYDNEY WATER CORPORATION	
DEVELOPER	WOORONG PARK PTY LTD	Case No. 167856WWW		SHT	8 OF 11 SHTS.
W.S.C.	QALCHEK PTY LTD				
CONSTRUCTOR	C.J. DOYLE CONTRACTING PTY LTD				
COMPLETED	27.07.2019				
W.A.C. PREPARED	09.08.2019				
DESIGNER	QALCHEK PTY LTD	SYDNEY WATER CORPORATION			
I CERTIFY THAT THE WORKS HAVE BEEN CONSTRUCTED IN ACCORDANCE WITH THE WORK AS CONSTRUCTED DRAWINGS		FOR DETAILS OF SERVICES SEE SHEET 1			

STRUCTURE

LINE No.

PIPE SIZE

GRADE

DATUM

DEPTH TO INVERT

INVERT LEVEL

SURFACE LEVEL

CHAINAGE

STRUCTURE

LINE No.

PIPE SIZE

GRADE

DATUM

DEPTH TO INVERT

INVERT LEVEL

SURFACE LEVEL

CHAINAGE

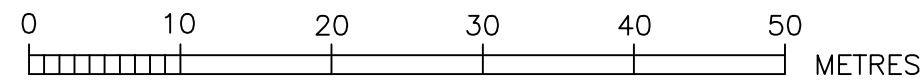

CONCRETE ENCASED

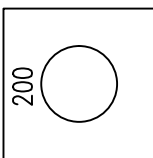

SUPPORT TYPE 12U

FROM	TO
11.50	18.66
70.30	76.30
240.50	245.02

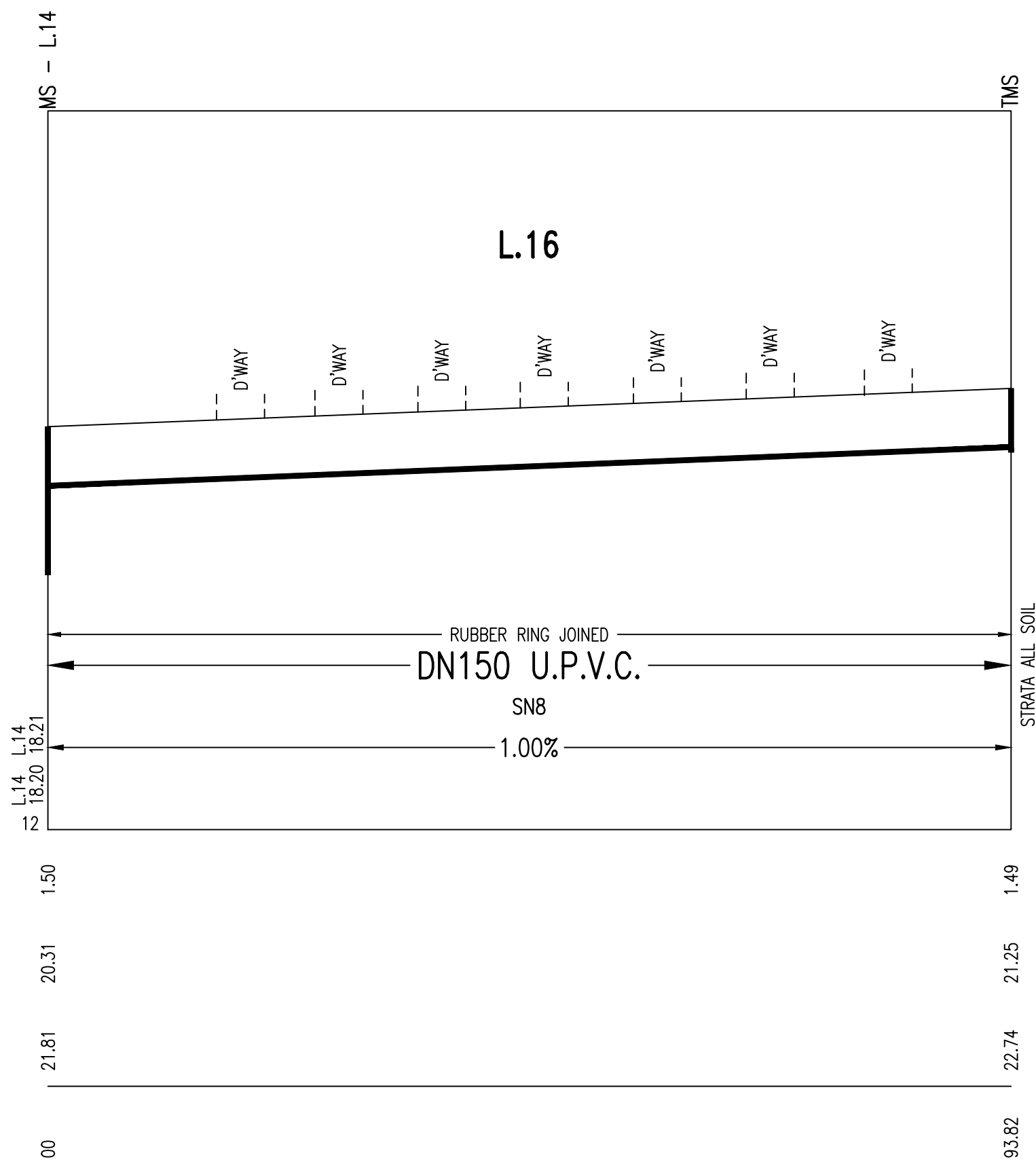
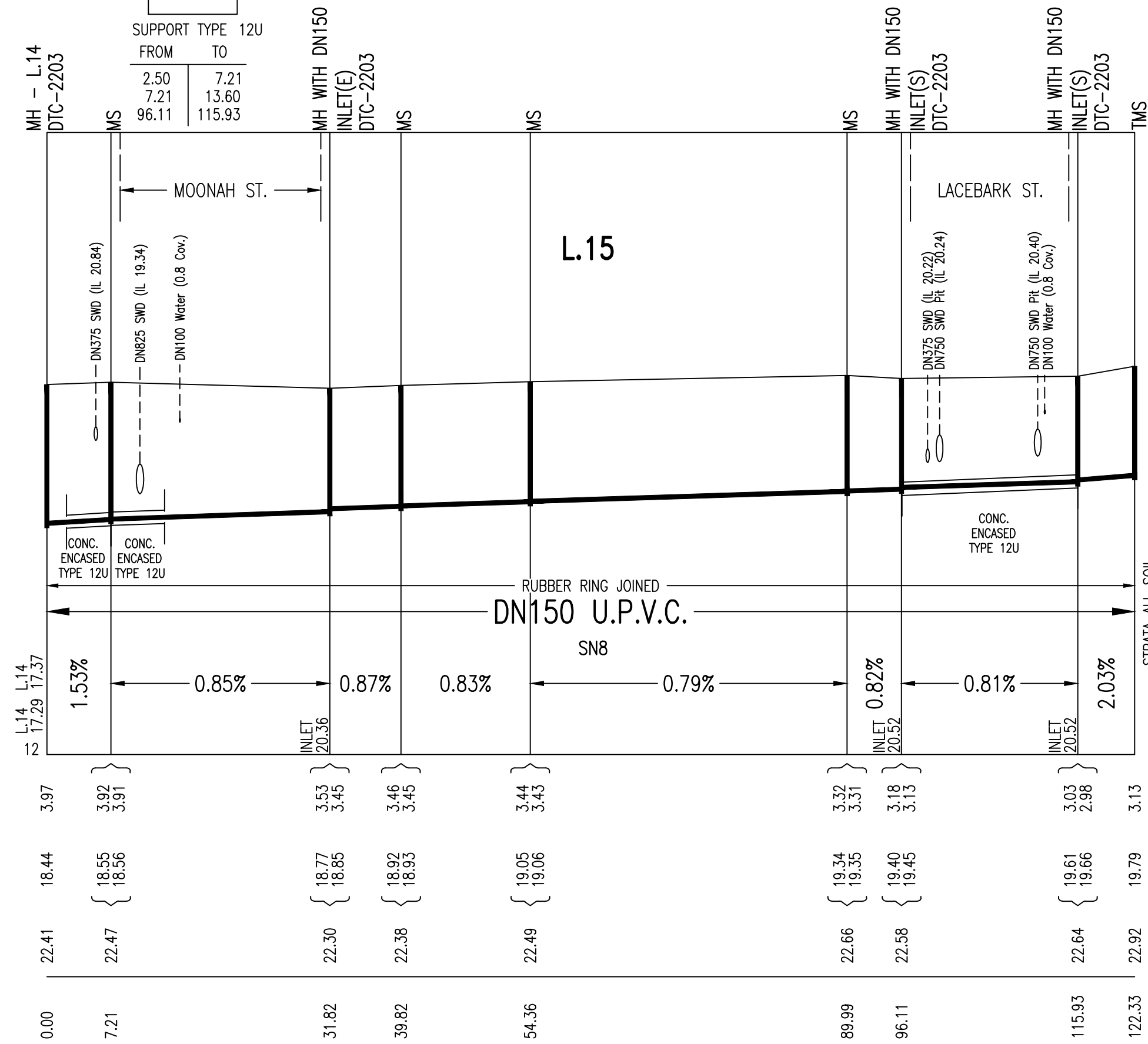
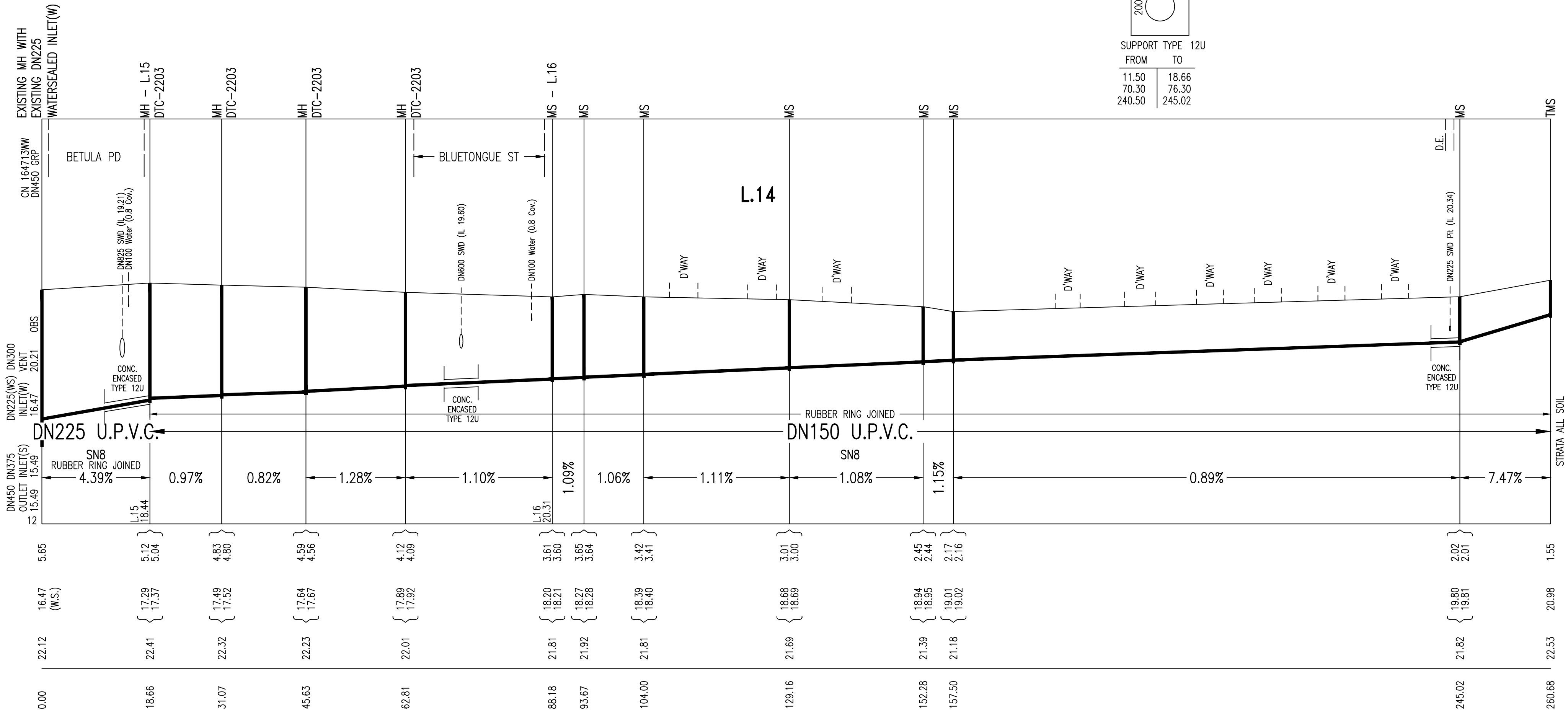
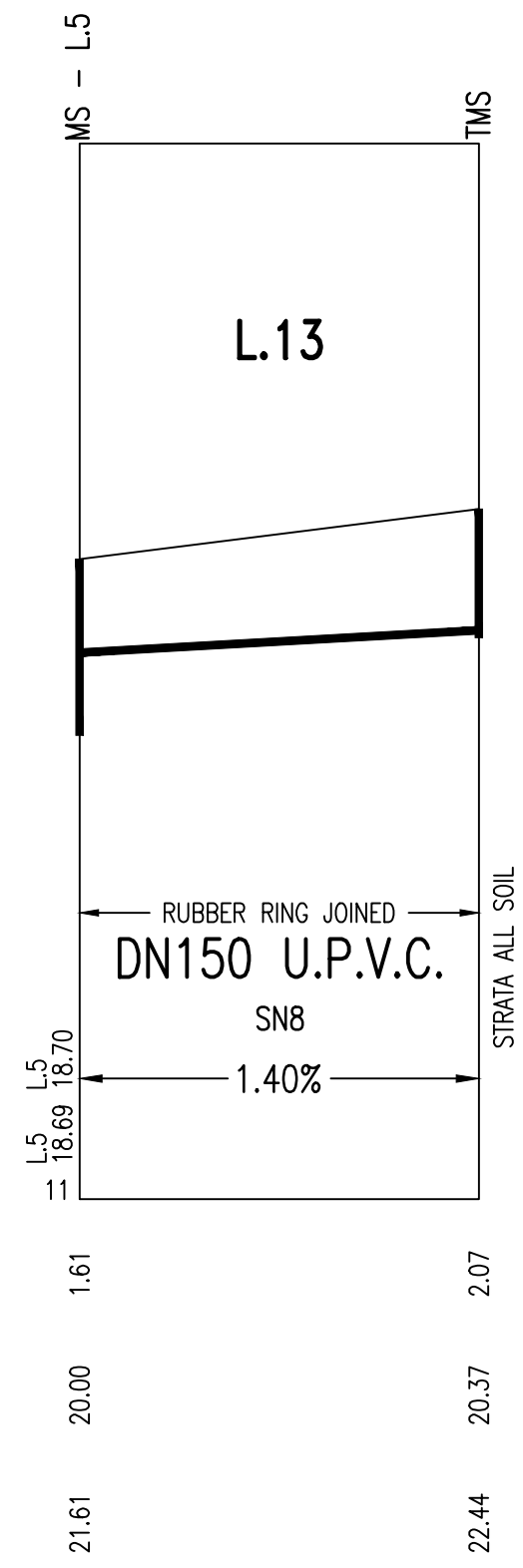

0	WORK AS CONSTRUCTED	J.V.	09.08.19
E	BORE ON L5 ADDED, STRUCTURE L18 AMENDED	F.J.	12.02.19
D	L2 DELETED, L6 AMENDED, L20 ADDED	F.J.	14.01.19
C	SHEET 11 ADDED AS PER SWC REQUEST	F.J.	26.11.18
B	ISSUE FOR APPROVAL	F.J.	29.08.18
A	DRAFT ISSUE FOR TENDER	F.J.	22.08.18
No.	AMENDMENT DESCRIPTION	BY	DATE

WORK AS CONSTRUCTED CERTIFICATION		SYDNEY WATER CORPORATION	
DEVELOPER	WOORONG PARK PTY LTD	Sydney WATER	
W.S.C.	QALCHEK PTY LTD		
CONSTRUCTOR	C.J. DOYLE CONTRACTING PTY LTD	Case No. 167856WW SHT 9 OF 11 SHTS.	
COMPLETED	27.07.2019	FOR DETAILS OF SERVICES SEE SHEET 1	
W.A.C. PREPARED	09.08.2019		
DESIGNER	QALCHEK PTY LTD	SYDNEY WATER CORPORATION	
I CERTIFY THAT THE WORKS HAVE BEEN CONSTRUCTED IN ACCORDANCE WITH THE WORK AS CONSTRUCTED DRAWINGS		FOR DETAILS OF SERVICES SEE SHEET 1	

STRUCTURE

LINE No.

PIPE SIZE

GRADE

DATUM

DEPTH TO INVERT

INVERT LEVEL

SURFACE LEVEL

CHAINAGE

CONCRETE ENCASED

SUPPORT TYPE 12U	
FROM	TO
13.60	18.96
56.85	83.85

CONCRETE ENCASED

SUPPORT TYPE 12U	
FROM	TO
26.30	32.30

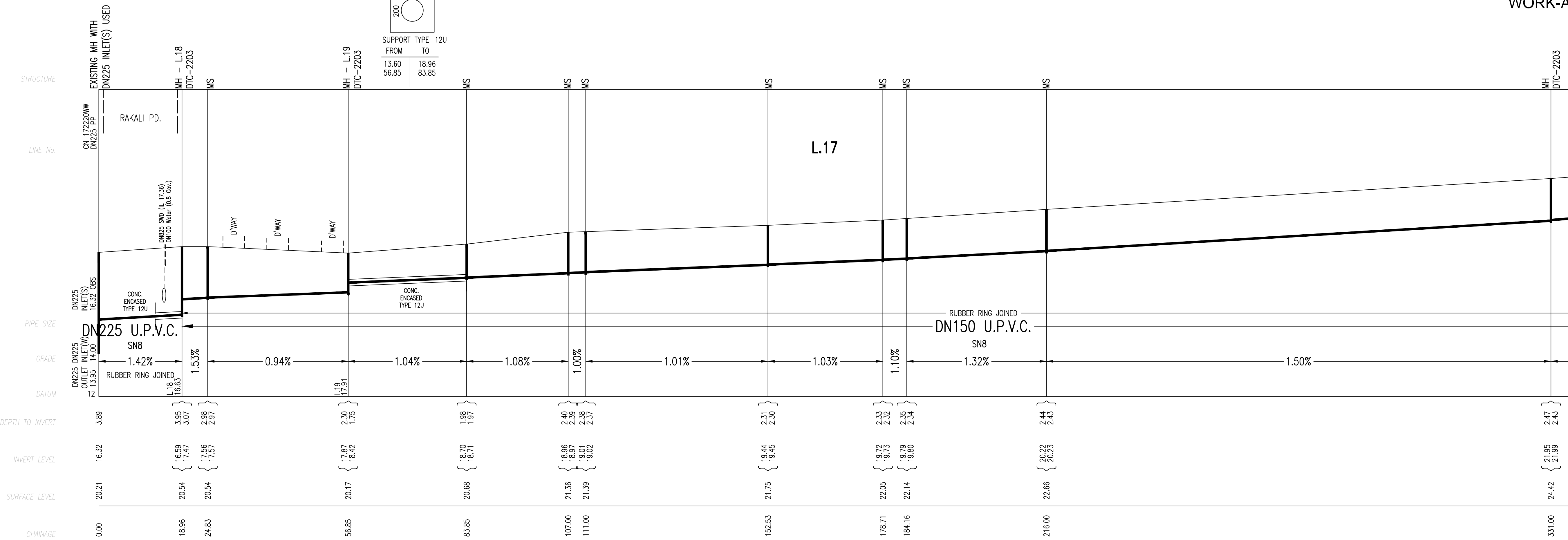

CONTINUATION FROM ABOVE

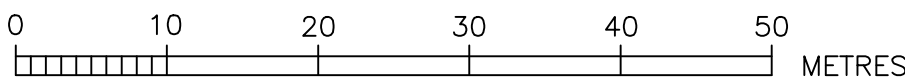
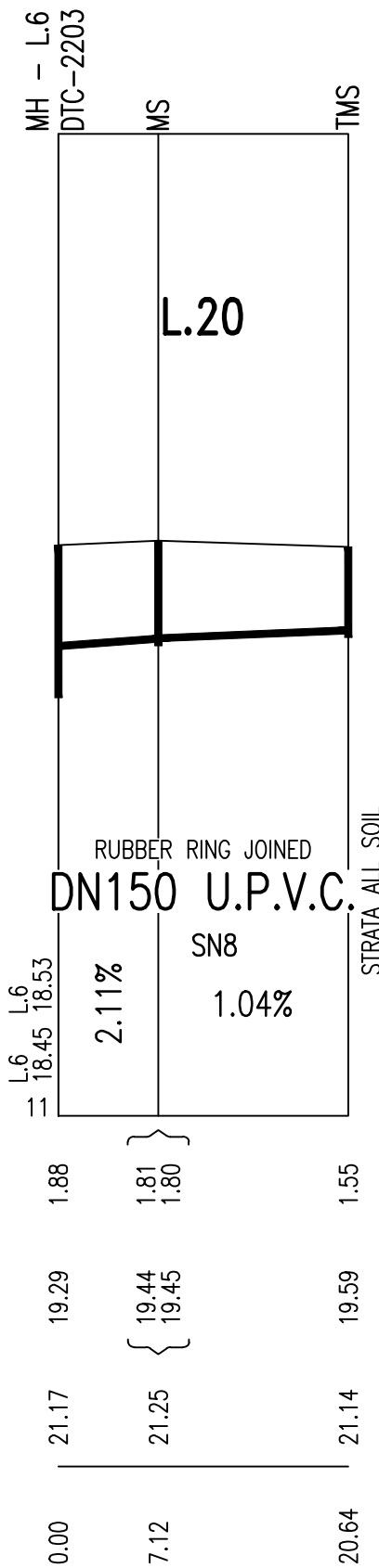
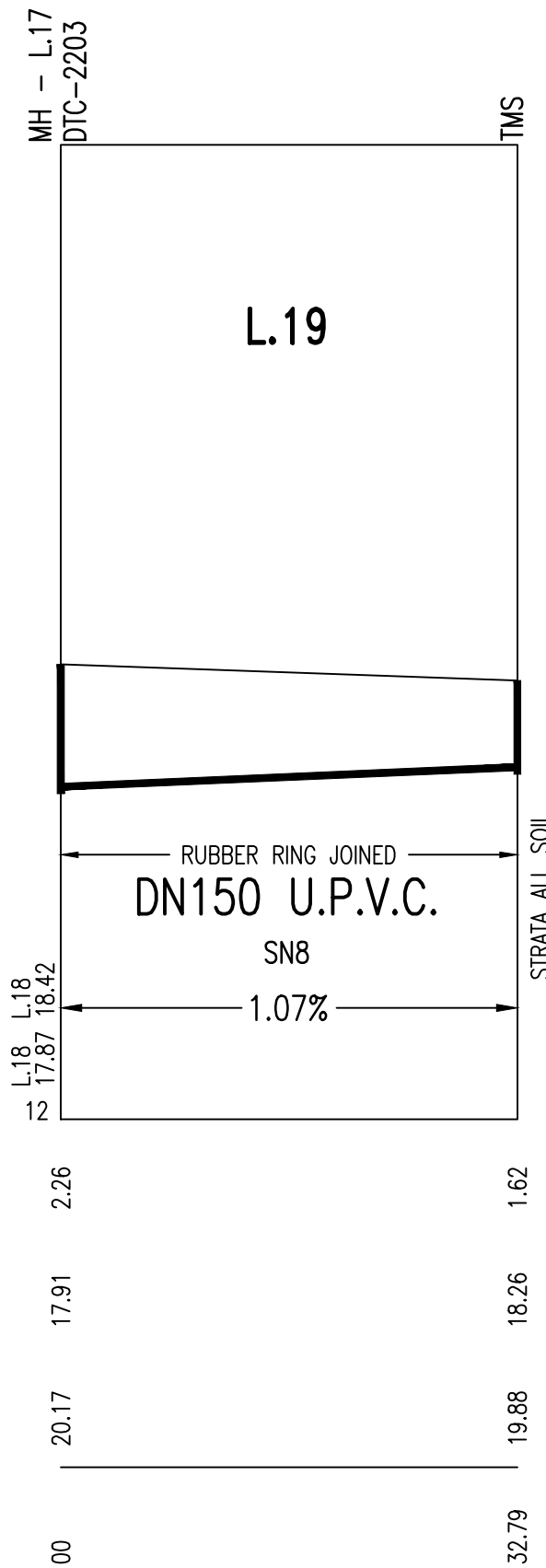
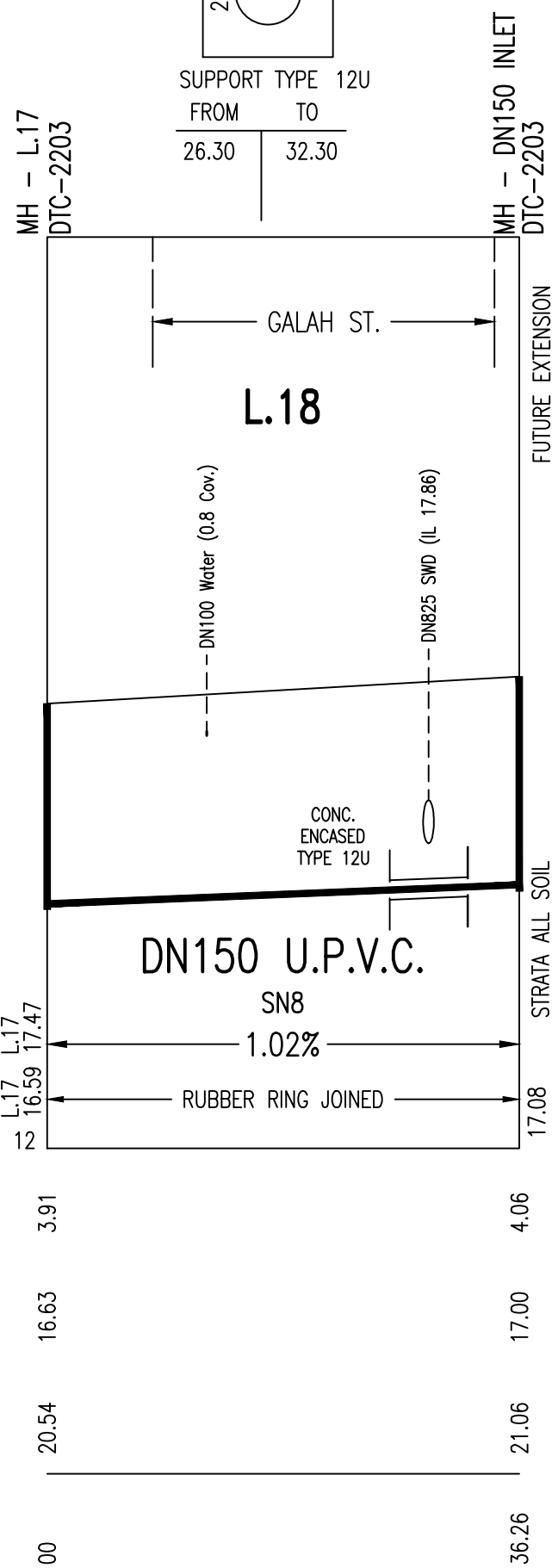
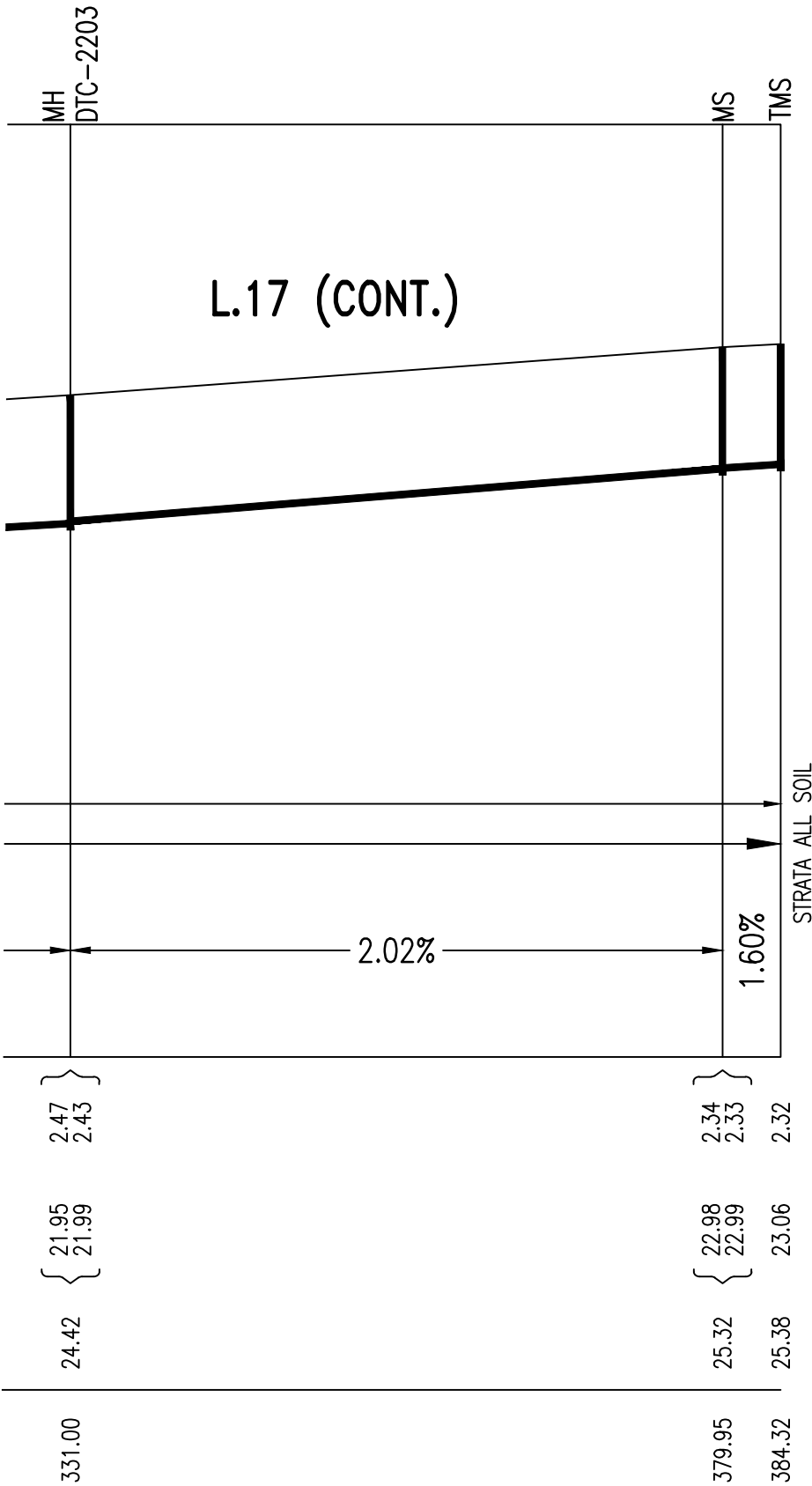

No.	AMENDMENT DESCRIPTION	BY	DATE
O	WORK AS CONSTRUCTED	J.V.	09.08.19
E	BORE ON L5 ADDED, STRUCTURE L18 AMENDED	F.J.	12.02.19
D	L2 DELETED, L6 AMENDED, L20 ADDED	F.J.	14.01.19
C	SHEET 11 ADDED AS PER SWC REQUEST	F.J.	26.11.18
B	ISSUE FOR APPROVAL	F.J.	29.08.18
A	DRAFT ISSUE FOR TENDER	F.J.	22.08.18

WORK AS CONSTRUCTED CERTIFICATION		SYDNEY WATER CORPORATION	
DEVELOPER	WOORONG PARK PTY LTD	Sydney WATER	
W.S.C.	QALCHEK PTY LTD		
CONSTRUCTOR	C.J. DOYLE CONTRACTING PTY LTD	Case No. 167856WW	
COMPLETED	27.07.2019	SHT 10 OF 11 SHTS.	
W.A.C. PREPARED	09.08.2019	FOR DETAILS OF SERVICES SEE SHEET 1	
DESIGNER	QALCHEK PTY LTD		
I CERTIFY THAT THE WORKS HAVE BEEN CONSTRUCTED IN ACCORDANCE WITH THE WORK AS CONSTRUCTED DRAWINGS		SYDNEY WATER CORPORATION	

DEVELOPMENT PLAN

(NOT TO SCALE)

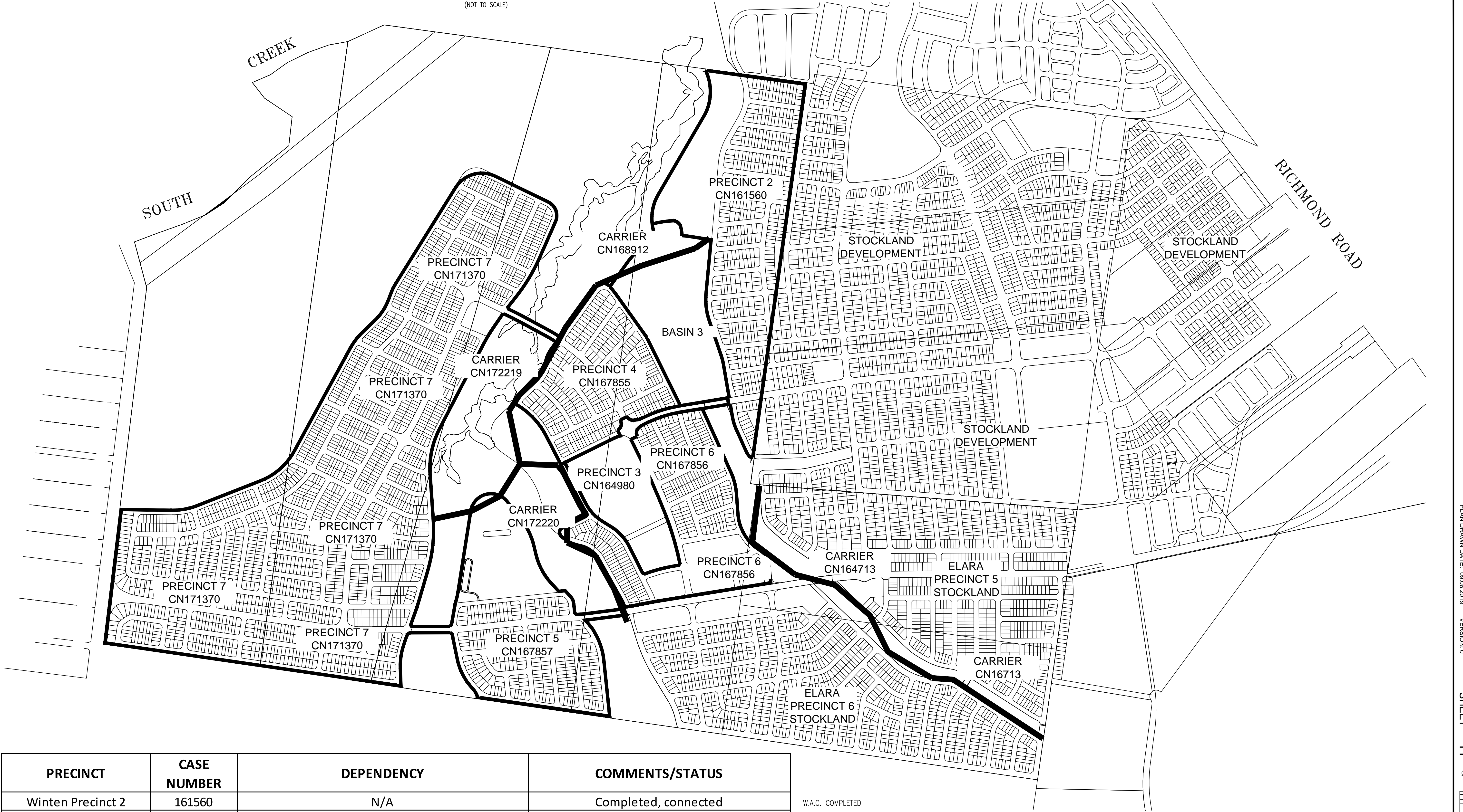

PRECINCT	CASE NUMBER	DEPENDENCY	COMMENTS/STATUS
Winten Precinct 2	161560	N/A	Completed, connected
Winten Precinct 3	164980	167855, 168912, 172219, 172220	Completed, not connected
Winten Precinct 4	167855	168912, 172219, 172220	Under Construction
Winten Precinct 5	167857	168912, 172219, 172221	Design not started
Winten Precinct 6	167856	164980, 167855, 168912, 172219, 172220, 164713	For SWC Endorsement
Winten Precinct 7	171370	168912, 172219, 172220	Design not started
Winten Carrier Phase 1	168912	N/A	Construction Start January 2019
Winten Carrier Phase 2	172219	168912	Construction Start January 2019
Winten Carrier Phase 3	172220	168912, 172219	Construction Start January 2019
Stockland Carrier	164713	N/A	Under Construction

W.A.C. COMPLETED

W.A.C. COMPLETED

W.A.C. COMPLETED

W.A.C. COMPLETED

W.A.C. COMPLETED

W.A.C. COMPLETED

W.A.C. COMPLETED

W.A.C. COMPLETED

W.A.C. COMPLETED

W.A.C. COMPLETED

O	WORK AS CONSTRUCTED	J.V.	09.08.19
E	BORE ON L5 ADDED, STRUCTURE L18 AMENDED	F.J.	12.02.19
D	L2 DELETED, L6 AMENDED, L20 ADDED	F.J.	14.01.19
C	SHEET 11 ADDED AS PER SWC REQUEST	F.J.	26.11.18
B	ISSUE FOR APPROVAL	F.J.	29.08.18
A	DRAFT ISSUE FOR TENDER	F.J.	22.08.18
No.	AMENDMENT DESCRIPTION	BY	DATE

WORK AS CONSTRUCTED CERTIFICATION

DEVELOPER
WOORONG PARK PTY LTD

W.S.C.
DALCHEK PTY LTD

CONSTRUCTOR
C.J. DOYLE CONTRACTING PTY LTD

COMPLETED
27.07.2019

W.A.C. PREPARED
09.08.2019

DESIGNER
DALCHEK PTY LTD

I CERTIFY THAT THE WORKS HAVE BEEN CONSTRUCTED IN ACCORDANCE WITH THE WORK AS CONSTRUCTED DRAWINGS

Sydney WATER

Case No. 167856WW

SHT 11 OF 11 SHTS.

SYDNEY WATER CORPORATION

FOR DETAILS OF SERVICES SEE SHEET 1