

- NOTES:**
- ALL PIT & PIPE INFRASTRUCTURE IS TO BE INSTALLED ACCORDING TO NBN Co's CONDUIT AND PIT NETWORK GUIDELINES (DOCUMENT NUMBER NBN-TE-CTO-194 VERSION 7.0 OR LATER).
  - DENOTES SHARED TRENCHES
  - CONDUITS TO BE INSTALLED IN SHARED TRENCHES, BUT NOT VERTICALLY ABOVE OR BELOW OTHER UTILITIES. CONDUITS MAY BE INSTALLED WITHIN THE ENDEAVOUR ENERGY ASSET ALLOCATION SPACE IF MANDATORY RADIAL SEPARATION FROM OTHER SERVICES IS MAINTAINED AT ALL TIMES. MINIMUM SEPARATIONS ARE:  
 - GAS MAIN (±75mm) - 150mm  
 - GAS MAIN (±110mm) - 300mm  
 - LV CABLES - 100mm  
 - HV CABLES - 300mm  
 REFER TYPICAL CROSS SECTION DIAGRAM.
  - NO PITS TO BE INSTALLED WITHIN 15m FROM ANY PAD MOUNTED TRANSFORMER. I.E. NO PITS TO BE INSTALLED WITHIN THE EPR (Earth Potential Rise) ZONE.
  - PITS TO BE INSTALLED CLEAR OF PROPOSED DRIVEWAYS
  - EXCLUSIVE ROAD CROSSING
  - FOR REMOVAL/RELOCATION OF EXISTING COMMS POLES & OVERHEAD NETWORK - DEVELOPER AND/OR PROJECT MANAGER IS TO LIAISE WITH:  
 \* TELSTRA - NETWORK INTEGRITY SERVICES  
 PH: 1800 810 443 - NetworkIntegrity@team.telstra.com  
 \* NBN RELOCATION WORKS GROUP  
 RelocationWorks@nbnco.com.au

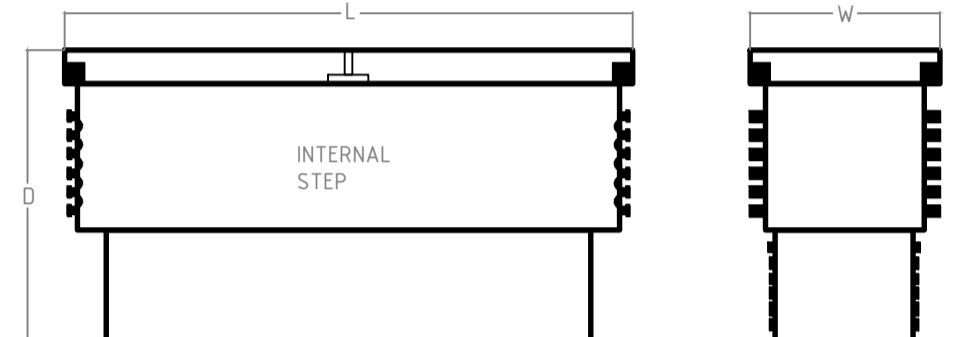

NBN NOMINAL DIMENSIONS (mm)			
PIT TYPE	L	W	D
Local Network Pit/Network Boundary Pit	700	450	650
Local Network Connection Pit	1360	555	860
Distribution Pit	1360	555	860
FDH PIT	2000	555	900

**TYPICAL ROAD CROSSING CONFIGURATION**  
 OFFSET FROM ELECTRICAL DUCTS TO ALLOW FOR SIDE ENTRY INTO PIT & CORRECT PIT PLACEMENT ON BOUNDARY.

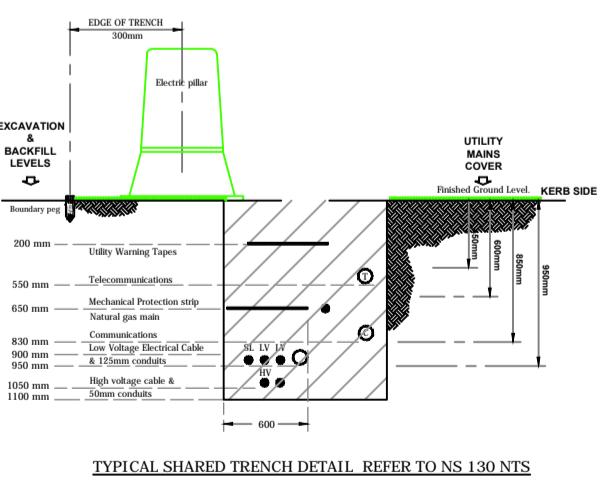
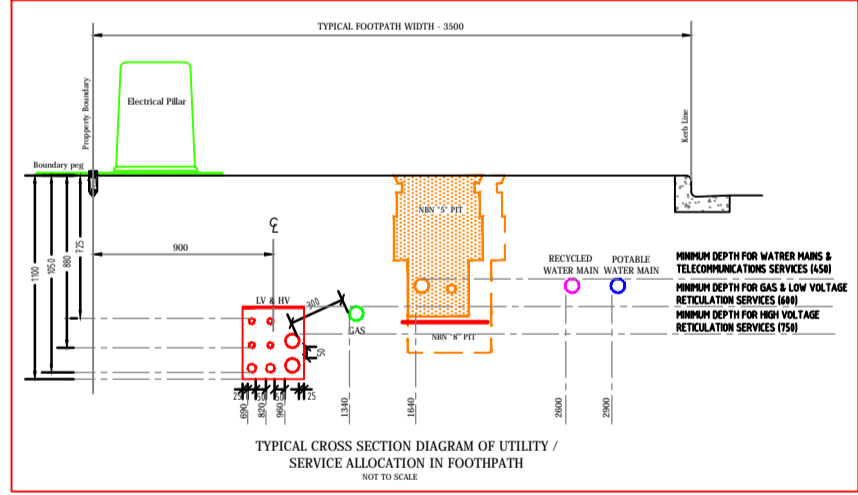
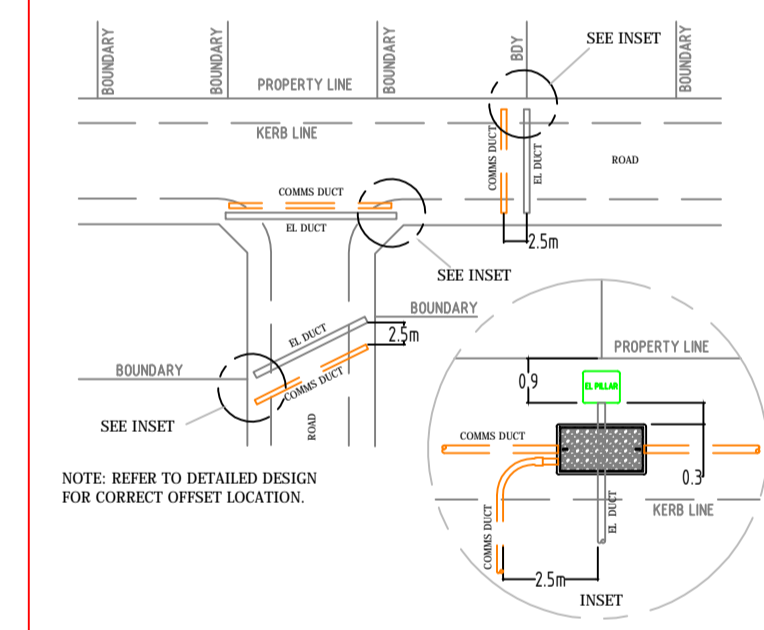

DESIGN & CONSTRUCTION AS PER MRR GUIDELINES DOCUMENT.  
 \* INSTALLING PIT AND CONDUIT INFRASTRUCTURE - GUIDELINES FOR DEVELOPERS \* - 08/07/2013

CIVIL CONTRACTORS ARE NOT TO LINK INTO EXISTING TELSTRA OR OTHER SERVICE PROVIDER NETWORK. NEW NETWORK WILL BE LINKED UNDER FUTURE PROJECT.  
 PIT AND PIPE ONLY WITH-IN THE DEVELOPMENT

**SDU Development Information**

Development Name:  
 NEW PARK  
 Developer Company:  
 WINTEN PROPERTY GROUP  
 Development Address:  
 ABELL ROAD, MARSDEN PARK  
 Authorised Rep:  
 TANIA SAINSBURY  
 Phone: 02 4720 3319  
 E-Mail: TSainsbury@jwprince.com.au  
 nbn Reference Number: STG-M000103598  
 Stage Number: STAGE 7E  
 Design Revision: 0

**BILL OF MATERIAL**  
 NO OF LOTS: 84

PITS		DUCTS		
SIZE	QTY	SIZE	QTY	MTRS
2	0	P100	17	606.5
5	25	P50	11	284.2
6	2	P20	84	642.8
8	0			
9	0			

TOTAL NUMBER OF PITS: 27  
 TOTAL NUMBER OF MANHOLES: 0  
 TOTAL NUMBER OF CONDUITS: 112  
 TOTAL LENGTH OF CONDUITS: 1533.5



REV	DATE	DRAFTER	DESCRIPTION	APPROVED
-	-	-	-	-
-	-	-	-	-
-	-	-	-	-
.D.01	28/09/2023	CIPRIAN PASCU	AS BUILT	NAME
.C.01	23/08/2022	CIPRIAN PASCU	FOR CONSTRUCTION	NAME
.B.01	24/05/2022	CIPRIAN PASCU	PRELIMINARY - ADDITIONAL LEADIN FOR DUAL OCCUPANCY LOT	NAME
.A.01	13/05/2022	CIPRIAN PASCU	PRELIMINARY	NAME

**STRICTLY CONFIDENTIAL**

NBNCO APPROVAL RECORD:

SIGNATURE	DATE
<input type="checkbox"/> DD	
<input type="checkbox"/> WD	
<input type="checkbox"/> AB	

QUALITY RECORD :

NBNCO DISCLAIMER  
 THIS DOCUMENT HAS BEEN PREPARED SOLELY FOR THE USE OF NBNCO LIMITED (ABN 86 136 533 741) FOR USE IN MAINTAINING NBNCO FACILITIES. IT HAS NOT BEEN CREATED FOR ANY OTHER USE. IT SHOULD NOT BE SCALED TO LOCATE NBNCO ASSETS. NO WARRANTY IS GIVEN THAT THE INFORMATION IS ACCURATE OR COMPLETE.

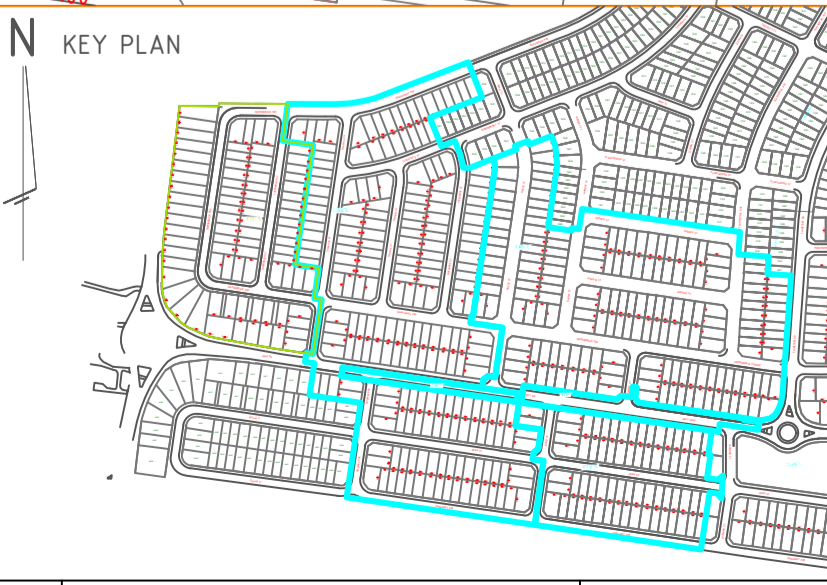
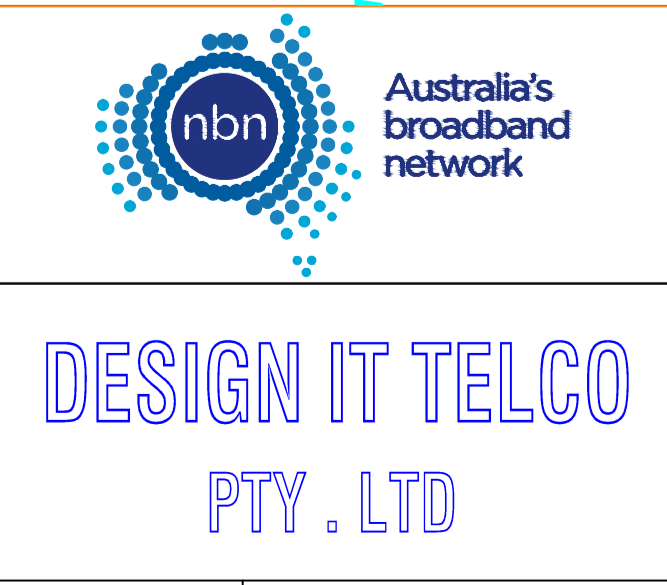

DRAWING TITLE:  
 84 LOTS SUBDIVISION - PIT & PIPE PROJECT  
 ABELL ROAD, MARSDEN PARK  
 "NEW PARK"  
 STAGE 7E  
 ENABLE#:  
 STATE: NSW REGION:  
 FSA: SAM: ADA:  
 PROJECT No: STG-M000103598  
 CADREF No: PN 36121  
 SCALE: N/A SHEET No: 1 OF 1 REV: D

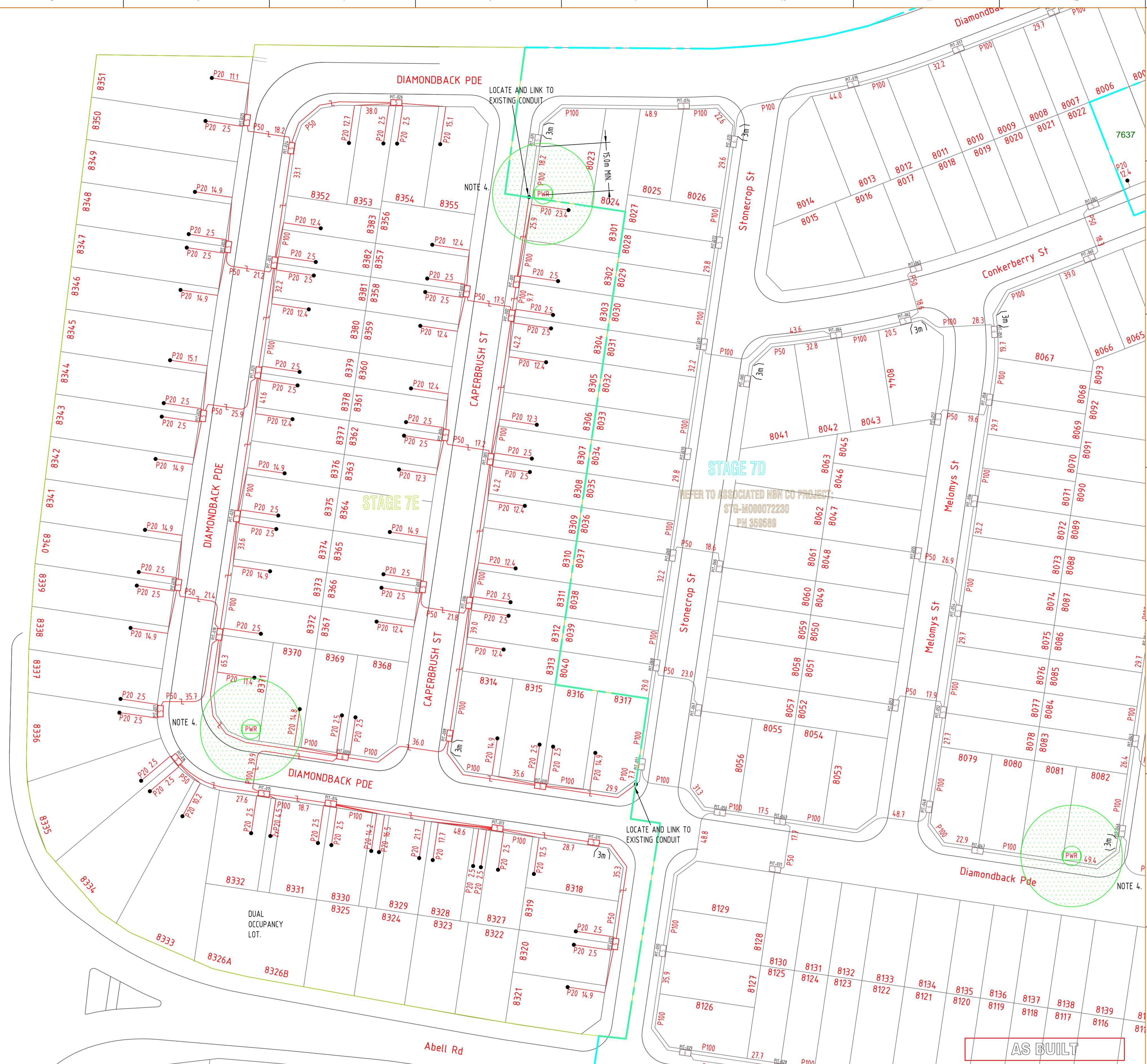

- POP** PRIVATELY OPERATED PAYPHONES
- APS** ASSISTANCE TELEPHONES (EG ELEVATOR AND ROADSIDE PHONES)
- MET** APPLY TO OTHER TYPE OF METERING POINT ( any service)
- ATM** ATM
- PRK** BANDSTAND / ROTUNDA / SPORTS FIELD STANDS / OTHER PARK BUILDING
- PSD** POINT OF SALE DEVICE (vending machine, ticket machine)
- TRF** Traffic Lights / Traffic Light Controller / Variable Speed Sign / Traffic Signal
- PBT** Public Transport (bus stop, tram stop, railway station, taxi rank, ferry wharf)
- SWT** Links / Link Pole / MV / HV Links / ABC Links / Dynamic Switch / Airbrake Switch / Isolator
- WAT** Water Infrastructure (storage, pumps, valves water supply, waste water, sewerage stations)
- GAS** Natural Gas Infrastructure
- CAM** Camera (security / traffic)
- CTL** Bridge control, swing bridge, traffic control gates, railway boom gates)
- MOB** Mobile Phone Tower / radio antenna
- LIT** Street Lighting Pole / street light controller
- CAR** Unmanned (council) car park
- PWR** Transformer / Kiosk / Pad Mount Sub-station / Pole Mount Transformer
- NAP-ID** Network Access Point (NAP)
- MPT-ID** Multiport (MPT)  
n is the number of ports (eg 4,6,8,12)
- Penetration**

**CABLE TRAY:**

STAFF WORKING ON THIS ESTIMATE PLEASE  
NOTE: The location of other authorities services which may affect this work have not been obtained by the estimator. Constructor to obtain service information before commencing.

**DANGER LASER BEAM**  
EYE PROTECTION MUST BE WORN

**SAFETY FIRST**  
SAFETY STARTS WITH YOU

- TJL-ID** Splice Joint on a Transit Cable (TJL)
- DJL-ID** Splice Joint on a Distribution Cable (DJL)
- LJL-ID** Splice Joint on a Local Cable (LJL)
- MJL-ID** Splice Joint on a Tether Cable (MJL)
- AJL-ID** Zone Terminal / Splice Joint (AJL)
- FDH-ID** Fibre Distribution Hub-FDH Cabinet with Cabinet ID shown
- PIT-ID 2** Service Drop Access Pit (650mmX280mmX565mm)
- PIT-ID 5** Network Boundary/Local Network Pit (Single Lid) (700mmX450mmX650mm)
- PIT-ID 6** Distribution/Local Network Connection Pit (Dual Lid) (1360mmX555mmX650mm)
- PIT-ID 8** Distribution/Local Network Connection Pit (1360mmX555mmX860mm)
- PIT-ID 9** Fibre Distribution Hub (FDH) Pit (2000mmX555mmX900mm)
- NTD** Shared Trench
- NTD** nbn NTD
- OBBU** NBN Optional Battery Backup Unit
- PDH** nbn Premises Distribution Hub
- CTL** nbn Cable Transition Location
- FDT** nbn Fibre Distribution Terminal
- FIP** nbn NTD Fire Indicator Panel
- Riser** Riser
- LIFT** nbn NTD LIFT
- AP** Access Panel
- SEC** nbn NTD Security
- CET** nbn Communications Earth Terminal
- DES QTY** Example of descriptor box that will show the type of work and the quantity involved
- nbn manhole**
- Existing Telstra manhole**
- FAN AAAA** Fan Access Node site (FAN)
- 138A<sup>RX</sup><sub>CX</sub>** Multi Dwelling Unit (MDU)

- DEPTH-- ALIGN--** DEPTH OVER ALIGNMENT SYMBOL TO BE USED WITH EVERY MARKER POST
- X** Symbol to be used when replacing/removing existing network
- PCD** Premise Connection Device (PCD)
- POLE-ID** Pole (showing pole identity)

- 5** Existing Telstra Pit ( 2,3,4,5,6,7,8,9 ) Telstra exchange
- M** Example of Telstra Major Conduit Layout with Proposed duct marked to be used by NBN
- M < - >** NBN MARKER POST MARKER POST TO BE NUMBERED

### CONDUIT CONFIGURATION

CONDUITS AND DUCTS ARE IN LAYER :  
< L460 NBN Support - Underground >  
AND TERMINOLOGY CATEGORIZED INTO TWO GROUPS IN THE DRAWING AS PER BELOW:

- 1- DUCT USED WITH LOCAL NETWORK
- 2-CONDUIT USED WITH LEAD-IN DROPS

ATTRIBUTES ATTACHED ARE AS SHOWN

### CABLE CONFIGURATION

CABLE TYPE:  
CABLES DIVIDE INTO FOLLOWING CATEGORIES AND ARE COLOUR CODED:

- TRANSIT CABLES COLOUR NO: 1 312F
- DISTRIBUTION CABLES COLOUR NO: 190 288F
- LOCAL CABLES COLOUR NO: 4 144F
- TETHER CABLES COLOUR NO: 3 12F
- LEAD IN (DROP) CABLES COLOUR NO: 5 1F

CABLE LOCATION:  
CABLE LOCATIONS DETERMINES WHERE THE CABLE IS USED AS PER BELOW:

- IN-CONDUIT 288F
- AERIAL 144F
- BURIED 96F

EXAMPLE:  
144 FIBRE AERIAL LOCAL CABLE 144F  
1 FIBRE BURIED DROP CABLE 1F  
432 FIBRE IN-CONDUIT TRANSIT CABLE 48F

CABLE SIZE:  
CABLE SIZE IS THE TOTAL NUMBER OF OPTIC FIBRES IN THE CABLE AND IS DETERMINED BY A NUMBER FOLLOWED BY F (FIBRE) OR R (RIBBON) IN THE MIDDLE OF THE LINE TYPE

LINE TYPES ARE CATEGORIZED INTO 3 TYPES:  
1- IN-CONDUIT: (XXXXF) 312F, ...  
2- AERIAL: (XXXXF\_A) 144\_A, ...  
3- BURIED: (XXXXF\_B) 12\_B, ...

- FSA Boundary
- FSAM Boundary
- FDA Boundary



REV	DATE	DRAFTER	DESCRIPTION	APPROVED
-				
-				
-				
-				
-D.01	28/09/2023	CIPRIAN PASCU	AS BUILT	NAME
.C.01	23/08/2022	CIPRIAN PASCU	FOR CONSTRUCTION	NAME
.B.01	24/05/2022	CIPRIAN PASCU	PRELIMINARY - ADDITIONAL LEADIN FOR DUAL OCCUPANCY LOT	NAME
.A.01	13/05/2022	CIPRIAN PASCU	PRELIMINARY	NAME

**STRICTLY CONFIDENTIAL**

NBNCO APPROVAL RECORD:

SIGNATURE	DATE
<input type="checkbox"/> DD	_____
<input type="checkbox"/> WD	_____
<input type="checkbox"/> AB	_____

QUALITY RECORD:

NBNCO DISCLAIMER  
THIS DOCUMENT HAS BEEN PREPARED SOLELY FOR THE USE OF NBNCO LIMITED (ABN 86 136 533 741) FOR USE IN MAINTAINING NBNCO FACILITIES. IT HAS NOT BEEN CREATED FOR ANY OTHER USE. IT SHOULD NOT BE SCALED TO LOCATE NBNCO ASSETS. NO WARRANTY IS GIVEN THAT THE INFORMATION IS ACCURATE OR COMPLETE.

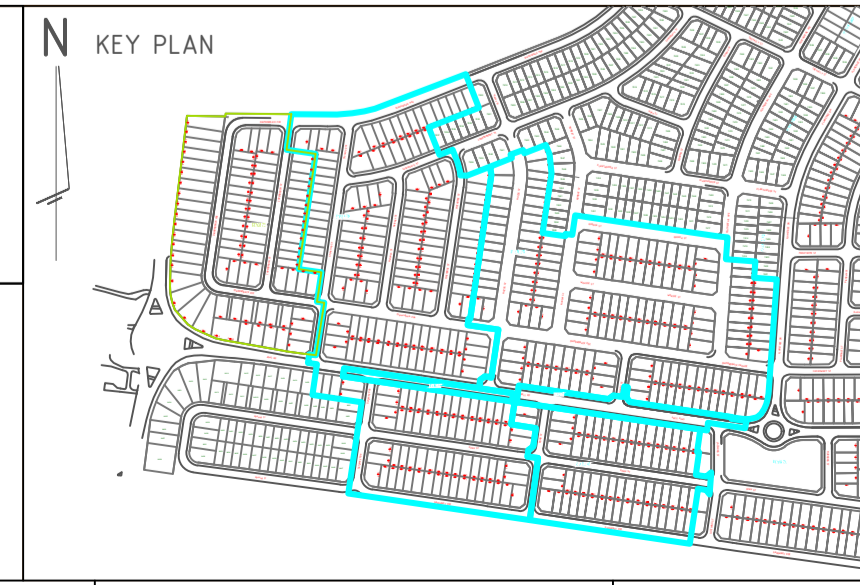
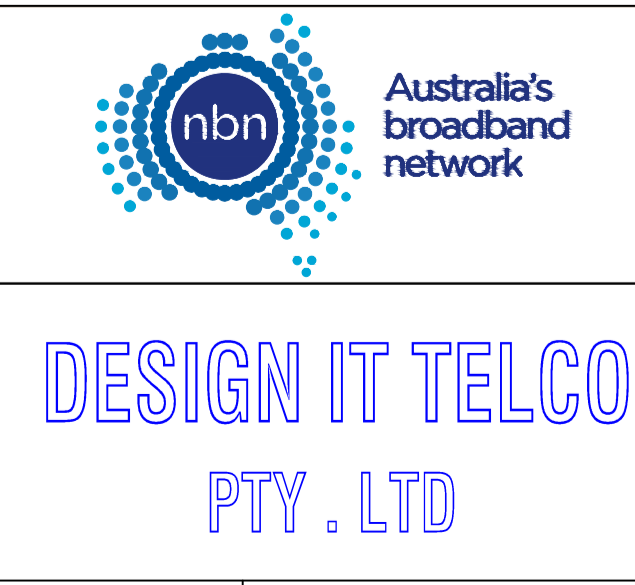

DRAWING TITLE:  
84 LOTS SUBDIVISION - PIT & PIPE PROJECT  
ABELL ROAD, MARSDEN PARK  
"NEW PARK"  
STAGE 7E

ENABLE#:

STATE: NSW	REGION:	
FSA:	SAM:	ADA:
PROJECT No: STG-M000103598		
CADREF No: PN 36121		
SCALE N/A	SHEET No. OF	REV. D