

- POP** PRIVATELY OPERATED PAYPHONES
- APS** ASSISTANCE TELEPHONES (EG ELEVATOR AND ROADSIDE PHONES)
- MET** APPLY TO OTHER TYPE OF METERING POINT (any service)
- ATM** ATM
- PRK** BANDSTAND / ROTUNDA / SPORTS FIELD STANDS / OTHER PARK BUILDING
- PSD** POINT OF SALE DEVICE (vending machine, ticket machine)
- TRF** Traffic Lights / Traffic Light Controller / Variable Speed Sign / Traffic Signal
- PBT** Public Transport (bus stop, tram stop, railway station, taxi rank, ferry wharf)
- SWT** Links / Link Pole / MV / HV Links / ABC Links / Dynamic Switch / Airbrake Switch / Isolator
- WAT** Water Infrastructure (storage, pumps, valves water supply, waste water, sewerage stations)
- GAS** Natural Gas Infrastructure
- CAM** Camera (security / traffic)
- CTL** Bridge control, swing bridge, traffic control gates, railway boom gates)
- MOB** Mobile Phone Tower / radio antenna
- LIT** Street Lighting Pole / street light controller
- CAR** Unmanned (council) car park
- PWR** Transformer / Kiosk / Pad Mount Sub-station / Pole Mount Transformer
- NAP-ID** Network Access Point (NAP)
- MPT-ID** Multiport (MPT)
n is the number of ports (eg 4,6,8,12)
- Penetration**

CABLE TRAY:

STAFF WORKING ON THIS ESTIMATE PLEASE NOTE:
The location of other authorities services which may affect this work have not been obtained by the estimator. Constructor to obtain service information before commencing.



SAFETY FIRST
SAFETY STARTS WITH YOU

- TJL-ID** Splice Joint on a Transit Cable (TJL)
- DJL-ID** Splice Joint on a Distribution Cable (DJL)
- LJL-ID** Splice Joint on a Local Cable (LJL)
- MJL-ID** Splice Joint on a Tether Cable (MJL)
- AJL-ID** Zone Terminal / Splice Joint (AJL)
- FDH-ID** Fibre Distribution Hub-FDH Cabinet with Cabinet ID shown
- PIT-ID 2** Service Drop Access Pit (650mmX280mmX565mm)
- PIT-ID 5** Network Boundary/Local Network Pit (Single Lid) (700mmX450mmX650mm)
- PIT-ID 6** Distribution/Local Network Connection Pit (Dual Lid) (1360mmX555mmX650mm)
- PIT-ID 8** Distribution/Local Network Connection Pit (1360mmX555mmX860mm)
- PIT-ID 9** Fibre Distribution Hub (FDH) Pit (2000mmX555mmX900mm)
- NTD** Shared Trench
- NTD** nbn NTD
- OBBU** NBN Optional Battery Backup Unit
- PDH** nbn Premises Distribution Hub
- CTL** nbn Cable Transition Location
- FDT** nbn Fibre Distribution Terminal
- FIP** nbn NTD Fire Indicator Panel
- Riser** Riser
- LIFT** nbn NTD LIFT
- AP** Access Panel
- SEC** nbn NTD Security
- CET** nbn Communications Earth Terminal
- DES QTY** Example of descriptor box that will show the type of work and the quantity involved
- nbn manhole**
- Existing Telstra manhole**
- FAN AAAA** Fan Access Node site (FAN)
- 138A^{RX}_{CX}** Multi Dwelling Unit (MDU)

- DEPTH-- ALIGN--** DEPTH OVER ALIGNMENT SYMBOL TO BE USED WITH EVERY MARKER POST
- X** Symbol to be used when replacing/removing existing network
- PCD** Premise Connection Device (PCD)
- POLE-ID** Pole (showing pole identity)

- 5** Existing Telstra Pit (2,3,4,5,6,7,8,9) Telstra exchange
- M** Example of Telstra Major Conduit Layout with Proposed duct marked to be used by NBN
- M** NBN MARKER POST MARKER POST TO BE NUMBERED

CONDUIT CONFIGURATION

CONDUITS AND DUCTS ARE IN LAYER :
< L460 NBN Support - Underground >
AND TERMINOLOGY CATEGORIZED INTO TWO GROUPS IN THE DRAWING AS PER BELOW:

- 1- DUCT USED WITH LOCAL NETWORK
- 2-CONDUIT USED WITH LEAD-IN DROPS

ATTRIBUTES ATTACHED ARE AS SHOWN

CABLE CONFIGURATION

CABLE TYPE:
CABLES DIVIDE INTO FOLLOWING CATEGORIES AND ARE COLOUR CODED:

- TRANSIT CABLES COLOUR NO: 1 312F
- DISTRIBUTION CABLES COLOUR NO: 190 288F
- LOCAL CABLES COLOUR NO: 4 144F
- TETHER CABLES COLOUR NO: 3 12F
- LEAD IN (DROP) CABLES COLOUR NO: 5 1F

CABLE LOCATION:
CABLE LOCATIONS DETERMINES WHERE THE CABLE IS USED AS PER BELOW:

- IN-CONDUIT 288F
- AERIAL 144F
- BURIED 96F

EXAMPLE:
144 FIBRE AERIAL LOCAL CABLE 144F
1 FIBRE BURIED DROP CABLE 1F
432 FIBRE IN-CONDUIT TRANSIT CABLE 48F

CABLE SIZE:
CABLE SIZE IS THE TOTAL NUMBER OF OPTIC FIBRES IN THE CABLE AND IS DETERMINED BY A NUMBER FOLLOWED BY F (FIBRE) OR R (RIBBON) IN THE MIDDLE OF THE LINE TYPE

LINE TYPES ARE CATEGORIZED INTO 3 TYPES:

- 1- IN-CONDUIT: (XXXXF) 312F, ...
- 2- AERIAL: (XXXXF_A) 144_A, ...
- 3- BURIED: (XXXXF_B) 12_B, ...

BOUNDARIES:
FSA Boundary
FSAM Boundary
FDA Boundary



REV	DATE	DRAFTER	DESCRIPTION	APPROVED
-				
-				
-				
E-01	31/10/2024	CIPRIAN PASCU	AS BUILT	NAME
_D.01	17/03/2024	CIPRIAN PASCU	RE-DESIGN - PIT & PIPE AMENDED	NAME
_C.01	20/02/2023	CIPRIAN PASCU	FOR CONSTRUCTION -- LEAD-IN ADDED	NAME
_B.01	27/07/2022	CIPRIAN PASCU	FOR CONSTRUCTION	NAME
_A.01	28/02/2022	CIPRIAN PASCU	PRELIMINARY	NAME

STRICTLY CONFIDENTIAL

NBNCO APPROVAL RECORD:

SIGNATURE	DATE
<input type="checkbox"/> DD	
<input type="checkbox"/> WD	
<input type="checkbox"/> AB	

QUALITY RECORD:

NBNCO DISCLAIMER
THIS DOCUMENT HAS BEEN PREPARED SOLELY FOR THE USE OF NBNCO LIMITED (ABN 86 136 533 741) FOR USE IN MAINTAINING NBNCO FACILITIES. IT HAS NOT BEEN CREATED FOR ANY OTHER USE. IT SHOULD NOT BE SCALED TO LOCATE NBNCO ASSETS. NO WARRANTY IS GIVEN THAT THE INFORMATION IS ACCURATE OR COMPLETE.

DESIGN IT TELCO
PTY . LTD

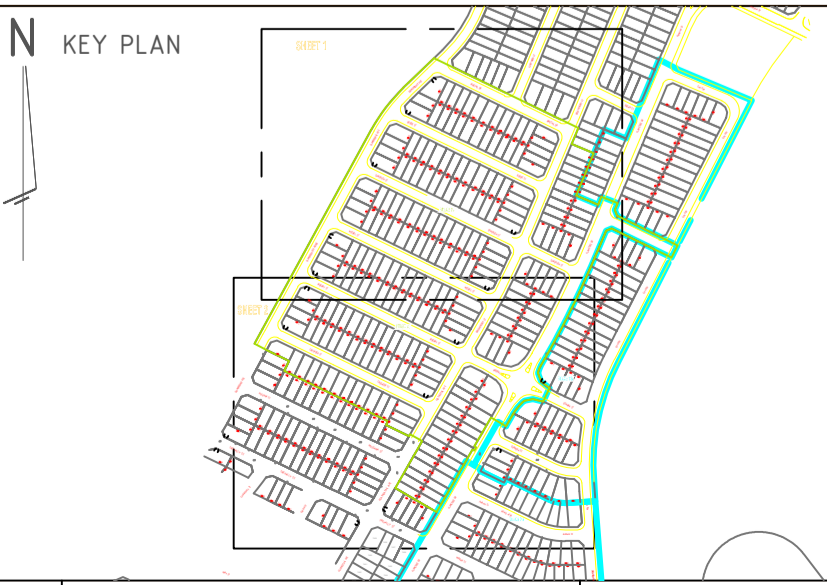

DRAWING TITLE:
252 LOTS SUBDIVISION - PIT & PIPE PROJECT
ABELL ROAD, MARSDEN PARK
"NEW PARK"
STAGE 7J

ENABLE#:

STATE: NSW REGION:

FSA: SAM: ADA:

PROJECT No: STG-M000089291

CADREF No: PN 36125

SCALE N/A SHEET No. OF REV. E

NOTES:

- ALL PIT & PIPE INFRASTRUCTURE IS TO BE INSTALLED ACCORDING TO NBN Co's CONDUIT AND PIT NETWORK GUIDELINES (DOCUMENT NUMBER NBN-TE-CTO-194 VERSION 7.0 OR LATER).
- DENOTES SHARED TRENCHES
- CONDUITS TO BE INSTALLED IN SHARED TRENCHES, BUT NOT VERTICALLY ABOVE OR BELOW OTHER UTILITIES. CONDUITS MAY BE INSTALLED WITHIN THE ENDEAVOUR ENERGY ASSET ALLOCATION SPACE IF MANDATORY RADIAL SEPARATION FROM OTHER SERVICES IS MAINTAINED AT ALL TIMES. MINIMUM SEPARATIONS ARE:
 - GAS MAIN (±75mm) - 150mm
 - GAS MAIN (±110mm) - 300mm
 - LV CABLES - 100mm
 - HV CABLES - 300mm
 REFER TYPICAL CROSS SECTION DIAGRAM.
- NO PITS TO BE INSTALLED WITHIN 15m FROM ANY PAD MOUNTED TRANSFORMER. I.E. NO PITS TO BE INSTALLED WITHIN THE EPR (Earth Potential Rise) ZONE.
- PITS TO BE INSTALLED CLEAR OF PROPOSED DRIVEWAYS
- EXCLUSIVE ROAD CROSSING
- FOR REMOVAL/RELOCATION OF EXISTING COMMS POLES & OVERHEAD NETWORK - DEVELOPER AND/OR PROJECT MANAGER IS TO LIAISE WITH:
 * TELSTRA - NETWORK INTEGRITY SERVICES
 PH: 1800 810 443 - NetworkIntegrity@team.telstra.com
 * NBN RELOCATION WORKS GROUP
 RelocationWorks@nbnco.com.au

SHEET 1

SDU Development Information

Development Name: "NEW PARK"	
Developer Company: WINTEN PROPERTY GROUP	
Development Address: ABELL ROAD, MARSDEN PARK	
Authorised Rep: TANA SAINSBURY	
Phone: 02 4720 3319	
E-Mail: TSainsbury@jwprince.com.au	
nbn Reference Number: STG-M000089291	Stage Number: STAGE 7J
	Design Revision: E

BILL OF MATERIAL

NO OF LOTS: 252				
PITS		DUCTS		
SIZE	QTY	SIZE	QTY	MTRS
2	0	P100	82	284.65
5	72	P50	29	733.6
6	18	P20	252	1779.1
8	4			
9	0			
TOTAL NUMBER OF PITS: 94				
TOTAL NUMBER OF MANHOLES: 0				
TOTAL NUMBER OF CONDUITS: 364				
TOTAL LENGTH OF CONDUITS: 5359.2				

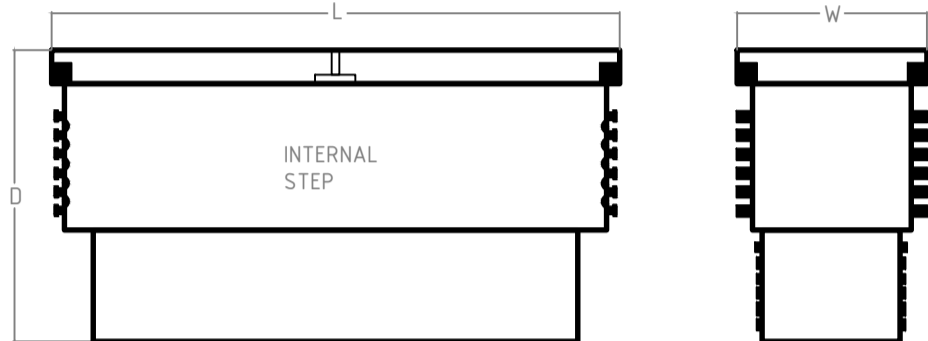

NBN NOMINAL DIMENSIONS (mm)			
PIT TYPE	L	W	D
Local Network Pit/Network Boundary Pit	700	450	650
Local Network Connection Pit	1360	555	860
Distribution Pit	1360	555	860
FDH PIT	2000	555	900

TYPICAL ROAD CROSSING CONFIGURATION

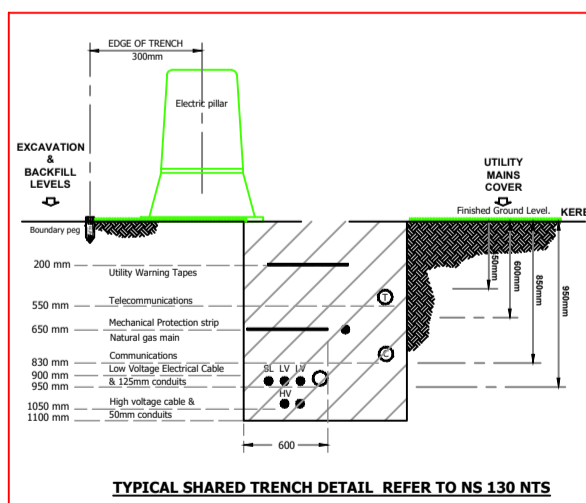
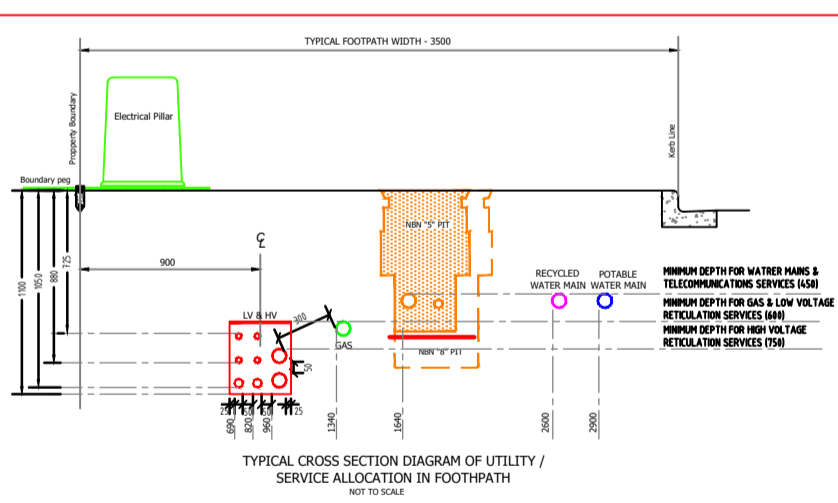
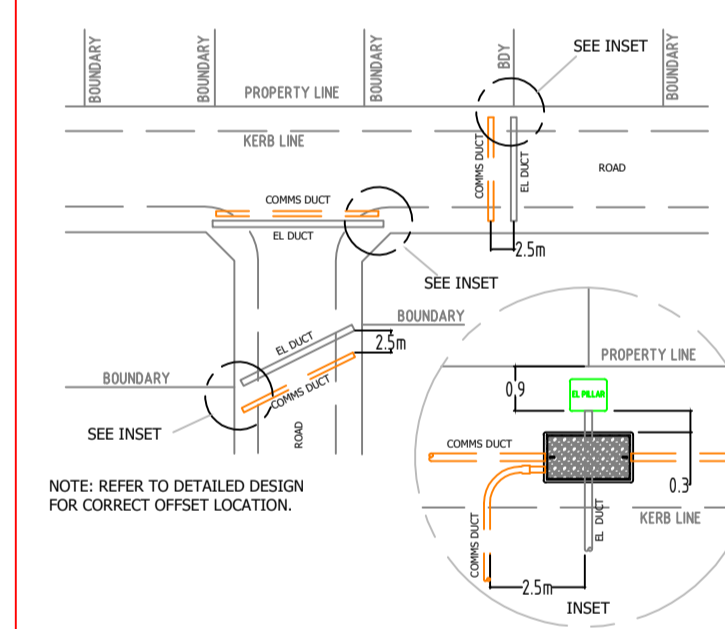

DESIGN & CONSTRUCTION AS PER NBN GUIDELINES DOCUMENT.
 * INSTALLING PIT AND CONDUIT INFRASTRUCTURE - GUIDELINES FOR DEVELOPERS - 08/07/2018

CIVIL CONTRACTORS ARE NOT TO LINK INTO EXISTING TELSTRA OR OTHER SERVICE PROVIDER NETWORK. NEW NETWORK WILL BE LINKED UNDER FUTURE PROJECT.
 PIT AND PIPE ONLY WITH-IN THE DEVELOPMENT



REV	DATE	DRAFTER	DESCRIPTION	APPROVED	NAME
-					
-					
E-01	31/10/2024	CIPRIAN PASCU	AS BUILT		NAME
D-01	17/03/2024	CIPRIAN PASCU	RE-DESIGN - PIT & PIPE AMENDED		NAME
C-01	20/02/2023	CIPRIAN PASCU	FOR CONSTRUCTION -- LEAD-IN ADDED		NAME
B-01	27/07/2022	CIPRIAN PASCU	FOR CONSTRUCTION		NAME
A-01	28/02/2022	CIPRIAN PASCU	PRELIMINARY		NAME

STRICTLY CONFIDENTIAL

NBNC APPROVAL RECORD:	
SIGNATURE	DATE
<input type="checkbox"/> DD	_____
<input type="checkbox"/> WD	_____
<input type="checkbox"/> AB	_____
QUALITY RECORD:	
NBNC DISCLAIMER	
THIS DOCUMENT HAS BEEN PREPARED SOLELY FOR THE USE OF NBNC LIMITED (ABN 86 136 533 741) FOR USE IN MAINTAINING NBNC FACILITIES. IT HAS NOT BEEN CREATED FOR ANY OTHER USE. IT SHOULD NOT BE SCALED TO LOCATE NBNC ASSETS. NO WARRANTY IS GIVEN THAT THE INFORMATION IS ACCURATE OR COMPLETE.	



DESIGN IT TELCO
PTY. LTD

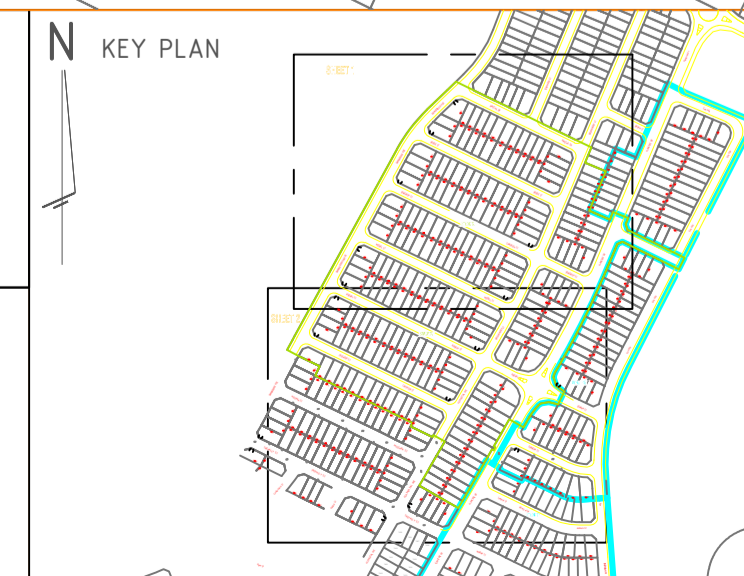

DRAWING TITLE: 252 LOTS SUBDIVISION - PIT & PIPE PROJECT ABELL ROAD, MARSDEN PARK "NEW PARK" STAGE 7J		
ENABLE#:		
STATE: NSW	REGION:	
FSA:	SAM:	ADA:
PROJECT No: STG-M000089291		
CADREF No: PN 36125		
SCALE N/A	SHEET No. 1 OF 2	REV. E

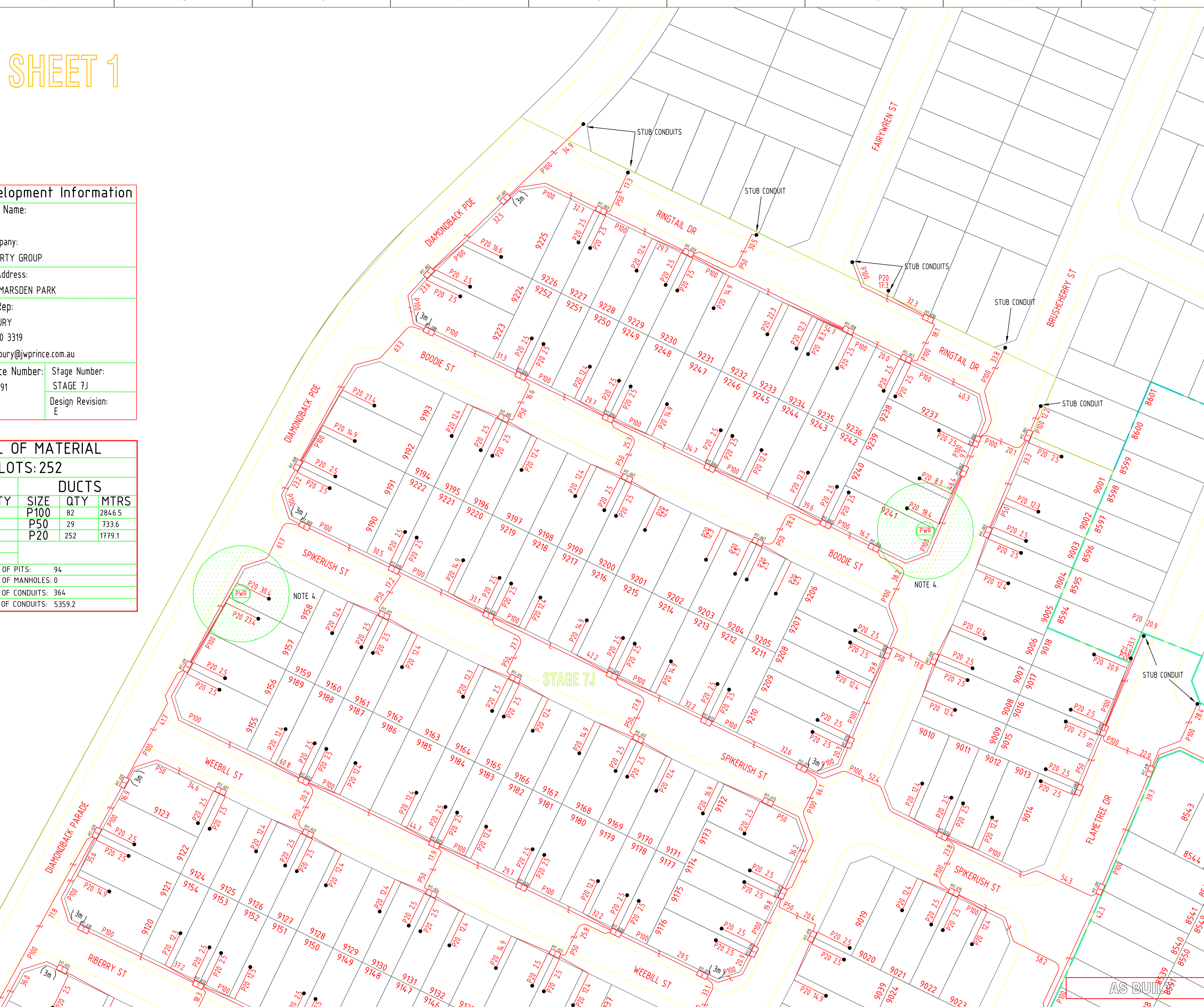

- NOTES:**
- ALL PIT & PIPE INFRASTRUCTURE IS TO BE INSTALLED ACCORDING TO NBN Co's CONDUIT AND PIT NETWORK GUIDELINES (DOCUMENT NUMBER NBN-TE-CTO-194 VERSION 7.0 OR LATER).
 - DENOTES SHARED TRENCHES
 - CONDUITS TO BE INSTALLED IN SHARED TRENCHES, BUT NOT VERTICALLY ABOVE OR BELOW OTHER UTILITIES. CONDUITS MAY BE INSTALLED WITHIN THE ENDEAVOUR ENERGY ASSET ALLOCATION SPACE IF MANDATORY RADIAL SEPARATION FROM OTHER SERVICES IS MAINTAINED AT ALL TIMES. MINIMUM SEPARATIONS ARE:
 - GAS MAIN (±Ø75mm) - 150mm
 - GAS MAIN (±Ø110mm) - 300mm
 - LV CABLES - 100mm
 - HV CABLES - 300mm
 REFER TYPICAL CROSS SECTION DIAGRAM.
 - NO PITS TO BE INSTALLED WITHIN 15m FROM ANY PAD MOUNTED TRANSFORMER. I.E. NO PITS TO BE INSTALLED WITHIN THE EPR (Earth Potential Rise) ZONE.
 - PITS TO BE INSTALLED CLEAR OF PROPOSED DRIVEWAYS
 - EXCLUSIVE ROAD CROSSING
 - FOR REMOVAL/RELOCATION OF EXISTING COMMS POLES & OVERHEAD NETWORK - DEVELOPER AND/OR PROJECT MANAGER IS TO LIAISE WITH:
 * TELSTRA - NETWORK INTEGRITY SERVICES
 PH: 1800 810 443 - NetworkIntegrity@team.telstra.com
 * NBN RELOCATION WORKS GROUP
 RelocationWorks@nbnco.com.au

SHEET 2

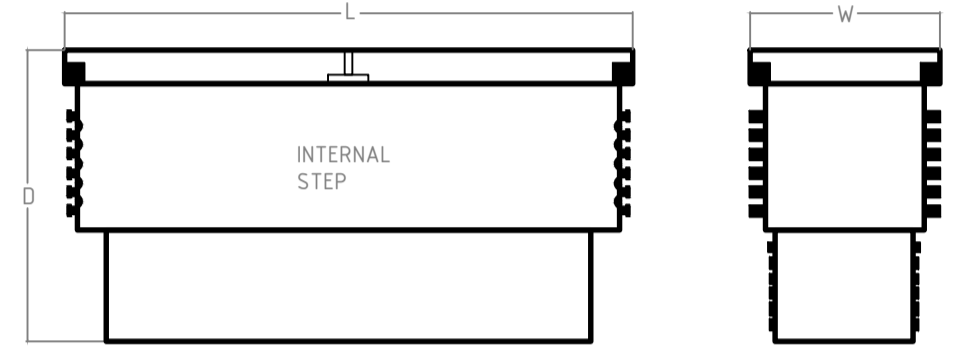

NBN NOMINAL DIMENSIONS (mm)			
PIT TYPE	L	W	D
Local Network Pit/Network Boundary Pit	700	450	650
Local Network Connection Pit	1360	555	860
Distribution Pit	1360	555	860
FDH PIT	2000	555	900

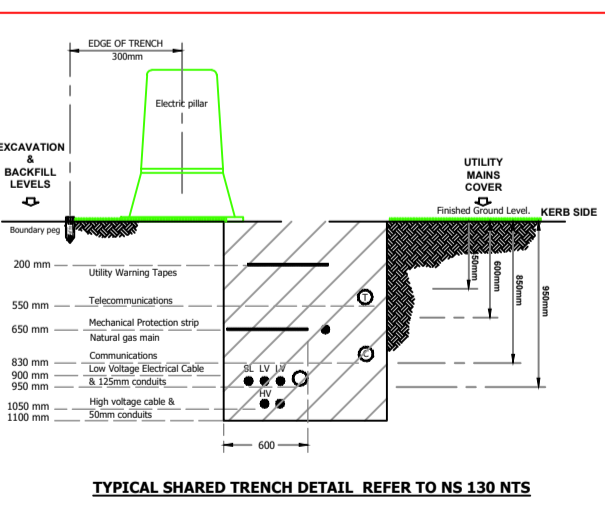
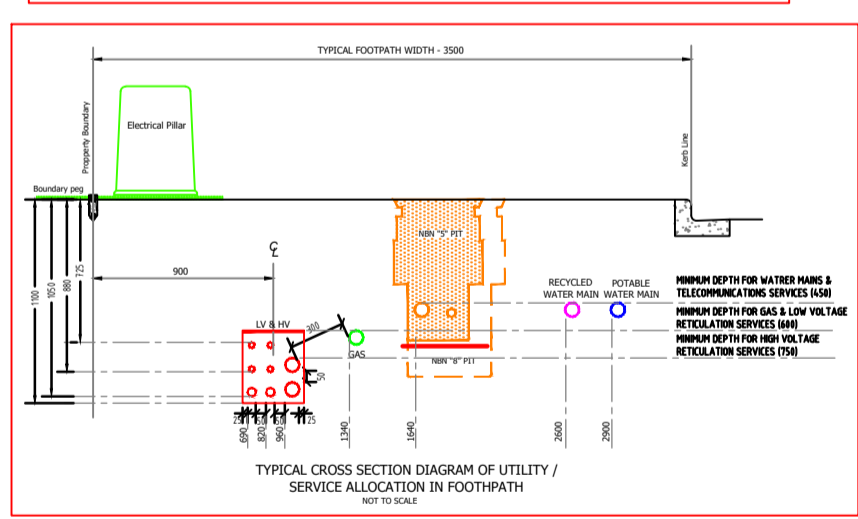
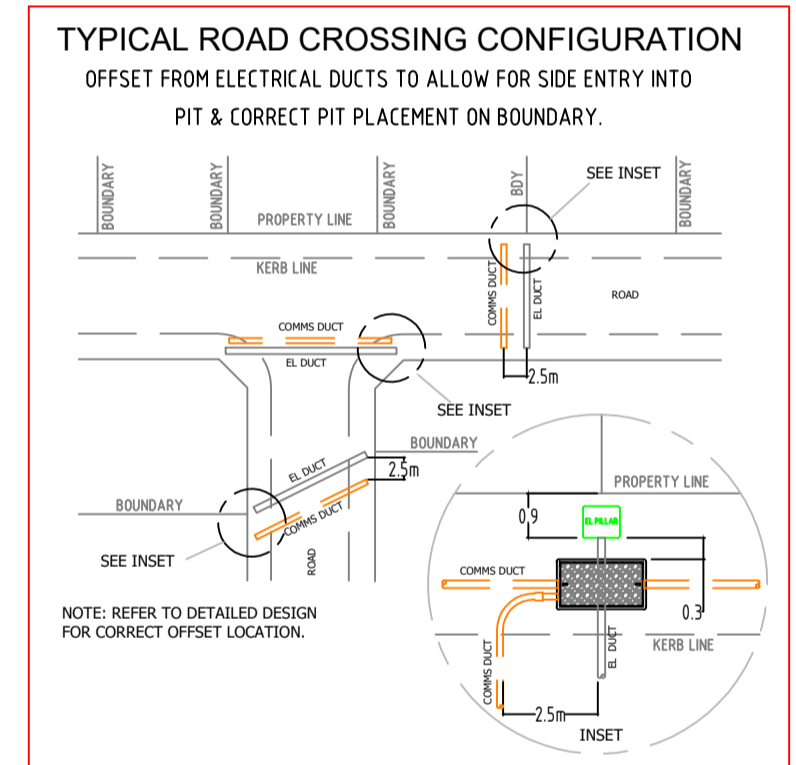

DESIGN & CONSTRUCTION AS PER NBN GUIDELINES DOCUMENT.
 * INSTALLING PIT AND CONDUIT INFRASTRUCTURE - GUIDELINES FOR DEVELOPERS - 08/07/2018

CIVIL CONTRACTORS ARE NOT TO LINK INTO EXISTING TELSTRA OR OTHER SERVICE PROVIDER NETWORK. NEW NETWORK WILL BE LINKED UNDER FUTURE PROJECT.
 PIT AND PIPE ONLY WITH-IN THE DEVELOPMENT

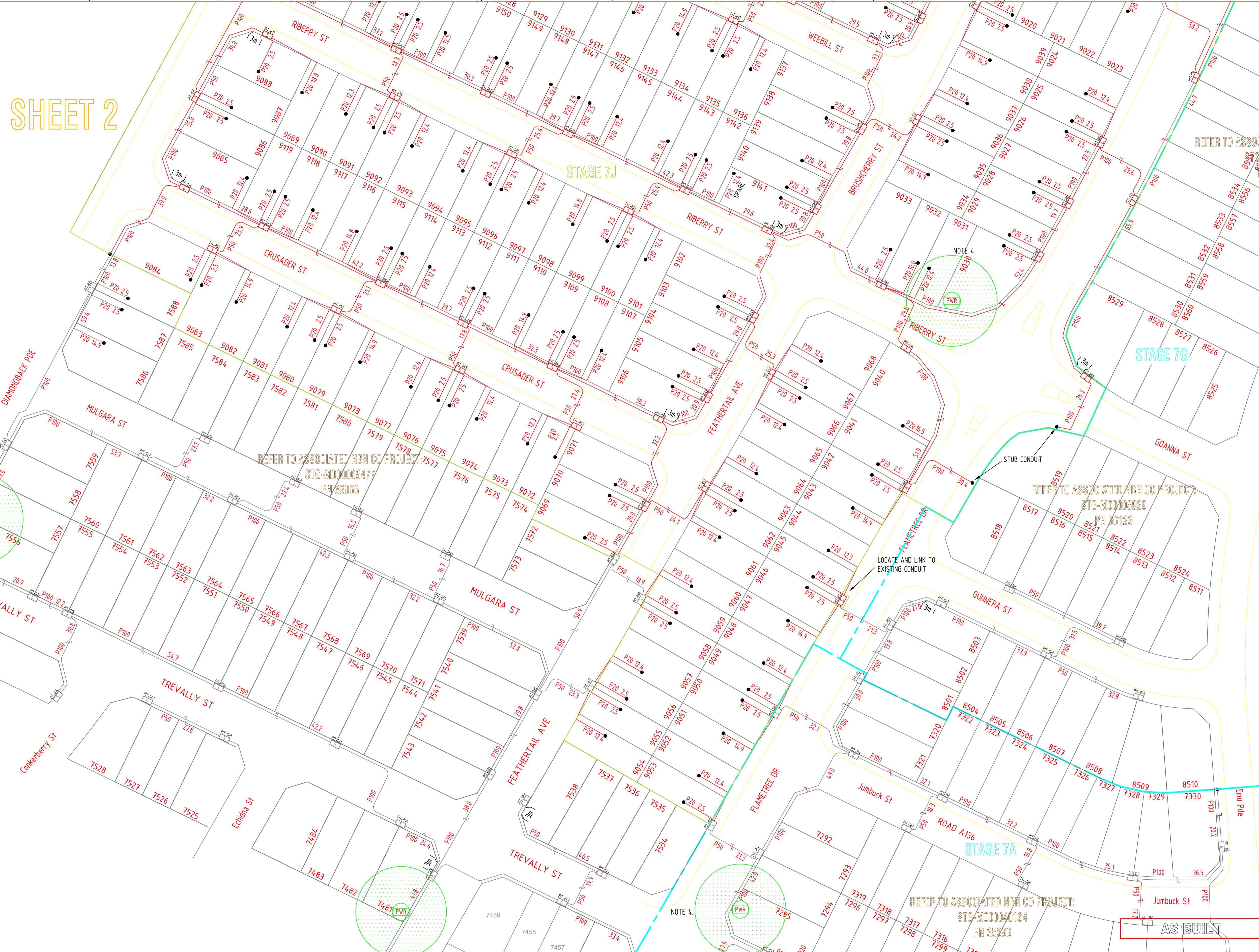

REV	DATE	DRAFTER	DESCRIPTION	APPROVED
-	-	-	-	-
-E.01	31/10/2024	CIPRIAN PASCU	AS BUILT	NAME
-D.01	17/03/2024	CIPRIAN PASCU	RE-DESIGN - PIT & PIPE AMENDED	NAME
-C.01	20/02/2023	CIPRIAN PASCU	FOR CONSTRUCTION -- LEAD-IN ADDED	NAME
-B.01	27/07/2022	CIPRIAN PASCU	FOR CONSTRUCTION	NAME
-A.01	28/02/2022	CIPRIAN PASCU	PRELIMINARY	NAME

STRICTLY CONFIDENTIAL

NBNCO APPROVAL RECORD:

SIGNATURE	DATE
<input type="checkbox"/> DD	_____
<input type="checkbox"/> WD	_____
<input type="checkbox"/> AB	_____

QUALITY RECORD:

NBNCO DISCLAIMER:
 THIS DOCUMENT HAS BEEN PREPARED SOLELY FOR THE USE OF NBNCO LIMITED (ABN 86 136 533 741) FOR USE IN MAINTAINING NBNCO FACILITIES. IT HAS NOT BEEN CREATED FOR ANY OTHER USE. IT SHOULD NOT BE SCALED TO LOCATE NBNCO ASSETS. NO WARRANTY IS GIVEN THAT THE INFORMATION IS ACCURATE OR COMPLETE.

DESIGN IT TELCO PTY. LTD

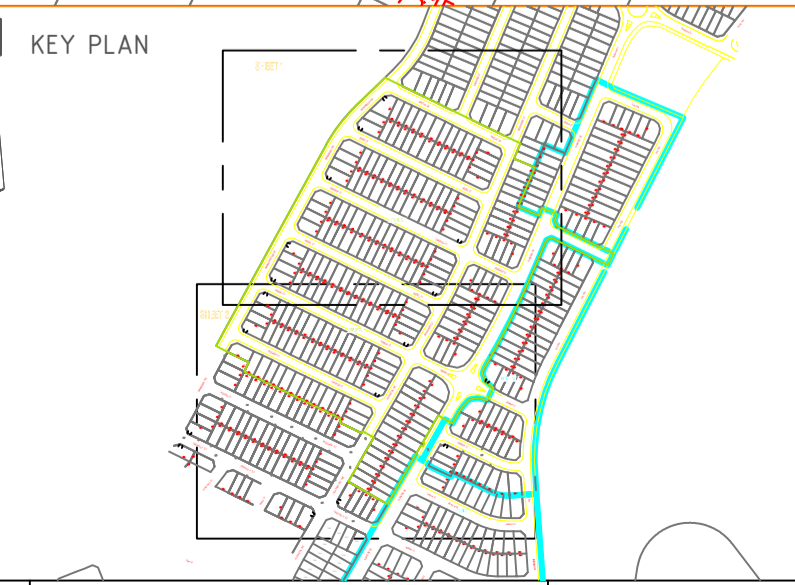

DRAWING TITLE:
 252 LOTS SUBDIVISION - PIT & PIPE PROJECT
 ABELL ROAD, MARSDEN PARK
 "NEW PARK"
 STAGE 7J

ENABLE#:

STATE: NSW	REGION:	
FSA:	SAM:	ADA:
PROJECT No: STG-M000089291		
CADREF No: PN 36125		
SCALE: N/A	SHEET No: 2	OF 2
	REV: E	