

- POP** PRIVATELY OPERATED PAYPHONES
- APS** ASSISTANCE TELEPHONES (EG ELEVATOR AND ROADSIDE PHONES)
- MET** APPLY TO OTHER TYPE OF METERING POINT (any service)
- ATM** ATM
- PRK** BANDSTAND / ROTUNDA / SPORTS FIELD STANDS / OTHER PARK BUILDING
- PSD** POINT OF SALE DEVICE (vending machine, ticket machine)
- TRF** Traffic Lights / Traffic Light Controller / Variable Speed Sign / Traffic Signal
- PBT** Public Transport (bus stop, tram stop, railway station, taxi rank, ferry wharf)
- SWT** Links / Link Pole / MV / HV Links / ABC Links / Dynamic Switch / Airbrake Switch / Isolator
- WAT** Water Infrastructure (storage, pumps, valves water supply, waste water, sewerage stations)
- GAS** Natural Gas Infrastructure
- CAM** Camera (security / traffic)
- CTL** Bridge control, swing bridge, traffic control gates, railway boom gates)
- MOB** Mobile Phone Tower / radio antenna
- LIT** Street Lighting Pole / street light controller
- CAR** Unmanned (council) car park
- PWR** Transformer / Kiosk / Pad Mount Sub-station / Pole Mount Transformer
- NAP-ID** Network Access Point (NAP)
- MPT-ID** Multipoint (MPT)
n is the number of ports (eg 4,6,8,12)

- TJL-ID** Splice Joint on a Transit Cable (TJL)
- DJL-ID** Splice Joint on a Distribution Cable (DJL)
- LJL-ID** Splice Joint on a Local Cable (LJL)
- MJL-ID** Splice Joint on a Tether Cable (MJL)
- AJL-ID** Zone Terminal / Splice Joint (AJL)
- FDH-ID** Fibre Distribution Hub-FDH Cabinet with Cabinet ID shown
- PIT-ID 2** Service Drop Access Pit (650mmX280mmX565mm)
- PIT-ID 5** Network Boundary/Local Network Pit (Single Lid) (700mmX450mmX650mm)
- PIT-ID 6** Distribution/Local Network Connection Pit (Dual Lid) (1360mmX555mmX650mm)
- PIT-ID 8** Distribution/Local Network Connection Pit (1360mmX555mmX860mm)
- PIT-ID 9** Fibre Distribution Hub (FDH) Pit (2000mmX555mmX900mm)
- Existing Telstra manhole
- Existing Telstra Pit (2,3,4,5,6,7,8,9)
- Telstra exchange
- Example of Telstra Major Conduit Layout with Proposed duct marked to be used by NBN
- M** < - > NBN MARKER POST
MARKER POST TO BE NUMBERED
- DES QTY** Example of descriptor box that will show the type of work and the quantity involved
- PCD** Premise Connection Device (PCD)
- Pole (showing pole identity)
- POLE-ID**
- FAN Access Node site (FAN)
- 138A** ^{RX} _{CX} Multi Dwelling Unit (MDU)

DEPTH--
ALIGN-- DEPTH OVER ALIGNMENT SYMBOL TO BE USED WITH EVERY MARKER POST

Symbol to be used when replacing/removing existing network

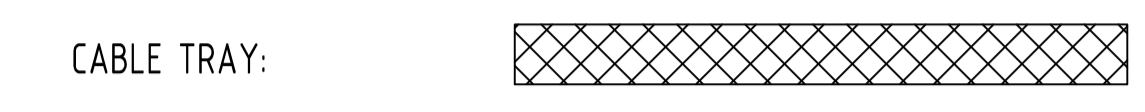

CONDUIT CONFIGURATION

CONDUITS AND DUCTS ARE IN LAYER :
< L460 NBN Support - Underground >
AND TERMINOLOGY CATEGORIZED INTO TWO GROUPS IN THE DRAWING AS PER BELOW:

1- DUCT USED WITH LOCAL NETWORK
2-CONDUIT USED WITH LEAD-IN DROPS
ATTRIBUTES ATTACHED ARE AS SHOWN

CABLE CONFIGURATION

CABLE TYPE:
CABLES DIVIDE INTO FOLLOWING CATEGORIES AND ARE COLOUR CODED:

- TRANSIT CABLES COLOUR NO: 1
- DISTRIBUTION CABLES COLOUR NO: 190
- LOCAL CABLES COLOUR NO: 4
- TETHER CABLES COLOUR NO: 3
- LEAD IN (DROP) CABLES COLOUR NO: 5

CABLE LOCATION:
CABLE LOCATIONS DETERMINES WHERE THE CABLE IS USED AS PER BELOW:

IN-CONDUIT
AERIAL
BURIED

CABLE SIZE:
CABLE SIZE IS THE TOTAL NUMBER OF OPTIC FIBRES IN THE CABLE AND IS DETERMINED BY A NUMBER FOLLOWED BY F (FIBRE) OR R (RIBBON) IN THE MIDDLE OF THE LINE TYPE

LINE TYPES ARE CATEGORIZED INTO 3 TYPES:
1- IN-CONDUIT: DXXXF1 312F , ...
2- AERIAL: DXXXF_A1 144_A , ...
3- BURIED: DXXXF_B1 12_B , ...

EXAMPLE:
144 FIBRE AERIAL LOCAL CABLE
1 FIBRE BURIED DROP CABLE
432 FIBRE IN-CONDUIT TRANSIT CABLE

FSA Boundary
FSAM Boundary
FDA Boundary

STAFF WORKING ON THIS ESTIMATE PLEASE NOTE:
The location of other authorities services which may affect this work have not been obtained by the estimator. Constructor to obtain service information before commencing.

SAFETY FIRST
SAFETY STARTS WITH YOU

DANGER LASER BEAM
EYE PROTECTION MUST BE WORN



REV	DATE	DRAFTER	DESCRIPTION	APPROVED
D	25/07/2019	CIPRIAN PASCU	AS BUILT	
C	25/10/2018	CIPRIAN PASCU	PRELIMINARY - PIT & PIPE AMENDED	
B	06/08/2018	CIPRIAN PASCU	PRELIMINARY - PIT & PIPE AMENDED	
A	24/06/2018	CIPRIAN PASCU	PRELIMINARY	

STRICTLY CONFIDENTIAL

NBNCO APPROVAL RECORD:

SIGNATURE	DATE
<input type="checkbox"/> DD	_____
<input type="checkbox"/> WD	_____
<input type="checkbox"/> AB	_____

QUALITY RECORD :

NBNCO DISCLAIMER
THIS DOCUMENT HAS BEEN PREPARED SOLELY FOR THE USE OF NBNCO LIMITED (ABN 86 136 533 741) FOR USE IN MAINTAINING NBNCO FACILITIES. IT HAS NOT BEEN CREATED FOR ANY OTHER USE. IT SHOULD NOT BE SCALED TO LOCATE NBNCO ASSETS. NO WARRANTY IS GIVEN THAT THE INFORMATION IS ACCURATE OR COMPLETE.

Australia's broadband network

DESIGN IT TELCO PTY. LTD

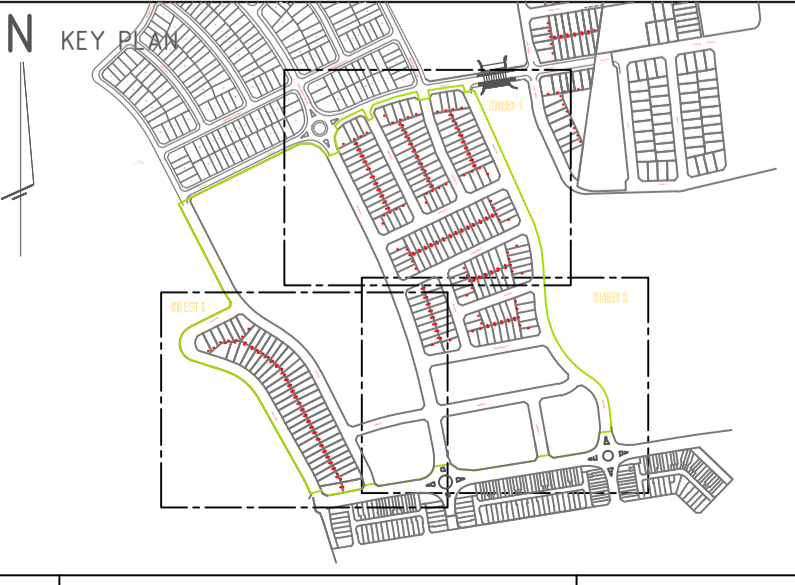

DRAWING TITLE:
248 LOTS SUBDIVISION - PIT & PIPE PROJECT
ELARA BOULEVARDE, MARSDEN PARK
"WOORONG PARK"
PRECINCT 6

STATE: NSW REGION: _____

FSA: _____ SAM: _____ ADA: _____

PROJECT No: AYCA-54JD6F

CADREF No: PN 33869

SCALE: N/A SHEET No: OF REV: D

- NOTES:**
- ALL PIT & PIPE INFRASTRUCTURE IS TO BE INSTALLED ACCORDING TO NBN Co's CONDUIT AND PIT NETWORK GUIDELINES (DOCUMENT NUMBER NBN-TE-CTO-194 VERSION 7.0 OR LATER).
 - DENOTES SHARED TRENCHES
 - CONDUITS TO BE INSTALLED IN SHARED TRENCHES, BUT NOT VERTICALLY ABOVE OR BELOW OTHER UTILITIES. CONDUITS MAY BE INSTALLED WITHIN THE ENDEAVOUR ENERGY ASSET ALLOCATION SPACE IF MANDATORY RADIAL SEPARATION FROM OTHER SERVICES IS MAINTAINED AT ALL TIMES. MINIMUM SEPARATIONS ARE:
 - GAS MAIN (ø75mm) - 150mm
 - GAS MAIN (ø110mm) - 300mm
 - LV CABLES - 100mm
 - HV CABLES - 300mm
 REFER TYPICAL CROSS SECTION DIAGRAM.
 - NO PITS TO BE INSTALLED WITHIN 15m FROM ANY PAD MOUNTED TRANSFORMER. I.E. NO PITS TO BE INSTALLED WITHIN THE EPR (Earth Potential Rise) ZONE.
 - PITS TO BE INSTALLED CLEAR OF PROPOSED DRIVEWAYS
 - EXCLUSIVE ROAD CROSSING
 - FOR REMOVAL/RELOCATION OF EXISTING COMMS POLES & OVERHEAD NETWORK - DEVELOPER AND/OR PROJECT MANAGER IS TO LIAISE WITH:
 * TELSTRA - NETWORK INTEGRITY SERVICES
 PH: 1800 810 443 - NetworkIntegrity@team.telstra.com
 * NBN RELOCATION WORKS GROUP
 RelocationWorks@nbnco.com.au

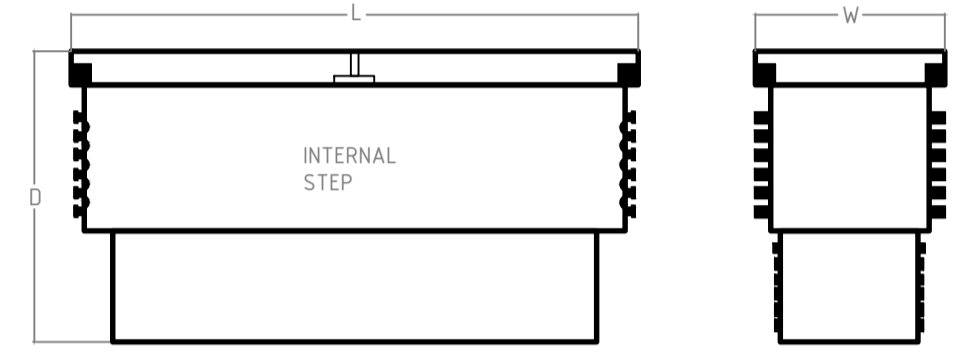

NBN NOMINAL DIMENSIONS (mm)			
PIT TYPE	L	W	D
Local Network Pit/Network Boundary Pit	700	450	650
Local Network Connection Pit	1360	555	860
Distribution Pit	1360	555	860
FDH PIT	2000	555	900

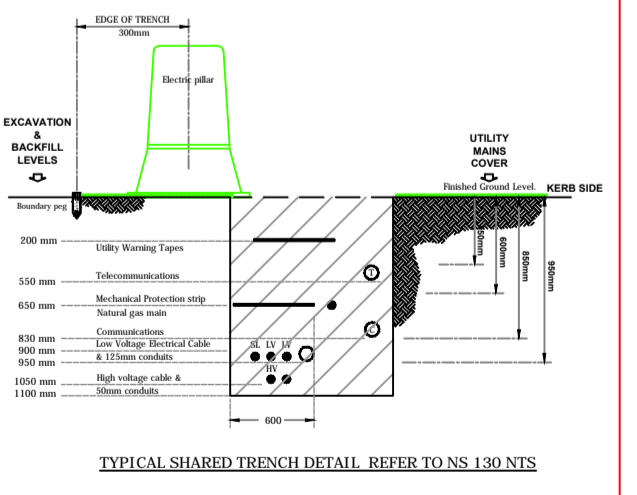
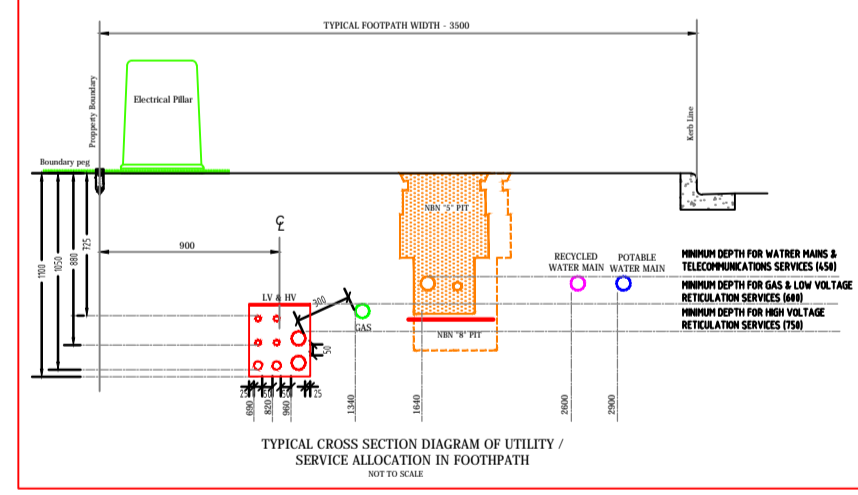
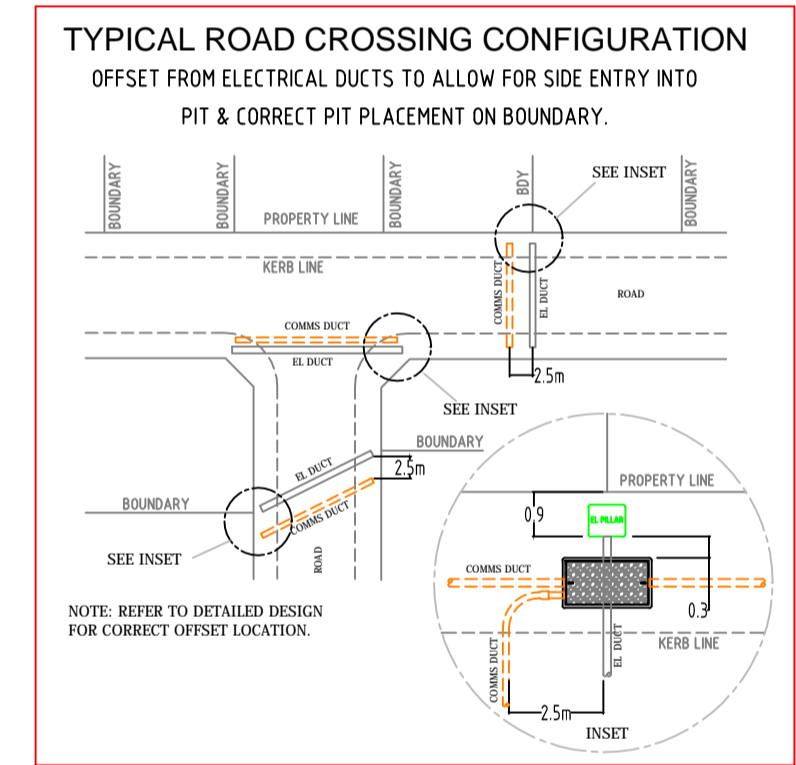

DESIGN & CONSTRUCTION AS PER NBN GUIDELINES DOCUMENT. *INSTALLING PIT AND CONDUIT INFRASTRUCTURE - GUIDELINES FOR DEVELOPERS - 04/07/2013

CIVIL CONTRACTORS ARE NOT TO LINK INTO EXISTING TELSTRA OR OTHER SERVICE PROVIDER NETWORK. NEW NETWORKS WILL BE LINKED UNDER FUTURE PROJECT. PIT AND PIPE ONLY WITH-IN THE DEVELOPMENT

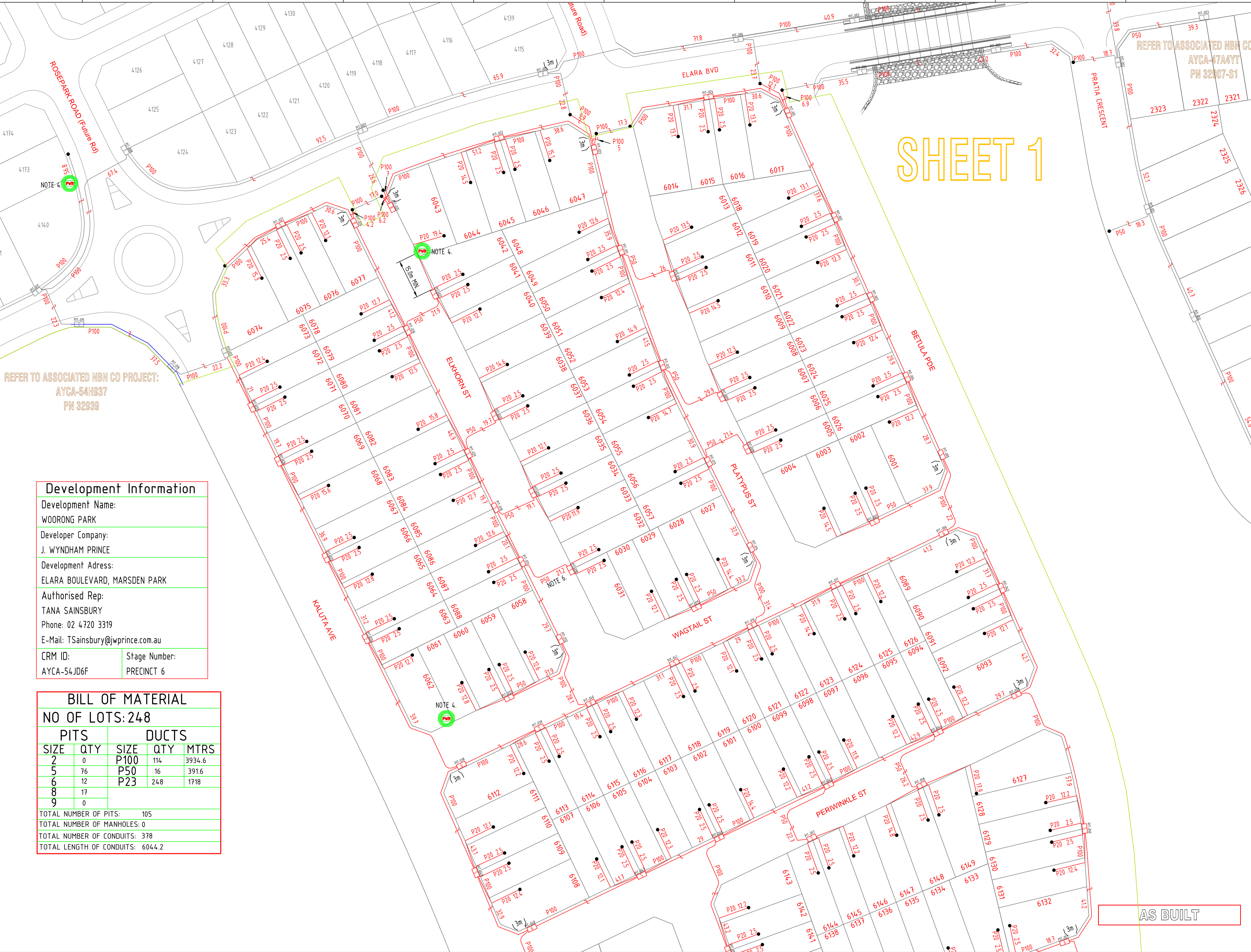

REFER TO ASSOCIATED NBN CO PROJECT: AYCA-54H337 PN 32939

Development Information

Development Name: WOORONG PARK

Developer Company: J. WYNDHAM PRINCE

Development Address: ELARA BOULEVARD, MARSDEN PARK

Authorised Rep: TANA SAINSBURY
 Phone: 02 4720 3319
 E-Mail: TSainsbury@jwprince.com.au

CRM ID: AYCA-54JD6F Stage Number: PRECINCT 6

BILL OF MATERIAL

NO OF LOTS: 248

PITS		DUCTS	
SIZE	QTY	SIZE	QTY
2	0	P100	114
5	76	P50	16
6	12	P23	248
8	17		
9	0		

MTRS: 3934.6, 391.6, 1718

TOTAL NUMBER OF PITS: 105
 TOTAL NUMBER OF MANHOLES: 0
 TOTAL NUMBER OF CONDUITS: 378
 TOTAL LENGTH OF CONDUITS: 6044.2



REV	DATE	DRAFTER	DESCRIPTION	APPROVED
D	25/07/2019	CIPRIAN PASCU	AS BUILT	
C	25/10/2018	CIPRIAN PASCU	FOR CONSTRUCTION	
B	06/08/2018	CIPRIAN PASCU	PRELIMINARY - PIT & PIPE AMENDED	
A	24/06/2018	CIPRIAN PASCU	PRELIMINARY	

STRICTLY CONFIDENTIAL

NBNCO APPROVAL RECORD:

SIGNATURE	DATE
<input type="checkbox"/> DD	
<input type="checkbox"/> WD	
<input type="checkbox"/> AB	

QUALITY RECORD:

NBNCO DISCLAIMER
 THIS DOCUMENT HAS BEEN PREPARED SOLELY FOR THE USE OF NBNCO LIMITED (ABN 86 136 533 741) FOR USE IN MAINTAINING NBNCO FACILITIES. IT HAS NOT BEEN CREATED FOR ANY OTHER USE. IT SHOULD NOT BE SCALED TO LOCATE NBNCO ASSETS. NO WARRANTY IS GIVEN THAT THE INFORMATION IS ACCURATE OR COMPLETE.

DESIGN IT TELCO PTY. LTD

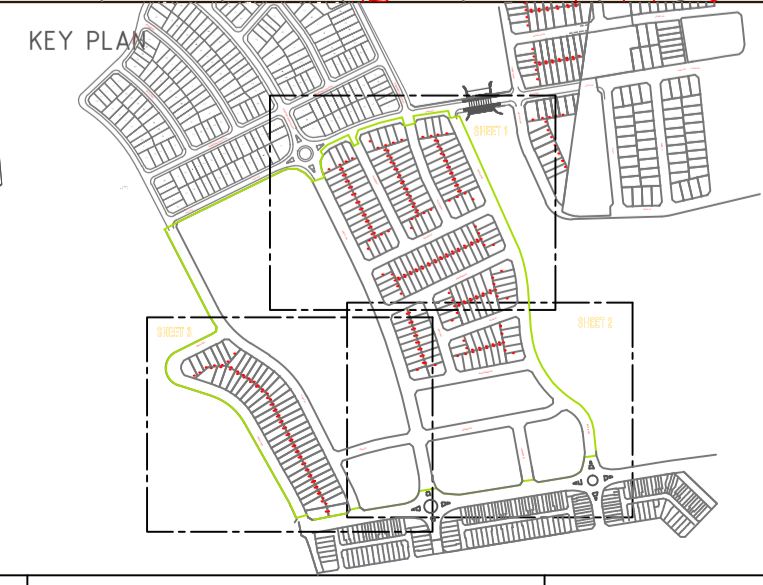

DRAWING TITLE:
 248 LOTS SUBDIVISION - PIT & PIPE PROJECT
 "WOORONG PARK"
 PRECINCT 6

STATE: NSW REGION:

FSA: SAM: ADA:

PROJECT No: AYCA-54JD6F

CADREF No: PN 33869

SCALE: N/A SHEET No: 1 OF 3 REV: D

SHEET 1

AS BUILT

REFER TO ASSOCIATED NBN CO AYCA-47A47T PN 32907-S1

SHEET 2

- NOTES:**
- ALL PIT & PIPE INFRASTRUCTURE IS TO BE INSTALLED ACCORDING TO NBN Co's CONDUIT AND PIT NETWORK GUIDELINES (DOCUMENT NUMBER NBN-TE-CTO-194 VERSION 7.0 OR LATER).
 - DENOTES SHARED TRENCHES
 - CONDUITS TO BE INSTALLED IN SHARED TRENCHES, BUT NOT VERTICALLY ABOVE OR BELOW OTHER UTILITIES. CONDUITS MAY BE INSTALLED WITHIN THE ENDEAVOUR ENERGY ASSET ALLOCATION SPACE IF MANDATORY RADIAL SEPARATION FROM OTHER SERVICES IS MAINTAINED AT ALL TIMES. MINIMUM SEPARATIONS ARE:
 - GAS MAIN (≤φ75mm) - 150mm
 - GAS MAIN (≤φ110mm) - 300mm
 - LV CABLES - 100mm
 - HV CABLES - 300mm
 REFER TYPICAL CROSS SECTION DIAGRAM.
 - NO PITS TO BE INSTALLED WITHIN 15m FROM ANY PAD MOUNTED TRANSFORMER. i.e. NO PITS TO BE INSTALLED WITHIN THE EPR (Earth Potential Rise) ZONE.
 - PITS TO BE INSTALLED CLEAR OF PROPOSED DRIVEWAYS
 - EXCLUSIVE ROAD CROSSING
 - FOR REMOVAL/RELOCATION OF EXISTING COMMS POLES & OVERHEAD NETWORK - DEVELOPER AND/OR PROJECT MANAGER IS TO LIAISE WITH:
 * TELSTRA - NETWORK INTEGRITY SERVICES
 PH: 1800 810 443 - NetworkIntegrity@team.telstra.com
 * NBN RELOCATION WORKS GROUP
 RelocationWorks@nbnco.com.au

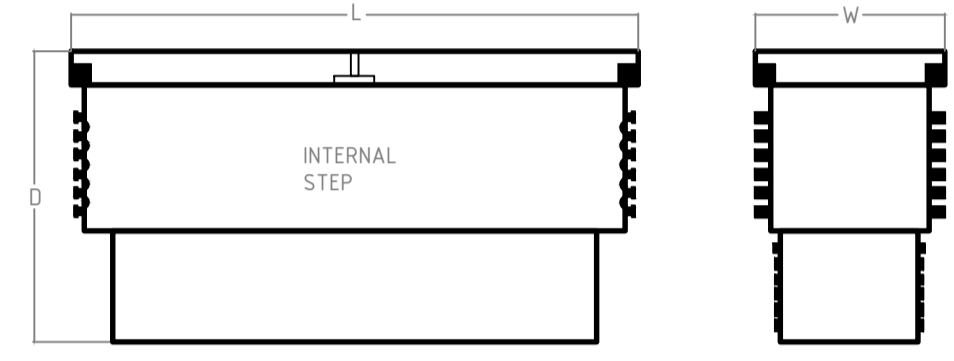

NBN NOMINAL DIMENSIONS (mm)			
PIT TYPE	L	W	D
Local Network Pit/Network Boundary Pit	700	450	650
Local Network Connection Pit	1360	555	860
Distribution Pit	1360	555	860
FDH PIT	2000	555	900

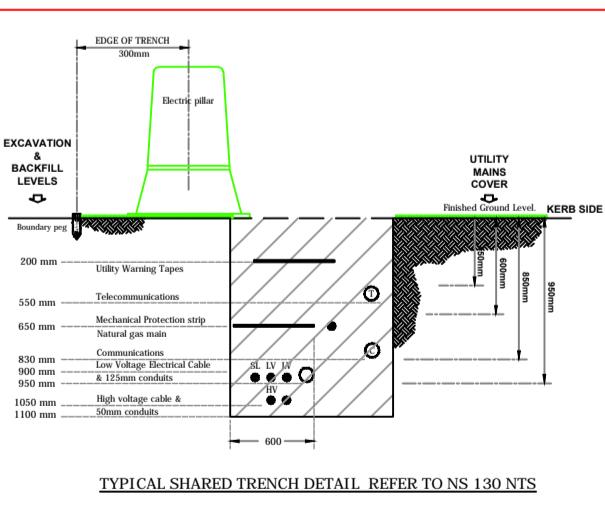
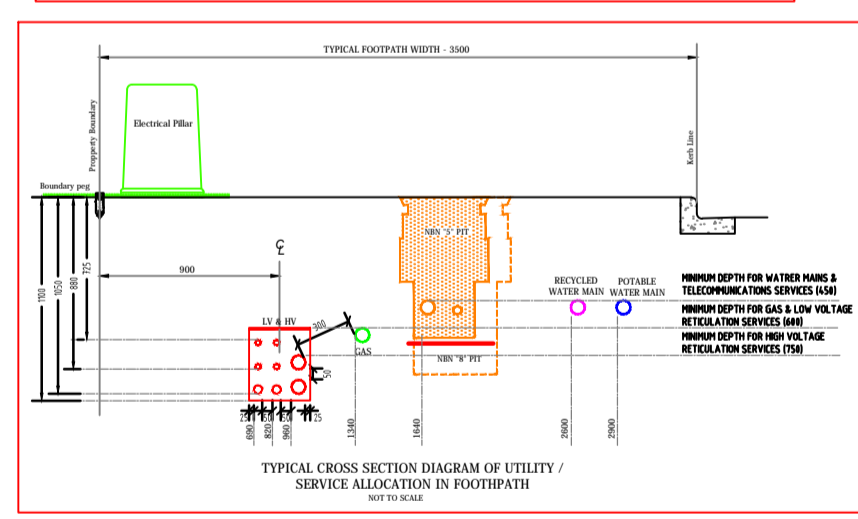
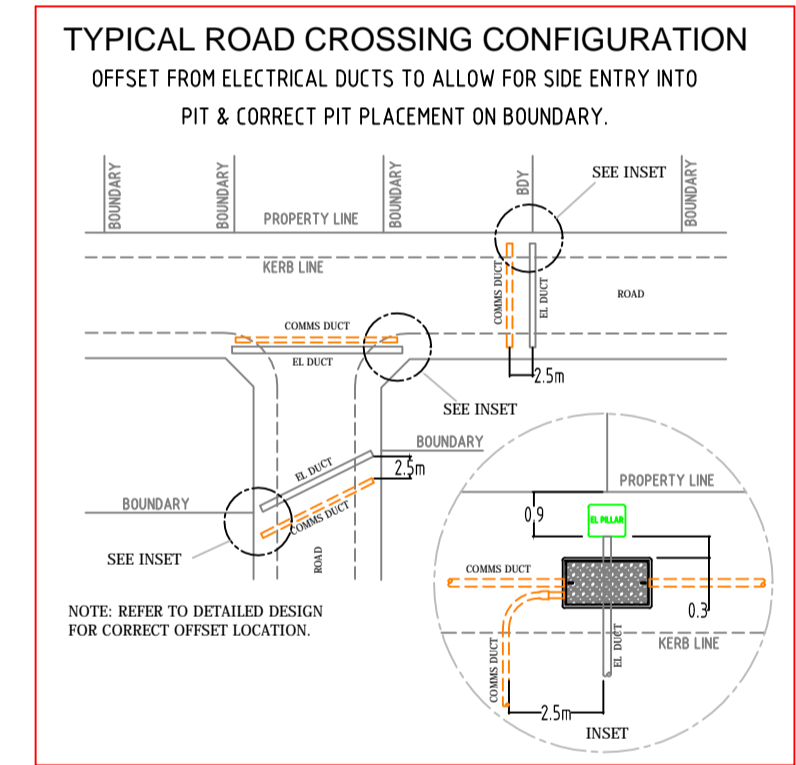

DESIGN & CONSTRUCTION AS PER NBN GUIDELINES DOCUMENT. *INSTALLING PIT AND CONDUIT INFRASTRUCTURE - GUIDELINES FOR DEVELOPERS - 08/07/2013

CIVIL CONTRACTORS ARE NOT TO LINK INTO EXISTING TELSTRA OR OTHER SERVICE PROVIDER NETWORK. NEW NETWORKS WILL BE LINKED UNDER FUTURE PROJECT. PIT AND PIPE ONLY WITH-IN THE DEVELOPMENT

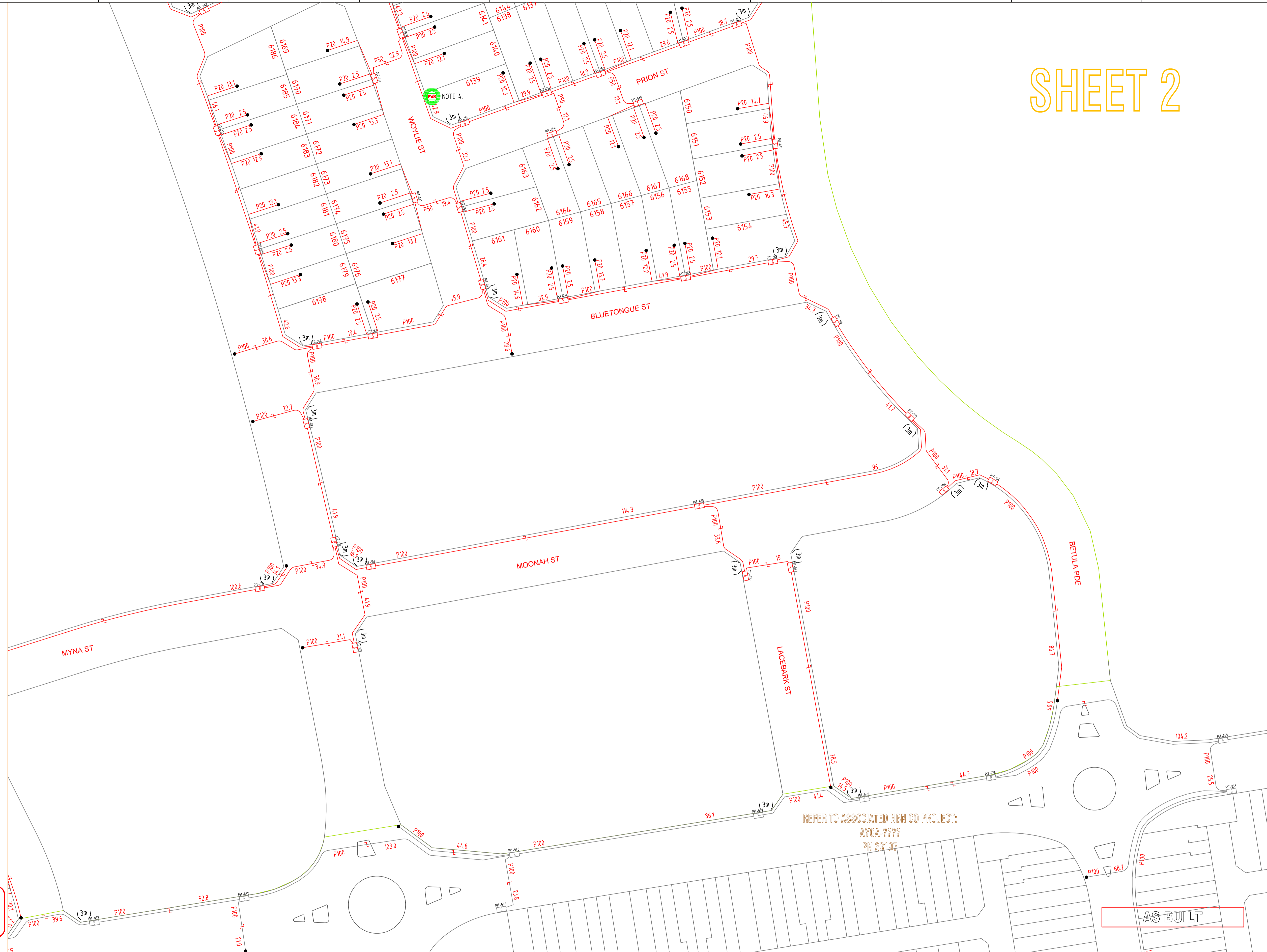

REFER TO ASSOCIATED NBN CO PROJECT:
 AYCA-????
 PN 33197

AS BUILT



REV	DATE	DRAFTER	DESCRIPTION	APPROVED
D	25/07/2019	CIPRIAN PASCU	AS BUILT	
C	25/10/2018	CIPRIAN PASCU	FOR CONSTRUCTION	
B	06/08/2018	CIPRIAN PASCU	PRELIMINARY - PIT & PIPE AMENDED	
A	24/06/2018	CIPRIAN PASCU	PRELIMINARY	

STRICTLY CONFIDENTIAL

NBNCO APPROVAL RECORD:

SIGNATURE	DATE
<input type="checkbox"/> DD	_____
<input type="checkbox"/> WD	_____
<input type="checkbox"/> AB	_____

QUALITY RECORD:

NBNCO DISCLAIMER
 THIS DOCUMENT HAS BEEN PREPARED SOLELY FOR THE USE OF NBNCO LIMITED (ABN 86 136 533 741) FOR USE IN MAINTAINING NBNCO FACILITIES. IT HAS NOT BEEN CREATED FOR ANY OTHER USE. IT SHOULD NOT BE SCALED TO LOCATE NBNCO ASSETS. NO WARRANTY IS GIVEN THAT THE INFORMATION IS ACCURATE OR COMPLETE.

DESIGN IT TELCO PTY. LTD

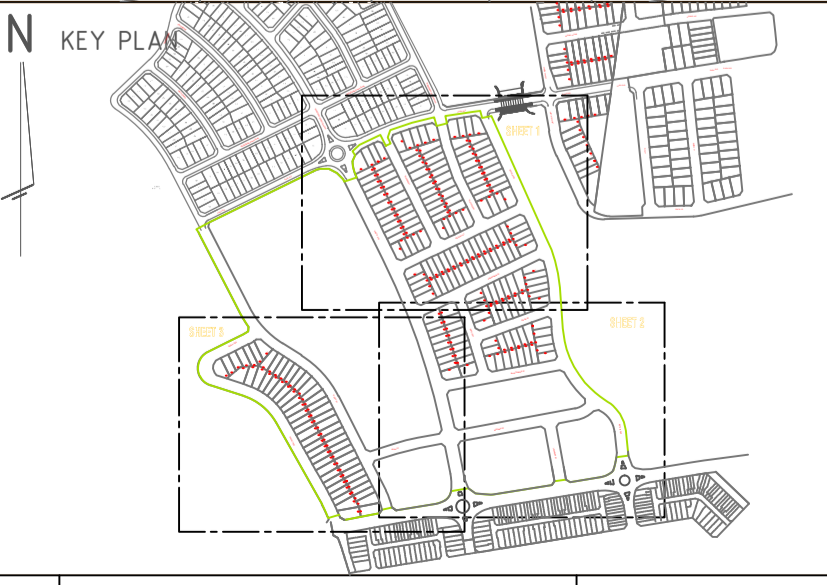

DRAWING TITLE:
 248 LOTS SUBDIVISION - PIT & PIPE PROJECT
 ELARA BOULEVARDE, MARSDEN PARK
 "WOORONG PARK"
 PRECINCT 6

STATE: NSW	REGION:
FSA:	SAM: ADA:
PROJECT No: AYCA-54JD6F	
CADREF No: PN 33869	
SCALE: N/A	SHEET No. 2 OF 3 REV. D

NOTES:

- ALL PIT & PIPE INFRASTRUCTURE IS TO BE INSTALLED ACCORDING TO NBN Co's CONDUIT AND PIT NETWORK GUIDELINES (DOCUMENT NUMBER NBN-TE-CTO-194 VERSION 7.0 OR LATER).
- DENOTES SHARED TRENCHES
- CONDUITS TO BE INSTALLED IN SHARED TRENCHES, BUT NOT VERTICALLY ABOVE OR BELOW OTHER UTILITIES. CONDUITS MAY BE INSTALLED WITHIN THE ENDEAVOUR ENERGY ASSET ALLOCATION SPACE IF MANDATORY RADIAL SEPARATION FROM OTHER SERVICES IS MAINTAINED AT ALL TIMES. MINIMUM SEPARATIONS ARE:
 - GAS MAIN (≤φ75mm) - 150mm
 - GAS MAIN (≤φ110mm) - 300mm
 - LV CABLES - 100mm
 - HV CABLES - 300mm
 REFER TYPICAL CROSS SECTION DIAGRAM.
- NO PITS TO BE INSTALLED WITHIN 15m FROM ANY PAD MOUNTED TRANSFORMER. i.e. NO PITS TO BE INSTALLED WITHIN THE EPR (Earth Potential Rise) ZONE.
- PITS TO BE INSTALLED CLEAR OF PROPOSED DRIVEWAYS
- EXCLUSIVE ROAD CROSSING
- FOR REMOVAL/RELOCATION OF EXISTING COMMS POLES & OVERHEAD NETWORK - DEVELOPER AND/OR PROJECT MANAGER IS TO LIAISE WITH:
 * TELSTRA - NETWORK INTEGRITY SERVICES
 PH: 1800 810 443 - NetworkIntegrity@team.telstra.com
 * NBN RELOCATION WORKS GROUP
 RelocationWorks@nbnco.com.au

SHEET 3

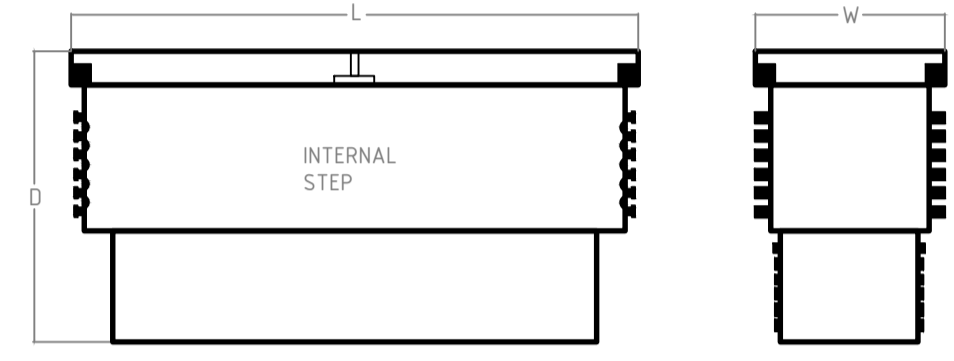
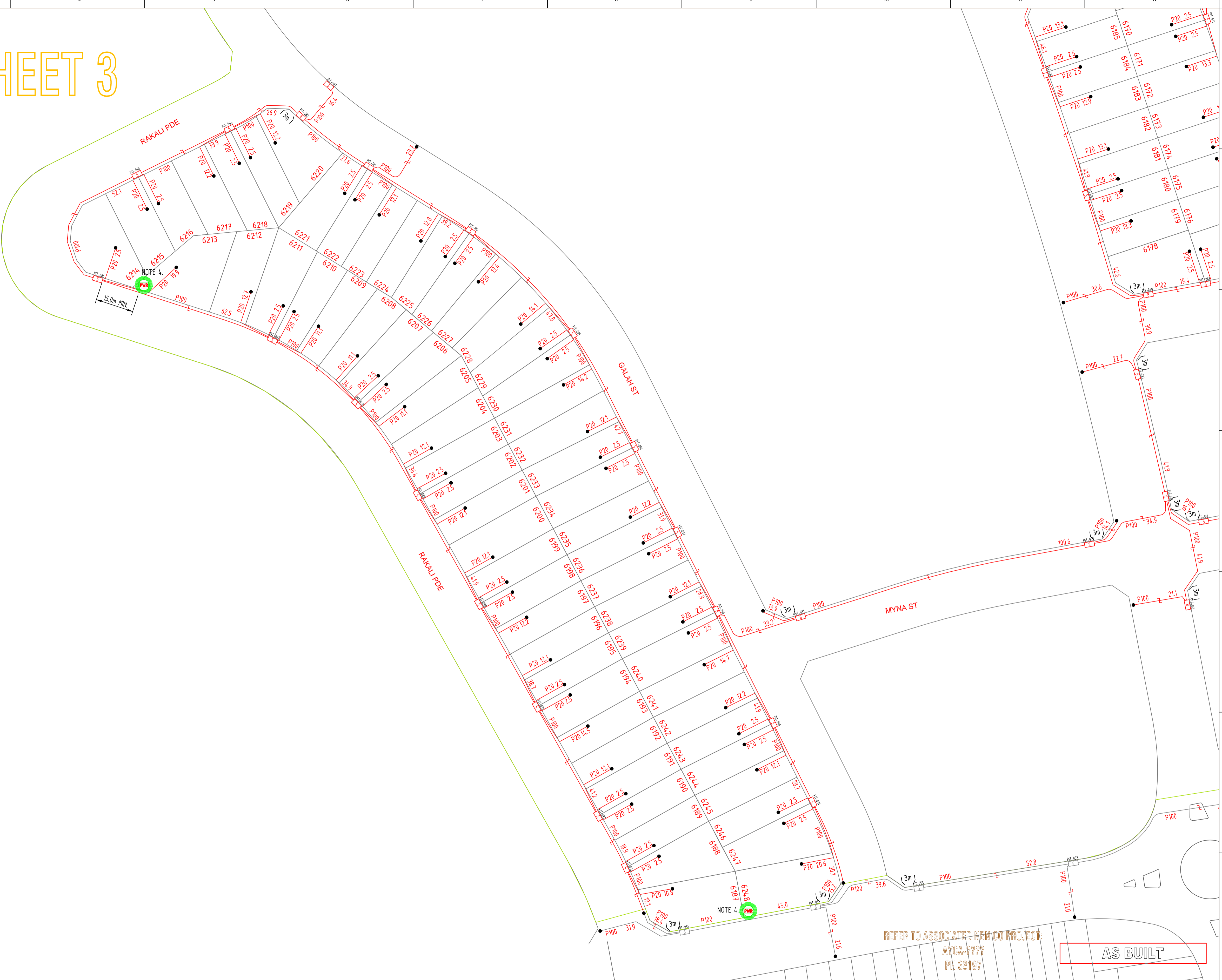

NBN NOMINAL DIMENSIONS (mm)			
PIT TYPE	L	W	D
Local Network Pit/Network Boundary Pit	700	450	650
Local Network Connection Pit	1360	555	860
Distribution Pit	1360	555	860
FDH PIT	2000	555	900

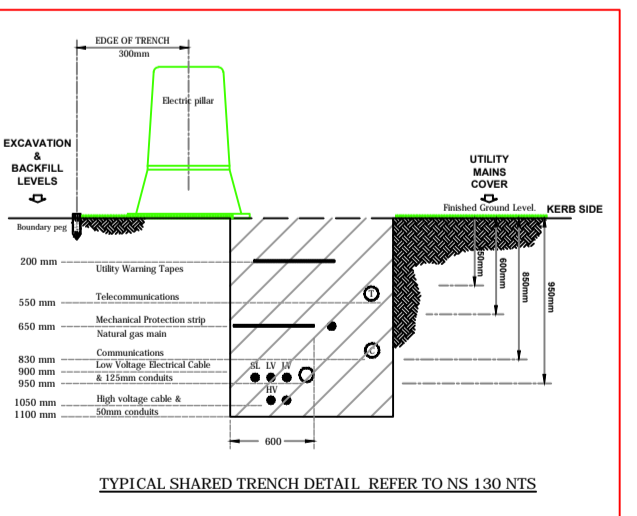
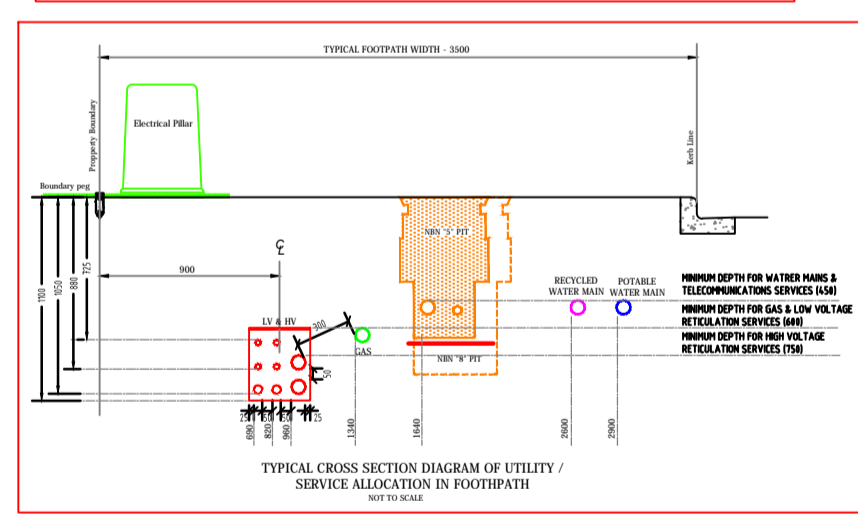
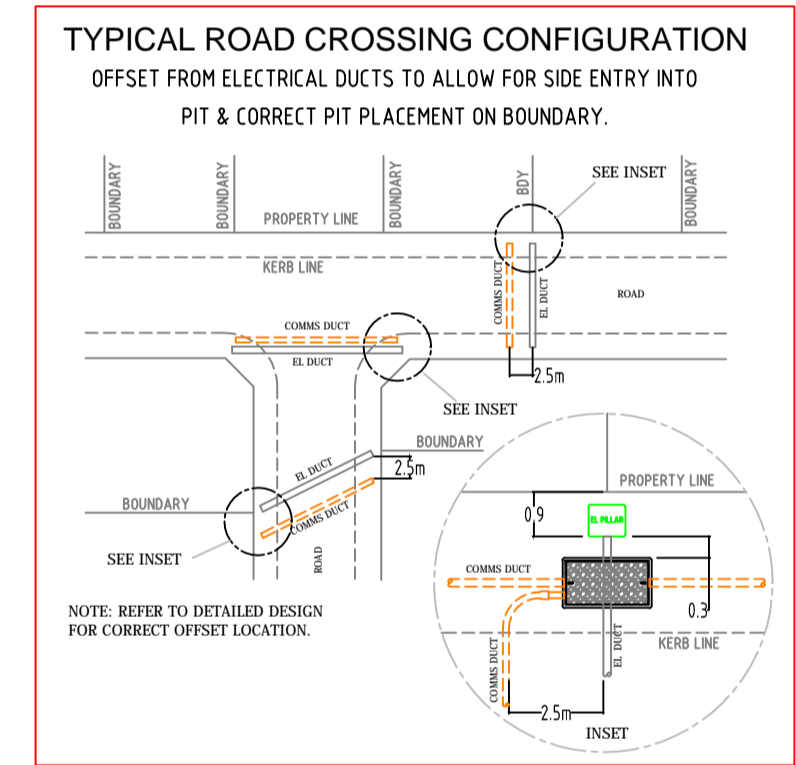

DESIGN & CONSTRUCTION AS PER NBN GUIDELINES DOCUMENT. *INSTALLING PIT AND CONDUIT INFRASTRUCTURE - GUIDELINES FOR DEVELOPERS - 04/07/2013

CIVIL CONTRACTORS ARE NOT TO LINK INTO EXISTING TELSTRA OR OTHER SERVICE PROVIDER NETWORK. NEW NETWORKS WILL BE LINKED UNDER FUTURE PROJECT. PIT AND PIPE ONLY WITH-IN THE DEVELOPMENT

REFER TO ASSOCIATED NBN CO PROJECT: AYCA-???? PN 33197
AS BUILT



REV	DATE	DRAFTER	DESCRIPTION	APPROVED
D	25/07/2019	CIPRIAN PASCU	AS BUILT	
C	25/10/2018	CIPRIAN PASCU	FOR CONSTRUCTION	
B	06/08/2018	CIPRIAN PASCU	PRELIMINARY - PIT & PIPE AMENDED	
A	24/06/2018	CIPRIAN PASCU	PRELIMINARY	

STRICTLY CONFIDENTIAL

NBNCO APPROVAL RECORD:

SIGNATURE	DATE
<input type="checkbox"/> DD	_____
<input type="checkbox"/> WD	_____
<input type="checkbox"/> AB	_____

QUALITY RECORD:

NBNCO DISCLAIMER
 THIS DOCUMENT HAS BEEN PREPARED SOLELY FOR THE USE OF NBNCO LIMITED (ABN 86 136 533 741) FOR USE IN MAINTAINING NBNCO FACILITIES. IT HAS NOT BEEN CREATED FOR ANY OTHER USE. IT SHOULD NOT BE SCALED TO LOCATE NBNCO ASSETS. NO WARRANTY IS GIVEN THAT THE INFORMATION IS ACCURATE OR COMPLETE.

DESIGN IT TELCO PTY. LTD

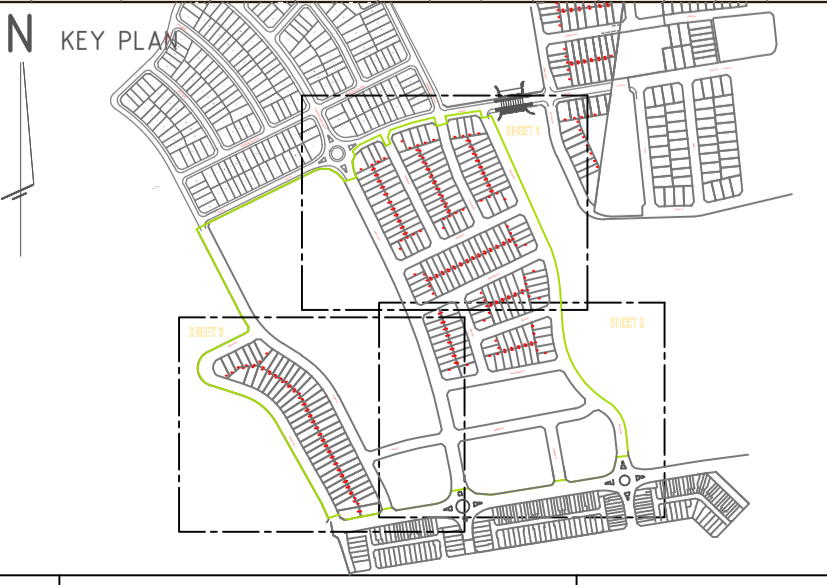

DRAWING TITLE:
248 LOTS SUBDIVISION - PIT & PIPE PROJECT ELARA BOULEVARDE, MARSDEN PARK "WOORONG PARK" PRECINCT 6

STATE: NSW	REGION:	
FSA:	SAM:	ADA:
PROJECT No: AYCA-54JD6F		
CADREF No: PN 33869		
SCALE: N/A	SHEET No: 3 OF 3	REV: D