

[illegible]

SHEET 1

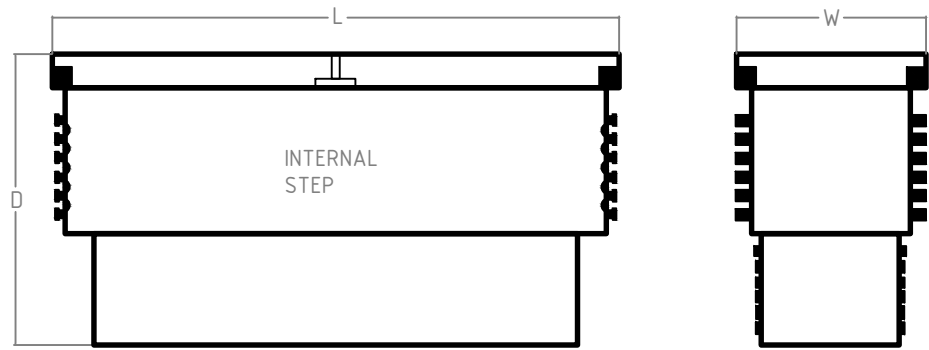

NBN NOMINAL DIMENSIONS (mm)			
PIT TYPE	L	W	D
Local Network Pit/Network Boundary Pit	700	450	650
Local Network Connection Pit	1360	555	860
Distribution Pit	1360	555	860
FDH PIT	2000	555	900

TYPICAL ROAD CROSSING CONFIGURATION

OFFSET FROM ELECTRICAL DUCTS TO ALLOW FOR SIDE ENTRY INTO PIT & CORRECT PIT PLACEMENT ON BOUNDARY.

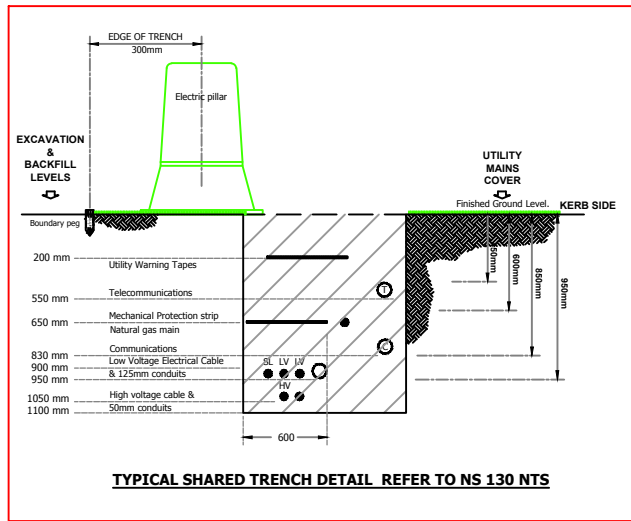
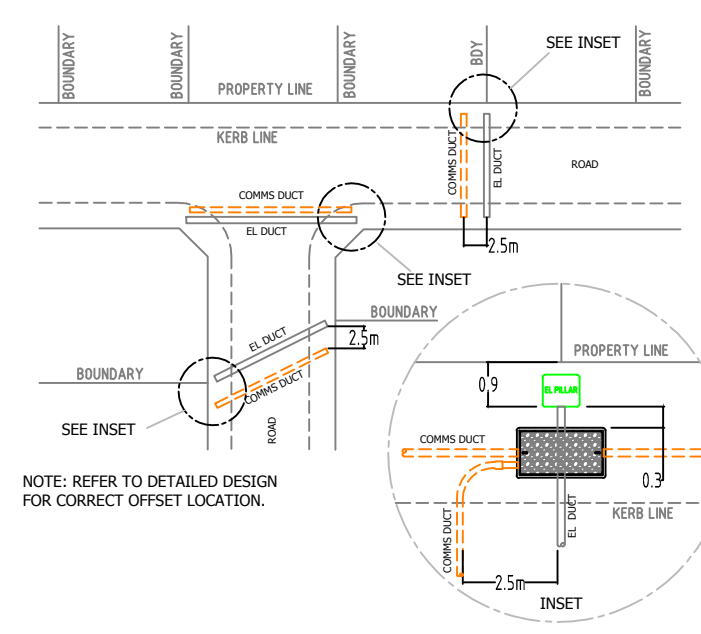

DESIGN & CONSTRUCTION AS PER NBN GUIDELINES DOCUMENT.
* INSTALLING PIT AND CONDUIT INFRASTRUCTURE - GUIDELINES FOR DEVELOPERS - 04/07/2013

CIVIL CONTRACTORS ARE NOT TO LINK INTO EXISTING TELSTRA OR OTHER SERVICE PROVIDER NETWORK. NEW NETWORK WILL BE LINKED UNDER FUTURE PROJECT.
PIT AND PIPE ONLY WITH-IN THE DEVELOPMENT

REV	DATE	DRAFTER	DESCRIPTION	APPROVED
H	14/05/18	CIPRIAN PASCU	AS BUILT	
G	11/03/18	CIPRIAN PASCU	AS BUILT	
F	14/02/2018	CIPRIAN PASCU	PRELIMINARY - PIT & PIPE ADDED	
E	08/02/2018	CIPRIAN PASCU	PRELIMINARY - STAGE 2 REMOVED	
D	11/11/17	CIPRIAN PASCU	PRELIMINARY - PIT & PIPE AMENDED	
C	11/10/17	CIPRIAN PASCU	PRELIMINARY - PIT & PIPE AMENDED	
B	23/08/17	CIPRIAN PASCU	PRELIMINARY - PIT & PIPE AMENDED	
I	30/07/18	CIPRIAN PASCU	AS BUILT	

STRICTLY CONFIDENTIAL

NBNCO APPROVAL RECORD:

SIGNATURE	DATE
<input type="checkbox"/> DD	
<input type="checkbox"/> WD	
<input type="checkbox"/> AB	

QUALITY RECORD :

NBNCO DISCLAIMER
THIS DOCUMENT HAS BEEN PREPARED SOLELY FOR THE USE OF NBNCO LIMITED (ABN 86 136 533 741) FOR USE IN MAINTAINING NBNCO FACILITIES. IT HAS NOT BEEN CREATED FOR ANY OTHER USE. IT SHOULD NOT BE SCALED TO LOCATE NBNCO ASSETS. NO WARRANTY IS GIVEN THAT THE INFORMATION IS ACCURATE OR COMPLETE.



DESIGN IT TELCO
PTY. LTD

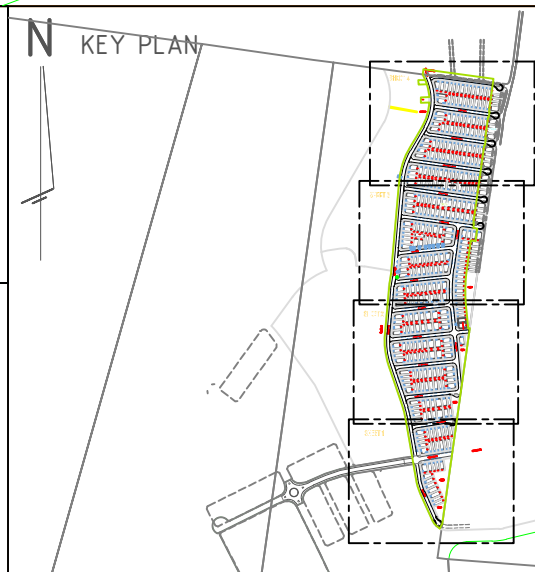

AS BUILT

BILL OF MATERIAL				
NO OF LOTS: 358				
PITS		DUCTS		
SIZE	QTY	SIZE	QTY	MTRS
2	0	P100	117	4144.8
5	105	P50	46	1067.7
6	14	P23	358	2598.7
8	14			
9	0			
TOTAL NUMBER OF PITS:		133		
TOTAL NUMBER OF MANHOLES:		0		
TOTAL NUMBER OF CONDUITS:		519		
TOTAL LENGTH OF CONDUITS:		7811.2		

Development Information

Development Name:
WOORONG PARK

Developer Company:
J. WYNDHAM PRINCE

Development Address:
ELARA BOULEVARD, MARSDEN PARK

Authorised Rep:
TANA SAINSBURY
Phone: 02 4720 3319
E-Mail: TSainsbury@jwprince.com.au

CRM ID:
AYCA-47A4YT

Stage Number:
PRECINCT 2 - STAGE 1



SHEET 2

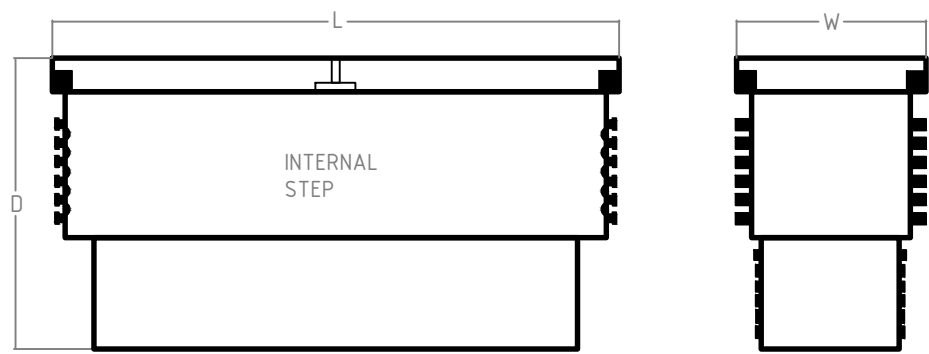

NBN NOMINAL DIMENSIONS (mm)			
PIT TYPE	L	W	D
Local Network Pit/Network Boundary Pit	700	450	650
Local Network Connection Pit	1360	555	860
Distribution Pit	1360	555	860
FDH PIT	2000	555	900

TYPICAL ROAD CROSSING CONFIGURATION

OFFSET FROM ELECTRICAL DUCTS TO ALLOW FOR SIDE ENTRY INTO PIT & CORRECT PIT PLACEMENT ON BOUNDARY.

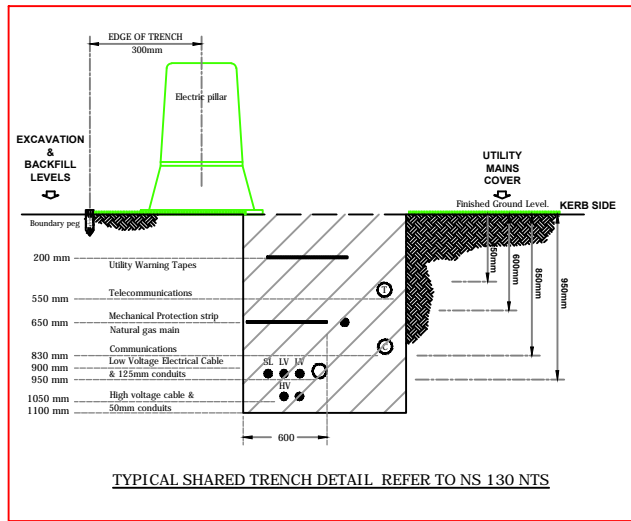
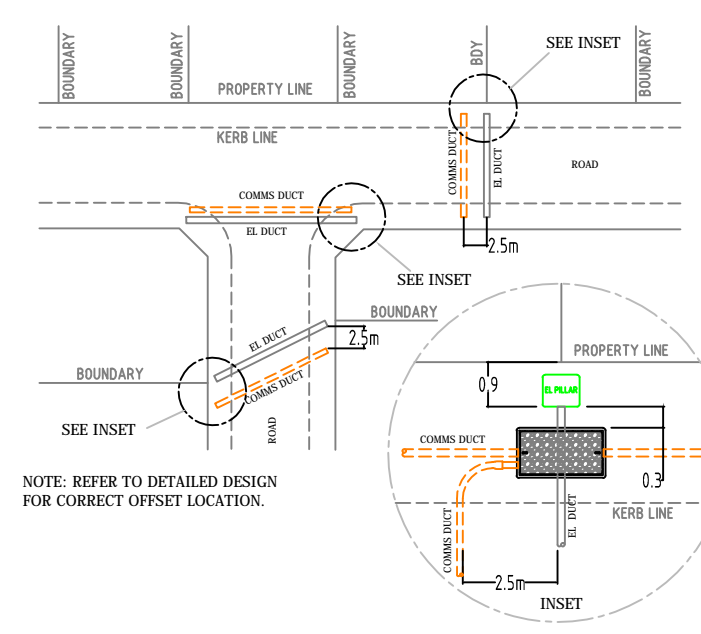

DESIGN & CONSTRUCTION AS PER NBN GUIDELINES DOCUMENT.
* INSTALLING PIT AND CONDUIT INFRASTRUCTURE - GUIDELINES FOR DEVELOPERS - 04/07/2013

CIVIL CONTRACTORS ARE NOT TO LINK INTO EXISTING TELSTRA OR OTHER SERVICE PROVIDER NETWORK. NEW NETWORK WILL BE LINKED UNDER FUTURE PROJECT.
PIT AND PIPE ONLY WITH-IN THE DEVELOPMENT



REV	DATE	DRAFTER	DESCRIPTION	APPROVED
H	14/05/18	CIPRIAN PASCU	AS BUILT	
G	11/03/18	CIPRIAN PASCU	AS BUILT	
F	16/02/2018	CIPRIAN PASCU	PRELIMINARY - PIT & PIPE ADDED	
E	08/02/2018	CIPRIAN PASCU	PRELIMINARY - STAGE 2 REMOVED	
D	11/11/17	CIPRIAN PASCU	PRELIMINARY - PIT & PIPE AMENDED	
C	11/10/17	CIPRIAN PASCU	PRELIMINARY - PIT & PIPE AMENDED	
B	23/08/17	CIPRIAN PASCU	PRELIMINARY - PIT & PIPE AMENDED	
I	30/07/18	CIPRIAN PASCU	AS BUILT	

STRICTLY CONFIDENTIAL

NBNCO APPROVAL RECORD:

SIGNATURE	DATE
<input type="checkbox"/> DD	
<input type="checkbox"/> WD	
<input type="checkbox"/> AB	

QUALITY RECORD :

NBNCO DISCLAIMER
THIS DOCUMENT HAS BEEN PREPARED SOLELY FOR THE USE OF NBNCO LIMITED (ABN 86 136 533 741) FOR USE IN MAINTAINING NBNCO FACILITIES. IT HAS NOT BEEN CREATED FOR ANY OTHER USE. IT SHOULD NOT BE SCALED TO LOCATE NBNCO ASSETS. NO WARRANTY IS GIVEN THAT THE INFORMATION IS ACCURATE OR COMPLETE.

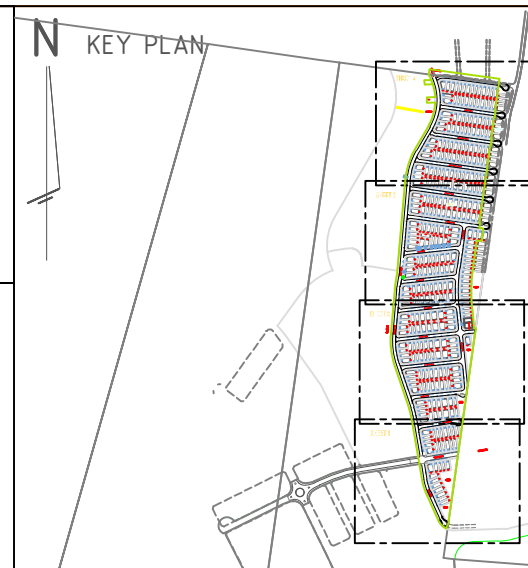

DRAWING TITLE: 358 LOTS SUBDIVISION - PIT & PIPE PROJECT ELARA BOULEVARDE, MARSDEN PARK "WOORONG PARK" PRECINCT 2 - STAGE 1		
STATE: NSW	REGION:	
FSA:	SAM:	ADA:
PROJECT No: AYCA-47A4YT		
CADREF No: PN 32907-S1		
SCALE N/A	SHEET No. 2 OF 4	REV. 1

SHEET 3

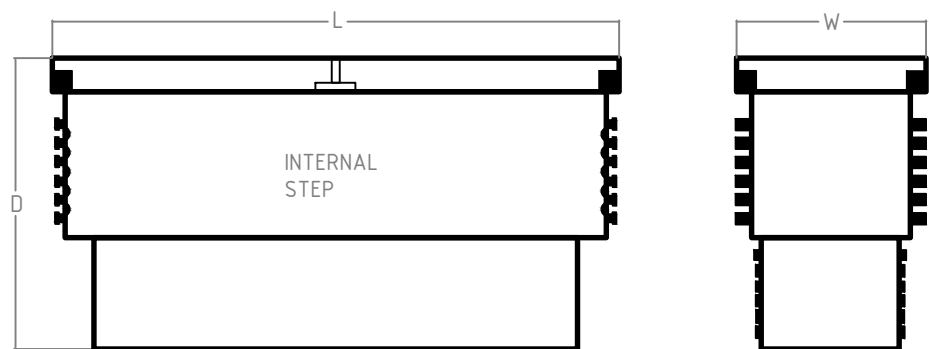

NBN NOMINAL DIMENSIONS (mm)			
PIT TYPE	L	W	D
Local Network Pit/Network Boundary Pit	700	450	650
Local Network Connection Pit	1360	555	860
Distribution Pit	1360	555	860
FDH PIT	2000	555	900

TYPICAL ROAD CROSSING CONFIGURATION

OFFSET FROM ELECTRICAL DUCTS TO ALLOW FOR SIDE ENTRY INTO PIT & CORRECT PIT PLACEMENT ON BOUNDARY.

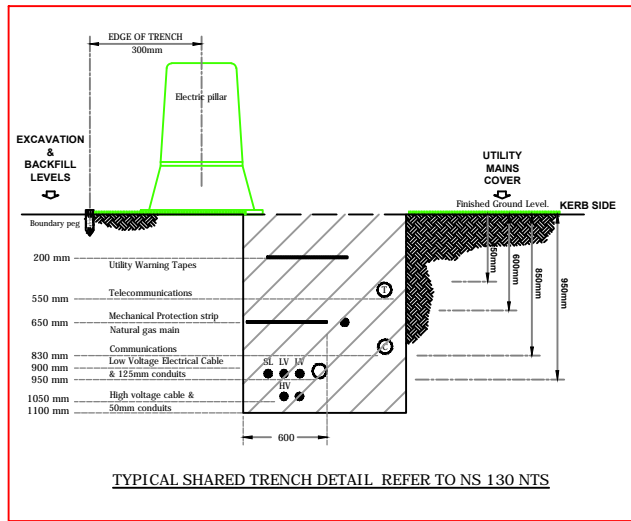
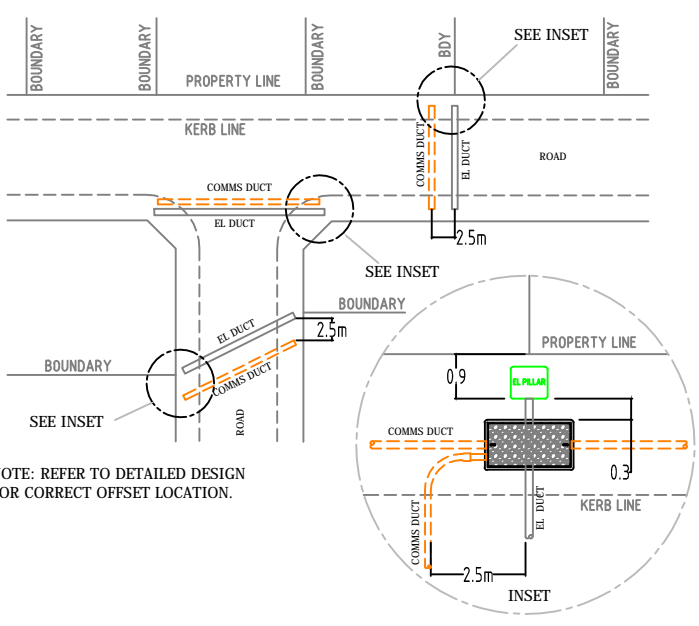

DESIGN & CONSTRUCTION AS PER NBN GUIDELINES DOCUMENT.
*INSTALLING PIT AND CONDUIT INFRASTRUCTURE - GUIDELINES FOR DEVELOPERS - 04/07/2013

CIVIL CONTRACTORS ARE NOT TO LINK INTO EXISTING TELSTRA OR OTHER SERVICE PROVIDER NETWORK. NEW NETWORK WILL BE LINKED UNDER FUTURE PROJECT.
PIT AND PIPE ONLY WITH-IN THE DEVELOPMENT



REV	DATE	DRAFTER	DESCRIPTION	APPROVED
H	14/05/18	CIPRIAN PASCU	AS BUILT	
G	11/03/18	CIPRIAN PASCU	AS BUILT	
F	16/02/2018	CIPRIAN PASCU	PRELIMINARY - PIT & PIPE ADDED	
E	08/02/2018	CIPRIAN PASCU	PRELIMINARY - STAGE 2 REMOVED	
D	11/11/17	CIPRIAN PASCU	PRELIMINARY - PIT & PIPE AMENDED	
C	11/10/17	CIPRIAN PASCU	PRELIMINARY - PIT & PIPE AMENDED	
B	23/08/17	CIPRIAN PASCU	PRELIMINARY - PIT & PIPE AMENDED	
I	30/07/18	CIPRIAN PASCU	AS BUILT	

STRICTLY CONFIDENTIAL

NBNCO APPROVAL RECORD:

	SIGNATURE	DATE
<input type="checkbox"/> DD		
<input type="checkbox"/> WD		
<input type="checkbox"/> AB		

QUALITY RECORD :

NBNCO DISCLAIMER

THIS DOCUMENT HAS BEEN PREPARED SOLELY FOR THE USE OF NBNCO LIMITED (ABN 86 136 533 741) FOR USE IN MAINTAINING NBNCO FACILITIES. IT HAS NOT BEEN CREATED FOR ANY OTHER USE. IT SHOULD NOT BE SCALED TO LOCATE NBNCO ASSETS. NO WARRANTY IS GIVEN THAT THE INFORMATION IS ACCURATE OR COMPLETE.

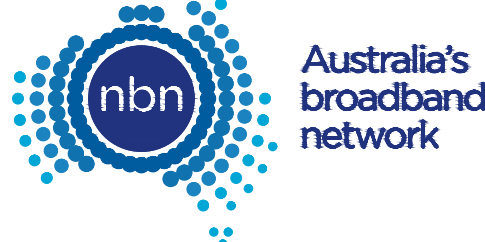

DESIGN IT TELCO
PTY. LTD

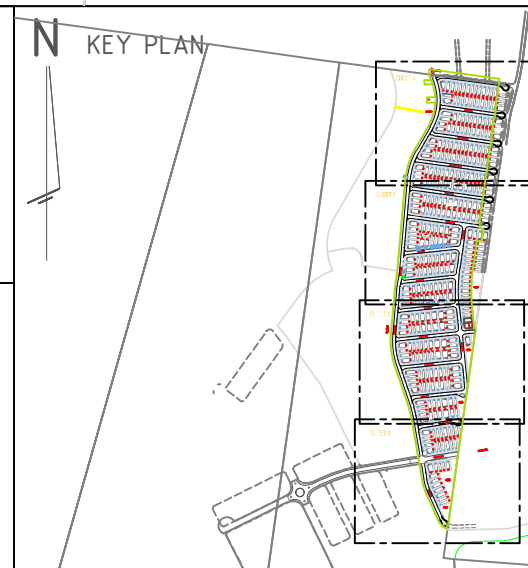

DRAWING TITLE:
358 LOTS SUBDIVISION - PIT & PIPE PROJECT
ELARA BOULEVARDE, MARSDEN PARK
"WOORONG PARK"
PRECINCT 2 - STAGE 1

STATE: NSW	REGION:
FSA:	SAM: ADA:
PROJECT No: AYCA-47A4YT	
CADREF No: PN 32907-S1	
SCALE N/A	SHEET No. 3 OF 4 REV. I

SHEET 4

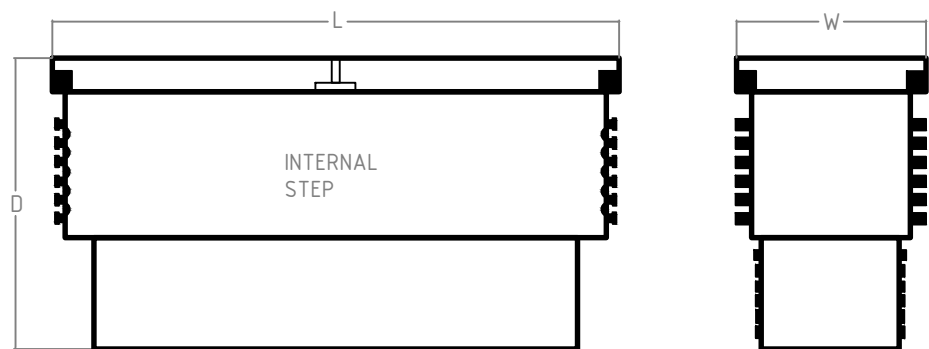

NBN NOMINAL DIMENSIONS (mm)			
PIT TYPE	L	W	D
Local Network Pit/Network Boundary Pit	700	450	650
Local Network Connection Pit	1360	555	860
Distribution Pit	1360	555	860
FDH PIT	2000	555	900

TYPICAL ROAD CROSSING CONFIGURATION

OFFSET FROM ELECTRICAL DUCTS TO ALLOW FOR SIDE ENTRY INTO PIT & CORRECT PIT PLACEMENT ON BOUNDARY.

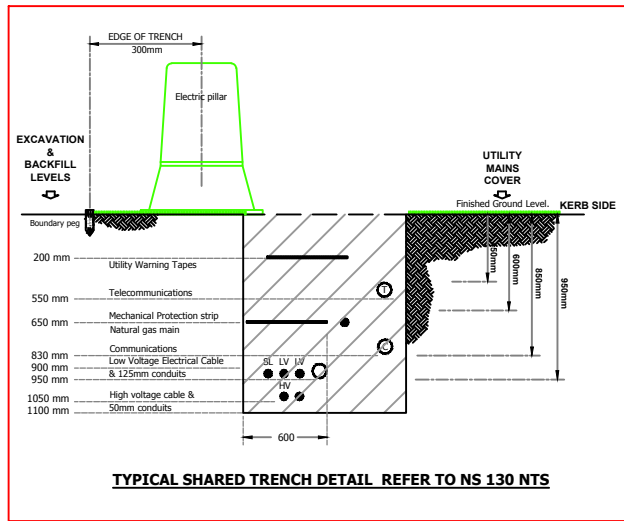
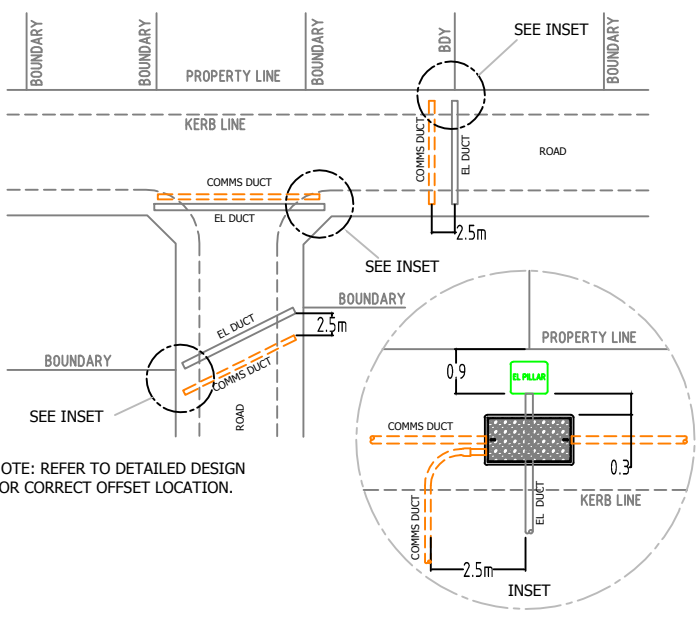

DESIGN & CONSTRUCTION AS PER NBN GUIDELINES DOCUMENT.
* INSTALLING PIT AND CONDUIT INFRASTRUCTURE - GUIDELINES FOR DEVELOPERS - 04/07/2013

CIVIL CONTRACTORS ARE NOT TO LINK INTO EXISTING TELSTRA OR OTHER SERVICE PROVIDER NETWORK. NEW NETWORK WILL BE LINKED UNDER FUTURE PROJECT.
PIT AND PIPE ONLY WITH-IN THE DEVELOPMENT



REV	DATE	DRAFTER	DESCRIPTION	APPROVED
H	14/05/18	CIPRIAN PASCU	AS BUILT	
G	11/03/18	CIPRIAN PASCU	AS BUILT	
F	16/02/2018	CIPRIAN PASCU	PRELIMINARY - PIT & PIPE ADDED	
E	08/02/2018	CIPRIAN PASCU	PRELIMINARY - STAGE 2 REMOVED	
D	11/11/17	CIPRIAN PASCU	PRELIMINARY - PIT & PIPE AMENDED	
C	11/10/17	CIPRIAN PASCU	PRELIMINARY - PIT & PIPE AMENDED	
B	23/08/17	CIPRIAN PASCU	PRELIMINARY - PIT & PIPE AMENDED	
I	30/07/18	CIPRIAN PASCU	AS BUILT	

STRICTLY CONFIDENTIAL

NBNCO APPROVAL RECORD:

SIGNATURE	DATE
<input type="checkbox"/> DD	
<input type="checkbox"/> WD	
<input type="checkbox"/> AB	

QUALITY RECORD :

NBNCO DISCLAIMER
THIS DOCUMENT HAS BEEN PREPARED SOLELY FOR THE USE OF NBNCO LIMITED (ABN 86 136 533 741) FOR USE IN MAINTAINING NBNCO FACILITIES. IT HAS NOT BEEN CREATED FOR ANY OTHER USE. IT SHOULD NOT BE SCALED TO LOCATE NBNCO ASSETS. NO WARRANTY IS GIVEN THAT THE INFORMATION IS ACCURATE OR COMPLETE.

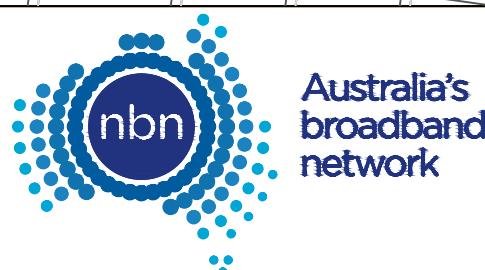

DESIGN IT TELCO
PTY. LTD

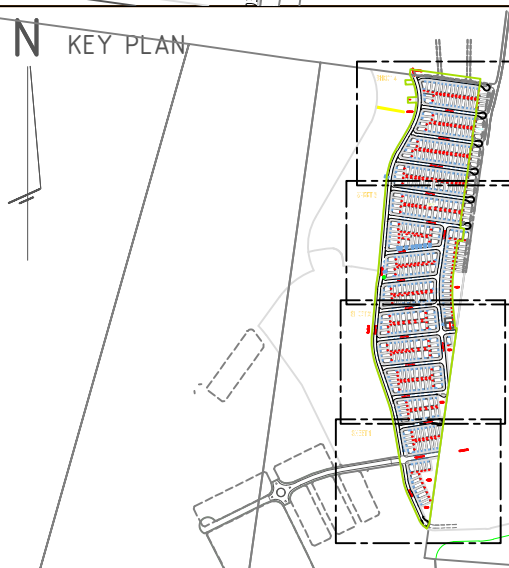

DRAWING TITLE:
358 LOTS SUBDIVISION - PIT & PIPE PROJECT
ELARA BOULEVARDE, MARSDEN PARK
"WOORONG PARK"
PRECINCT 2 - STAGE 1

STATE: NSW	REGION:
FSA:	SAM: ADA:
PROJECT No: AYCA-47A4YT	
CADREF No: PN 32907-S1	
SCALE N/A	SHEET No. 4 OF 4 REV. I

AS BUILT