

Plotted: 29 February 2024 8:15:07 AM File Name: J:\9985-12\J-SP01.dwg



LEGEND

- S — S — SEWER #
- W — W — WATER #
- WATER METER LOCATION #
- - - (D) - - - PROPOSED EASEMENT TO DRAIN WATER
- - - (E) - - - PROPOSED EASEMENT FOR ACCESS AND MAINTENANCE 17 m LONG
- STORMWATER KERB INLET PIT
- STORMWATER INTERALLOTMENT DRAINAGE PIT / CONNECTION
- EXISTING STORMWATER INTERALLOTMENT DRAINAGE PIT
- - - INTER ALLOTMENT DRAINAGE AND STREET DRAINAGE LINE
- ELECTRICAL PADMOUNT SUBSTATION *
- SEWER MANHOLE/MAINTENANCE SHAFT #
- PROPOSED 4m WIDE DRIVEWAY LOCATION, INDICATIVE ONLY
- VERGE
- LOTS
- FOOTPATH
- EXISTING LOTS
- FUTURE RESIDENTIAL LOTS

- ### NOTES:
1. EASEMENTS, AND POSITIVE COVENANT LOCATIONS SHOWN HEREON ARE SUBJECT TO FINAL APPROVAL FROM BLACKTOWN CITY COUNCIL, RELEVANT SERVICING AUTHORITIES AND FINAL REGISTRATION OF THE FINAL DEPOSITED PLAN AT LRS.
 2. SERVICES SHOWN HEREON ARE DRAFT ONLY AND SUBJECT TO RELEVANT AUTHORITY APPROVAL. FINAL LOCATION OF ALL SERVICES TO BE DETERMINED ONSITE PRIOR TO COMMENCEMENT OF ANY CONSTRUCTION OR EXCAVATION.
 3. CONTOURS SHOWN HEREON ARE FROM SUBDIVISION DESIGN PLANS AND ARE TO BE CONFIRMED ON SITE PRIOR TO COMMENCEMENT OF ANY CONSTRUCTION OR EXCAVATION. INTERVAL 0.5m.
 4. CONCRETE SLAB THICKNESS AND PIERING REQUIREMENTS ARE SUBJECT TO STRUCTURAL DESIGN.
 5. ALL LOTS ARE FILLED ABOVE NATURAL SURFACE LEVEL.

DISCLAIMER

THIS PLAN IS PROVIDED SOLELY FOR THE PURPOSE OF PROVIDING AN IMPRESSION OF THE PROPOSED LOCATION OF INFRASTRUCTURE AND SERVICES ON, IN OR AROUND THE LOTS SHOWN IN THE PLAN, AND IS NOT INTENDED TO BE USED FOR ANY OTHER PURPOSE. WINTEN PROPERTY GROUP DOES NOT MAKE ANY REPRESENTATION OR GIVE ANY WARRANTY IN RELATION TO THE EXISTENCE AND PROPOSED LOCATION OF ANY SERVICES OR INFRASTRUCTURE ON, IN OR AROUND THE LOTS SHOWN IN THE PLAN. THE PLAN IS BASED ON THE INTENTION OF, AND INFORMATION AVAILABLE TO, WINTEN PROPERTY GROUP, AT THE TIME OF CREATION OF THE PLAN (FEBRUARY 2024) AND DETAILS MAY CHANGE DUE TO FUTURE CIRCUMSTANCES. ANY INDICATIONS OF DISTANCE OR SIZE ARE APPROXIMATE AND FOR INDICATIVE PURPOSES ONLY, AND ARE NOT TO SCALE. THE PLAN IS NOT A LEGALLY BINDING OBLIGATION OR WARRANTY BY WINTEN PROPERTY GROUP. WINTEN PROPERTY GROUP ACCEPTS NO LIABILITY FOR ANY LOSS OR DAMAGE ARISING AS A RESULT OF ANY RELIANCE ON THIS PLAN OR ITS CONTENTS.

- ### EASEMENT NOTES
- (A) EASEMENT FOR PADMOUNT SUBSTATION 2.75m x 5.5m AND VARIABLE.
 - (B) RESTRICTION ON THE USE OF LAND IN RELATION TO FIRE RATINGS OF BUILDINGS MEASURED 3m FROM THE SUBSTATION PLINTH.
 - (C) RESTRICTION ON THE USE OF LAND IN RELATION TO SWIMMING POOLS MEASURED 5m FROM THE SUBSTATION PLINTH.
 - (D) EASEMENT FOR DRAINAGE 1.5m WIDE
 - (E) EASEMENT FOR ACCESS 0.9m WIDE

SERVICES FILES

# SEWER & WATER:	QALCHEK - Rec 17/10/23 PM28840 PW-A BASE.dwg PM28840 WW-A BASE.dwg
* ELECTRICAL:	POWER LINE DESIGN - 27/06/23 (URS26188) RICHMOND RD, MARSDEN PARK - 7J - 527571A_URS26188_Rec_230622
LOT BOUNDARIES:	VINCE MORGAN SURVEYORS - Rec 06/09/2021 7j-dp-060921.pdf
LOT CALCULATIONS:	VINCE MORGAN SURVEYORS - Rec 27/09/2021 DP1275630-270921.pdf
STORMWATER:	J WYNNDHAM PRINCE - 28/09/2021 998512/CC17001 - CC17803 Rev 1

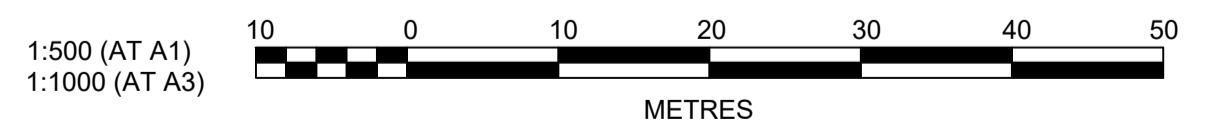

REFER DRAWING SP04 FOR CONTINUATION

REFER DRAWING SP02 FOR CONTINUATION

AMENDMENT	DES	DRN	CKD	APR	DATE
2	KE	JM	KE		16/02/24
1	KE	NP / KE	DG	MS	01/10/21

J. WYNDHAM PRINCE
CONSULTING CIVIL INFRASTRUCTURE ENGINEERS & PROJECT MANAGERS

PO Box 4366 PENRITH WESTFIELD NSW 2750
P 02 4720 3300 W www.jwprince.com.au E jwp@jwprince.com.au

CLIENT: **WINTEN PROPERTY GROUP**

STATUS: **SALES PLANS**
NOT FOR CONSTRUCTION

THIS DRAWING MUST NOT BE USED FOR CONSTRUCTION UNLESS SIGNED AS PART OF AN APPROVED CONSTRUCTION CERTIFICATE.

NEWPARK PRECINCT 7J
SALES PLANS
SHEET 1

PROJECT No: **9985-12**
SHEET No: **SP01**

PLAN No: **9985-12-7J-SP01**

AZIMUTH: M.G.A.94 DATUM: A.H.D. ORIGIN: - PLAN No: 9985-12-7J-SP01 2

LEGEND

- s — s — SEWER #
- w — w — WATER #
- WATER METER LOCATION #
- (D) PROPOSED EASEMENT TO DRAIN WATER
- (E) PROPOSED EASEMENT FOR ACCESS AND MAINTENANCE 17 m LONG
- STORMWATER KERB INLET PIT
- STORMWATER INTERALLOTMENT DRAINAGE PIT / CONNECTION
- EXISTING STORMWATER INTERALLOTMENT DRAINAGE PIT
- INTER ALLOTMENT DRAINAGE AND STREET DRAINAGE LINE
- E ELECTRICAL PADMOUNT SUBSTATION *
- SEWER MANHOLE/MAINTENANCE SHAFT #
- PROPOSED 4m WIDE DRIVEWAY LOCATION, INDICATIVE ONLY
- VERGE
- LOTS
- FOOTPATH
- EXISTING LOTS
- FUTURE RESIDENTIAL LOTS

NOTES:

1. EASEMENTS, AND POSITIVE COVENANT LOCATIONS SHOWN HEREON ARE SUBJECT TO FINAL APPROVAL FROM BLACKTOWN CITY COUNCIL, RELEVANT SERVICING AUTHORITIES AND FINAL REGISTRATION OF THE FINAL DEPOSITED PLAN AT LRS.
2. SERVICES SHOWN HEREON ARE DRAFT ONLY AND SUBJECT TO RELEVANT AUTHORITY APPROVAL. FINAL LOCATION OF ALL SERVICES TO BE DETERMINED ONSITE PRIOR TO COMMENCEMENT OF ANY CONSTRUCTION OR EXCAVATION.
3. CONTOURS SHOWN HEREON ARE FROM SUBDIVISION DESIGN PLANS AND ARE TO BE CONFIRMED ON SITE PRIOR TO COMMENCEMENT OF ANY CONSTRUCTION OR EXCAVATION. INTERVAL 0.5m.
4. CONCRETE SLAB THICKNESS AND PIERING REQUIREMENTS ARE SUBJECT TO STRUCTURAL DESIGN.
5. ALL LOTS ARE FILLED ABOVE NATURAL SURFACE LEVEL.

DISCLAIMER

THIS PLAN IS PROVIDED SOLELY FOR THE PURPOSE OF PROVIDING AN IMPRESSION OF THE PROPOSED LOCATION OF INFRASTRUCTURE AND SERVICES ON, IN OR AROUND THE LOTS SHOWN IN THE PLAN, AND IS NOT INTENDED TO BE USED FOR ANY OTHER PURPOSE. WINTEN PROPERTY GROUP DOES NOT MAKE ANY REPRESENTATION OR GIVE ANY WARRANTY IN RELATION TO THE EXISTENCE AND PROPOSED LOCATION OF ANY SERVICES OR INFRASTRUCTURE ON, IN OR AROUND THE LOTS SHOWN IN THE PLAN. THE PLAN IS BASED ON THE INTENTION OF, AND INFORMATION AVAILABLE TO, WINTEN PROPERTY GROUP, AT THE TIME OF CREATION OF THE PLAN (FEBRUARY 2024) AND DETAILS MAY CHANGE DUE TO FUTURE CIRCUMSTANCES. ANY INDICATIONS OF DISTANCE OR SIZE ARE APPROXIMATE AND FOR INDICATIVE PURPOSES ONLY, AND ARE NOT TO SCALE. THE PLAN IS NOT A LEGALLY BINDING OBLIGATION OR WARRANTY BY WINTEN PROPERTY GROUP. WINTEN PROPERTY GROUP ACCEPTS NO LIABILITY FOR ANY LOSS OR DAMAGE ARISING AS A RESULT OF ANY RELIANCE ON THIS PLAN OR ITS CONTENTS.

EASEMENT NOTES

- (A) EASEMENT FOR PADMOUNT SUBSTATION 2.75m x 5.5m AND VARIABLE.
- (B) RESTRICTION ON THE USE OF LAND IN RELATION TO FIRE RATINGS OF BUILDINGS MEASURED 3m FROM THE SUBSTATION PLINTH.
- (C) RESTRICTION ON THE USE OF LAND IN RELATION TO SWIMMING POOLS MEASURED 5m FROM THE SUBSTATION PLINTH.
- (D) EASEMENT FOR DRAINAGE 1.5m WIDE
- (E) EASEMENT FOR ACCESS 0.9m WIDE

SERVICES FILES

- # SEWER & WATER: QALCHEK - Rec 17/10/23
PM28840 PW-A BASE.dwg
PM28840 WW-A BASE.dwg
- * ELECTRICAL: POWER LINE DESIGN - 27/06/23
(URS26188) RICHMOND RD, MARSDEN PARK - 7J - 527571A_URS26188_Rec_230622
- LOT BOUNDARIES: VINCE MORGAN SURVEYORS - Rec 06/09/2021
7j-dp-060921.pdf
- LOT CALCULATIONS: VINCE MORGAN SURVEYORS - Rec 27/09/2021
DP1275630-270921.pdf
- STORMWATER: J WYNDHAM PRINCE - 28/09/2021
998512/CC17001 - CC17803 Rev 1

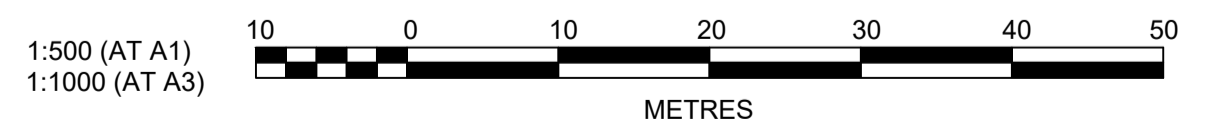

REFER DRAWING SP01 FOR CONTINUATION

REFER DRAWING SP03 FOR CONTINUATION

Plotted: 29 February 2024 7:59:05 AM. File Name: J:\9985\SP - Sales Plans\PK12 CENTRAL PRECINCTS\Printout 7\060921-12-J-SP02.dwg

AMENDMENT	DES	DRN	CKD	APR	DATE
2	KE	JM	KE		16/02/24
1	KE	NP / KE	DG	MS	01/10/21

J. WYNDHAM PRINCE
CONSULTING CIVIL INFRASTRUCTURE ENGINEERS & PROJECT MANAGERS

PO Box 4366 PENRITH WESTFIELD NSW 2750
P 02 4720 3300 W www.jwprince.com.au E jwp@jwprince.com.au

CLIENT: **WINTEN PROPERTY GROUP**

STATUS: **SALES PLANS**
NOT FOR CONSTRUCTION

THIS DRAWING MUST NOT BE USED FOR CONSTRUCTION UNLESS SIGNED AS PART OF AN APPROVED CONSTRUCTION CERTIFICATE.

NEWPARK PRECINCT 7J
SALES PLANS
SHEET 2

PROJECT No: **9985-12**
SHEET No: **SP02**
PLAN No: **9985-12-7J-SP02**

LEGEND

- S — S — SEWER #
- W — W — WATER #
- WATER METER LOCATION #
- (D) PROPOSED EASEMENT TO DRAIN WATER
- (E) PROPOSED EASEMENT FOR ACCESS AND MAINTENANCE 17 m LONG
- STORMWATER KERB INLET PIT
- STORMWATER INTERALLOTMENT DRAINAGE PIT / CONNECTION
- EXISTING STORMWATER INTERALLOTMENT DRAINAGE PIT
- INTER ALLOTMENT DRAINAGE AND STREET DRAINAGE LINE
- ELECTRICAL PADMOUNT SUBSTATION *
- SEWER MANHOLE/MAINTENANCE SHAFT #
- PROPOSED 4m WIDE DRIVEWAY LOCATION. INDICATIVE ONLY
- VERGE
- LOTS
- FOOTPATH
- EXISTING LOTS
- FUTURE RESIDENTIAL LOTS

NOTES:

1. EASEMENTS, AND POSITIVE COVENANT LOCATIONS SHOWN HEREON ARE SUBJECT TO FINAL APPROVAL FROM BLACKTOWN CITY COUNCIL, RELEVANT SERVICING AUTHORITIES AND FINAL REGISTRATION OF THE FINAL DEPOSITED PLAN AT LRS.
2. SERVICES SHOWN HEREON ARE DRAFT ONLY AND SUBJECT TO RELEVANT AUTHORITY APPROVAL. FINAL LOCATION OF ALL SERVICES TO BE DETERMINED ONSITE PRIOR TO COMMENCEMENT OF ANY CONSTRUCTION OR EXCAVATION.
3. CONTOURS SHOWN HEREON ARE FROM SUBDIVISION DESIGN PLANS AND ARE TO BE CONFIRMED ON SITE PRIOR TO COMMENCEMENT OF ANY CONSTRUCTION OR EXCAVATION. INTERVAL 0.5m.
4. CONCRETE SLAB THICKNESS AND PIERING REQUIREMENTS ARE SUBJECT TO STRUCTURAL DESIGN.
5. ALL LOTS ARE FILLED ABOVE NATURAL SURFACE LEVEL.

DISCLAIMER

THIS PLAN IS PROVIDED SOLELY FOR THE PURPOSE OF PROVIDING AN IMPRESSION OF THE PROPOSED LOCATION OF INFRASTRUCTURE AND SERVICES ON, IN OR AROUND THE LOTS SHOWN IN THE PLAN, AND IS NOT INTENDED TO BE USED FOR ANY OTHER PURPOSE. WINTEN PROPERTY GROUP DOES NOT MAKE ANY REPRESENTATION OR GIVE ANY WARRANTY IN RELATION TO THE EXISTENCE AND PROPOSED LOCATION OF ANY SERVICES OR INFRASTRUCTURE ON, IN OR AROUND THE LOTS SHOWN IN THE PLAN. THE PLAN IS BASED ON THE INTENTION OF, AND INFORMATION AVAILABLE TO, WINTEN PROPERTY GROUP, AT THE TIME OF CREATION OF THE PLAN (FEBRUARY 2024) AND DETAILS MAY CHANGE DUE TO FUTURE CIRCUMSTANCES. ANY INDICATIONS OF DISTANCE OR SIZE ARE APPROXIMATE AND FOR INDICATIVE PURPOSES ONLY, AND ARE NOT TO SCALE. THE PLAN IS NOT A LEGALLY BINDING OBLIGATION OR WARRANTY BY WINTEN PROPERTY GROUP. WINTEN PROPERTY GROUP ACCEPTS NO LIABILITY FOR ANY LOSS OR DAMAGE ARISING AS A RESULT OF ANY RELIANCE ON THIS PLAN OR ITS CONTENTS.

EASEMENT NOTES

- (A) EASEMENT FOR PADMOUNT SUBSTATION 2.75m x 5.5m AND VARIABLE.
- (B) RESTRICTION ON THE USE OF LAND IN RELATION TO FIRE RATINGS OF BUILDINGS MEASURED 3m FROM THE SUBSTATION PLINTH.
- (C) RESTRICTION ON THE USE OF LAND IN RELATION TO SWIMMING POOLS MEASURED 5m FROM THE SUBSTATION PLINTH.
- (D) EASEMENT FOR DRAINAGE 1.5m WIDE
- (E) EASEMENT FOR ACCESS 0.9m WIDE

SERVICES FILES

# SEWER & WATER:	QALCHEK - Rec 17/10/23 PM28840 PW-A BASE.dwg PM28840 WW-A BASE.dwg
* ELECTRICAL:	POWER LINE DESIGN - 27/06/23 (URS26188) RICHMOND RD, MARSDEN PARK - 7J - 527571A_URS26188_Rec_230622
LOT BOUNDARIES:	VINCE MORGAN SURVEYORS - Rec 06/09/2021 7j-dp-060921.pdf
LOT CALCULATIONS:	VINCE MORGAN SURVEYORS - Rec 27/09/2021 DP1275630-270921.pdf
STORMWATER:	J WYNDHAM PRINCE - 28/09/2021 998512/CC17001 - CC17803 Rev 1

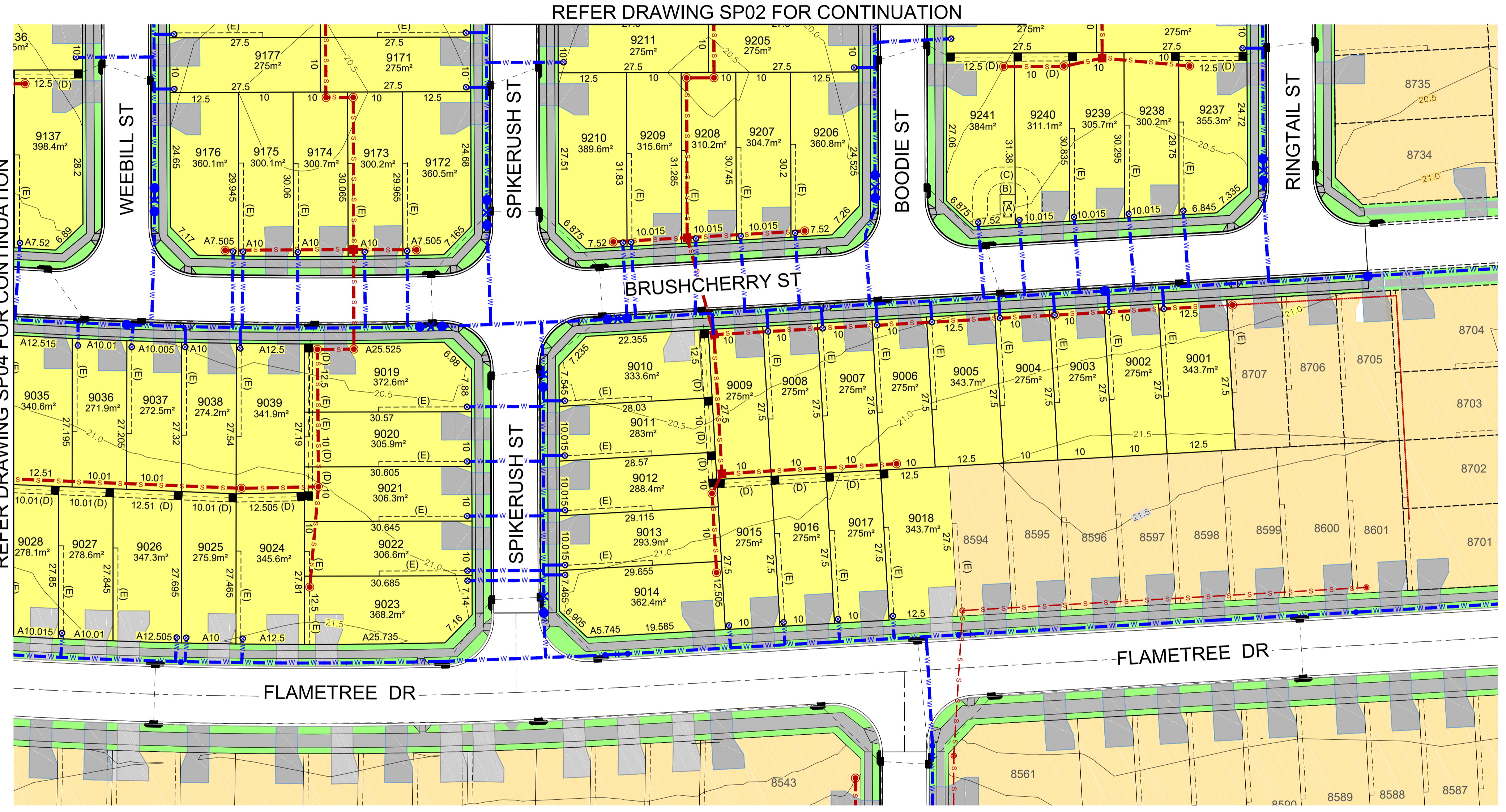
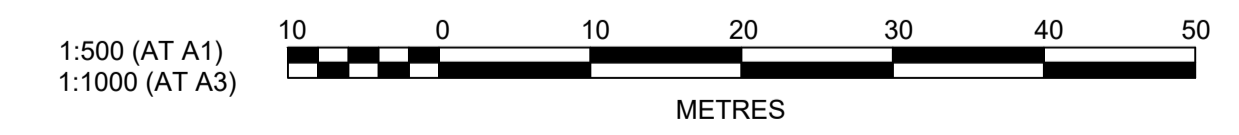

Plotted: 29 February 2024 7:59:51 AM. File Name: J:\998512\J-SP03.dwg

NO	DESCRIPTION	DES	DRN	CKD	APR	DATE
2	ISSUE FOR INFORMATION	KE	JM	KE		16/02/24
1	ISSUE FOR INFORMATION	KE	NP / KE	DG	MS	01/10/21
	AMENDMENT	DES	DRN	CKD	APR	DATE

J. WYNDHAM PRINCE
CONSULTING CIVIL INFRASTRUCTURE ENGINEERS & PROJECT MANAGERS

PO Box 4366 PENRITH WESTFIELD NSW 2750
P 02 4720 3300 W www.jwprince.com.au E jwp@jwprince.com.au

CLIENT:

WINTEN PROPERTY GROUP

STATUS:

SALES PLANS
NOT FOR CONSTRUCTION

THIS DRAWING MUST NOT BE USED FOR CONSTRUCTION UNLESS SIGNED AS PART OF AN APPROVED CONSTRUCTION CERTIFICATE.

NEWPARK
PRECINCT 7J
SALES PLANS
SHEET 3

PROJECT No:
9985-12
SHEET No:
SP03

PLAN No: **9985-12-7J-SP03**

AZIMUTH: M.G.A.94 DATUM: A.H.D. ORIGIN: - PLAN No: **9985-12-7J-SP03** 2

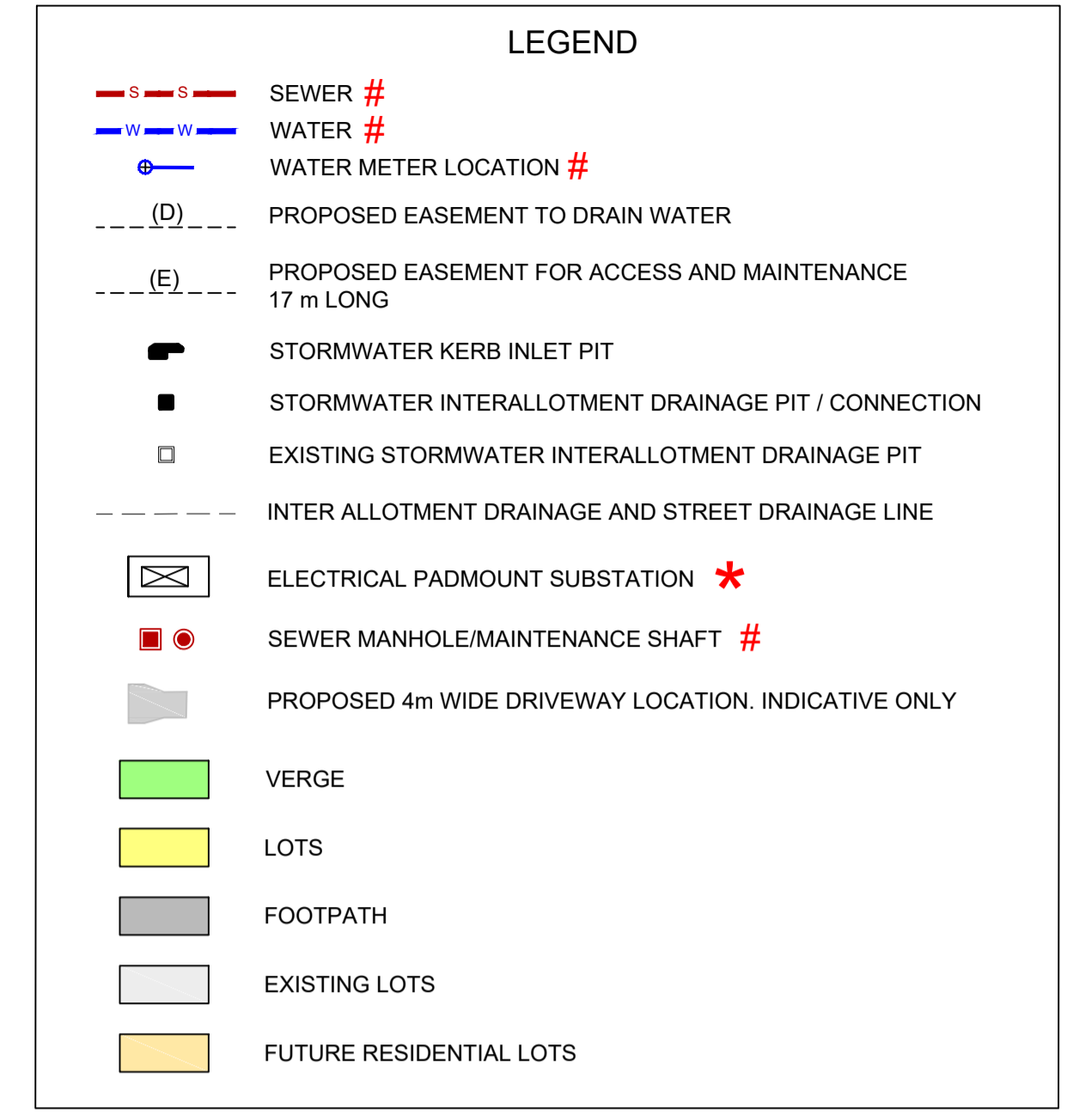
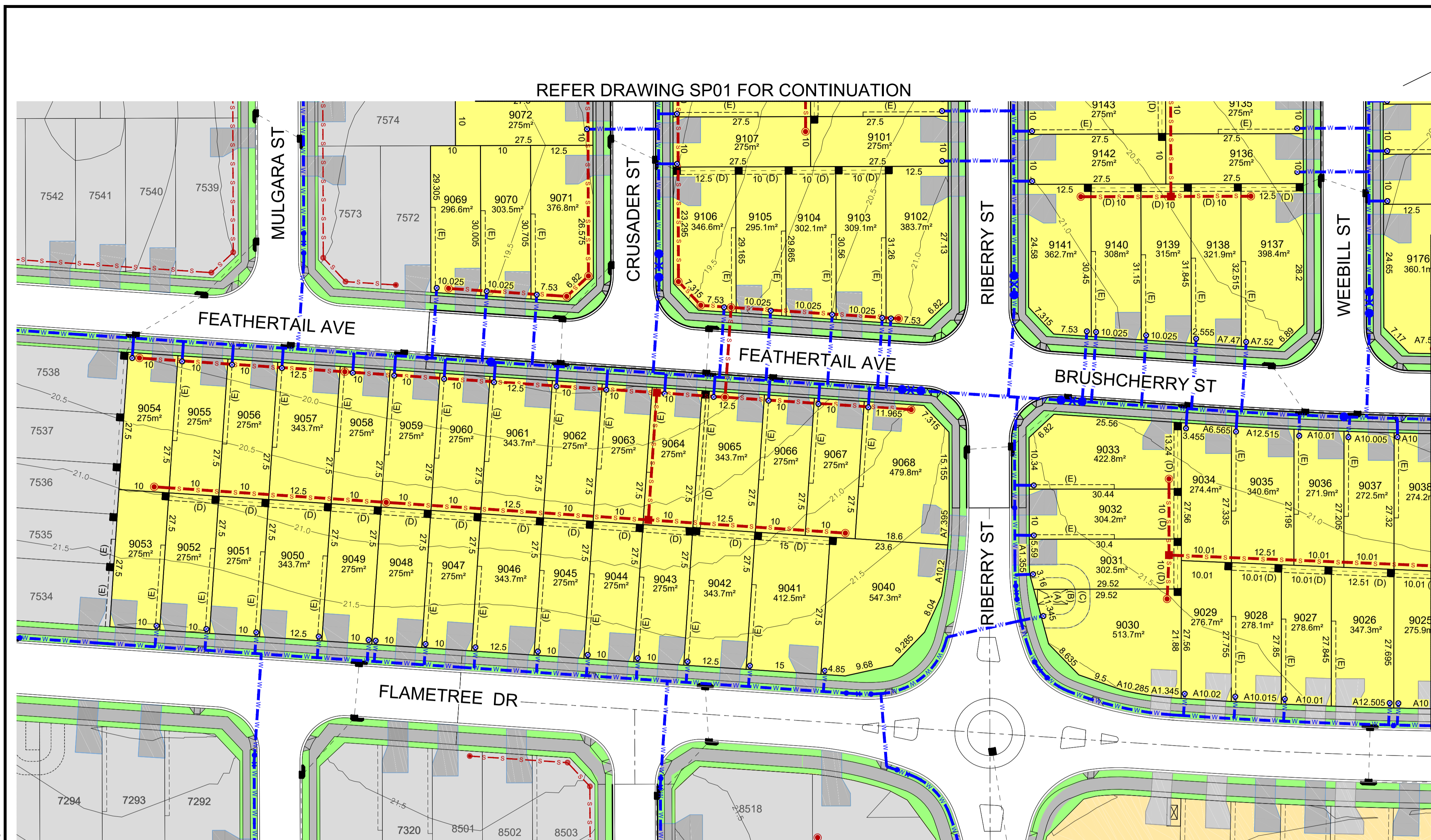

- NOTES:**
- EASEMENTS, AND POSITIVE COVENANT LOCATIONS SHOWN HEREON ARE SUBJECT TO FINAL APPROVAL FROM BLACKTOWN CITY COUNCIL, RELEVANT SERVICING AUTHORITIES AND FINAL REGISTRATION OF THE FINAL DEPOSITED PLAN AT LRS.
 - SERVICES SHOWN HEREON ARE DRAFT ONLY AND SUBJECT TO RELEVANT AUTHORITY APPROVAL. FINAL LOCATION OF ALL SERVICES TO BE DETERMINED ONSITE PRIOR TO COMMENCEMENT OF ANY CONSTRUCTION OR EXCAVATION.
 - CONTOURS SHOWN HEREON ARE FROM SUBDIVISION DESIGN PLANS AND ARE TO BE CONFIRMED ON SITE PRIOR TO COMMENCEMENT OF ANY CONSTRUCTION OR EXCAVATION. INTERVAL 0.5m.
 - CONCRETE SLAB THICKNESS AND PIERING REQUIREMENTS ARE SUBJECT TO STRUCTURAL DESIGN.
 - ALL LOTS ARE FILLED ABOVE NATURAL SURFACE LEVEL.

DISCLAIMER

THIS PLAN IS PROVIDED SOLELY FOR THE PURPOSE OF PROVIDING AN IMPRESSION OF THE PROPOSED LOCATION OF INFRASTRUCTURE AND SERVICES ON, IN OR AROUND THE LOTS SHOWN IN THE PLAN, AND IS NOT INTENDED TO BE USED FOR ANY OTHER PURPOSE. WINTEN PROPERTY GROUP DOES NOT MAKE ANY REPRESENTATION OR GIVE ANY WARRANTY IN RELATION TO THE EXISTENCE AND PROPOSED LOCATION OF ANY SERVICES OR INFRASTRUCTURE ON, IN OR AROUND THE LOTS SHOWN IN THE PLAN. THE PLAN IS BASED ON THE INTENTION OF, AND INFORMATION AVAILABLE TO, WINTEN PROPERTY GROUP, AT THE TIME OF CREATION OF THE PLAN (FEBRUARY 2024) AND DETAILS MAY CHANGE DUE TO FUTURE CIRCUMSTANCES. ANY INDICATIONS OF DISTANCE OR SIZE ARE APPROXIMATE AND FOR INDICATIVE PURPOSES ONLY, AND ARE NOT TO SCALE. THE PLAN IS NOT A LEGALLY BINDING OBLIGATION OR WARRANTY BY WINTEN PROPERTY GROUP. WINTEN PROPERTY GROUP ACCEPTS NO LIABILITY FOR ANY LOSS OR DAMAGE ARISING AS A RESULT OF ANY RELIANCE ON THIS PLAN OR ITS CONTENTS.

- EASEMENT NOTES**
- (A) EASEMENT FOR PADMOUNT SUBSTATION 2.75m x 5.5m AND VARIABLE.
 - (B) RESTRICTION ON THE USE OF LAND IN RELATION TO FIRE RATINGS OF BUILDINGS MEASURED 3m FROM THE SUBSTATION PLINTH.
 - (C) RESTRICTION ON THE USE OF LAND IN RELATION TO SWIMMING POOLS MEASURED 5m FROM THE SUBSTATION PLINTH.
 - (D) EASEMENT FOR DRAINAGE 1.5m WIDE
 - (E) EASEMENT FOR ACCESS 0.9m WIDE

SERVICES FILES

# SEWER & WATER:	QALCHEK - Rec 17/10/23 PM28840 PW-A BASE.dwg PM28840 WW-A BASE.dwg
* ELECTRICAL:	POWER LINE DESIGN - 27/06/23 (URS26188) RICHMOND RD, MARSDEN PARK - 7J - 527571A_URS26188_Rec_230622
LOT BOUNDARIES:	VINCE MORGAN SURVEYORS - Rec 06/09/2021 7j-dp-060921.pdf
LOT CALCULATIONS:	VINCE MORGAN SURVEYORS - Rec 27/09/2021 DP1275630-270921.pdf
STORMWATER:	J WYNDHAM PRINCE - 28/09/2021 998512/CC17001 - CC17803 Rev 1

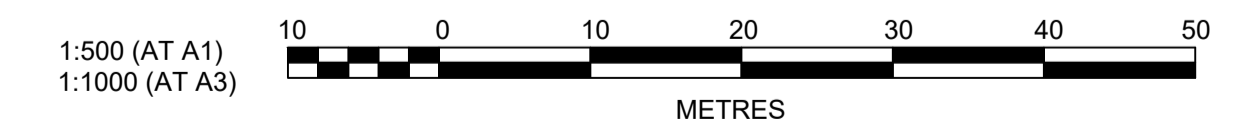

Plotted: 29 February, 2024, 7:57:39 AM. File Name: J:\9985\12\J-SP04.dwg

2	ISSUE FOR INFORMATION	KE	JM	KE	16/02/24
1	ISSUE FOR INFORMATION	KE	NP/KE	DG MS	01/10/21
	AMENDMENT	DES	DRN	CKD	APR
					DATE

J. WYNDHAM PRINCE
CONSULTING CIVIL INFRASTRUCTURE ENGINEERS & PROJECT MANAGERS

PO Box 4366 PENRITH WESTFIELD NSW 2750
P 02 4720 3300 W www.jwprince.com.au E jwp@jwprince.com.au

CLIENT: **WINTEN PROPERTY GROUP**

STATUS: **SALES PLANS**
NOT FOR CONSTRUCTION

THIS DRAWING MUST NOT BE USED FOR CONSTRUCTION UNLESS SIGNED AS PART OF AN APPROVED CONSTRUCTION CERTIFICATE.

NEWPARK PRECINCT 7J
SALES PLANS
SHEET 4

PROJECT No: **9985-12**
SHEET No: **SP04**

PLAN No: **9985-12-7J-SP04**

AZIMUTH: M.G.A.94	DATUM: A.H.D.	ORIGIN: -	PLAN No: 9985-12-7J-SP04	2
-------------------	---------------	-----------	--------------------------	---