

- NOTES:**
1. EASEMENTS, AND POSITIVE COVENANT LOCATIONS SHOWN HEREON ARE SUBJECT TO FINAL APPROVAL FROM BLACKTOWN CITY COUNCIL, RELEVANT SERVICING AUTHORITIES AND FINAL REGISTRATION OF THE FINAL DEPOSITED PLAN AT LRS.
 2. SERVICES SHOWN HEREON ARE DRAFT ONLY AND SUBJECT TO RELEVANT AUTHORITY APPROVAL. FINAL LOCATION OF ALL SERVICES TO BE DETERMINED ONSITE PRIOR TO COMMENCEMENT OF ANY CONSTRUCTION OR EXCAVATION.
 3. CONTOURS SHOWN HEREON ARE FROM SUBDIVISION DESIGN PLANS AND ARE TO BE DETERMINED ON SITE PRIOR TO COMMENCEMENT OF ANY CONSTRUCTION OR EXCAVATION. INTERVAL 0.5m.
 4. CONCRETE SLAB THICKNESS AND PIERING REQUIREMENTS ARE SUBJECT TO STRUCTURAL DESIGN.
 5. ALL LOTS ARE FILLED ABOVE NATURAL SURFACE LEVEL.

DISCLAIMER

THIS PLAN IS PROVIDED SOLELY FOR THE PURPOSE OF PROVIDING AN IMPRESSION OF THE PROPOSED LOCATION OF INFRASTRUCTURE AND SERVICES ON, IN OR AROUND THE LOTS SHOWN IN THE PLAN, AND IS NOT INTENDED TO BE USED FOR ANY OTHER PURPOSE. WINTEN PROPERTY GROUP DOES NOT MAKE ANY REPRESENTATION OR GIVE ANY WARRANTY IN RELATION TO THE EXISTENCE AND PROPOSED LOCATION OF ANY SERVICES OR INFRASTRUCTURE ON, IN OR AROUND THE LOTS SHOWN IN THE PLAN. THE PLAN IS BASED ON THE INTENTION OF, AND INFORMATION AVAILABLE TO, WINTEN PROPERTY GROUP, AT THE TIME OF CREATION OF THE PLAN (SEPTEMBER 2024) AND DETAILS MAY CHANGE DUE TO FUTURE CIRCUMSTANCES. ANY INDICATIONS OF DISTANCE OR SIZE ARE APPROXIMATE AND FOR INDICATIVE PURPOSES ONLY, AND ARE NOT TO SCALE. THE PLAN IS NOT A LEGALLY BINDING OBLIGATION ON OR WARRANTY BY WINTEN PROPERTY GROUP. WINTEN PROPERTY GROUP ACCEPTS NO LIABILITY FOR ANY LOSS OR DAMAGE ARISING AS A RESULT OF ANY RELIANCE ON THIS PLAN OR ITS CONTENTS.

EASEMENT NOTES

- (A) EASEMENT FOR PADMOUNT SUBSTATION 2.75m x 5.5m AND VARIABLE.
- (B) RESTRICTION ON THE USE OF LAND IN RELATION TO FIRE RATINGS OF BUILDINGS MEASURED 3m FROM THE SUBSTATION PLINTH.
- (C) RESTRICTION ON THE USE OF LAND IN RELATION TO SWIMMING POOLS MEASURED 5m FROM THE SUBSTATION PLINTH.
- (D) EASEMENT FOR DRAINAGE 1.5m WIDE
- (E) EASEMENT FOR ACCESS 0.9m WIDE

SERVICES FILES

- | | |
|-------------------|---|
| # SEWER & WATER: | QALCHEK - Rec 20/06/2024
PM195240PW-A REVIEW. dwg
PM195240WW-A PLAN.dwg |
| * ELECTRICAL: | POWER LINE DESIGN - 28/05/2024
(URS26402) RICHMOND RD, MARSDEN PARK - 7H -
PLD3867_240528.dwg |
| LOT BOUNDARIES: | VINCE MORGAN SURVEYORS - Rec 6/12/2021
7h-dp-011121.dxf |
| LOT CALCULATIONS: | VINCE MORGAN SURVEYORS - Rec 6/12/2021
DP1275630-270921.pdf |
| STORMWATER: | J WYNDHAM PRINCE - 30/11/2021
9985-12-CC18001 - CC18803 Rev 1 |

DRAFT ISSUE ONLY
PRELIMINARY DESIGNS SUBJECT TO CHANGE

2	LOT 8796 SUBSTATION AMENDED	KE	NDW	TS	KE	07/10/25
1	ISSUE FOR INFORMATION	KE	NW	TS	KE	11/09/24
	AMENDMENT	DES	DRN	CKD	APR	DATE

J. WYNDHAM PRINCE
CONSULTING CIVIL INFRASTRUCTURE ENGINEERS & PROJECT MANAGERS

PO Box 4366 PENRITH WESTFIELD NSW 2750
P 02 4720 3300 W www.jwprince.com.au E jwp@jwprince.com.au

CLIENT:



STATUS:

ADVANCE COPY
DESIGN SUBJECT TO CHANGE
NOT FOR CONSTRUCTION

THIS DRAWING MUST NOT BE USED FOR CONSTRUCTION UNLESS
SIGNED AS PART OF AN APPROVED CONSTRUCTION CERTIFICATE.

NEWPARK
PRECINCT 7H
SALES PLANS
SHEET 1 OF 4

PROJECT No:
9985-12

SHEET No:
SP01

AZIMUTH: M.G.A.94	DATUM: A.H.D.	ORIGIN: _	PLAN No: 9985-12-7H-SP01	2
-------------------	---------------	-----------	--------------------------	---

--	--

Plotted: 7 October, 2025 10:28:03 AM File Name: J:\9985D\SP - Sales Plans\PK12 CENTRAL PRECINCTS\Precinct 7H\9985-12-7H-SP01.dwg

Plotted: 9 August, 2024, 1:07:02 PM File Name: J:\9985\DISP - Sales Plans\PK12 CENTRAL PRECINCTS\Precinct 7H\9985-12-7H-SP02.dwg

DRAFT ISSUE ONLY
PRELIMINARY DESIGNS SUBJECT TO CHANGE

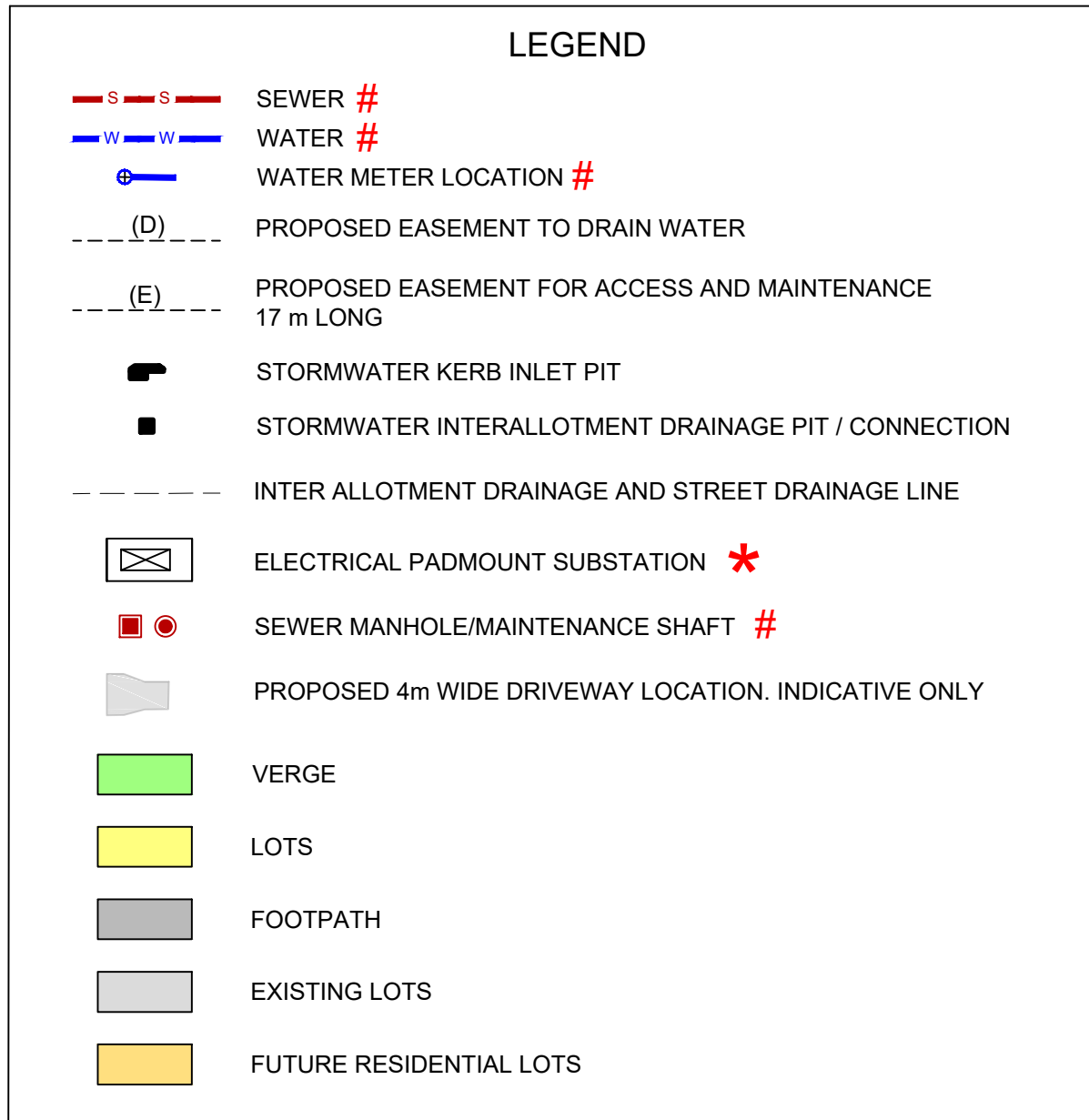

- NOTES:**
- EASEMENTS, AND POSITIVE COVENANT LOCATIONS SHOWN HEREON ARE SUBJECT TO FINAL APPROVAL FROM BLACKTOWN CITY COUNCIL, RELEVANT SERVICING AUTHORITIES AND FINAL REGISTRATION OF THE FINAL DEPOSITED PLAN AT LRS.
 - SERVICES SHOWN HEREON ARE DRAFT ONLY AND SUBJECT TO RELEVANT AUTHORITY APPROVAL. FINAL LOCATION OF ALL SERVICES TO BE DETERMINED ONSITE PRIOR TO COMMENCEMENT OF ANY CONSTRUCTION OR EXCAVATION.
 - CONTOURS SHOWN HEREON ARE FROM SUBDIVISION DESIGN PLANS AND ARE TO BE CONFIRMED ON SITE PRIOR TO COMMENCEMENT OF ANY CONSTRUCTION OR EXCAVATION. INTERVAL 0.5m.
 - CONCRETE SLAB THICKNESS AND PIERING REQUIREMENTS ARE SUBJECT TO STRUCTURAL DESIGN.
 - ALL LOTS ARE FILLED ABOVE NATURAL SURFACE LEVEL.

DISCLAIMER

THIS PLAN IS PROVIDED SOLELY FOR THE PURPOSE OF PROVIDING AN IMPRESSION OF THE PROPOSED LOCATION OF INFRASTRUCTURE AND SERVICES ON, IN OR AROUND THE LOTS SHOWN IN THE PLAN, AND IS NOT INTENDED TO BE USED FOR ANY OTHER PURPOSE. WINTEN PROPERTY GROUP DOES NOT MAKE ANY REPRESENTATION OR GIVE ANY WARRANTY IN RELATION TO THE EXISTENCE AND PROPOSED LOCATION OF ANY SERVICES OR INFRASTRUCTURE ON, IN OR AROUND THE LOTS SHOWN IN THE PLAN. THE PLAN IS BASED ON THE INTENTION OF, AND INFORMATION AVAILABLE TO, WINTEN PROPERTY GROUP, AT THE TIME OF CREATION OF THE PLAN (AUGUST 2024) AND DETAILS MAY CHANGE DUE TO FUTURE CIRCUMSTANCES. ANY INDICATIONS OF DISTANCE OR SIZE ARE APPROXIMATE AND FOR INDICATIVE PURPOSES ONLY, AND ARE NOT TO SCALE. THE PLAN IS NOT A LEGALLY BINDING OBLIGATION ON OR WARRANTY BY WINTEN PROPERTY GROUP. WINTEN PROPERTY GROUP ACCEPTS NO LIABILITY FOR ANY LOSS OR DAMAGE ARISING AS A RESULT OF ANY RELIANCE ON THIS PLAN OR ITS CONTENTS.

- EASEMENT NOTES**
- (A) EASEMENT FOR PADMOUNT SUBSTATION 2.75m x 5.5m AND VARIABLE.
 - (B) RESTRICTION ON THE USE OF LAND IN RELATION TO FIRE RATINGS OF BUILDINGS MEASURED 3m FROM THE SUBSTATION PLINTH.
 - (C) RESTRICTION ON THE USE OF LAND IN RELATION TO SWIMMING POOLS MEASURED 5m FROM THE SUBSTATION PLINTH.
 - (D) EASEMENT FOR DRAINAGE 1.5m WIDE
 - (E) EASEMENT FOR ACCESS 0.9m WIDE

SERVICES FILES	
# SEWER & WATER:	QALCHEK - Rec 20/06/2024 PM195240PW-A REVIEW.dwg PM195240WW-A PLAN.dwg
* ELECTRICAL:	POWER LINE DESIGN - 28/05/2024 (URS26402) RICHMOND RD, MARSDEN PARK - 7H - PLD3867_240528.dwg
LOT BOUNDARIES:	VINCE MORGAN SURVEYORS - Rec 6/12/2021 7h-dp-01121.dxf
LOT CALCULATIONS:	VINCE MORGAN SURVEYORS - Rec 6/12/2021 DP1275630-270921.pdf
STORMWATER:	J WYNDHAM PRINCE - 30/11/2021 9985-12-CC18001 - CC18803 Rev 1

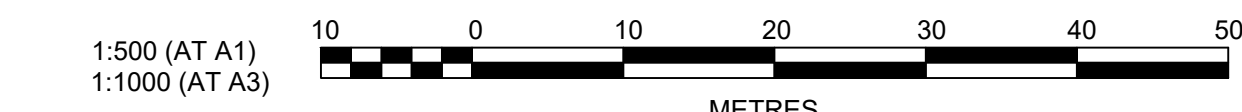

1	ISSUE FOR INFORMATION	KE	NP	TS	KE	08/08/24
	AMENDMENT	DES	DRN	CKD	APR	DATE

J. WYNDHAM PRINCE
CONSULTING CIVIL INFRASTRUCTURE ENGINEERS & PROJECT MANAGERS

PO Box 4366 PENRITH WESTFIELD NSW 2750
P 02 4720 3300 W www.jwprince.com.au E jwp@jwprince.com.au



STATUS:
ADVANCE COPY
DESIGN SUBJECT TO CHANGE
NOT FOR CONSTRUCTION

THIS DRAWING MUST NOT BE USED FOR CONSTRUCTION UNLESS SIGNED AS PART OF AN APPROVED CONSTRUCTION CERTIFICATE.

NEWPARK PRECINCT 7H SALES PLANS SHEET 2 OF 4		PROJECT No: 9985-12	
		SHEET No: SP02	
AZIMUTH: M.G.A.94	DATUM: A.H.D.	ORIGIN: -	PLAN No: 9985-12-7H-SP02
			1

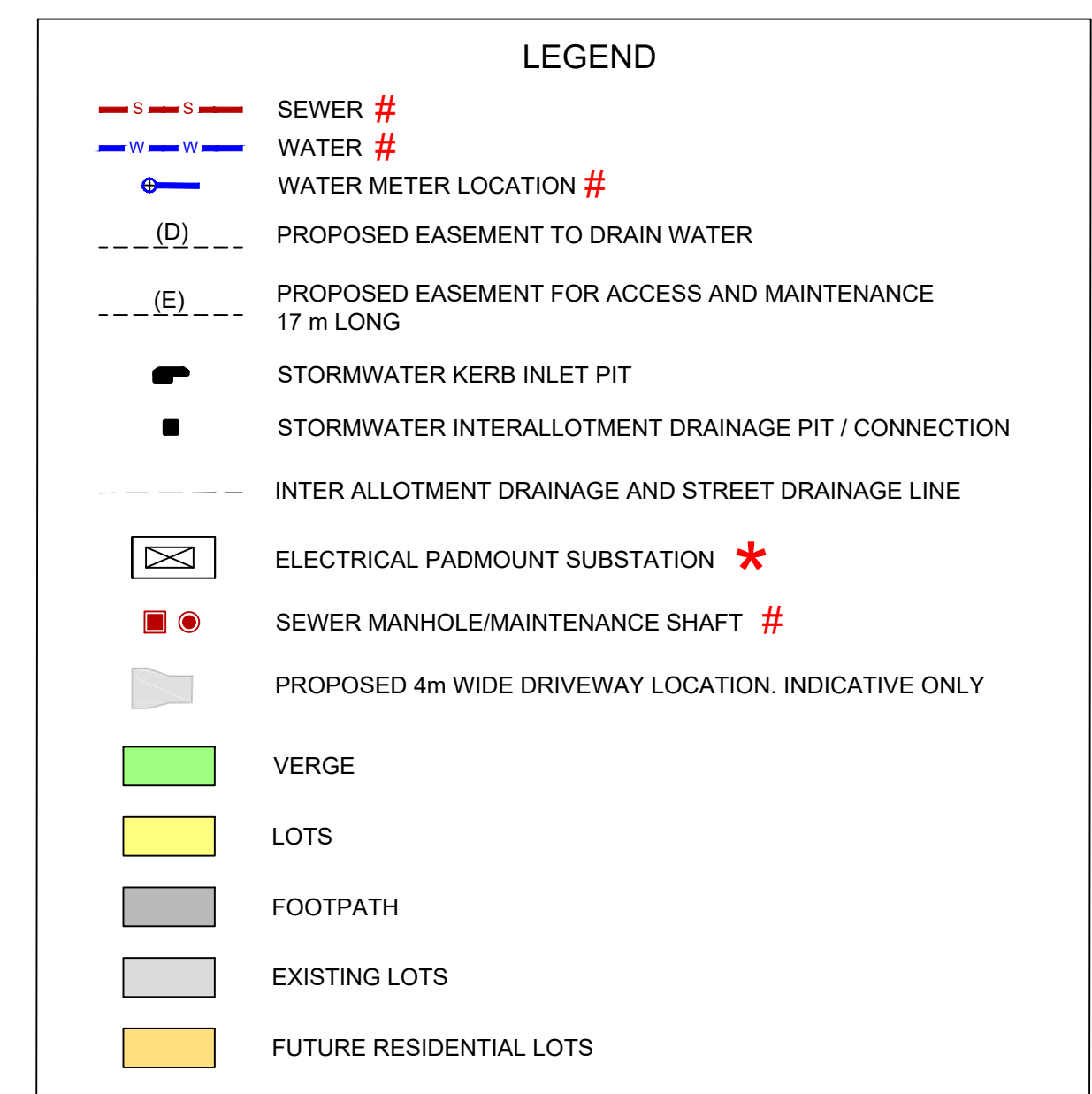
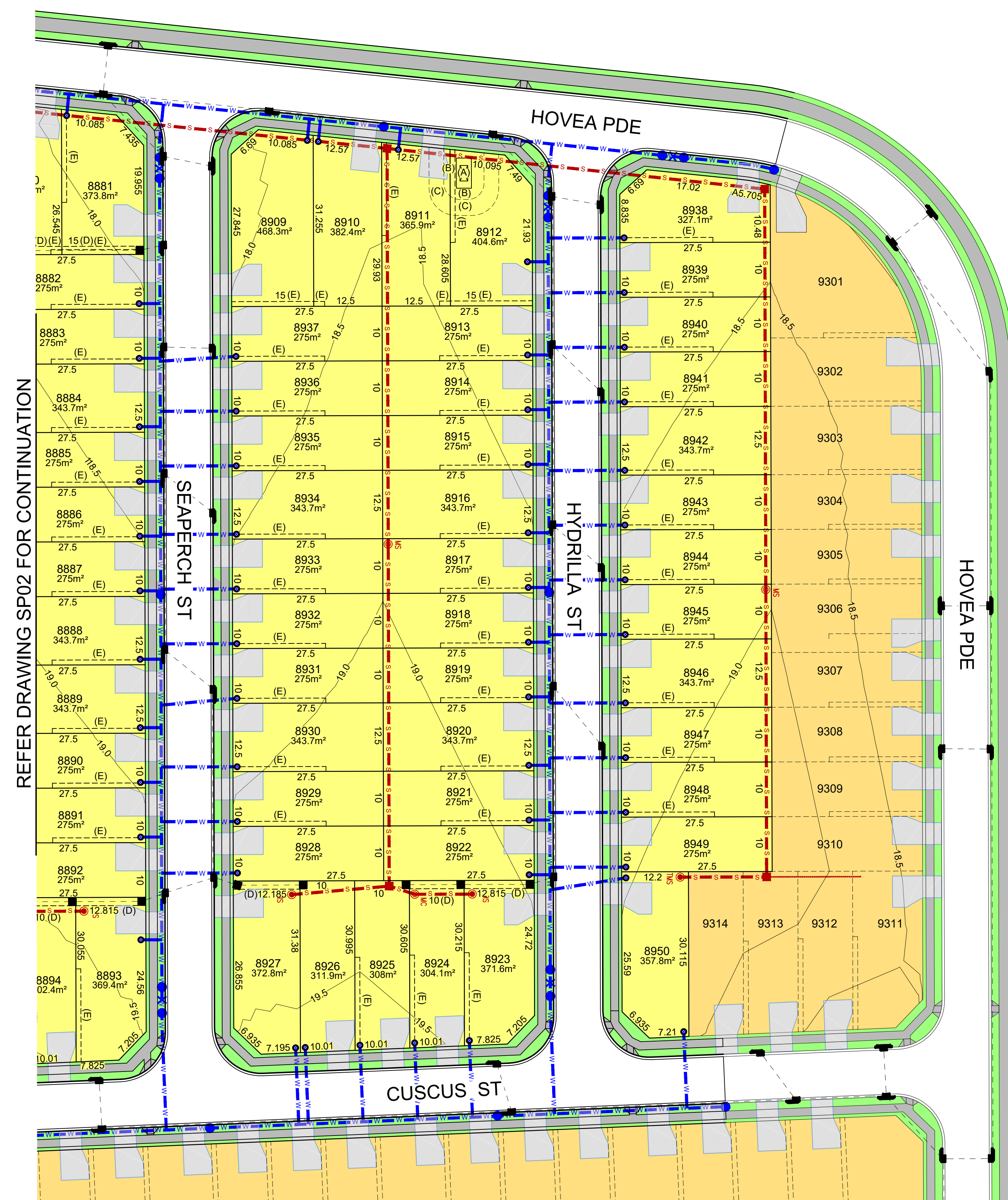

- NOTES:**
1. EASEMENTS, AND POSITIVE COVENANT LOCATIONS SHOWN HEREON ARE SUBJECT TO FINAL APPROVAL FROM BLACKTOWN CITY COUNCIL, RELEVANT SERVICING AUTHORITIES AND FINAL REGISTRATION OF THE FINAL DEPOSITED PLAN AT LRS.
 2. SERVICES SHOWN HEREON ARE DRAFT ONLY AND SUBJECT TO RELEVANT AUTHORITY APPROVAL. FINAL LOCATION OF ALL SERVICES TO BE DETERMINED ONSITE PRIOR TO COMMENCEMENT OF ANY CONSTRUCTION OR EXCAVATION.
 3. CONTOURS SHOWN HEREON ARE FROM SUBDIVISION DESIGN PLANS AND ARE TO BE CONFIRMED ON SITE PRIOR TO COMMENCEMENT OF ANY CONSTRUCTION OR EXCAVATION. MIN. 0.5m.
 4. CONCRETE SLAB THICKNESS AND PIERING REQUIREMENTS ARE SUBJECT TO STRUCTURAL DESIGN.
 5. ALL LOTS ARE FILLED ABOVE NATURAL SURFACE LEVEL.

DISCLAIMER

THIS PLAN IS PROVIDED SOLELY FOR THE PURPOSE OF PROVIDING AN IMPRESSION OF THE PROPOSED LOCATION OF INFRASTRUCTURE AND SERVICES, IN OR AROUND THE LOTS SHOWN IN THE PLAN, AND IS NOT INTENDED TO BE USED FOR ANY OTHER PURPOSE. WINTEN PROPERTY GROUP DOES NOT MAKE ANY REPRESENTATION OR GIVE ANY WARRANTY IN RELATION TO THE EXISTENCE AND PROPOSED LOCATION OF ANY SERVICES OR INFRASTRUCTURE ON, IN OR AROUND THE LOTS SHOWN IN THE PLAN. THE PLAN IS BASED ON THE INTENTION OF, AND INFORMATION AVAILABLE TO, WINTEN PROPERTY GROUP, AT THE TIME OF CREATION OF THE PLAN (SEPTEMBER 2024) AND DETAILS MAY CHANGE DUE TO FUTURE CIRCUMSTANCES. ANY INDICATIONS OF DISTANCE OR SIZE ARE APPROXIMATE AND FOR INDICATIVE PURPOSES ONLY, AND ARE NOT TO SCALE. THE PLAN IS NOT A LEGALLY BINDING OBLIGATION ON OR WARRANTY BY WINTEN PROPERTY GROUP. WINTEN PROPERTY GROUP ACCEPTS NO LIABILITY FOR ANY LOSS OR DAMAGE ARISING AS A RESULT OF ANY RELIANCE ON THIS PLAN OR ITS CONTENTS.

EASEMENT NOTES

- (A) EASEMENT FOR PADMOUNT SUBSTATION 2.75m x 5.5m AND VARIABLE.
- (B) RESTRICTION ON THE USE OF LAND IN RELATION TO FIRE RATINGS OF BUILDINGS MEASURED 3m FROM THE SUBSTATION PLINTH.
- (C) RESTRICTION ON THE USE OF LAND IN RELATION TO SWIMMING POOLS MEASURED 5m FROM THE SUBSTATION PLINTH.
- (D) EASEMENT FOR DRAINAGE 1.5m WIDE
- (E) EASEMENT FOR ACCESS 0.9m WIDE

SERVICES FILES

- | | |
|-------------------|--|
| # SEWER & WATER: | QALCHEK - Rec 20/06/2024
PM195240PW-A REVIEW. dwg
PM195240WW-A PLAN.dwg |
| * ELECTRICAL: | POWER LINE DESIGN - 28/05/2024
(URS26402) RICHMOND RD, MARSDEN PARK - 7H -
PLD3867 _240528.dwg |
| LOT BOUNDARIES: | VINCE-MORGAN SURVEYORS - Rec 6/12/2021
7h-dp-011121.dxf |
| LOT CALCULATIONS: | VINCE-MORGAN SURVEYORS - Rec 6/12/2021
DP1275630-270921.pdf |
| STORMWATER: | J WYNDHAM DESIGN - 30/11/2021
9985-12-CC18001 - CC18803 Rev 1 |

DRAFT ISSUE ONLY
PRELIMINARY DESIGNS SUBJECT TO CHANGE

2	LOT 8912 SUBSTATION AMENDED	KE	NDW	TS	KE	07/10/25
1	ISSUE FOR INFORMATION	KE	NW	TS	KE	11/09/24
	AMENDMENT	DES	DRN	CKD	APR	DATE

J. WYNDHAM PRINCE
CONSULTING CIVIL INFRASTRUCTURE ENGINEERS & PROJECT MANAGERS

PO Box 4366 PENRITH WESTFIELD NSW 2750
P 02 4720 3300 W www.iwprince.com.au E iwp@iwprince.com.au

CLIENT:



STATUS:

ADVANCE COPY
DESIGN SUBJECT TO CHANGE
NOT FOR CONSTRUCTION

THIS DRAWING MUST NOT BE USED FOR CONSTRUCTION UNLESS
SIGNED AS PART OF AN APPROVED CONSTRUCTION CERTIFICATE

NEWPARK
PRECINCT 7H
SALES PLANS
SHEET 3 OF 4

PROJECT No:
9985-12

SHEET No:
SP03

AZIMUTH: M.G.A.94	DATUM: A.H.D.	ORIGIN: _	PLAN No: 9985-12-7H-SP03	2
-------------------	---------------	-----------	--------------------------	---

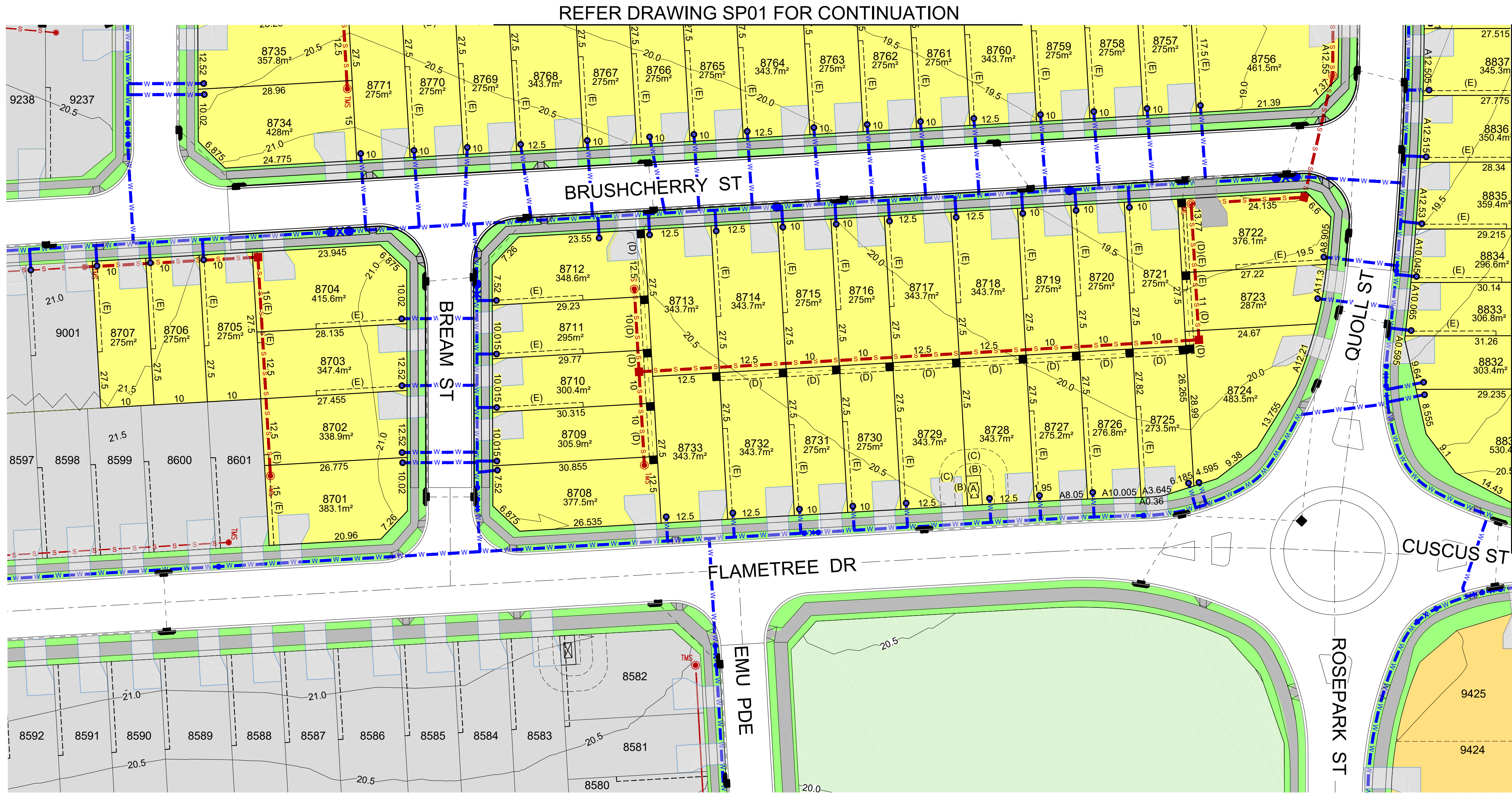

LEGEND

- SEWER #
- WATER #
- WATER METER LOCATION #
- PROPOSED EASEMENT TO DRAIN WATER
- PROPOSED EASEMENT FOR ACCESS AND MAINTENANCE 17 m LONG
- STORMWATER KERB INLET PIT
- STORMWATER INTERALLOTMENT DRAINAGE PIT / CONNECTION
- INTER ALLOTMENT DRAINAGE AND STREET DRAINAGE LINE
- ELECTRICAL PADMOUNT SUBSTATION *
- SEWER MANHOLE/MAINTENANCE SHAFT #
- PROPOSED 4m WIDE DRIVEWAY LOCATION. INDICATIVE ONLY
- VERGE
- LOTS
- FOOTPATH
- EXISTING LOTS
- FUTURE RESIDENTIAL LOTS

- NOTES:
- EASEMENTS, AND POSITIVE COVENANT LOCATIONS SHOWN HEREON ARE SUBJECT TO FINAL APPROVAL FROM BLACKTOWN CITY COUNCIL, RELEVANT SERVICING AUTHORITIES AND FINAL REGISTRATION OF THE FINAL DEPOSITED PLAN AT LRS.
 - SERVICES SHOWN HEREON ARE DRAFT ONLY AND SUBJECT TO RELEVANT AUTHORITY APPROVAL. FINAL LOCATION OF ALL SERVICES TO BE DETERMINED ONSITE PRIOR TO COMMENCEMENT OF ANY CONSTRUCTION OR EXCAVATION.
 - CONTOURS SHOWN HEREON ARE FROM SUBDIVISION DESIGN PLANS AND ARE TO BE CONFIRMED ON SITE PRIOR TO COMMENCEMENT OF ANY CONSTRUCTION OR EXCAVATION. INTERVAL 0.5m.
 - CONCRETE SLAB THICKNESS AND PIERING REQUIREMENTS ARE SUBJECT TO STRUCTURAL DESIGN.
 - ALL LOTS ARE FILLED ABOVE NATURAL SURFACE LEVEL.

DISCLAIMER

THIS PLAN IS PROVIDED SOLELY FOR THE PURPOSE OF PROVIDING AN IMPRESSION OF THE PROPOSED LOCATION OF INFRASTRUCTURE AND SERVICES ON, IN OR AROUND THE LOTS SHOWN IN THE PLAN, AND IS NOT INTENDED TO BE USED FOR ANY OTHER PURPOSE. WINTEN PROPERTY GROUP DOES NOT MAKE ANY REPRESENTATION OR GIVE ANY WARRANTY IN RELATION TO THE EXISTENCE AND PROPOSED LOCATION OF ANY SERVICES OR INFRASTRUCTURE ON, IN OR AROUND THE LOTS SHOWN IN THE PLAN. THE PLAN IS BASED ON THE INTENTION OF, AND INFORMATION AVAILABLE TO, WINTEN PROPERTY GROUP, AT THE TIME OF CREATION OF THE PLAN (AUGUST 2024) AND DETAILS MAY CHANGE DUE TO FUTURE CIRCUMSTANCES. ANY INDICATIONS OF DISTANCE OR SIZE ARE APPROXIMATE AND FOR INDICATIVE PURPOSES ONLY, AND ARE NOT TO SCALE. THE PLAN IS NOT A LEGALLY BINDING OBLIGATION ON OR WARRANTY BY WINTEN PROPERTY GROUP. WINTEN PROPERTY GROUP ACCEPTS NO LIABILITY FOR ANY LOSS OR DAMAGE ARISING AS A RESULT OF ANY RELIANCE ON THIS PLAN OR ITS CONTENTS.

- EASEMENT NOTES
- (A) EASEMENT FOR PADMOUNT SUBSTATION 2.75m x 5.5m AND VARIABLE.
 - (B) RESTRICTION ON THE USE OF LAND IN RELATION TO FIRE RATINGS OF BUILDINGS MEASURED 3m FROM THE SUBSTATION PLINTH.
 - (C) RESTRICTION ON THE USE OF LAND IN RELATION TO SWIMMING POOLS MEASURED 5m FROM THE SUBSTATION PLINTH.
 - (D) EASEMENT FOR DRAINAGE 1.5m WIDE
 - (E) EASEMENT FOR ACCESS 0.9m WIDE

SERVICES FILES	
# SEWER & WATER:	QALCHECK - Rec 20/06/2024 PM195240PW-A REVIEW. dwg PM195240WW-A PLAN. dwg
* ELECTRICAL:	POWER LINE DESIGN - 28/05/2024 (URS26402) RICHMOND RD, MARSDEN PARK - 7H - PLD3867_240528.dwg
LOT BOUNDARIES:	VINCE MORGAN SURVEYORS - Rec 6/12/2021 7h-dp-011121.dxf
LOT CALCULATIONS:	VINCE MORGAN SURVEYORS - Rec 6/12/2021 DP1275630-270921.pdf
STORMWATER:	J WYNNDHAM PRINCE - 30/11/2021 9985-12-CC18001 - CC18803 Rev 1

DRAFT ISSUE ONLY
PRELIMINARY DESIGNS SUBJECT TO CHANGE

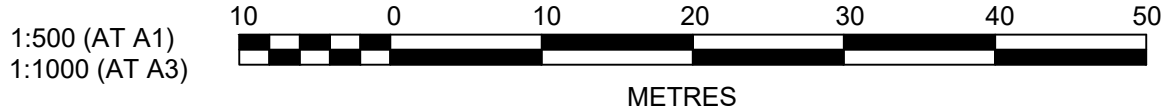

1	ISSUE FOR INFORMATION	KE	NP	TS	KE	08/08/24
	AMENDMENT	DES	DRN	CKD	APR	DATE

J. WYNDHAM PRINCE
CONSULTING CIVIL INFRASTRUCTURE ENGINEERS & PROJECT MANAGERS

PO Box 4366 PENRITH WESTFIELD NSW 2750
P 02 4720 3300 W www.jwprince.com.au E jwp@jwprince.com.au

CLIENT:

WINTEN
PROPERTY
GROUP

STATUS:

ADVANCE COPY
DESIGN SUBJECT TO CHANGE
NOT FOR CONSTRUCTION

THIS DRAWING MUST NOT BE USED FOR CONSTRUCTION UNLESS SIGNED AS PART OF AN APPROVED CONSTRUCTION CERTIFICATE.

NEWPARK PRECINCT 7H SALES PLANS SHEET 4 OF 4		PROJECT No: 9985-12	
		SHEET No: SP04	
AZIMUTH: M.G.A.94	DATUM: A.H.D.	ORIGIN: -	PLAN No: 9985-12-7H-SP04
			1