



## Design Guidelines

# Welcome to Newportark.

The Newportark Design Guidelines have been produced to help create a well-designed, high quality streetscape at Newportark and to protect your investment in your new home. The Newportark Design Guidelines form part of the Contract of Sale for your block of land (lot) and are also included in the restrictions on title known as the 88B.

The Newportark Design Guidelines apply in addition to and not in lieu of other statutory requirements and approvals. Approval by Blacktown Council under its Development Control Plan (DCP) or by a Private Certifier (PCA) under the NSW Housing Code (CDC) will still be required.

The Newportark Design Review Panel (DRP) will review all proposed home designs within Newportark for compliance. Purchasers or their selected Builders or Designers must submit their house designs along with their landscape plans for review and approval by the Newportark DRP prior to lodgement with Blacktown City Council or a Private Certifier for approval.

Also as an incentive for Land Only purchasers if your home and landscaping are completed and you apply within 24 months (two years) of your land settlement with the developer you will be eligible to receive your Design Guidelines Compliance Payment.

If you have any questions you can ask at the Newportark Sales and Information Centre or by emailing the DRP at [newparkdesignreview@winten.com.au](mailto:newparkdesignreview@winten.com.au)

## Building at Newportark

### STEP 1

#### **Inform Your Builder About the Design Guidelines**

Provide your builder with a copy of the Newportark Design Guidelines, also available for download from the Newportark website. Make sure your builder understands that it is a condition of your Sale of Land Contract and Restrictions on Title (88B) that you must comply with the Newportark Design Guidelines.

### STEP 2

#### **Seek Newportark Design Review Panel Approval**

Prior to the lodgement of your plans for approval with Blacktown City Council (or an accredited Private Certifier), you or your builder or designer (on your behalf) must ensure that your house is approved by the Newportark DRP. Complete the Newportark Design Guideline Application Checklist (available from <https://newpark.com.au/building-at-newpark>) and submit along with your building plans, colour scheme and landscape plan for approval. You, your builder or designer can lodge the plans with the DRP via email at [newparkdesignreview@winten.com.au](mailto:newparkdesignreview@winten.com.au).

### STEP 3

#### **Newportark Design Review Panel (DRP) Grants Approval**

Following review of your application the DRP may approve your building plans, landscaping plans and colour scheme. If there is any non-compliance to the Design and Landscaping Guidelines you will be asked to resubmit your application. The DRP will stamp your plans and return them to you (or your builder or designer) with a letter of approval. If you wish to lodge your plans for approval with Blacktown City Council prior to settlement the DRP can also provide an owner's consent to lodge letter.

### STEP 4

#### **Completion of Works and Application for Design Guidelines Compliance Payment**

If your building and landscape works are completed as approved, you have rectified any damage and you apply by lodging the Application Form with the DRP within 24 months (two years) of the settlement of your block of land you will be eligible for the Design Guidelines Compliance Payment to be paid to you.

### STEP 5

#### **Payment of Design Guidelines Compliance Payment**

A representative of the DRP will inspect your home and landscaping to check all the works have been completed in accordance with the DRP approved building and landscape plans. Once the completion of the works in accordance with the DRP approval has been verified, the Design Guidelines Compliance Payment will be paid to you.

## Colour Schemes

### Paint and Render Colours

Paint and render colours should suit your brick and roof materials and be in line with or based on the two Rendered and Paint Colour Schemes below. Each of the colour schemes 'Trees and Grasses', and 'Wood and Earth', include a number of trim accent and background colours. Choose one of each for your house. Background and accent colours are to be used for large expanses of the house such as wall materials, cladding or painted masonry. Strong/ bright colours are restricted to highlights and trim such as columns and beams, windows and door frames, the front door, gutters and downpipes, handrails and pergolas.

### Face Brick

Face brick which generally forms the main wall material is to be flat-faced, square-edged and not deeply textured. The brick colour is to be uniform throughout the brick and provide a consistent wall colour. Pale or white coloured bricks are not permitted. Mid to darker tone bricks are preferred.

### Roof

Roof colours such as greys to charcoal are suitable. Bright red terracotta, bright blue, pure black or pure white are not permitted.

### Driveways and Paths

Driveways and paths in the front yard (private land) must be either a broom finished coloured concrete; plain patterned stencilled or stamped concrete. Driveways and paths in the public road reserve (verge areas) must be plain, off-white concrete with a broom finish.

### Retaining Walls

Retaining walls in the front or side yard areas that are visible from the street must be masonry and must be either painted masonry to match the house or masonry blocks in charcoal or natural earth colours and tones.

### Trees and Grass

#### Tree and Grasses - Palette 1

	Trim Colour C23 Woodland Grey EB
	Accent Colour A251 Army Greens D
	Accent Colour A251 Battle Dress D
	Background Colour A251 Moorland W
	Background Colour A252 Lamb's Ears W
	Trim Colour C20 Plantation EB

#### Tree and Grasses - Palette 2

	Trim Colour A202 Congo Brown BY
	Accent Colour A203 Irrigation UD
	Accent Colour A203 Knapsack D
	Background Colour A203 Tuft W
	Background Colour A204 Grand Piano W
	Trim Colour C160 Warm Spice BY

#### Roof Colour for Tree and Grasses - Palette 1

Colours for Colorbond or tiled roofs for each palette are included below. These colours can also be used for accents and trims elsewhere on your house.

	Colorbond Colour C23 Woodland Grey EB
	Colorbond Colour C20 Plantation EB
	Colorbond Colour C3 Summershade W
	Colorbond Colour C18 Bushland D
	Colorbond Colour C16 Windspray D
	Colorbond Colour C19 Ironstone UD
	Colorbond Colour C10 Wilderness UD

#### Roof Colour for Tree and Grasses - Palette 2

	Colorbond Colour C3 Summershade W
	Colorbond Colour C17 Jasper UD
	Colorbond Colour C22 Estate EB
	Colorbond Colour C23 Woodland Grey EB

#### Driveways and Paths for Trees and Grasses - Colour - Palette 1

	Dulux Colour GR10 Domino
--	-----------------------------

#### Driveways and Paths for Trees and Grasses - Colour - Palette 2

	Dulux Colour H23 Charcoal Chintz
--	-------------------------------------

#### Driveways and Paths for Trees and Grasses - Colour - Palette 3

	Dulux Colour GR8 Monk
--	--------------------------

#### Driveways and Paths for Trees and Grasses - Colour - Palette 4

Please note: While Dulux colours are specified, equivalent colours within other paint brands are allowed. Half and quarter mixes of each tint are also allowed.

### Wood and Earth

#### Wood and Earth - Palette 1

	Trim Colour C22 Estate EB
	Accent Colour A143 Sea Elephant UD
	Accent Colour A143 Toffee Fingers D
	Background Colour A143 Blind Date W
	Background Colour A168 Limed White W
	Trim Colour A142 Abbot O

#### Wood and Earth - Palette 2

	Trim/Background Colour CB Dune W
	Accent Colour A152 Baton UD
	Accent Colour A152 Snuggle Pie D
	Background Colour A152 Puddle W
	Background Colour A165 Light Rose W
	Trim Colour A151 Bunker EB

#### Roof Colour for Wood and Earth - Palette 1

Colours for Colorbond or tiled roofs for each palette are included below. These colours can also be used for accents and trims elsewhere on your house.

	Colorbond Colour C13 Bushland D
	Colorbond Colour C22 Estate EB
	Colorbond Colour CB Dune W
	Colorbond Colour C4 Shale Grey W
	Colorbond Colour C23 Woodland Grey EB

#### Roof Colour for Wood and Earth - Palette 2

	Colorbond Colour CB Dune W
	Colorbond Colour C12 Stone D
	Colorbond Colour C22 Estate EB
	Colorbond Colour C23 Woodland Grey EB

#### Driveways and Paths for Trees and Grasses - Colour - Palette 1

	Dulux Colour GR10 Domino
--	-----------------------------

#### Driveways and Paths for Trees and Grasses - Colour - Palette 2

	Dulux Colour H23 Charcoal Chintz
--	-------------------------------------

#### Driveways and Paths for Trees and Grasses - Colour - Palette 3

	Dulux Colour GR8 Monk
--	--------------------------

#### Driveways and Paths for Trees and Grasses - Colour - Palette 4

Please note: While Dulux colours are specified, equivalent colours within other paint brands are allowed. Half and quarter mixes of each tint are also allowed.

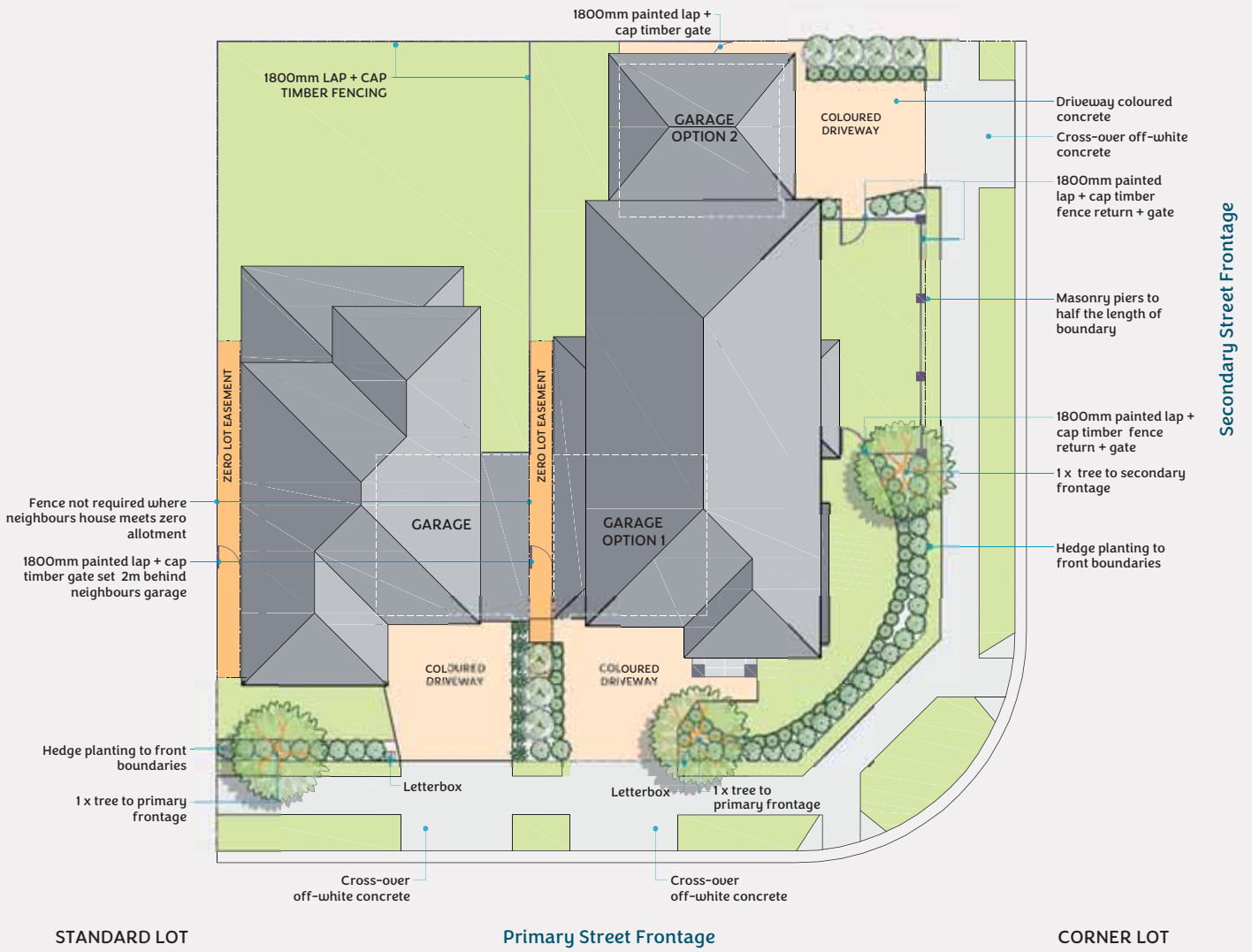

## Compliance Payment

For Land Only purchasers the Newport Design Guidelines Compliance Payment is \$5,000 for all lots and \$10,000 for corner lots. **Please note there are no Compliance Payments for Home and Land Packages purchased through Newport partner builders.**

The Special Conditions in the Land Sale Contract offers Land Only purchasers a Design Guidelines Compliance Payment once their new home and landscaping is complete and the conditions of the offer have been satisfied.

Conditions of the Design Guidelines Compliance Payment are:

- Your home, landscaping, driveways and fencing as approved, has been completed within 24 months of the settlement of your lot with the developer.
- You (and your builder) have been careful during construction to minimise any damage to the street, footpath, verge, services, public landscape or street tree.
- Any damage to the surrounding public areas including streets, street trees, footpaths, nature strips, services and adjoining land caused by the construction of your home has been rectified (at your cost).
- No changes (unless endorsed by the DRP) have occurred to the exterior of the home or landscaping as approved by the DRP.
- Your home and landscaping is being maintained to a tidy and reasonable standard.

To apply for your Compliance Payment complete the Newport Compliance Payment Application Form, available to download from the Newport website on the 'Building at Newport' page, and email it to [newparkdesignreview@wintn.com.au](mailto:newparkdesignreview@wintn.com.au) within 24 months of settlement of your lot with the developer.

## Your Plans

Your plans being submitted to the Newport DRP for approval must include House Plans, Landscape Plan, and Materials and Colour Scheme.

### House Plans

House plans must include:

- Site plan with levels.
- Street elevations, showing all materials.
- Floor plans.

### Landscape Plan

A landscape plan or the landscaping works may be shown on the Site Plan.

The landscape plan should include the following elements in the front yard, and side yard of secondary street frontages on corner lots:

- Location of proposed hedge plants including species, quantity, size and pot sizes.
- Turf, front hedge, garden and edges.
- Trees – 1 x tree to front street and 1 x tree to side street on corner lots.
- Retaining walls – including location, height and materials.
- Driveway location and finish – off-white concrete to public road reserve and coloured concrete on private lot.
- Paths and hard paving areas, size and finish.
- Fencing including secondary street fencing to corner lots.
- Letterbox pier location and finish.

### Materials and Colour Scheme

Must comply with the Newport Colour Schemes and include:

- Brick type – include a picture/photo.
- Roof type and colour.

- Colour of the private driveway concrete (public street crossover to be off-white concrete).
- Colours of windows, garage doors, handrails, downpipes, fascia and gutter.
- All paint colours.

## Design Guidelines

### Dwelling Design

Many lots in Newport have a restriction on title that you must build a two storey home. Some lots allow double or single storey homes depending on the restrictions on the title of your lot. **Please refer to the Single and Double Storey Plan at <https://newpark.com.au/building-at-newpark> to confirm if your home must be double storey or can be either double or single storey home.**

- The front facade of all single storey homes must include either:  
(A) Raised Entry Patio Element (minimum of 3m wide); or  
(B) Entry Veranda Element (minimum 4m wide).  
NOTE: Refer to images A and B (on the next page) for details of the Single Storey Design Requirements for these elements.
- The primary or main roof must be a hip roof. Gables and/ or some minor parapet wall elements are allowed including to the garage. No skillion roofs are to be visible from the street (only permitted at the rear of the ground floor or behind minor parapet wall elements).
- For single storey homes the primary or main roof must be a minimum of 25-degree pitch and for two storey homes the minimum is a 22.5-degree pitch.
- All homes must have eaves on the front (primary street) facade.
- No sliding windows to front facades (awning or double hung windows are permitted).
- All front facades must include articulation and a mix of materials and colours such as face brick, painted masonry or cladding.
- Front facades of single storey homes must have a minimum of 25% of the area of walls or faces of masonry columns as painted masonry or cladding.
- Single storey homes can have up to a maximum of 25% of front facade wall area as cladding.
- Colours and materials have been selected from the Newport Colour Schemes.
- No mottle, speckled, or light face bricks are permitted, mid to dark bricks are preferred.

### Landscaping, Fences, Paths and Driveways

- Driveway and crossover from the street to the property boundary must be off white concrete. Private driveways and paths within the property boundary can be coloured concrete (colour must be selected from the Newport Colour Schemes).
- A masonry letterbox pier in face brick or painted in a colour that complements the house.
- No front fences are allowed, a planted hedge in a garden bed is required on the front boundary.
- Front yard landscaping must include a minimum of one small tree, hedge plants (minimum 300mm pots) on the boundary and turf.
- Any retaining walls visible from the street or public place must be masonry.
- Side and rear fences must be 1800mm lapped and capped timber and not extend forward of a point 1m back from the front of the dwelling or the neighbouring dwelling. Any timber fencing visible from the street must be painted in a dark colour that complements the house (must be noted on the landscape plan).
- Side gates must be painted in a dark colour that complements the house (must be noted on the landscape plan).

### Corner Lots (Controls for Secondary Street Frontage)

- Secondary street façades for corner lots must include articulation and a mix of materials and colours such as face brick, painted masonry or cladding.
- No sliding windows to the secondary street facades (awning or double hung windows are permitted).
- All corner lot homes must have eaves on the secondary street facade.
- No front fences are allowed, the front planted hedge in a garden bed is required to return along the front section the secondary street boundary.
- Front side yard landscaping to the secondary street must include a minimum of one additional small tree (2 trees in total), hedge plants (minimum 300mm pots) on the secondary boundary and turf.
- Any retaining walls visible from the secondary street or a public place must be masonry.
- The rear section of fence on the secondary street enclosing the rear or side yard is to be 1800mm high. Timber lapped and capped timber, painted in a dark colour between masonry piers in a face brick or bagged and painted in a colour that complements the house. Painting the fence must be noted on the landscape plan. The maximum length of this fence is half the length of the lot boundary.

## Single Storey Design Requirements



### (A) Raised Entry Patio Element

The Element must be:

- A minimum 3m wide
- Have a raised roof and soffit by minimum 300mm
- Articulated forward of main facade by minimum 450mm
- Columns must be masonry
- Can have a hip or gable roof



### (B) Entry Verandah Element

The Element must be:

- A minimum 4m wide
- Articulated forward of main facade by minimum 450mm
- Can have a hip or gable roof
- Can be masonry columns or timber posts
- Can be at the same level as the eave soffit



Newpark Sales Centre: Corner of Elara Boulevard & Rosepark Drive, Marsden Park  
1300 122 500 [newpark.com.au](http://newpark.com.au)

This plan is provided solely for the purpose of providing an impression of the proposed development called Newpark, as well as the approximate location of existing and proposed third party facilities, services or destinations, and is not intended to be used for any other purpose. Winten Property does not make any representation or give any warranty in relation to the future development of the site, or the current or future location or existence of any facilities, services or destinations. The plan is based on the intention of, and information available to, Winten Property Group at the time of creation of the plan and details may change due to future circumstances. Any indications of distance or size are approximate and for indicative purposes only, and are not to scale. Information correct as at January 2019. Printed October 2019 WIP0308

