

PRECINCT	CASE NUMBER	DEPENDENCY	COMMENTS/STATUS
Abell Rd Stockland Precinct 6	171635	N/A	DN250 PW main completed, connected
Abell Rd Culvert Crossing	180445	N/A	Connection was 05.03.2021
Precinct 5	180446	180445	Connection in June 2021
Abell Rd Stage 1	183893	180445, 180446	Design was submitted to SWC , Construction July/August 2021
Winten Stage 7A	183455	18393, 180445, 180446	Designed, construction started February 2021, 8 months construction schedule for Stage 7A
Winten Stage 7C	190658	180445, 183455, 18393, 180446	Current CN as of PW design (05.06.2021)
Abell Rd Stage 2	191044	18393, 180445, 180446	Design started, Civil Construction Commencing August 2021, concluding May 2022
Abell Rd Stage 3	191045	18393, 180445, 180446, 191044	Design not started, Civil Construction Commencing October 2021, concluding June 2022
Abell Rd Stage 4	191046	18393, 180445, 180446, 191044, 191045	Design not started, Civil Construction Commencing December 2021, concluding September 2024
Stony Creek Rd Upgrade	169016	N/A	Completed, connected

No.	AMENDMENT DESCRIPTION	BY	DATE
1	WORK AS CONSTRUCTED	JV	22.08.22
B	ISSUE FOR APPROVAL	FJ	05.06.21
A	LAYOUT FOR CLIENT	FJ	03.05.21

WORK AS CONSTRUCTED CERTIFICATION		SYDNEY WATER CORPORATION	
DEVELOPER	WOORONG PARK PTY LTD	<b>Sydney WATER</b>	Case No.190658PW SHT 5 OF 5 SHTS.
W.S.C.	QALCHEK PTY LTD		
CONSTRUCTOR	C.J. DOYLE	SYDNEY WATER CORPORATION	
COMPLETED	17.08.2022	FOR DETAILS OF SERVICES SEE SHEET 1	
W.A.C. PREPARED	22.08.2022		
DESIGNER	QALCHEK PTY LTD		
I CERTIFY THAT THE WORKS HAVE BEEN CONSTRUCTED IN ACCORDANCE WITH THE WORK AS CONSTRUCTED DRAWINGS			

0 10 20 30 40 50 METRES  
M.G.A. ZONE 56 M.G.A. DATUM: GDA2020

- DESIGNER AND WATER SERVICING COORDINATOR:  
QALCHEK PTY LTD (CERTIFIED No.289)  
UNIT 2, LEVEL 1, 15-17 DAVID ROAD, EMU PLAINS 2750  
PH. No. (02) 4722 8181  
  
FOR:  
WOORONG PARK PTY LTD  
c/o J WYNDHAM PRINCE  
580 HIGH STREET, PENRITH, NSW 2750  
PH. 02 4720 3300
- THE WORKS AND MATERIALS ARE IN ACCORDANCE WITH THE WATER SUPPLY CODE OF AUSTRALIA (WSA 03-2011-3.1) INCLUDING THE SYDNEY WATER SUPPLEMENT (2014) AND APPENDICES AS WELL AS THE SYDNEY WATER TECHNICAL SPECIFICATION - CIVIL VERSION 9.0 AND THE SYDNEY WATER TECHNICAL SPECIFICATION - MECHANICAL VERSION 11.0.
- MAINS LAID GENERALLY 2.9 P.L. & AS SHOWN AT STANDARD DEPTH BELOW KERB INLET EXCEPT WHERE OTHERWISE SHOWN.
- ALL EXCAVATION, SHORING EXCAVATION AND STABILITY OF ADJACENT STRUCTURES/SERVICES/DWELLINGS WAS THE RESPONSIBILITY OF THE CONSTRUCTOR.
- ALL BUILDING LAYOUTS, FINISHED SURFACE LEVELS, STORMWATER INFORMATION, AND GENERAL CIVIL ENGINEERING DETAILS TAKEN FROM:  
CIVIL BASEPLAN: 998512-P7C and Abell Road-BASE FOR SERVICE DESIGN.dwg (SUPPLIED 20.05.2021 BY JWP)  
SURFACE INFORMATION: 9985 P7C DESIGN TRIANGLES 210520.dwg (SUPPLIED 21.05.2021 BY JWP)  
SWD INFORMATION SUBMISSION: 9985-12-CC10001-10803.pdf AS WELL AS 9985-12-CC11001-11801.pdf (SUPPLIED 20.05.21 BY JWP)
- CONDITIONS FOR EMBEDMENT, BACKFILL AND TESTING REQUIREMENTS ARE AS FOLLOWS:  
- ALL POTABLE WATER ROAD CARRIAGEWAY CROSSINGS FOR EXISTING AND NEW ROADS BEDDED AND BACKFILLED WITH SAND/CEMENT. SAND/CEMENT RATIO 14:1 AND WAS PLACED DRY.  
- FOR ANY WATERMAIN LOCATED WITHIN 1.0m OF A ROAD SHOULDER OR KERB AND GUTTER IN THE VERGE OR FOOTPATH THE EMBEDMENT AND BACKFILL WAS COMPACTED TO A DENSITY INDEX OF 98%. ALL TESTS (EMBEDMENT AND BACKFILL) WERE DONE AS FOR TRAFFICABLE AREA.  
THE MINIMUM NUMBER OF FIELD COMPACTION TESTS CONDUCTED TO SATISFY THE CONDITIONS ABOVE AS WELL AS THE WATER SUPPLY CODE OF AUSTRALIA ARE:  
PIPE EMBEDMENT ZONE: 0 TESTS CONDUCTED (LETTER PROVIDED)  
TRENCH FILL ZONE (TRAFFICABLE): 70 TESTS CONDUCTED  
TRENCH FILL ZONE PROPERTY SERVICES: 40 TESTS CONDUCTED  
COMPACTION TESTS - TOTAL: 110 TESTS CONDUCTED
- ALL PROPERTY (MAIN TO METER) SERVICES WERE CONSTRUCTED TO SYDNEY WATER'S INSTALLATION REQUIREMENTS BY A LICENSED PLUMBER AND ACCREDITED DRILLER. THE WORKS WERE INSTALLED IN ACCORDANCE WITH THE CURRENT SYDNEY WATER PROPERTY SERVICE (MAIN TO METER) INSTALLATIONS TECHNICAL REQUIREMENTS, NSW CODE OF PRACTICE FOR PLUMBING AND DRAINAGE, AND AS/NZ 3500.
- ALL REDUNDANT SURFACE FITTINGS AND INDICATOR PLATES WERE RECOVERED.
- THE WORKS WERE CONSTRUCTED IN ACCORDANCE WITH SYDNEY WATER'S DEEMED TO COMPLY DRAWINGS:  
- FOR HORIZONTAL BENDS TYPE 2 DTC-1111 (ISSUE B 29.02.12)  
- FOR TAPERS DTC-1112 (ISSUE B 29.02.12)  
- FOR TEES DTC-1113 (ISSUE B 29.02.12)  
- FOR VERTICAL BENDS & HYDRANT BENDS DTC-1114 (ISSUE A 31.01.12)  
- FOR STOP VALVES NOTE THAT VALVES DN200 AND UNDER DO NOT REQUIRE ANCHORING AS NOTED IN SYDNEY WATER'S EMAIL 08.08.14

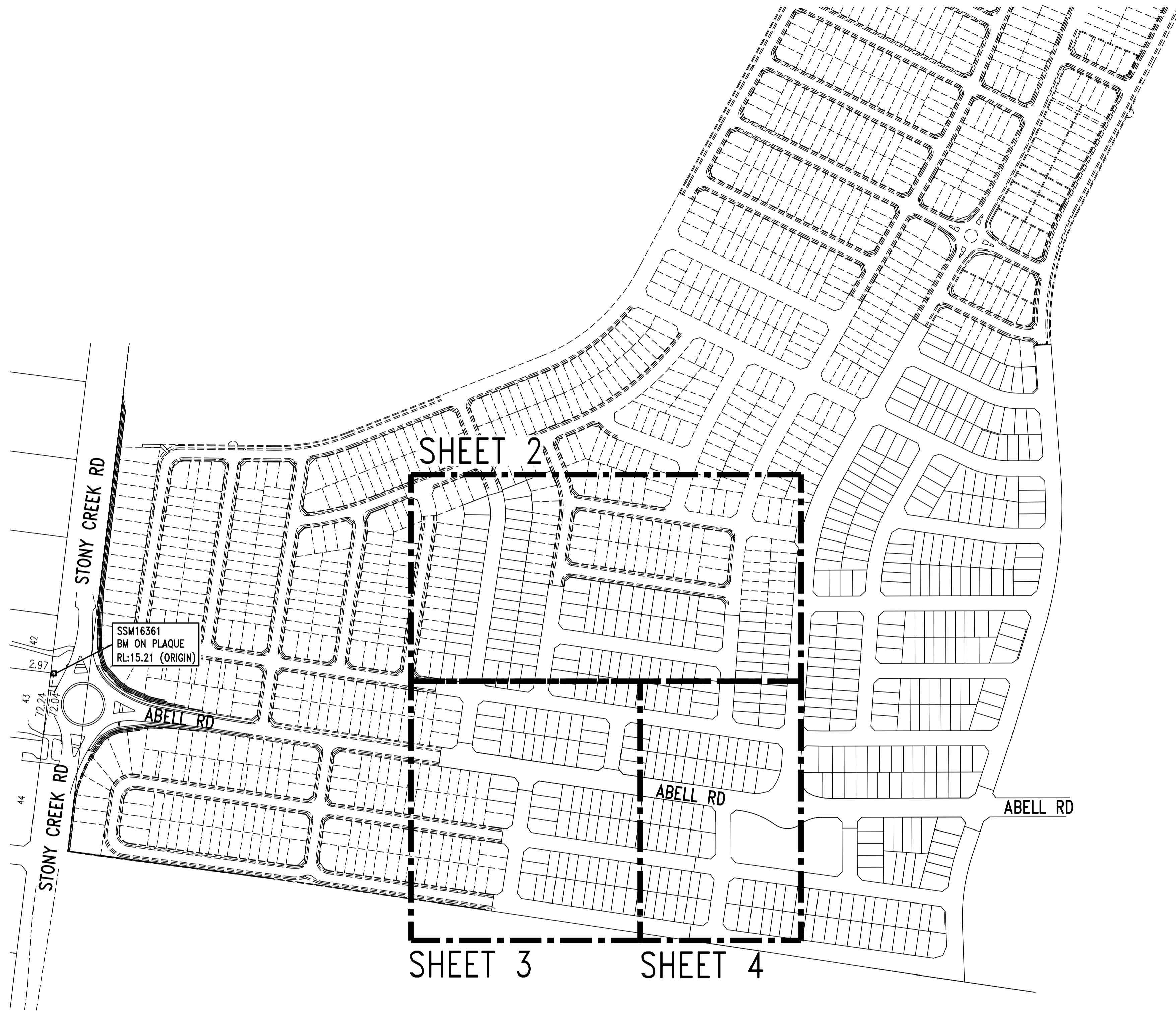

LOCALITY PLAN & BENCHMARK DIAGRAM  
(NOT TO SCALE)

1	WORK AS CONSTRUCTED	JV	22.08.22
B	ISSUE FOR APPROVAL	FJ	05.06.21
A	LAYOUT FOR CLIENT	FJ	03.05.21
No.	AMENDMENT DESCRIPTION	BY	DATE

PLAN TO BE READ IN CONJUNCTION WITH CURRENT SYDNEY WATER STANDARDS SYDNEY WATER CORPORATION  
PRIOR TO COMMENCEMENT OF EXCAVATION FOR PROPOSED AND EXISTING SERVICES CONTACT:-  
DIAL BEFORE YOU DIG ..... Ph. 1100  
ELECTRICITY ..... Ph. ....  
GAS ..... Ph. ....  
TELECOMMUNICATIONS ..... Ph. ....  
SYDNEY WATER ..... Ph. 132 092  
GIVING AT LEAST 48 HOURS NOTICE.

UTILITIES			
TYPE	DATE	REF.	
STORMWATER: SWD - - - - SWD	20.05.21	ENG.PLANS	
SEWER: S - - - - S	05.06.21	DESIGN	
SSM 16361 (ORIGIN)	05.05.21	SCIMS	

WORK AS CONSTRUCTED CERTIFICATION			
DEVELOPER	WATER SERVICE CO-ORDINATOR	CONSTRUCTOR	COMPLETED
WOORONG PARK PTY LTD	QALCHEK PTY LTD	C.J. DOYLE	17.08.2022
DESIGNER QALCHEK PTY LTD		W.A.C. PREPARED 22.08.2022	

PIPE SCHEDULE				
SIZE DN	TYPE	CLASS	LENGTH	PIPE JOINING METHOD / NOTES
100	OPVC	PN16	1690.1	RRJ
DESIGN HEAD, 120 m				

AUSTRALIAN HEIGHT DATUM  
SCALES  
PLAN 1:500 SECTION { HOR. . . . .  
VERT. . . . .  
CROSS SECTIONS . . . . . NATURAL  
LENGTHS, DEPTHS & LEVELS ARE IN METRES.

NO AMENDMENTS ARE TO BE MADE TO THIS PLAN WITHOUT REFERENCE TO SYDNEY WATER. THIS PLAN IS NOT NECESSARILY UP TO DATE OR CORRECT AND SYDNEY WATER ACCEPTS NO RESPONSIBILITY.  
U.B. DIRECTORY . . . . . MAP 126/A/16 45th EDITION  
SHEET . 1 . OF . 5 . File No. N/A

**Sydney WATER** SYDNEY WATER CORPORATION  
Case No. 190658PW  
WATERMAIN EXTENSION  
ABELL RD AND OTHERS  
MARSDEN PARK BLACKTOWN



JOIN LINE CONTINUED ON SHEET 3 CONTINUED ON SHEET 4 JOIN LINE

- LEGEND
- EASEMENT FOR DRAINAGE 1.5 WIDE
  - \* DRIVEWAY
  - ⊠ SUBSTATION
  - ⊗ LOT SERVICED BY CN190189PW
  - ⊕ TAPPING INSERTED INTO EXISTING MAIN

1	WORK AS CONSTRUCTED	JV	22.08.22
B	ISSUE FOR APPROVAL	FJ	05.06.21
A	LAYOUT FOR CLIENT	FJ	03.05.21
No.	AMENDMENT DESCRIPTION	BY	DATE

WORK AS CONSTRUCTED CERTIFICATION		SYDNEY WATER CORPORATION	
DEVELOPER	WOORONG PARK PTY LTD	<b>Sydney WATER</b>	Case No. 190658PW SHT 2 OF 5 SHTS.
W.S.C.	QALCHEK PTY LTD		
CONSTRUCTOR	C.J. DOYLE		
COMPLETED	17.08.2022	SYDNEY WATER CORPORATION	
W.A.C. PREPARED	22.08.2022	FOR DETAILS OF SERVICES SEE SHEET 1	
DESIGNER	QALCHEK PTY LTD	I CERTIFY THAT THE WORKS HAVE BEEN CONSTRUCTED IN ACCORDANCE WITH THE WORK AS CONSTRUCTED DRAWINGS	

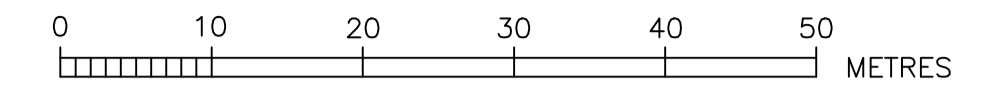

- LEGEND
- EASEMENT FOR DRAINAGE 1.5 WIDE
  - \* DRIVEWAY
  - SUBSTATION
  - LOT SERVICED BY CN191044PW

1	WORK AS CONSTRUCTED	JV	22.08.22
B	ISSUE FOR APPROVAL	FJ	05.06.21
A	LAYOUT FOR CLIENT	FJ	03.05.21
No.	AMENDMENT DESCRIPTION	BY	DATE

WORK AS CONSTRUCTED CERTIFICATION

DEVELOPER: WOORONG PARK PTY LTD  
W.S.C.: QALCHEK PTY LTD  
CONSTRUCTOR: C.J. DOYLE  
COMPLETED: 17.08.2022  
W.A.C. PREPARED: 22.08.2022

DESIGNER: QALCHEK PTY LTD

I CERTIFY THAT THE WORKS HAVE BEEN CONSTRUCTED IN ACCORDANCE WITH THE WORK AS CONSTRUCTED DRAWINGS

**Sydney WATER**  
SYDNEY WATER CORPORATION  
Case No. 190658PW SHT 3 OF 5 SHTS.

FOR DETAILS OF SERVICES SEE SHEET 1

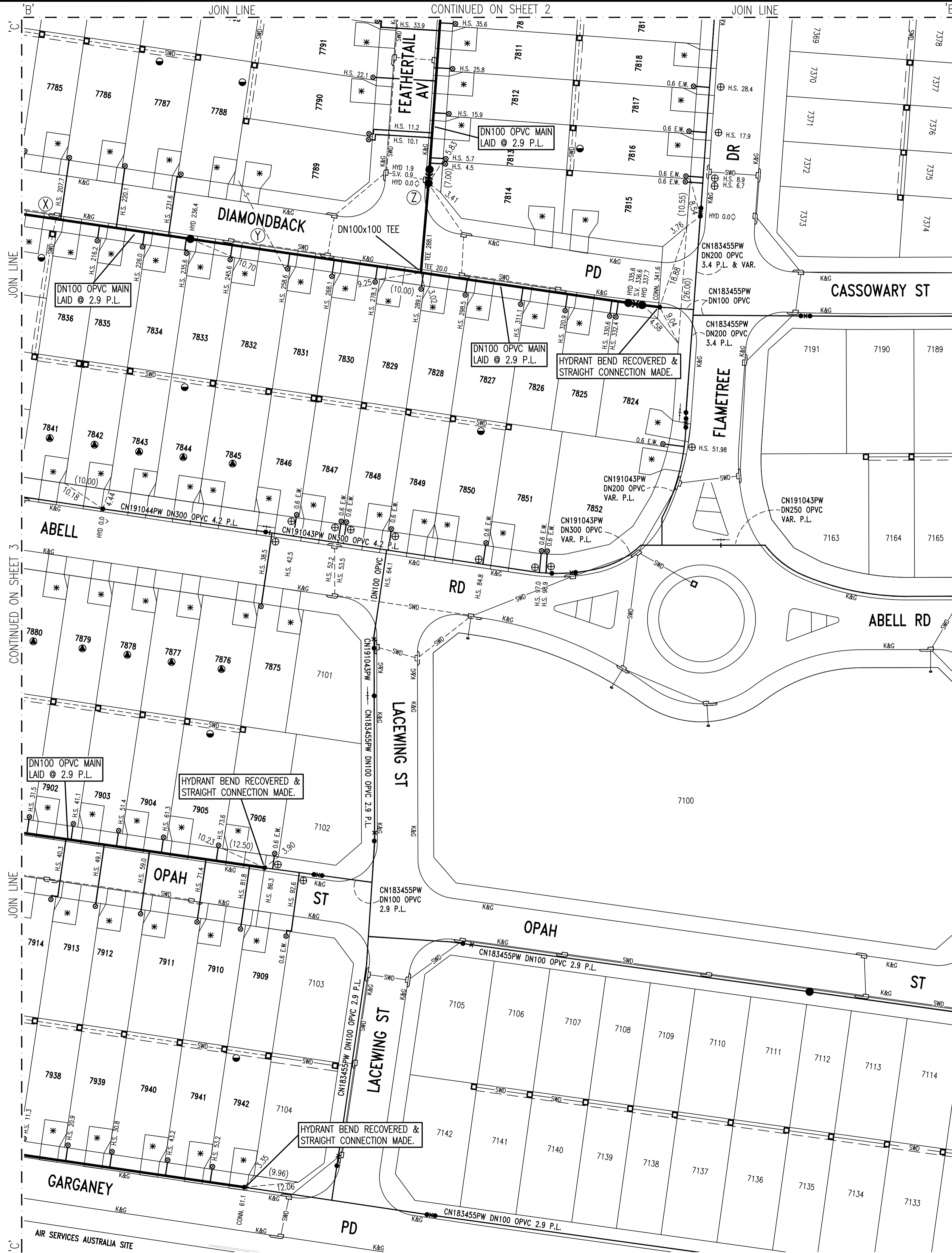
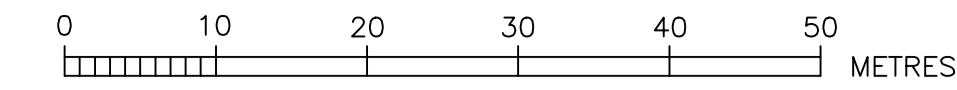

SERVICES CROSSING TABLE SHEET - MAIN WAS LAID OVER UNLESS NOTED OTHERWISE

CROSSING	SERVICE	SERVICE SIZE	PW SIZE	SERVICE COVER (m)	PW COVER (m)	CLEARANCE (m)	COMMENT/DTC
'A'	SWD	DN375	DN100	1.11	0.75	0.26	N/A
'B'	SWD	DN375	DN100	2.00	0.75	1.15	N/A
'C'	SWD	DN375	DN100	1.11	0.75	0.26	N/A
'D'	SWD	DN825	DN100	1.72	0.75	0.87	N/A
'E'	Sewer	DN150	DN100	2.99	0.75	2.14	N/A
'F'	SWD	DN375	DN100	1.12	0.75	0.27	N/A
'G'	SWD	DN375	DN100	1.11	0.75	0.26	N/A
'H'	SWD	DN450	DN100	1.38	0.75	0.53	N/A
'I'	SWD	DN375	DN100	1.10	0.75	0.25	N/A
'J'	SWD	DN375	DN100	1.11	0.75	0.26	N/A
'K'	SWD	DN375	DN100	1.56	0.75	0.71	N/A
'L'	Sewer	DN225	DN100	3.02	0.75	2.17	N/A
'M'	SWD	DN375	DN100	1.11	0.75	0.26	N/A
'N'	SWD	DN825	DN100	3.23	0.75	2.38	N/A
'O'	SWD	DN825	DN100	2.70	0.75	1.85	N/A
'P'	SWD	DN750	DN100	2.56	0.75	1.71	N/A
'Q'	SWD	DN450	DN100	2.07	0.75	1.22	N/A
'R'	SWD	DN375	DN100	1.16	0.75	0.31	N/A
'S'	Sewer	DN150	DN100	3.03	0.75	2.18	N/A
'T'	SWD	DN450	DN100	2.07	0.75	1.22	N/A
'U'	SWD	DN375	DN100	1.17	0.75	0.32	N/A
'V'	SWD	DN375	DN100	1.12	0.75	0.27	N/A
'W'	SWD	DN375	DN100	1.44	0.75	0.59	N/A
'X'	SWD	DN375	DN100	1.76	0.75	0.91	N/A
'Y'	Sewer	DN150	DN100	2.43	0.75	1.58	N/A
'Z'	SWD	DN375	DN100	1.39	0.75	0.54	N/A

- LEGEND
- EASEMENT FOR DRAINAGE 1.5 WIDE
  - \* DRIVEWAY
  - SUBSTATION
  - ⊙ LOT SERVICED BY CN191044PW
  - ⊕ TAPPING INSERTED INTO EXISTING MAIN

1	WORK AS CONSTRUCTED	JV	22.08.22
B	ISSUE FOR APPROVAL	FJ	05.06.21
A	LAYOUT FOR CLIENT	FJ	03.05.21
No.	AMENDMENT DESCRIPTION	BY	DATE

WORK AS CONSTRUCTED CERTIFICATION

DEVELOPER: WOORONG PARK PTY LTD  
 W.S.C.: QALCHEK PTY LTD  
 CONSTRUCTOR: C.J. DOYLE  
 COMPLETED: 17.08.2022  
 W.A.C. PREPARED: 22.08.2022

DESIGNER: QALCHEK PTY LTD

I CERTIFY THAT THE WORKS HAVE BEEN CONSTRUCTED IN ACCORDANCE WITH THE WORK AS CONSTRUCTED DRAWINGS

**Sydney WATER**  
 SYDNEY WATER CORPORATION  
 Case No. 190658PW SHT 4 OF 5 SHTS.

FOR DETAILS OF SERVICES SEE SHEET 1